



IMPORTANT WARRANTY & INSTALLATION INSTRUCTIONS ATTACHED

*Please Forward All Attached Information to Consumer
Warranty Not Valid Unless Returned to CORSA Exhaust*

We ask that you take a few moments to complete our warranty registration form:

TO ACTIVATE YOUR LIMITED LIFETIME WARRANTY GO TO:

CORSAPERFORMANCE.COM/WARRANTY



For Full-Color Installation Instructions, Please Visit:

CORSAPERFORMANCE.COM and Search by Part Number

Please be sure to review the enclosed instructions prior to beginning the installation process. If you have any questions about the enclosed parts, instructions or encounter a problem during Installation: **CALL CORSA PERFORMANCE TECHNICAL ASSISTANCE AT 800.486.0999**

Please take time to read and understand these installation instructions.

CORSA recommends that installation of this system be performed by a qualified service center or professional muffler installer who has the necessary equipment, tools and experienced personnel. However, if you decide to perform this install, the use of a hoist and an additional person will be required.

CAUTION: Never work on a hot exhaust system. Allow time for the vehicle to cool. Always wear eye protection when working under a vehicle.

Please confirm that all parts are present before beginning the factory exhaust system removal and CORSA exhaust system installation.

Recommended Tools:

- Safety Glasses
- 14mm Socket
- 15mm Socket
- Grommet Pullers
- Soapy Water
- Torque Wrench

Bill of Materials:

- 17CH2078 (Muffler)
- 17CH4095 (Axle Pipe Assembly)

- 17CH4097 (Tip Assembly)
- 17CH7038/17CH7039 (Hardware Kit)
- 1 Packet Antiseize Lubricant

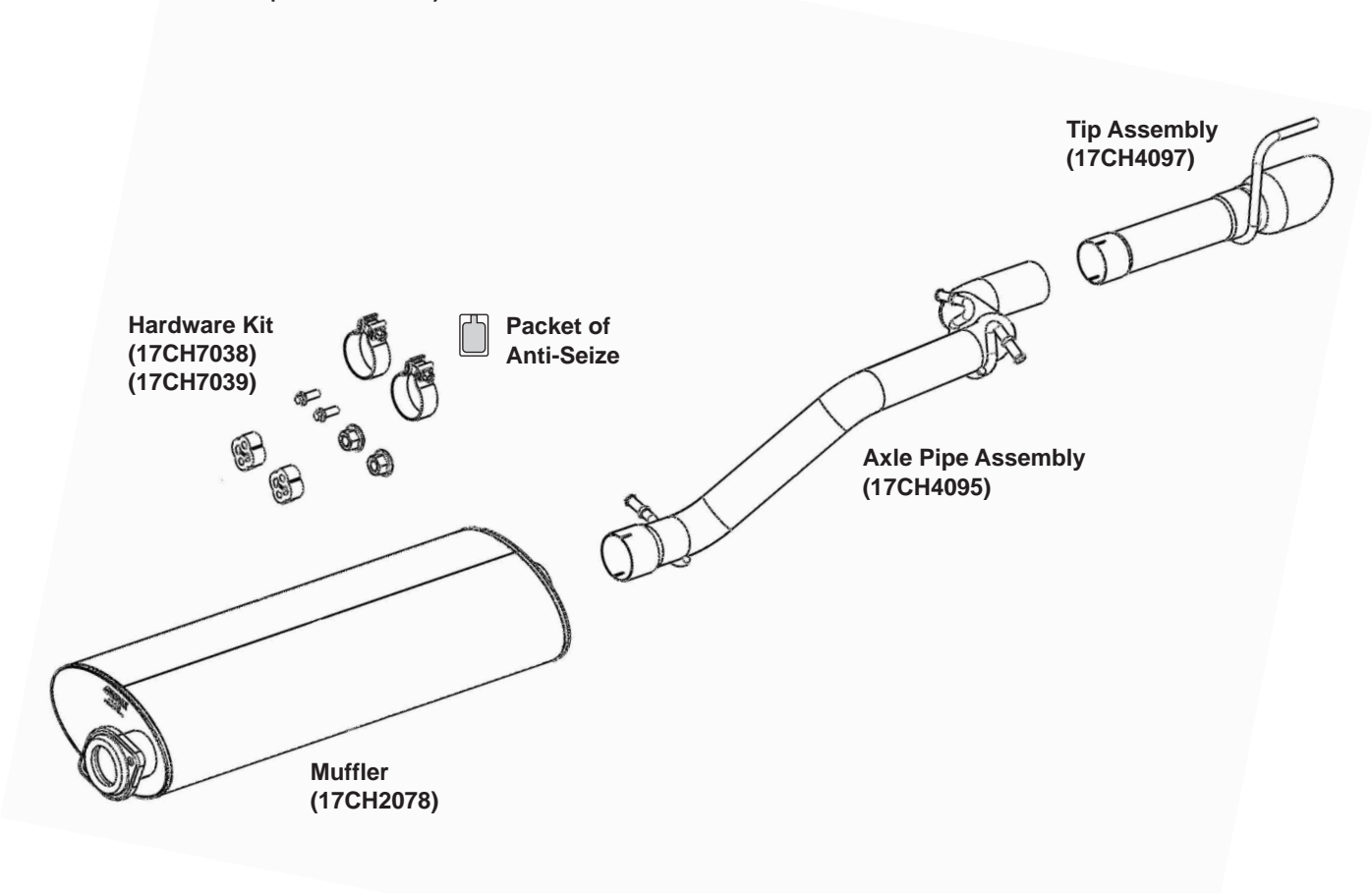

Removal of Stock Exhaust System:

1. Using a chain style cutter, cut the factory tailpipe approximately 11 inches (measured in a straight line up to the tailpipe) from the muffler outlet. **(See Fig. A,B)**

Note: Spraying the rubber grommets with a soapy water solution will ease in the removal of parts.

2. Using a grommet puller or similar device, remove the axle pipe hangers and rear tip hanger. While supporting the muffler and front pipe, remove the tailpipe over the axle towards the rear of the vehicle **(See Fig. C,D,E)**.
3. Using a 15mm socket, remove the flange bolts from the front of the muffler. Remove the muffler hanger and remove the muffler from the vehicle **(See Fig. F, G)**. The removal of the factory system is complete.

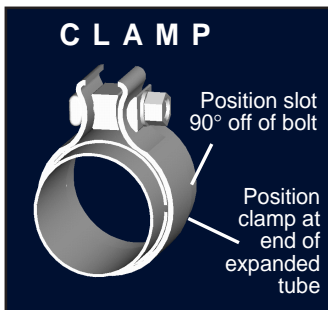

FIG. A



FIG. B

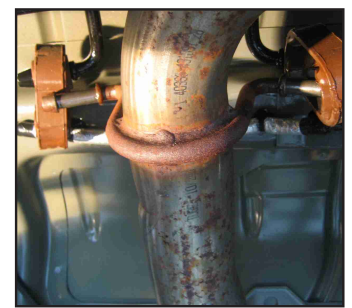

FIG. C



FIG. D

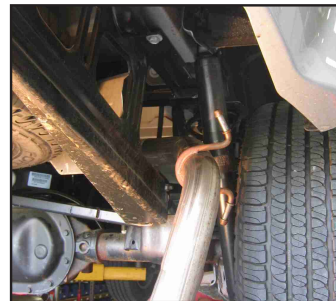

FIG. E



FIG. F

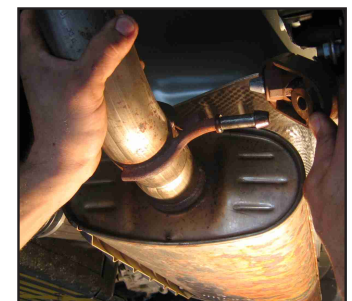

FIG. G

Installation of CORSA Exhaust System:

NOTE: Apply the anti-seize lubricant (supplied) to the threads **ONLY** of all the clamps and flange bolts. Failure to follow this procedure can cause nuts to seize on clamps and potentially destroy threads. After applying anti-seize lubricant, be sure to thoroughly clean hands as lubricant will tarnish stainless steel. All clamps should be tightened using a properly calibrated Torque Wrench. Using an air impact gun will damage the clamp and reduce its ability to effectively seal the joint. It may also cause the joint to separate thereby causing damage to your exhaust system and your vehicle.

1. Install the CORSA muffler. While supporting the rear of the muffler, align the CORSA muffler flange to the factory flange and loosely snug the supplied flange bolts and nuts. Make sure to reinstall the grounding strap on one of the flange bolts. **(See Fig. H)**
2. Slide a clamp over the inlet of the axle pipe and slide the front of the axle pipe over the outlet of the CORSA muffler. Then slide the hangers into the rubber grommets near the outlet of the muffler and above the axle (use supplied grommets if installing on a 4.7L V8 equipped vehicle). The clamp can be loosely tightened at this time **(See Fig. I, J, K, L)**
3. Slide a clamp over the inlet expansion of the tip assembly. Slide the hanger into the rubber grommet and slide the pipe over the outlet of the axle pipe. The clamp can be loosely tightened at this time **(See Fig. M, N, O)**. Do not torque anything yet.

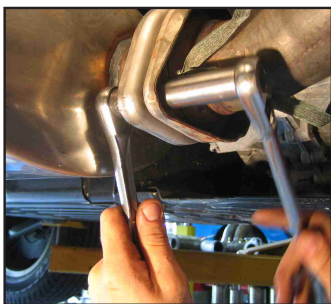

FIG. H

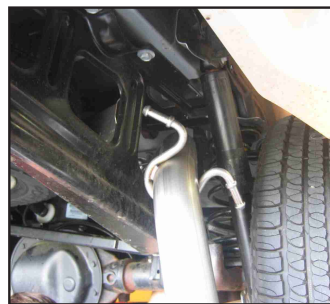

FIG. I

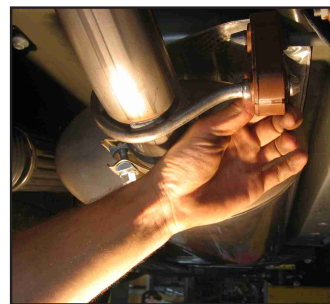

FIG. J



FIG. K

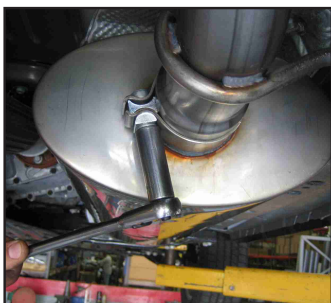

FIG. L

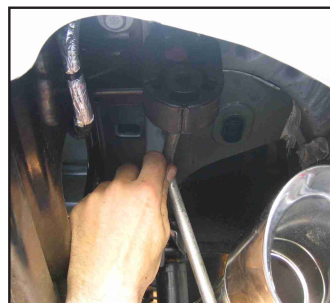

FIG. M

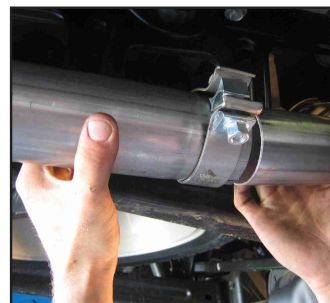

FIG. N



FIG. O

4. Starting at the front of the vehicle, torque all flange bolts and clamps to 45 ft-lbs.
5. Check clearance around the frame and axle and make adjustments at the clamp joints to properly align (**See Fig. P**).
6. It is **strongly suggested** that all clamps be checked and tightened if needed after road testing the vehicle once the system has cooled.

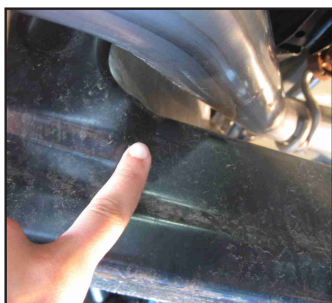

FIG. P

NOTE: During cold weather start-ups, you may experience an exhaust sound that is deeper and louder in tone than usual. This is temporary and will diminish to normal levels once your engine has reached its normal operating temperature. **NOTE:** Immediately following the installation of your exhaust system, you may experience a trace of smoke after initial start-up. **DO NOT** be alarmed. The smoke is caused by the burning of a small amount of forming oil residue used in the manufacturing process.