

Please take time to read and understand these installation instructions.

CORSA recommends that installation of this system be performed by a qualified service center or professional muffler installer who has the necessary equipment, tools and experienced personnel. However, if you decide to perform this install, the use of a hoist is strongly recommended.

CAUTION: Never work on a hot exhaust system. Allow time for the vehicle to cool. Always wear eye protection when working under a vehicle.

NOTE: Apply the anti-seize lubricant (supplied) to the threads **ONLY** of all the clamps and flange bolts. Failure to follow this procedure can cause nuts to seize on clamps and potentially destroy threads. After applying anti-seize lubricant, be sure to thoroughly clean hands as lubricant will tarnish stainless steel. All clamps should be tightened using a properly calibrated Torque Wrench. Using an air impact gun will damage the clamp and reduce its ability to effectively seal the joint. It may also cause the joint to separate thereby causing damage to your exhaust system and your vehicle.

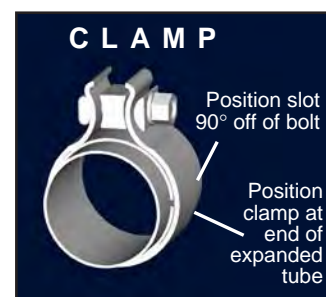

Please confirm that all parts are present before beginning the installation process.

Bill of Materials:

- Exhaust Tip Assembly (15CE3001)
- Hardware Kit (16DT7001)
- (1) Packet Anti-Seize Lubricant

Recommended Tools:

- Safety Glasses
- Torque Wrench
- Tape Measure or Ruler
- Saw or Chain-Style Pipe Cutter
- File
- 15mm Socket and Ratchet

Exhaust Tip Assembly (15CE3001)

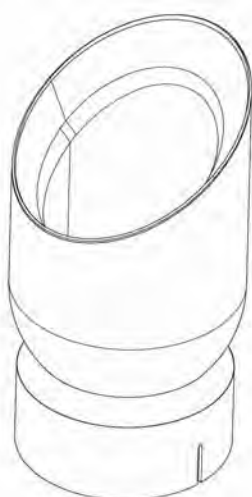

Hardware Kit (16DT7001)

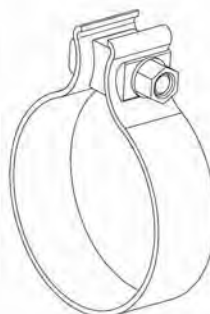

Anti-Seize Lubricant



FOR TECHNICAL ASSISTANCE, CALL 800.486.0999.

CORSA Exhaust Tip Installation:

1. The first step is to determine where to mark the tailpipe in order to remove a portion of the factory tailpipe. Measure 1" back from the bottom of the tailpipe exit and mark the tailpipe. This is your cut mark. **(See Figs. A & B)**

NOTE: Be sure to re-check your measurement before cutting.

2. Cut off the factory tailpipe at the point marked in step #1. Cut the pipe as straight as possible and remove any remaining burrs with a file. **(See Figs. C & D)**
3. Slide a supplied 3.5" Torca clamp over the tip assembly and place the tip onto the end of the tailpipe. Rotate the tip so that the CORSA logo is on top. **(See Figs. E & F)**
4. Tighten the Torca clamp to 45 ft-lbs using a torque wrench. **(See Figs. G & H)** This completes installation of the CORSA tip.



FIG. A

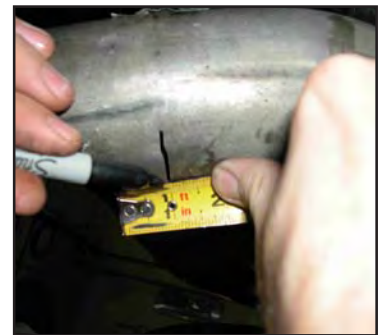

FIG. B



FIG. C



FIG. D



FIG. E



FIG. F



FIG. G



FIG. H