



IMPORTANT WARRANTY & INSTALLATION INSTRUCTIONS ATTACHED

*Please Forward All Attached Information to Consumer. Warranty
Not Valid Unless Returned to CORSA Exhaust*

We ask that you take a few moments to
Complete our warranty registration form.

To Activate Your 10 Year LIMITED WARRANTY, Go To:
CORSAPERFORMANCE.COM/WARRANTY



MADE IN THE USA



For Full-Color Installation Instructions, Please Visit:
CORSAPERFORMANCE.COM & Search Part #

Please be sure to review the enclosed instructions prior to beginning the installation process. If you have any questions about the enclosed parts, instructions or encounter a problem during installation, **CALL CORSA PERFORMANCE TECHNICAL ASSISTANCE AT 800.486.0999**

Please take time to read and understand these installation instructions.

CORSA recommends that installation of this system be performed by a qualified service center or professional muffler installer who has the necessary equipment, tools and experienced personnel. However, if you decide to perform this install, the use of a hoist and an additional person will be required.

CAUTION: Never work on a hot exhaust system. Allow time for the vehicle to cool. Always wear eye protection when working under a vehicle.

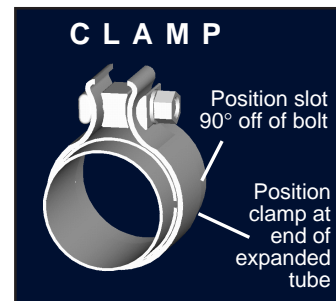

Please confirm that all parts are present before beginning the factory exhaust system removal and CORSA exhaust system installation.

Bill of Materials:

Recommended Tools:

- Head Pipe Assembly (24TI4005)
- Muffler 14687
- Tailpipe Assembly (24TI4006)
- Side Swept 4.0" Pro-Series Tip Assembly (16TA3000)
- Hardware Kit (24TI7001)
- (1) Packet Anti-Seize Lubricant

- Safety Glasses
- 14mm socket and ratchet
- 15mm socket and ratchet
- Chain style pipe cutter
- Grommet pullers
- Soapy water
- Torque wrench

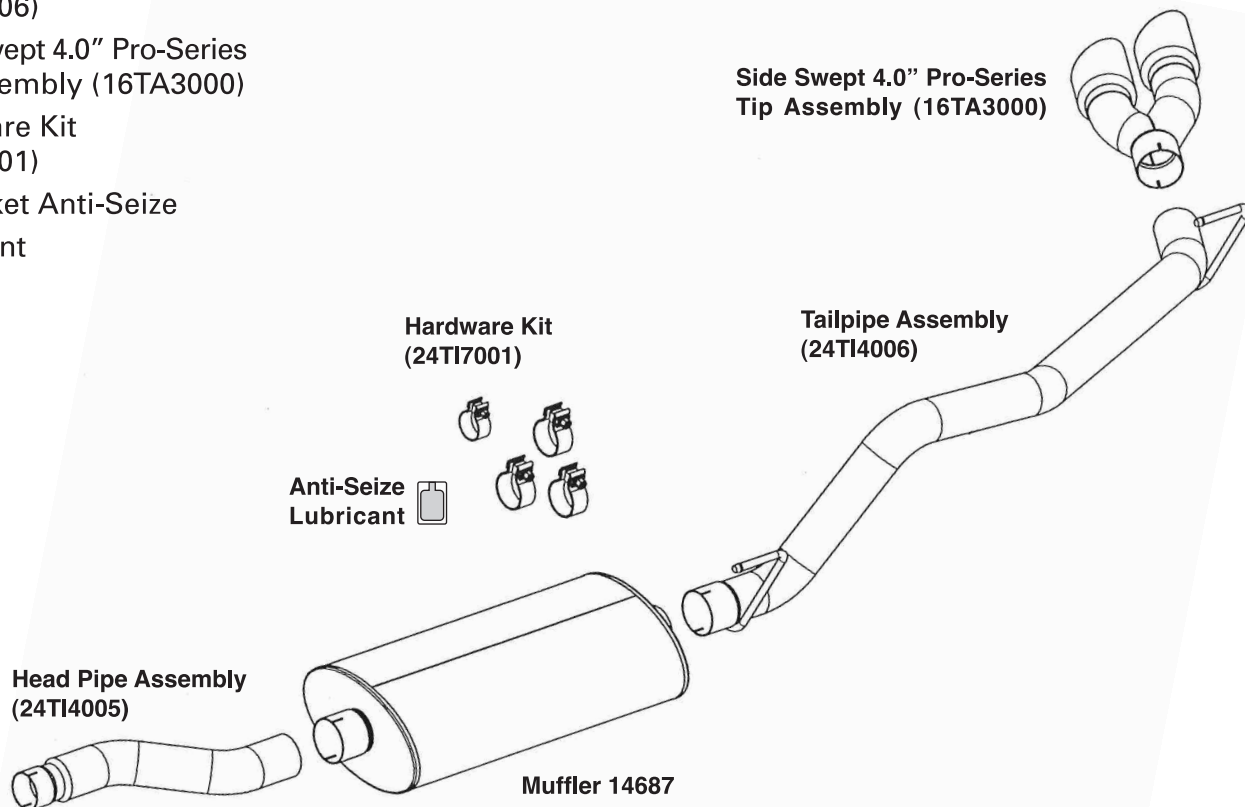

Removal of Stock System:

1. Measure 4" back from the rear surface of the metal grommet housing and mark a cut line on the exhaust pipe. (See Fig. A)
NOTE: Be sure to re-check your measurement before cutting.
2. Place a chain style cutter around the tailpipe at your cut line from step #1. Cut the pipe as straight as possible and remove any burrs with a file. (See Figs. B & C)
NOTE: For safety, be sure to support the muffler to prevent injury.
3. Using a 14mm socket and ratchet, remove the flange nuts at the flange connection of the tailpipe. (See Fig. D)
4. Remove the headpipe and muffler by removing the muffler hanger from the factory rubber grommet using grommet pullers or similar device. (See Figs. E & F)
NOTE: Using a soapy water solution on all grommet holes will make the job easier.
5. Remove the tailpipe section by removing the tailpipe hanger from the factory rubber grommet using grommet pullers or similar device and lifting the tailpipe over the rear axle and towards the rear. This completes removal of the stock system. (See Fig. G & H)



FIG. A



FIG. B



FIG. C



FIG. D



FIG. E



FIG. F

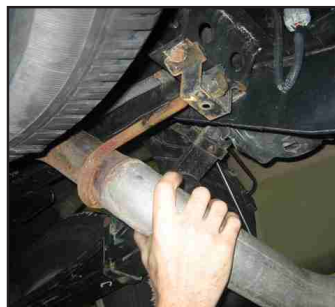

FIG. G



FIG. H

Installation of CORSA Exhaust System:

NOTE: Apply the anti-seize lubricant (supplied) to the threads **ONLY** of all the clamps and flange bolts. Failure to follow this procedure can cause nuts to seize on clamps and potentially destroy threads. After applying anti-seize lubricant, be sure to thoroughly clean hands as lubricant will tarnish stainless steel. All clamps should be tightened using a properly calibrated Torque Wrench. Using an air impact gun will damage the clamp and reduce its ability to effectively seal the joint. It may also cause the joint to separate thereby causing damage to your exhaust system and your vehicle.



NOTE: IMPORTANT-Make sure that the small drain or weep hole in muffler faces down when muffler is installed.

1. Locate the CORSA head-pipe assembly, slide a supplied 2-1/2" Torca clamp on the inlet end and slide onto the stock system. Pre-tighten the Torca clamp. **(See Figs. A & B)**
NOTE: Align all clamps as shown in clamp alignment diagram.
2. Locate the CORSA muffler and slide a supplied 3" Torca clamp over the inlet of the CORSA muffler. Make sure the drain hole on the muffler is facing towards the floor. Slide the muffler onto the head-pipe and pre-tighten the clamp. **(See Figs. C & D)**
3. Locate the CORSA tailpipe assembly and slide a supplied 3" Torca clamp over the inlet. From the rear of the vehicle, slide the tailpipe over the axle and place the hangers into the factory grommets and insert the pipe over the muffler exit. **(See Figs. E, F and G)**



FIG. A



FIG. B



FIG. C



FIG. D



FIG. E



FIG. F



FIG. G

4. Locate the CORSA tip assembly and slide a supplied 3" Torca clamp over the inlet end.
(See Fig. H)
5. Slide the tip assembly onto the tailpipe and adjust the angle and location of the tip to your liking and pre-tighten the clamp. (See Figs. I & J)
6. Making sure that the muffler stays level, start from the front of the CORSA exhaust system and tighten all clamps to **45 lbs.-ft.** using a torque wrench. This completes the installation of the CORSA exhaust system.
7. **It is strongly recommended that all clamps be checked and tightened after road testing the vehicle. Allow the exhaust system to cool before working on it.**



FIG. H



FIG. I



FIG. J

NOTE: During cold weather start-ups, you may experience an exhaust sound that is deeper and louder in tone than usual. This is temporary and will diminish to normal levels once your engine has reached its normal operating temperature.

NOTE: Immediately following the installation of your CORSA exhaust system, you may experience a trace of smoke after initial start-up. DO NOT be alarmed. The smoke is caused by the burning of a small amount of forming oil residue used in the manufacturing process.

If you have any questions about the installation process, call CORSA Performance and ask one of our Sales & Technical Service Representatives. Do not attempt to make any modifications to parts as this will void your warranty.