

INSTALLATION INSTRUCTIONS

⚠ WARNING: DO NOT EXCEED PRODUCT RATING OR TOW VEHICLE LAMP LOAD RATING, WHICHEVER IS LOWER

APPLICATIONS

Make	Model
Ram	ProMaster

CUSTOM WIRING HARNESS

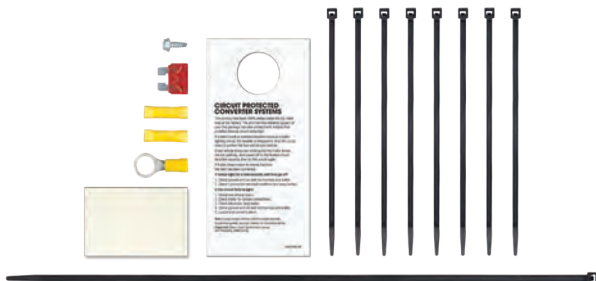
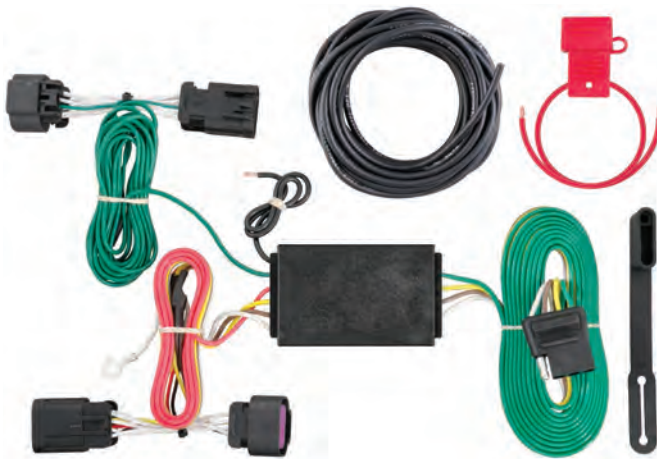

WIRING LOCATION GUIDE

SUVs, MINI & FULL-SIZED VANS (S)

Representative vehicle shown below

S3 - Behind driver side rear access panel

S4 - Behind passenger side rear access panel



NOTICE

All steps must be followed to ensure the wiring harness will function properly. Once installed, test for proper function by using a test light or connecting a properly wired trailer.

TOOLS NEEDED

Flat blade screwdriver

Phillips screwdriver

⚠ WARNING

The battery connection must be fuse-protected, 10-amp max. Exceeding the product rating can cause loss of warranty, overheating and potential fire. Do not exceed product rating or tow vehicle lamp load rating, whichever is lower.

Signal Circuits - 7.5 amps per side

Tail / Running Circuits - 7.5 amps total

Check vehicle owner's manual or contact the vehicle manufacturer for more information.

INSTALLATION / SAFETY INSTRUCTIONS

Step 1

Locate the vehicle battery under the driver side floor panel. Turn the six fasteners securing the floor panel and remove the panel to disconnect the negative battery terminal (A,B).

Step 2

Open the rear cargo doors. Starting on the driver side, remove the seven Phillips screws from the plastic cover to locate the vehicle taillight wiring harness connectors (C). The connectors will be similar to those on the custom wiring harness. Separate the connectors from the taillight housing taking care not to damage the locking tabs (D).

Step 3

Insert the custom wiring harness end with yellow wire between the separated connectors. Make sure the connectors are fully inserted with locking tabs in place (E).

Step 4

Locate a suitable grounding point near the connector such as an existing screw with nut in the vehicle frame or drill a 3/32" pilot hole for the provided screw. The area should be free of rust, dirt and paint. Secure the white ground wire using the ring terminal and provided screw.

 **WARNING:** Check for miscellaneous items that may be hidden behind or under any surface before drilling to avoid damage and / or personal injury.

Step 5

Route the custom wiring harness end with the green wire to the passenger side through the opening that runs up and over the rear cargo doors. Repeat steps 2-3 on the passenger side using the harness end with the green wire (F).

Step 6

Inside the vehicle on the driver side, locate a flat spot on the upper corner inside the rear cargo door frame to adhere the black converter box using the provided double-sided tape (G).

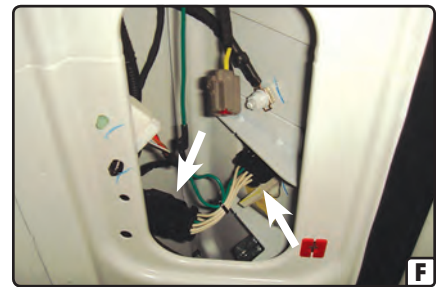
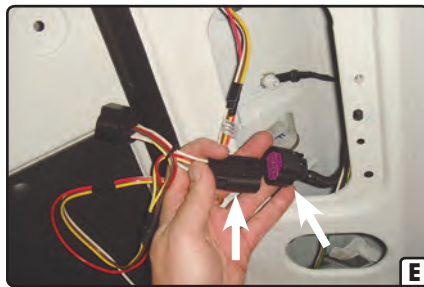
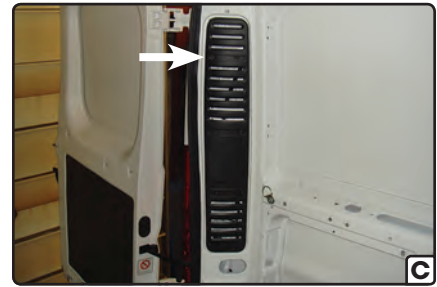
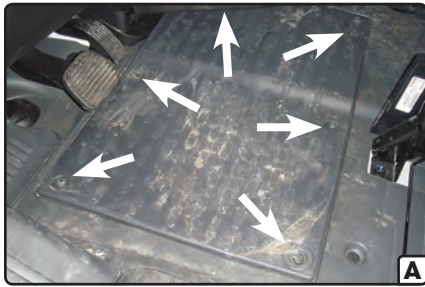

INSTALLATION / SAFETY INSTRUCTIONS

Step 7

Starting on the back side of the driver seat, remove the Phillips screws from the plastic seat belt trim panel (H) and the trim around the driver side seat and floor. Remove all the plastic trim panels (H,I,J,K,L).

Step 8

Route the black power wire from the vehicle battery as shown on the included CME-PCL-INS sheet. Below is a more detailed instruction for this application.

Route the black power wire starting at the wiring harness converter box, along the top of the driver side cargo area and down along the frame located behind the driver seat (M,N,O). Continue from the cargo area along the bottom of the driver side seat frame (O,P,Q,R) and route the power wire under floor panel section to the battery (S).

Step 9

When in use, route the 4-flat to the center of the vehicle and out of the cargo area. When not in use, roll up and store in a convenient, out of the way location inside the trunk. Secure any loose wires with the provided cable ties.

Step 10

Reinstall all items removed during install and reconnect negative battery terminal. Install the provided 4-flat dust cover to help prevent corrosion.

