

11079**00-02 VOLKSWAGEN CABRIO**

11/26/2012

GROSS LOAD CAPACITY WHEN USED AS A WEIGHT CARRYING HITCH: 2,000 LBS. TRAILER WEIGHT & 200 LBS. TONGUE WEIGHT.

*****DO NOT EXCEED VEHICLE MANUFACTURER'S RECOMMENDED TOWING CAPACITY.*******WARNING: ALL NON-TRAILER LOADS APPLIED TO THIS PRODUCT MUST BE SUPPORTED BY 18050 STABILIZING STRAPS.****** FAILURE TO PROPERLY SUPPORT NON-TRAILER LOADS WILL VOID PRODUCT WARRANTY****

HAVING INSTALLATION QUESTIONS? CALL TECHNICAL SUPPORT AT 1-800-798-0813

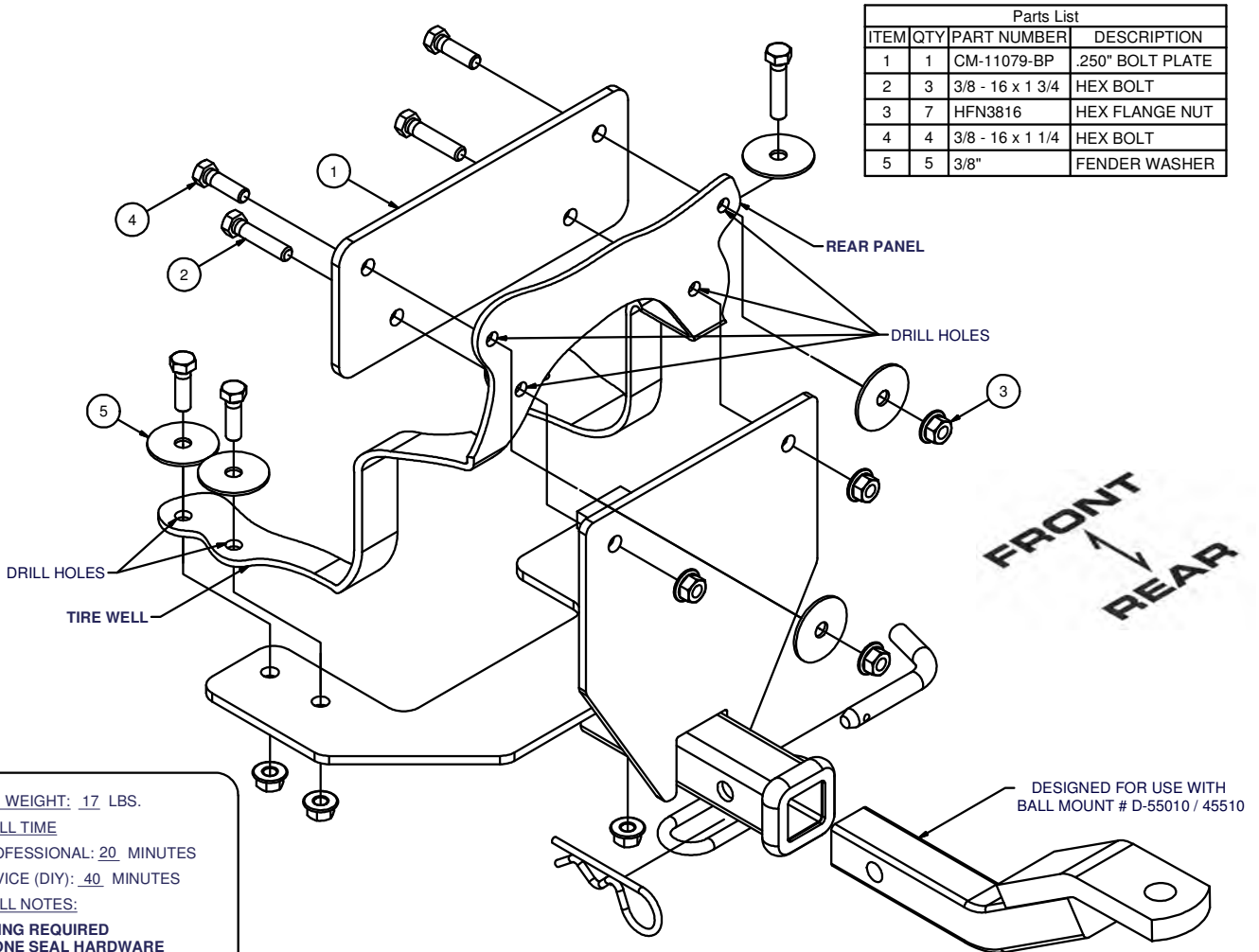

Parts List			
ITEM	QTY	PART NUMBER	DESCRIPTION
1	1	CM-11079-BP	.250" BOLT PLATE
2	3	3/8 - 16 x 1 3/4	HEX BOLT
3	7	HFN3816	HEX FLANGE NUT
4	4	3/8 - 16 x 1 1/4	HEX BOLT
5	5	3/8"	FENDER WASHER

HITCH WEIGHT: 17 LBS.

INSTALL TIME

PROFESSIONAL: 20 MINUTES

NOVICE (DIY): 40 MINUTES

INSTALL NOTES:

- DRILLING REQUIRED
- SILICONE SEAL HARDWARE
- TEMPORARILY REMOVE SPARE TIRE

INSTALLATION STEPS

1. Temporarily remove spare tire and other contents from tire well. Install bolt plate inside tire well against rear panel and between vertical stiffeners. The CM-11079-BP plate rests on the ledge at top of tire well with holes 6" from the bottom edge.
2. Using bolt plate as a template, drill rear panel (4) places for 3/8" fasteners. Mount hitch to outside of rear panel as shown.
3. Using hitch as a template drill bottom of tire well through hitch mounting plate. Install fasteners as shown with fender washers inside of spare tire well.
4. Torque all 3/8" hardware to 45 lb.-ft.
5. Use silicone sealant to seal hardware installed through spare tire well.
6. Reinstall spare tire and other contents removed in Step 1.

PERIODICALLY CHECK THIS RECEIVER HITCH TO ENSURE THAT ALL FASTENERS ARE TIGHT AND THAT ALL STRUCTURAL COMPONENTS ARE SOUND.

Curt Manufacturing Inc., warrants this product to be free of defects in material and/or workmanship at the time of retail purchase by the original purchaser. If the product is found to be defective, Curt Manufacturing Inc., may repair or replace the product, at their option, when the product is returned, prepaid, with proof of purchase. Alteration to, misuse of, or improper installation of this product voids the warranty. Curt Manufacturing Inc.'s liability is limited to repair or replacement of products found to be defective, and specifically excludes liability for incidental or consequential loss or damage.