



Safety glasses should be worn at all times while installing this product.

YEARS: 2012-PRESENT

MAKE: CHEVROLET

MODEL: SONIC

STYLE: SEDAN

WARNING: NEVER EXCEED YOUR VEHICLE MANUFACTURER'S RECOMMENDED TOWING CAPACITY







WEIGHT CARRYING:
 TRAILER WEIGHT: 2000 LBS.
 TONGUE WEIGHT: 200 LBS.

WARNING:
 WE RECOMMEND THE USE OF 18050 STABILIZING STRAPS FOR ALL NON-TRAILER (WHEEL-LESS) LOADS. PLEASE SEE THE CURT CATALOG OR VISIT US ONLINE AT WWW.CURTMFG.COM FOR FURTHER INFORMATION.

INSTALLATION TIME: 20 MIN.

THE INSTALL TIME LISTED IS FOR PROFESSIONAL INSTALLERS. IF YOU ARE HESITANT TO UNDERTAKE THIS TASK ON YOUR OWN, CONTACT AN AUTHORIZED CURT INSTALLER FOR ADDITIONAL ASSISTANCE.



INSTALLATION REQUIRES:

 RATCHET	 11/16" SOCKET	 TORQUE WRENCH
 POWER DRILL	 1" DRILL BIT	 SAFETY GLASSES

INSTALLATION TIPS:

- BEFORE YOU BEGIN INSTALLATION, READ ALL INSTRUCTIONS THOROUGHLY.
- TO EASE INSTALLATION, 2 PEOPLE MAY BE REQUIRED.
- USING PROPER TOOLS WILL GREATLY IMPROVE THE QUALITY OF THE INSTALL AND REDUCE THE TIME REQUIRED.
- NEED HELP OR HAVE SOME QUESTIONS? CALL TECHNICAL SUPPORT AT 800.798.0813

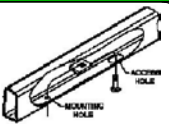
LEVEL OF DIFFICULTY: EASY

EASY	MODERATE	CHALLENGING
	FISHWIRE HARDWARE	
	REVERSE FISHWIRE HARDWARE (2017 MODELS)	
	HOLE ENLARGEMENT REQUIRED	

VEHICLE PHOTO:



REPRESENTATIVE PHOTO

HITCH ILLUSTRATION:

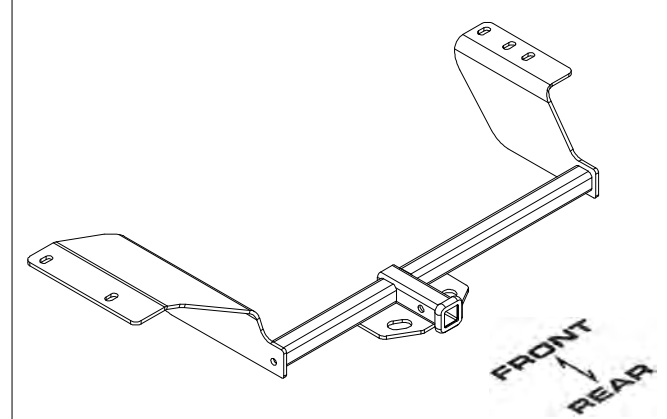

MAKE SURE YOUR HITCH MATCHES

PERIODICALLY CHECK THIS RECEIVER HITCH TO ENSURE ALL FASTENERS ARE TIGHT AND ALL STRUCTURAL COMPONENTS ARE SOUND

CURT Manufacturing LLC. warrants this product to be free of defects in material and/or workmanship at the time of retail purchase by the original purchaser. If the product is found to be defective, Curt Manufacturing LLC. may repair or replace the product at their option, when the product is returned, prepaid, with proof of purchase. Alteration to, misuse of, or improper installation of this product voids the warranty. Curt Manufacturing LLC.'s liability is limited to repair or replacement of products found to be defective, and specifically excludes liability for incidental or consequential loss or damage.

For more information log onto www.curtmfg.com, & for helpful towing tips log onto www.hitchinfo.com

INSTALLATION WALKTHROUGH:

Parts List			
ITEM	QTY	PART NUMBER	DESCRIPTION
1	4	7/16-14 x 1 1/2	CARRIAGE BOLT
2	4	CM-SP2	.250 x .88 x 2.25" SPACER
3	4	7/16-14	HEX FLANGE NUT
4	4	7_16 FISHWIRE	7/16" FISHWIRE

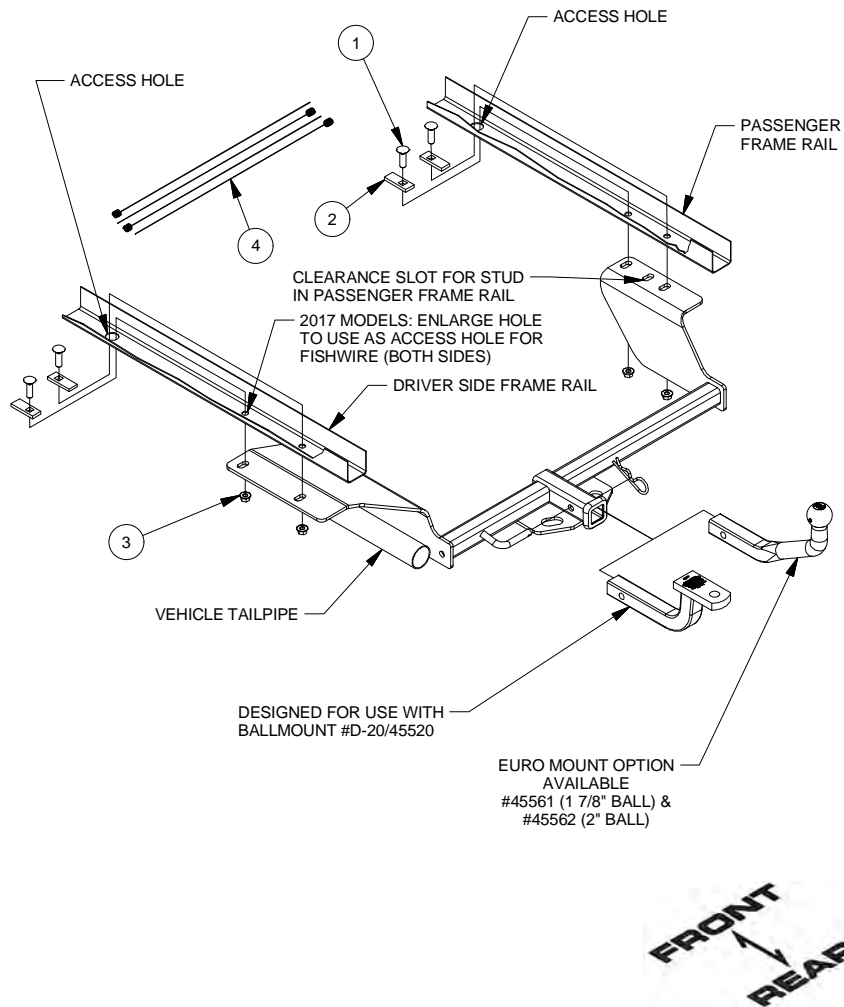

1. Fishwire CM-SP2 spacers and 7/16-14 carriage bolts through access hole in frame rail and down through attachment hole, (2) places, each side.

NOTE: On 2017 models; enlarge forward-most attachment hole to one inch using drill and 1" drill bit. Use as new access hole to fishwire 7/16" carriage bolts and CM-SP2 spacers into the frame rail. Reverse fishwire in access hole to use as attachment point.



2. Raise hitch into position, lifting driver side first over tailpipe, then lifting passenger side.

3. Secure with 7/16" hex flange nuts.

4. Tighten all 7/16-14 fasteners to 70 ft.-lbs.

Installation is complete.

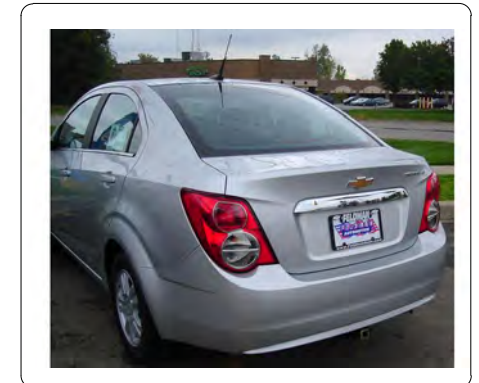
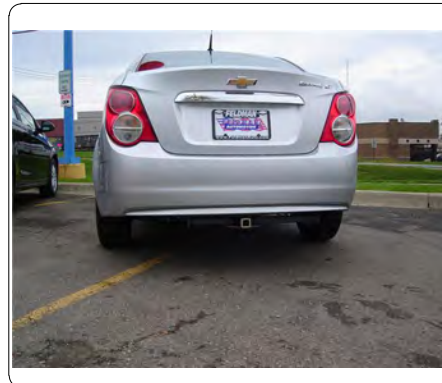

11240

CHEVROLET SONIC SEDAN

1/27/2017

GROSS LOAD CAPACITY WHEN USED AS A WEIGHT CARRYING HITCH: 2000 LBS. TRAILER WEIGHT & 200 LBS. TONGUE WEIGHT.

DO NOT EXCEED VEHICLE MANUFACTURER'S RECOMMENDED TOWING CAPACITY.

WARNING: ALL NON-TRAILER LOADS APPLIED TO THIS PRODUCT MUST BE SUPPORTED BY 18050 STABILIZING STRAPS.

** FAILURE TO PROPERLY SUPPORT NON-TRAILER LOADS WILL VOID PRODUCT WARRANTY**

HAVING INSTALLATION QUESTIONS? CALL TECHNICAL SUPPORT AT 1-800-798-0813

Parts List			
ITEM	QTY	PART NUMBER	DESCRIPTION
1	4	7/16-14	HEX FLANGE NUT
2	4	7/16-14 x 1 1/2	CARRIAGE BOLT
3	4	CM-SP2	.250 x .88 x 2.25" SQUARE HOLE SPACER
4	4	7_16 FISHWIRE	7/16" FISHWIRE

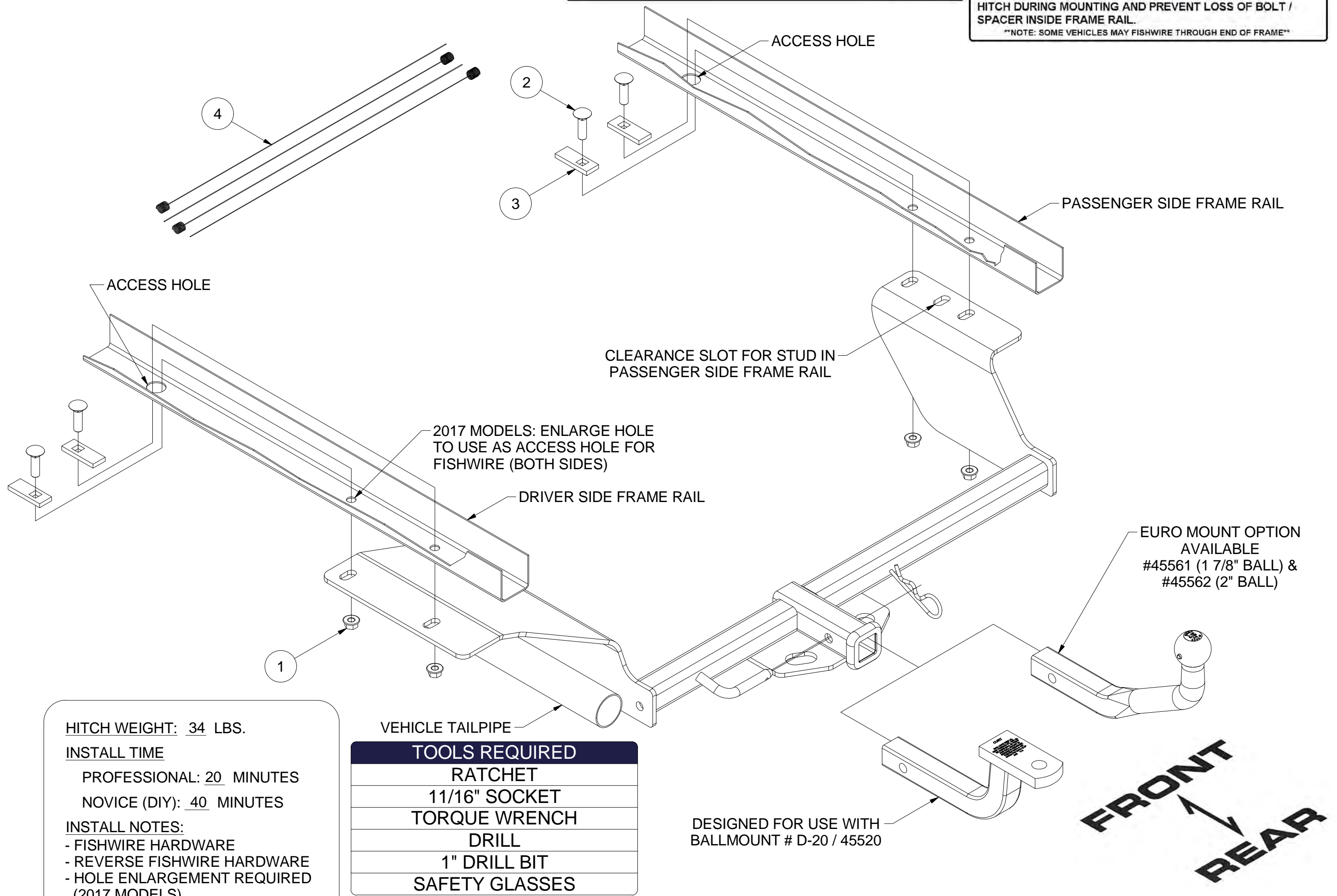
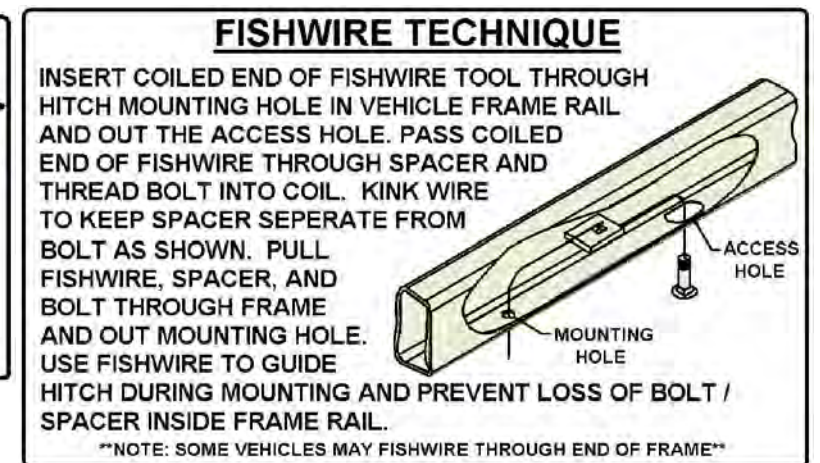
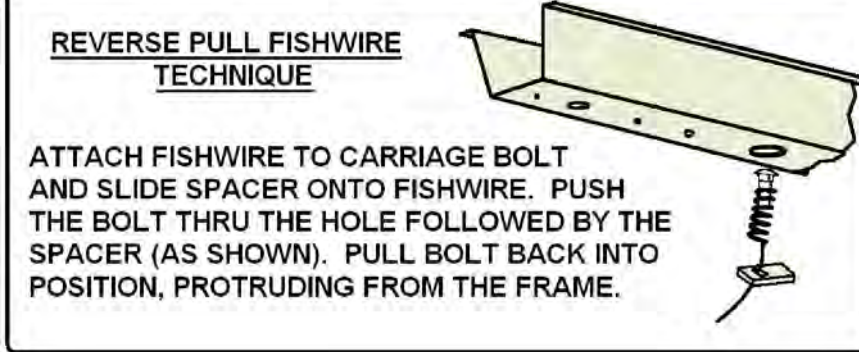

HITCH WEIGHT: 34 LBS.
INSTALL TIME
 PROFESSIONAL: 20 MINUTES
 NOVICE (DIY): 40 MINUTES
INSTALL NOTES:
 - FISHWIRE HARDWARE
 - REVERSE FISHWIRE HARDWARE
 - HOLE ENLARGEMENT REQUIRED (2017 MODELS)

VEHICLE TAILPIPE

TOOLS REQUIRED
RATCHET
11/16" SOCKET
TORQUE WRENCH
DRILL
1" DRILL BIT
SAFETY GLASSES

DESIGNED FOR USE WITH BALLMOUNT # D-20 / 45520



INSTALLATION STEPS

1. Fishwire CM-SP2 spacers and 7/16-14 carriage bolts through access hole in frame rail and down through attachment hole, (2) places, each side.
- NOTE:** On 2017 models; enlarge forward-most attachment hole to one inch using drill and 1" drill bit. Use as new access hole to fishwire 7/16" carriage bolts and CM-SP2 spacers into the frame rail. Reverse fishwire in access hole to use as attachment point.
2. Raise hitch into position, lifting driver side first over tailpipe, then lifting passenger side.
 3. Secure with 7/16" hex flange nuts.
 4. Torque all 7/16-14 fasteners to 70 ft.-lbs.
- PERIODICALLY CHECK THIS RECEIVER HITCH TO ENSURE THAT ALL FASTENERS ARE TIGHT AND THAT ALL STRUCTURAL COMPONENTS ARE SOUND.**

Curt Manufacturing LLC., warrants this product to be free of defects in material and/or workmanship at the time of retail purchase by the original purchaser. If the product is found to be defective, Curt Manufacturing LLC., may repair or replace the product, at their option, when the product is returned, prepaid, with proof of purchase. Alteration to, misuse of, or improper installation of this product voids the warranty. Curt Manufacturing LLC.'s liability is limited to repair or replacement of products found to be defective, and specifically excludes liability for incidental or consequential loss or damage.