

11242 / 247363

98-04 KIA SEPHIA 00-04 KIA SPECTRA

10/15/2012

GROSS LOAD CAPACITY WHEN USED AS A WEIGHT CARRYING HITCH: 2000 LBS. TRAILER WEIGHT & 200 LBS. TONGUE WEIGHT.
*****DO NOT EXCEED VEHICLE MANUFACTURER'S RECOMMENDED TOWING CAPACITY.*****

Parts List			
ITEM	QTY	PART NUMBER	DESCRIPTION
1	4	3/8-16 X 1 1/2	HEX BOLT
2	4	HFN3816	HEX FLANGE NUT
3	2	7/16-14 x 1 1/2	HEX BOLT
4	2	7/16-14	HEX FLANGE NUT
5	1	CM-SP22	.250 x 1.50 x 1.50" ROUND HOLE SPACER
6	2	3/8"	FENDER WASHER
7	1	CM-11242-SP	.25 x 4.00" SPACER

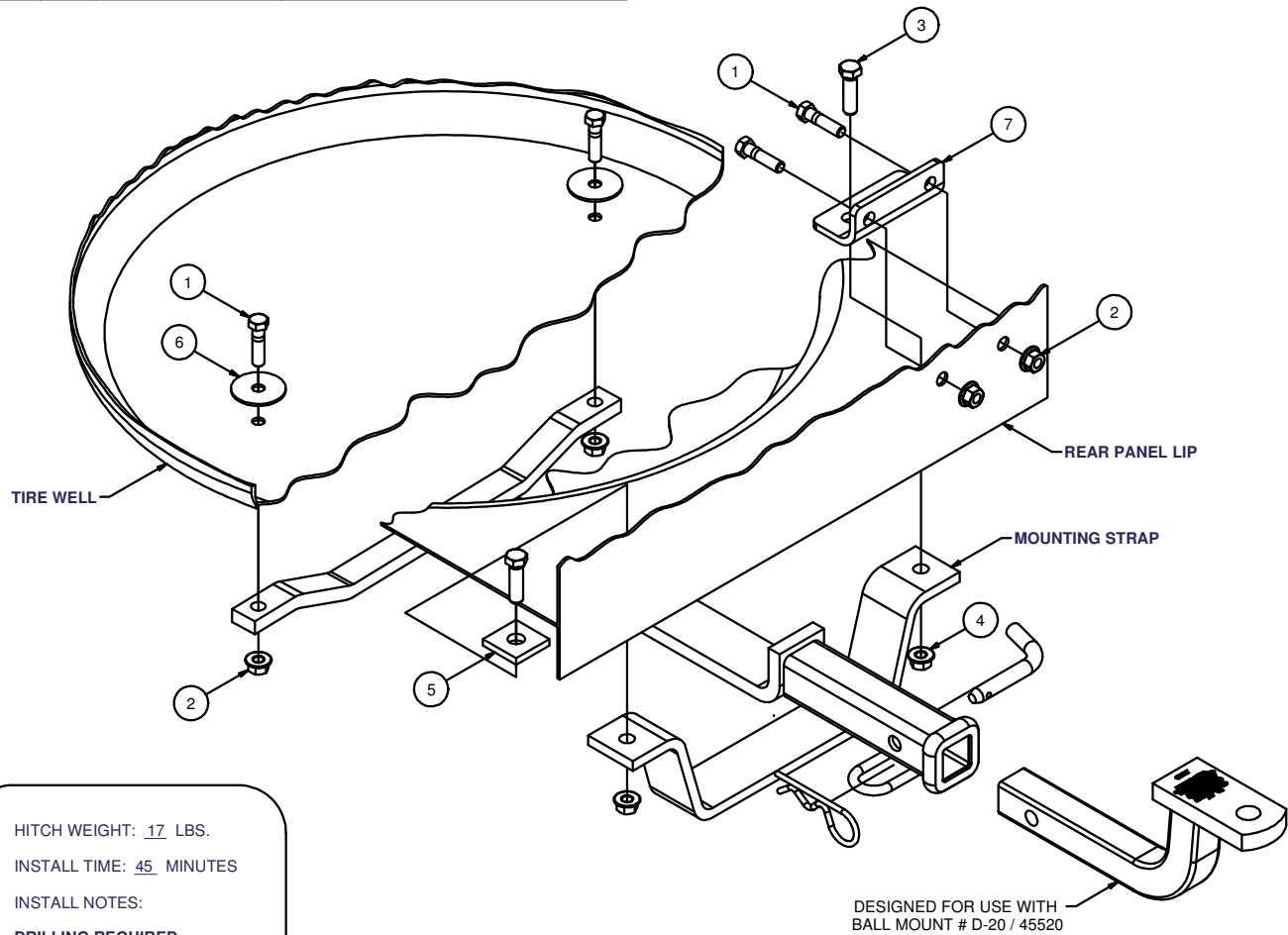
HITCH WEIGHT: 17 LBS.INSTALL TIME: 45 MINUTES

INSTALL NOTES:

DRILLING REQUIRED

INSTALLATION STEPS

- 1) Temporarily remove spare tire. Raise hitch into position, with receiver tube centered left to right on vehicle and rearmost mounting strap against rear panel lip.
- 2) With hitch in position, use hitch as template and drill four holes for fasteners. Loosely install fasteners as shown.
- 3) Using reinforcement plate as template, drill two holes for fasteners into rear panel lip. Install fasteners as shown into rear surface of tire well.
- 4) Torque all 7/16" fasteners to 70 lb.-ft. and all 3/8" fasteners to 45 lb.-ft. Replace spare tire.

PERIODICALLY CHECK THIS RECEIVER HITCH TO ENSURE THAT ALL FASTENERS ARE TIGHT AND THAT ALL STRUCTURAL COMPONENTS ARE SOUND.

Curt Manufacturing Inc., warrants this product to be free of defects in material and/or workmanship at the time of retail purchase by the original purchaser. If the product is found to be defective, Curt Manufacturing Inc., may repair or replace the product, at their option, when the product is returned, prepaid, with proof of purchase. Alteration to, misuse of, or improper installation of this product voids the warranty. Curt Manufacturing Inc.'s liability is limited to repair or replacement of products found to be defective, and specifically excludes liability for incidental or consequential loss or damage.