

11244

## 97-02 MITSUBISHI DIAMANTE SEDAN

12/5/2012

GROSS LOAD CAPACITY WHEN USED AS A WEIGHT CARRYING HITCH: 2,000 LBS. TRAILER WEIGHT &amp; 200 LBS. TONGUE WEIGHT.

\*\*\*DO NOT EXCEED VEHICLE MANUFACTURER'S RECOMMENDED TOWING CAPACITY.\*\*\*

WARNING: ALL NON-TRAILER LOADS APPLIED TO THIS PRODUCT MUST BE SUPPORTED BY AUXILIARY STABILIZING STRAPS.

\*\* FAILURE TO PROPERLY SUPPORT NON-TRAILER LOADS WILL VOID PRODUCT WARRANTY\*\*

HAVING INSTALLATION QUESTIONS? CALL TECHNICAL SUPPORT AT 1-800-798-0813

Parts List

ITEM	QTY	PART NUMBER	DESCRIPTION
1	1	1/2-13	HANDLE NUT
2	1	7_16 - 14 x 1.75" x 1.00" C-C	U-BOLT
3	3	3/8-16 X 1 1/2	HEX BOLT
4	3	3/8"	FENDER WASHER
5	1	1/2-13 x 1 1/4	HEX BOLT
6	1	1/2"	CONICAL TOOTHED WASHER
7	1	7/16"	CONICAL TOOTHED WASHER
8	3	HFN3816	HEX FLANGE NUT
9	1	7/16-14 x 2 1/2	HEX TAP BOLT
10	2	7_16 - 14	NYLOCK HEX NUT

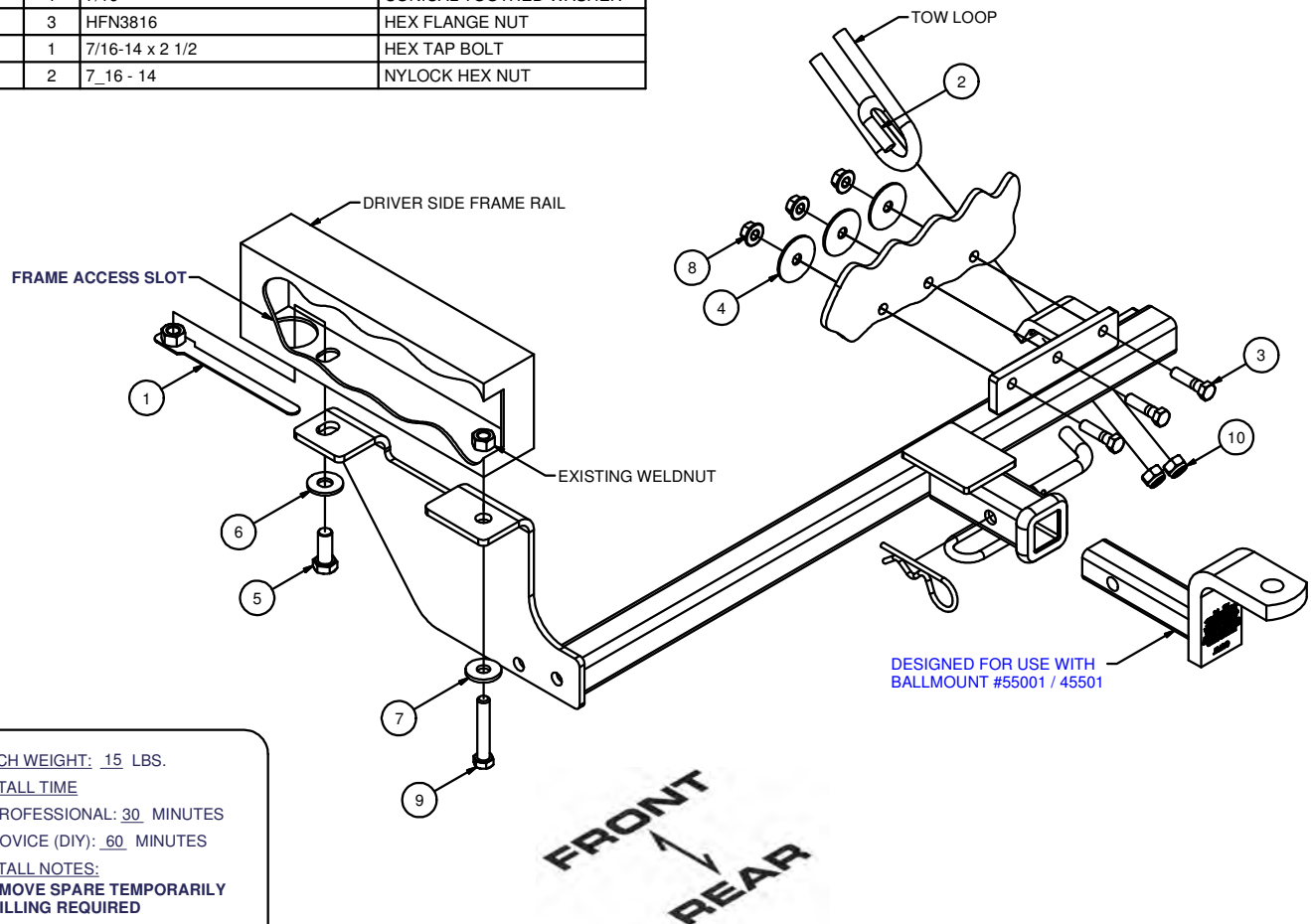
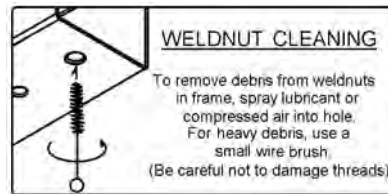

HITCH WEIGHT: 15 LBS.

## INSTALL TIME

PROFESSIONAL: 30 MINUTES

NOVICE (DIY): 60 MINUTES

## INSTALL NOTES:

- REMOVE SPARE TEMPORARILY
- DRILLING REQUIRED

## INSTALLATION STEPS

1. Position hitch on car and mount using fastener at rearmost hole in hitch bracket. Mount hitch at car's tow loop using the u-bolt and nuts. Install fastener in forward hole of hitch bracket placing 1/2" handle nut through access hole just forward of hitch bracket.
2. Using the three hole bracket on hitch main body as a template, drill car's rear panel three places for 3/8" bolts. Install fasteners making certain the large diameter 3/8" fender washers are placed inside rear panel. It may be necessary to push the rear bumper fascia temporarily out of the way to gain access to drill.
3. Torque: 1/2" bolts to 110 ft-lb., 7/16 to 70 ft-lb., M10 bolt to 48 ft-lb., 3/8" bolts to 45 ft-lb.

**PERIODICALLY CHECK THIS RECEIVER HITCH TO ENSURE THAT ALL FASTENERS ARE TIGHT AND THAT ALL STRUCTURAL COMPONENTS ARE SOUND.**

Curt Manufacturing Inc., warrants this product to be free of defects in material and/or workmanship at the time of retail purchase by the original purchaser. If the product is found to be defective, Curt Manufacturing Inc., may repair or replace the product, at their option, when the product is returned, prepaid, with proof of purchase. Alteration to, misuse of, or improper installation of this product voids the warranty. Curt Manufacturing Inc.'s liability is limited to repair or replacement of products found to be defective, and specifically excludes liability for incidental or consequential loss or damage.