

# 11462 MITSUBISHI GALANT SEDAN 2.4L SINGLE EXHAUST

9/11/2009

PAGE 1 of 2

GROSS LOAD CAPACITY WHEN USED AS A WEIGHT CARRYING HITCH: 2,000 LBS. TRAILER WEIGHT & 200 LBS. TONGUE WEIGHT.

\*\*\*DO NOT EXCEED VEHICLE MANUFACTURER'S RECOMMENDED TOWING CAPACITY.\*\*\*

**WARNING: ALL NON-TRAILER LOADS APPLIED TO THIS PRODUCT MUST BE SUPPORTED BY AUXILIARY STABILIZING STRAPS.**

\*\* FAILURE TO PROPERLY SUPPORT NON-TRAILER LOADS WILL VOID PRODUCT WARRANTY\*\*

HAVING INSTALLATION QUESTIONS? CALL TECHNICAL SUPPORT AT 1-800-798-0813

Parts List			
ITEM	QTY	PART NUMBER	DESCRIPTION
1	1	1_2 FISHWIRE	1/2" FISHWIRE
2	2	CM-3802-UBS	3/8-16 x 1.06 x 1.38" C-C U-BOLT
3	1	HFN 1213	HEX FLANGE NUT
4	4	HFN3816	HEX FLANGE NUT
5	1	1/2-13 x 1 1/2	CARRIAGE BOLT
6	1	CM-SP19	.250 x 1.25 x 3.00" SQUARE HOLE SPACER

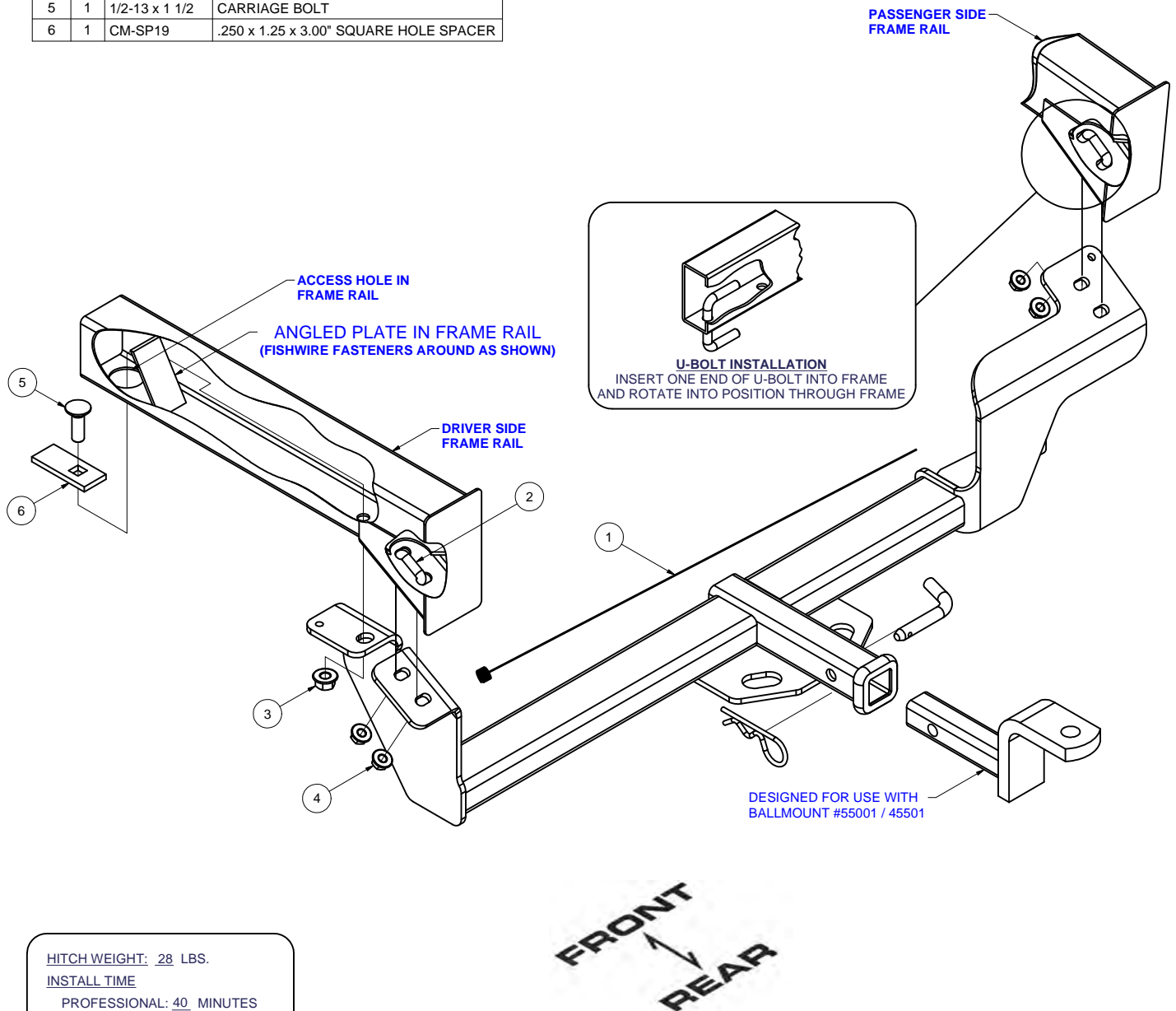

HITCH WEIGHT: 28 LBS.

#### INSTALL TIME

PROFESSIONAL: 40 MINUTES

NOVICE (DIY): 80 MINUTES

#### INSTALL NOTES:

- LOWER EXHAUST
- REMOVE HEAT SHIELD
- FISHWIRING REQUIRED
- NO DRILLING REQUIRED

PERIODICALLY CHECK THIS RECEIVER HITCH TO ENSURE THAT ALL FASTENERS ARE TIGHT AND THAT ALL STRUCTURAL COMPONENTS ARE SOUND.

Curt Manufacturing Inc., warrants this product to be free of defects in material and/or workmanship at the time of retail purchase by the original purchaser. If the product is found to be defective, Curt Manufacturing Inc., may repair or replace the product, at their option, when the product is returned, prepaid, with proof of purchase. Alteration to, misuse of, or improper installation of this product voids the warranty. Curt Manufacturing Inc.'s liability is limited to repair or replacement of products found to be defective, and specifically excludes liability for incidental or consequential loss or damage.

# 11462 MITSUBISHI GALANT SEDAN 2.4L SINGLE EXHAUST

9/11/2009

PAGE 2 of 2

HAVING INSTALLATION QUESTIONS? CALL TECHNICAL SUPPORT AT 1-800-798-0813

## TOOLS REQUIRED

RATCHET
6" EXTENSION
3/4" SOCKET
9/16" SOCKET
12mm SOCKET
10mm SOCKET
TORQUE WRENCH

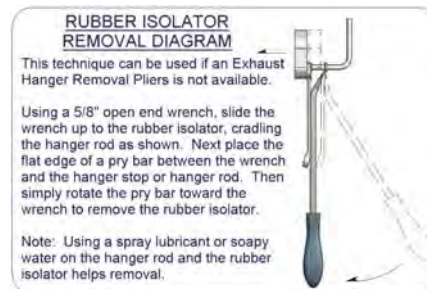
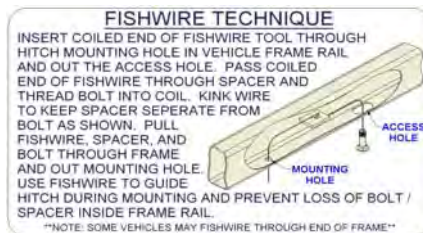

## INSTALLATION STEPS

- 1) Lower exhaust by removing bolt in rear rubber hanger. Remove exhaust heat shield.
  - 2) Fishwire the 1/2" bolt and into position using access hole as shown.
- NOTE: Fishwire bolt through frame on inside of frame rail.
- 3) Place U-bolts into position as shown in the above diagram.
  - 4) Raise hitch into position, being carefull not to push fasteners into frame.
  - 5) Attach hitch with remaining fasteners as shown.
  - 6) Torque all 1/2" fasteners to 75 lb-ft, and all 3/8" fasteners to 30 lb-ft.
  - 7) Re-install heat shield. Raise exhaust into position, and re-install original bolt.

PERIODICALLY CHECK THIS RECEIVER HITCH TO ENSURE THAT ALL FASTENERS ARE TIGHT AND THAT ALL STRUCTURAL COMPONENTS ARE SOUND.