

11476

02-06 MITSUBISHI LANCER

9/11/2009

WILL NOT FIT EVOLUTION

GROSS LOAD CAPACITY WHEN USED AS A WEIGHT CARRYING HITCH: 2,000 LBS. TRAILER WEIGHT & 200 LBS. TONGUE WEIGHT.

DO NOT EXCEED VEHICLE MANUFACTURER'S RECOMMENDED TOWING CAPACITY.

WARNING: ALL NON-TRAILER LOADS APPLIED TO THIS PRODUCT MUST BE SUPPORTED BY AUXILIARY STABILIZING STRAPS.

** FAILURE TO PROPERLY SUPPORT NON-TRAILER LOADS WILL VOID PRODUCT WARRANTY**

HAVING INSTALLATION QUESTIONS? CALL TECHNICAL SUPPORT AT 1-800-798-0813

Parts List				
ITEM	QTY	PART NUMBER	DESCRIPTION	
1	1	CM-438-FW	7/16" FISHWIRE TOOL	
2	1	7/16-14 x 1 1/2	CARRIAGE BOLT	
3	3	HFN 1213	HEX FLANGE NUT	
4	1	7/16-14	HEX FLANGE NUT	
5	1	CM-SP22	.250 x 1.50 x 1.50" ROUND HOLE SPACER	
6	1	CM-SP40	.188 x 1.00 x 3.00" SQUARE HOLE SPACER	
7	1	1/2-13 x 1 3/4	CARRIAGE BOLT	
8	2	1/2 - 13 x 1 1/2	HEX BOLT	

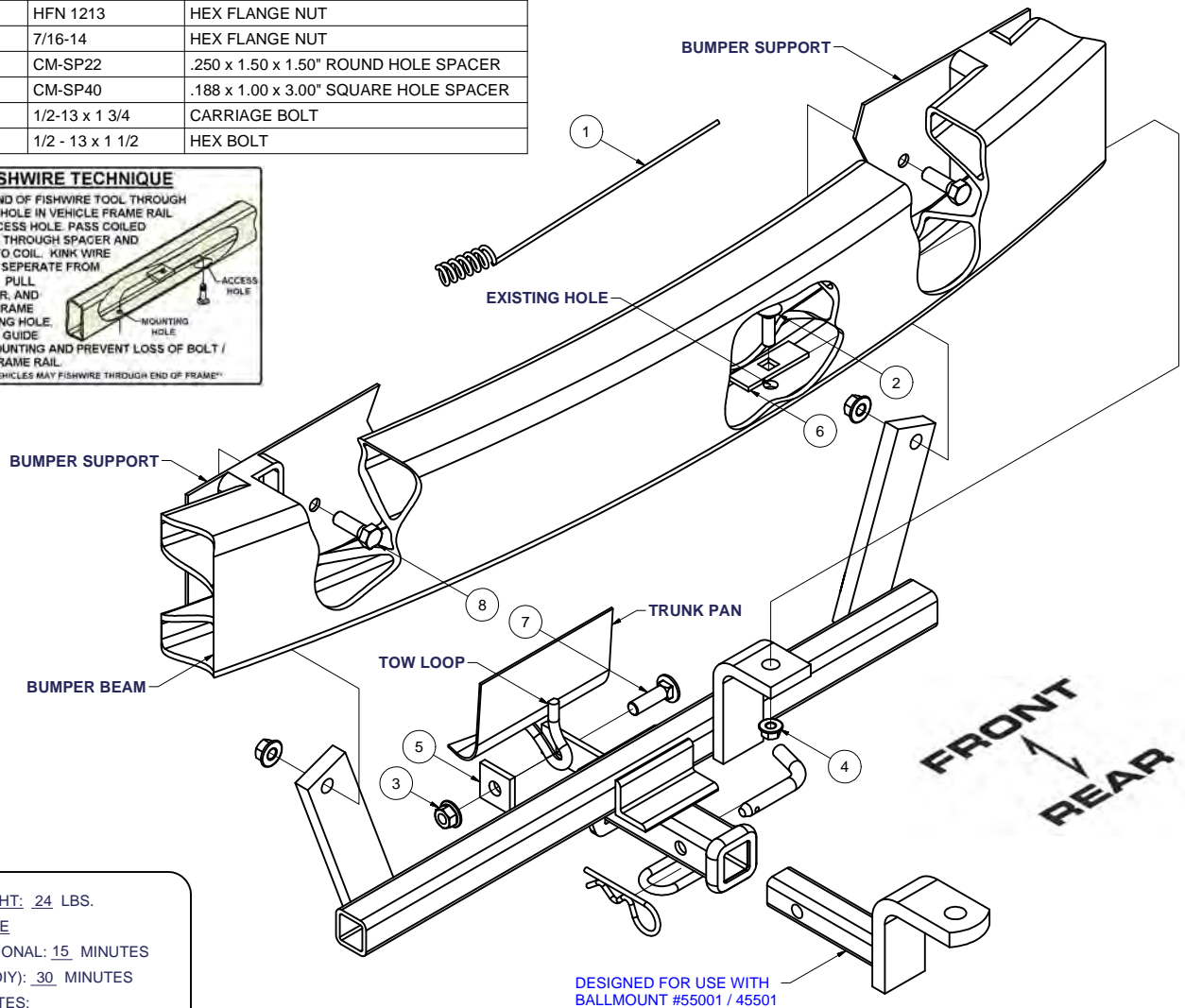
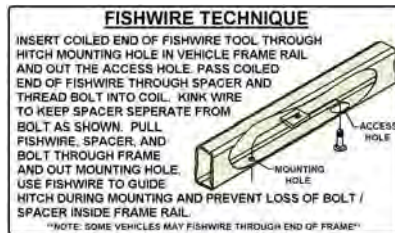

HITCH WEIGHT: 24 LBS.

INSTALL TIME

PROFESSIONAL: 15 MINUTES

NOVICE (DIY): 30 MINUTES

INSTALL NOTES:

-NO DRILLING REQ.

-FISHWIRE FASTENERS

INSTALLATION STEPS

- 1) Fishwire 7/16" carriage bolt and spacer through end of bumper beam and out existing hole as shown.
- 2) Raise hitch into position and secure with 1/2" hex bolts, flange nuts and 7/16" flange nut, finger tight.
- 3) Secure hitch to tow loop using 1/2" carriage bolt, spacer, and flange nut as shown.
- 4) Torque all 1/2" fasteners to 75 lb-ft. and all 7/16" fasteners to 50 lb-ft.

PERIODICALLY CHECK THIS RECEIVER HITCH TO ENSURE THAT ALL FASTENERS ARE TIGHT AND THAT ALL STRUCTURAL COMPONENTS ARE SOUND.

Curt Manufacturing Inc., warrants this product to be free of defects in material and/or workmanship at the time of retail purchase by the original purchaser. If the product is found to be defective, Curt Manufacturing Inc., may repair or replace the product, at their option, when the product is returned, prepaid, with proof of purchase. Alteration to, misuse of, or improper installation of this product voids the warranty. Curt Manufacturing Inc.'s liability is limited to repair or replacement of products found to be defective, and specifically excludes liability for incidental or consequential loss or damage.