

11503**86-89 ACURA INTEGRA**

12/10/2012

GROSS LOAD CAPACITY WHEN USED AS A WEIGHT CARRYING HITCH: 1,000 LBS. TRAILER WEIGHT & 100 LBS. TONGUE WEIGHT.

*****DO NOT EXCEED VEHICLE MANUFACTURER'S RECOMMENDED TOWING CAPACITY.*****

WARNING: ALL NON-TRAILER LOADS APPLIED TO THIS PRODUCT MUST BE SUPPORTED BY 18050 STABILIZING STRAPS.

**** FAILURE TO PROPERLY SUPPORT NON-TRAILER LOADS WILL VOID PRODUCT WARRANTY****

HAVING INSTALLATION QUESTIONS? CALL TECHNICAL SUPPORT AT 1-800-798-0813

Parts List			
ITEM	QTY	PART NUMBER	DESCRIPTION
1	2	HFN3816	HEX FLANGE NUT
2	2	3/8-16 x 3	HEX BOLT
3	4	3/8 - 16 x 1 1/4	HEX BOLT
4	4	3/8"	FENDER WASHER
5	4	3/8"	LOCK WASHER
6	4	3/8 - 16	HEX NUT

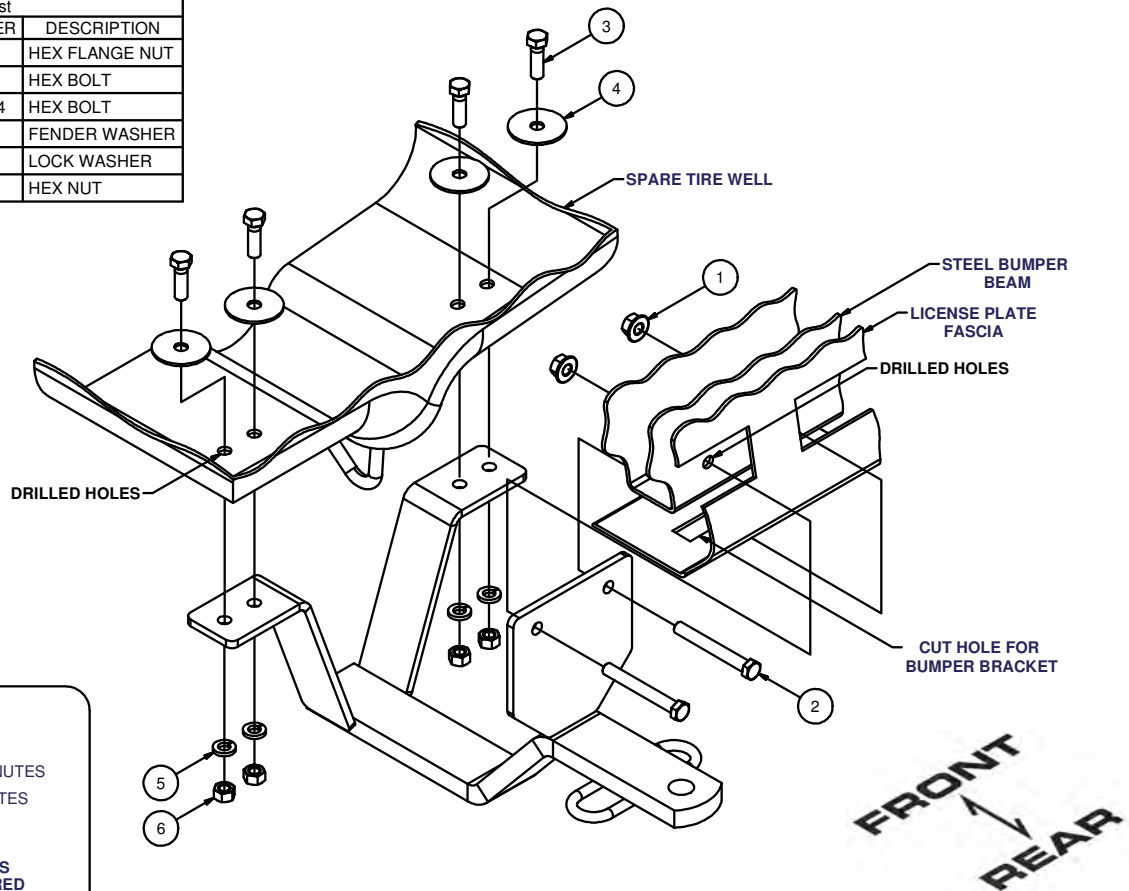
HITCH WEIGHT: 11 LBS.INSTALL TIMEPROFESSIONAL: 45 MINUTESNOVICE (DIY): 90 MINUTESINSTALL NOTES:

- DRILLING REQUIRED
- CLEAR TRUNK CONTENTS
- FACIA TRIMMING REQUIRED
- SILICONE SEAL HARDWARE

INSTALLATION STEPS

1. Locate and mark the vehicle's centerline on the rear steel bumper beam (visible in license plate area). Clear all contents in the trunk where the floor holes will be drilled.
2. A slot approximately 1/2" x 5 1/2" must be cut into the license plate fascia using a sharp utility knife. Locate the slot to fit the hitch bumper plate through the slot.
3. Raise hitch into position, center and square with the vehicle. Using the hitch as a template, mark and centerpunch the bumper beam (2) places and spare tire well (4) places for the hitch fasteners.
4. Drill the holes for 3/8" diameter fasteners.
5. Install the hitch using fasteners as shown above. Notice fender washers are placed inside of the vehicle, opposite the hitch. Tighten the lock nuts only until the bumper beam starts to compress.
6. Torque all 3/8" fasteners to 45 lb-ft.
7. Silicone seal hardware that is installed through spare tire well.
8. Reinstall contents removed in Step 1.

PERIODICALLY CHECK THIS RECEIVER HITCH TO ENSURE THAT ALL FASTENERS ARE TIGHT AND THAT ALL STRUCTURAL COMPONENTS ARE SOUND.

Curt Manufacturing Inc., warrants this product to be free of defects in material and/or workmanship at the time of retail purchase by the original purchaser. If the product is found to be defective, Curt Manufacturing Inc., may repair or replace the product, at their option, when the product is returned, prepaid, with proof of purchase. Alteration to, misuse of, or improper installation of this product voids the warranty. Curt Manufacturing Inc.'s liability is limited to repair or replacement of products found to be defective, and specifically excludes liability for incidental or consequential loss or damage.