

11515**78-86 BMW 7-SERIES SEDAN**

12/17/2012

GROSS LOAD CAPACITY WHEN USED AS A WEIGHT CARRYING HITCH: 1,500 LBS. TRAILER WEIGHT & 150 LBS. TONGUE WEIGHT.

*****DO NOT EXCEED VEHICLE MANUFACTURER'S RECOMMENDED TOWING CAPACITY.*****

WARNING: ALL NON-TRAILER LOADS APPLIED TO THIS PRODUCT MUST BE SUPPORTED BY 18050 STABILIZING STRAPS.

**** FAILURE TO PROPERLY SUPPORT NON-TRAILER LOADS WILL VOID PRODUCT WARRANTY****

HAVING INSTALLATION QUESTIONS? CALL TECHNICAL SUPPORT AT 1-800-798-0813

Parts List			
ITEM	QTY	PART NUMBER	DESCRIPTION
1	4	3/8 - 16 x 1 1/4	HEX BOLT
2	4	3/8"	FENDER WASHER
3	4	3/8"	LOCK WASHER
4	4	3/8 - 16	HEX NUT
5	1	M12 - 1.75 x 50mm	HEX BOLT
6	1	7/16 WASHER	WASHER
7	1	1/2"	LOCK WASHER
8	1	M12 - 1.75	HEX NUT

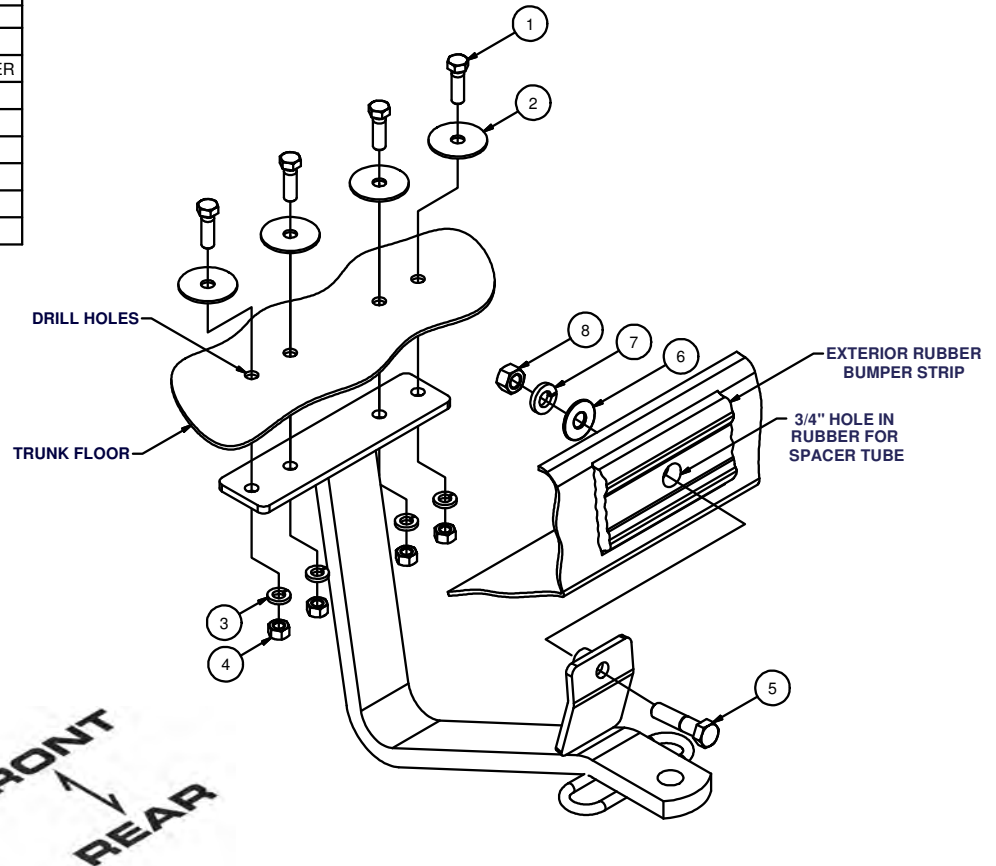

HITCH WEIGHT: 11 LBS.

INSTALL TIME

PROFESSIONAL: 45 MINUTES

NOVICE (DIY): 90 MINUTES

INSTALL NOTES:

- TRIM BUMPER STRIP
- CLEAR TRUNK
- DRILLING REQUIRED
- SILICONE SEAL HARDWARE

INSTALLATION STEPS

1. Fasten the hitch with (1) 12mm bolt to the center of the rear bumper without removing the rubber bumper strip. First, locate the existing hole at the center of the metal part of the rear bumper. This hole may be located by looking inside the bumper. Make a 3/4" hole in the rubber strip centered on the existing hole.

NOTE: On early models, a permanent 12mm nut is provided in place of the existing hole. Make matching 3/4" hole in the rubber as before and discard the 12mm nut and flat washer provided with the hitch. Use the 7/16" lock washer under the head of the 12mm bolt.

2. Clear the trunk and lift the floor covering in the trunk. Using the hitch as a template, drill the vehicle floor (4) places for 3/8" hardware.
3. Install fasteners as shown, making sure fender washers are placed inside the vehicle, opposite the hitch.
4. Torque all 3/8" fasteners to 45 lb-ft, and 12mm fastener to 79 lb-ft.
5. Use silicone sealant to seal hardware installed through trunk floor.
6. Reinstall contents removed in Step 2.

PERIODICALLY CHECK THIS RECEIVER HITCH TO ENSURE THAT ALL FASTENERS ARE TIGHT AND THAT ALL STRUCTURAL COMPONENTS ARE SOUND.

Curt Manufacturing Inc., warrants this product to be free of defects in material and/or workmanship at the time of retail purchase by the original purchaser. If the product is found to be defective, Curt Manufacturing Inc., may repair or replace the product, at their option, when the product is returned, prepaid, with proof of purchase. Alteration to, misuse of, or improper installation of this product voids the warranty. Curt Manufacturing Inc.'s liability is limited to repair or replacement of products found to be defective, and specifically excludes liability for incidental or consequential loss or damage.

217215