

11516**87-94 BMW 7-SERIES SEDAN**

12/10/2012

GROSS LOAD CAPACITY WHEN USED AS A WEIGHT CARRYING HITCH: 1,000 LBS. TRAILER WEIGHT & 100 LBS. TONGUE WEIGHT.

*****DO NOT EXCEED VEHICLE MANUFACTURER'S RECOMMENDED TOWING CAPACITY.*****

WARNING: ALL NON-TRAILER LOADS APPLIED TO THIS PRODUCT MUST BE SUPPORTED BY 18050 STABILIZING STRAPS.

**** FAILURE TO PROPERLY SUPPORT NON-TRAILER LOADS WILL VOID PRODUCT WARRANTY****

HAVING INSTALLATION QUESTIONS? CALL TECHNICAL SUPPORT AT 1-800-798-0813

Parts List			
ITEM	QTY	PART NUMBER	DESCRIPTION
1	2	3/8 - 16 x 4	HEX BOLT
2	2	HFN3816	HEX FLANGE NUT
3	4	3/8 - 16 x 1 1/4	HEX BOLT
4	4	3/8"	LOCK WASHER
5	4	3/8 - 16	HEX NUT

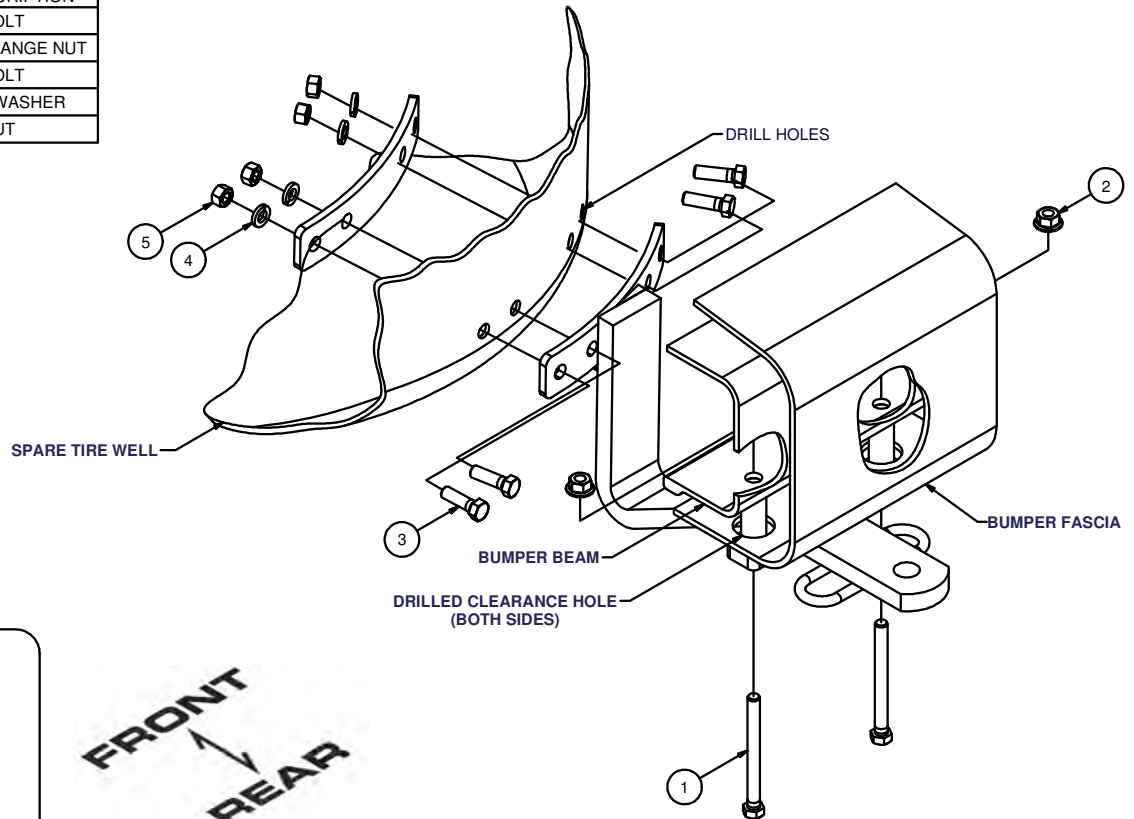

HITCH WEIGHT: 11 LBS.

INSTALL TIME

PROFESSIONAL: 45 MINUTES

NOVICE (DIY): 90 MINUTES

INSTALL NOTES:

- DRILLING REQUIRED
- CLEAR SPARE TIRE WELL
- SILICONE SEAL HARDWARE

INSTALLATION STEPS

1. This hitch mounts to the vehicle's spare tire well and to the aluminum bumper beam found inside the rear plastic bumper fascia. A hole saw is recommended for two clearance holes in fascia under the bumper beam.
2. Remove spare tire and other contents from spare tire well.
3. Hold the hitch centered on the vehicle with the curved hitch bracket against the vertical wall of the spare tire well. Mark and drill the bumper fascia for two clearance holes for the hitch spacer tubes using 1" diameter or larger hole saw.
Note: The curved bracket may be close or in contact with the vehicle's fuel tank strap.
4. Raise the hitch into position and carefully mark the bumper beam and tire well for mounting holes. Center punch and drill the bumper beam two places for 3/8" fasteners.
5. Mount the hitch using fasteners as shown.
6. Torque all 3/8" fasteners to 45 lb-ft.
7. Use silicone sealant to seal hardware installed through spare tire well.
8. Reinstall spare tire and other contents removed in Step 2.

PERIODICALLY CHECK THIS RECEIVER HITCH TO ENSURE THAT ALL FASTENERS ARE TIGHT AND THAT ALL STRUCTURAL COMPONENTS ARE SOUND.

Curt Manufacturing Inc., warrants this product to be free of defects in material and/or workmanship at the time of retail purchase by the original purchaser. If the product is found to be defective, Curt Manufacturing Inc., may repair or replace the product, at their option, when the product is returned, prepaid, with proof of purchase. Alteration to, misuse of, or improper installation of this product voids the warranty. Curt Manufacturing Inc.'s liability is limited to repair or replacement of products found to be defective, and specifically excludes liability for incidental or consequential loss or damage.