

**11566****87-93 FORD FESTIVA**

12/7/2012

GROSS LOAD CAPACITY WHEN USED AS A WEIGHT CARRYING HITCH: 1,000 LBS. TRAILER WEIGHT &amp; 100 LBS. TONGUE WEIGHT.

**\*\*\*DO NOT EXCEED VEHICLE MANUFACTURER'S RECOMMENDED TOWING CAPACITY.\*\*\*****WARNING: ALL NON-TRAILER LOADS APPLIED TO THIS PRODUCT MUST BE SUPPORTED BY 18050 STABILIZING STRAPS.****\*\* FAILURE TO PROPERLY SUPPORT NON-TRAILER LOADS WILL VOID PRODUCT WARRANTY\*\***

HAVING INSTALLATION QUESTIONS? CALL TECHNICAL SUPPORT AT 1-800-798-0813

Parts List			
ITEM	QTY	PART NUMBER	DESCRIPTION
1	4	3/8 - 16	HEX NUT
2	4	3/8"	LOCK WASHER
3	4	3/8 - 16 x 1 1/4	HEX BOLT
4	4	3/8"	FENDER WASHER
5	2	7/16-14 x 1.63 x 2.50 C-C	SQ. U-BOLT
6	4	7/16 LOCK WASHER	HELICAL LOCK WASHER
7	4	7/16-14	HEX NUT

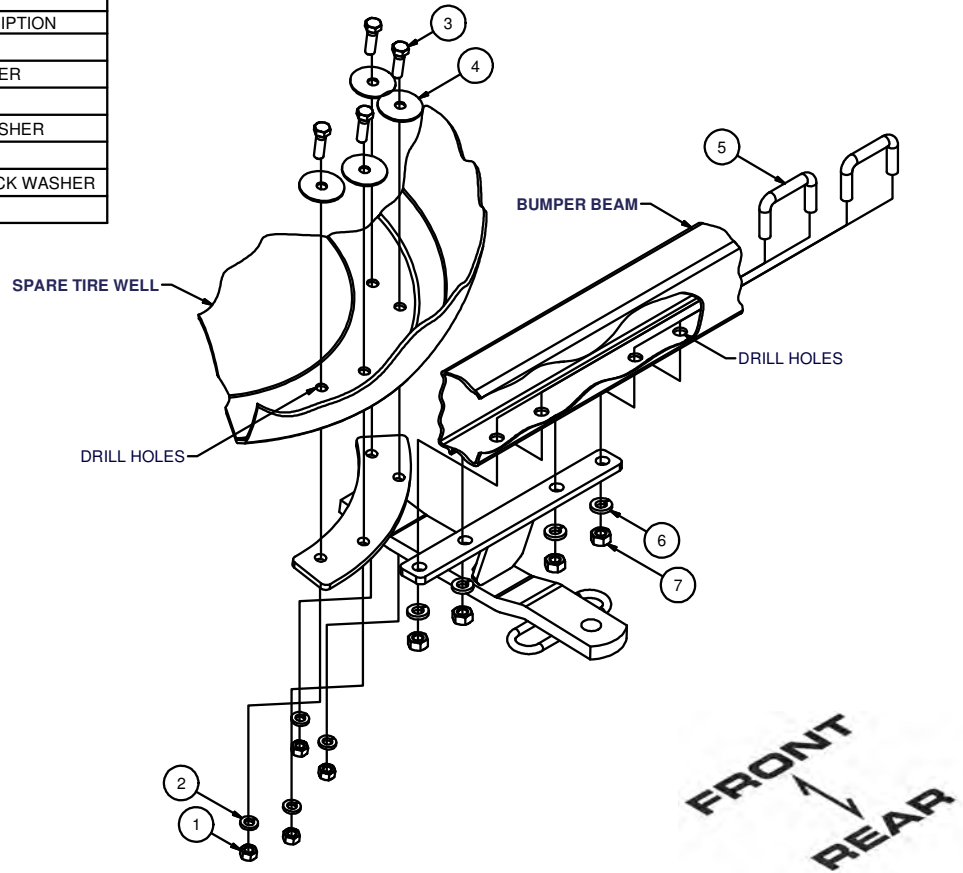
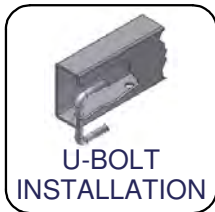
HITCH WEIGHT: 9 LBS.**INSTALL TIME**PROFESSIONAL: 45 MINUTESNOVICE (DIY): 90 MINUTES**INSTALL NOTES:**

- DRILLING REQUIRED
- TEMP. REMOVE SPARE TIRE
- SILICONE SEAL HARDWARE
- TRIM BUMPER FASCIA

**INSTALLATION STEPS**

1. Temporarily remove the spare tire from the tire well. Loosen the bumper fascia material from the inner beam and trim fascia to fit the hitch bracket to the bottom of the beam as shown. The hitch will also fit up against the bottom of the spare tire well.
2. Make sure the hitch is centered and square on the vehicle. Check the hitch ball/bumper clearance. Using the hitch as a template, drill the bumper (4) places 1/2" diameter for rectangular U-bolts. Drill the tire well (4) places for 3/8" diameter bolts.
3. Place the rectangular U-bolts into the bumper beam as shown.
4. Place the hitch over the (2) U-bolts in the bumper and fasten to the vehicle as shown. Fender washers must be placed inside the spare tire well opposite the hitch.
5. Torque all 3/8" fasteners to 45 lb-ft, and all 7/16" fasteners to 70 lb-ft. NOTE: Do not use impact wrench on U-bolts.
6. Use silicone sealant to seal hardware installed through spare tire well.
7. Reinstall spare tire.

**PERIODICALLY CHECK THIS RECEIVER HITCH TO ENSURE THAT ALL FASTENERS ARE TIGHT AND THAT ALL STRUCTURAL COMPONENTS ARE SOUND.**

Curt Manufacturing Inc., warrants this product to be free of defects in material and/or workmanship at the time of retail purchase by the original purchaser. If the product is found to be defective, Curt Manufacturing Inc., may repair or replace the product, at their option, when the product is returned, prepaid, with proof of purchase. Alteration to, misuse of, or improper installation of this product voids the warranty. Curt Manufacturing Inc.'s liability is limited to repair or replacement of products found to be defective, and specifically excludes liability for incidental or consequential loss or damage.