

11605

'90 MAZDA PROTEGE, SEDAN 2 WD ONLY
 '91-'96 FORD ESCORT / MERCURY TRACER SEDAN AND HATCHBACK (INCL. GT)
 '91-'97 FORD ESCORT / MERCURY TRACER WAGON

3/25/2013

GROSS LOAD CAPACITY WHEN USED AS A WEIGHT CARRYING HITCH: 2,000 LBS. TRAILER WEIGHT & 200 LBS. TONGUE WEIGHT.

*****DO NOT EXCEED VEHICLE MANUFACTURER'S RECOMMENDED TOWING CAPACITY.*****

WARNING: ALL NON-TRAILER LOADS APPLIED TO THIS PRODUCT MUST BE SUPPORTED BY 18050 STABILIZING STRAPS.

**** FAILURE TO PROPERLY SUPPORT NON-TRAILER LOADS WILL VOID PRODUCT WARRANTY****

HAVING INSTALLATION QUESTIONS? CALL TECHNICAL SUPPORT AT 1-800-798-0813

		Parts List	
ITEM	QTY	PART NUMBER	DESCRIPTION
1	2	CM-SP51	.250 x 1.50 x 3.50" ROUND HOLE SPACER
2	2	7_16 - 14	NYLOCK HEX NUT
3	2	7_16 - 14 x 4 1_2 HEX	HEX BOLT
4	2	7/16 WASHER	WASHER
5	2	5_8 - 11 x 2 HEX	HEX TAP BOLT
6	2	5/8"	WASHER WIDE
7	2	5_8 LOCK WASHER	5/8" HELICAL LOCK WASHER
8	2	5_8 - 11 HEX-NUT	5/8" 11 UNC HEX NUT

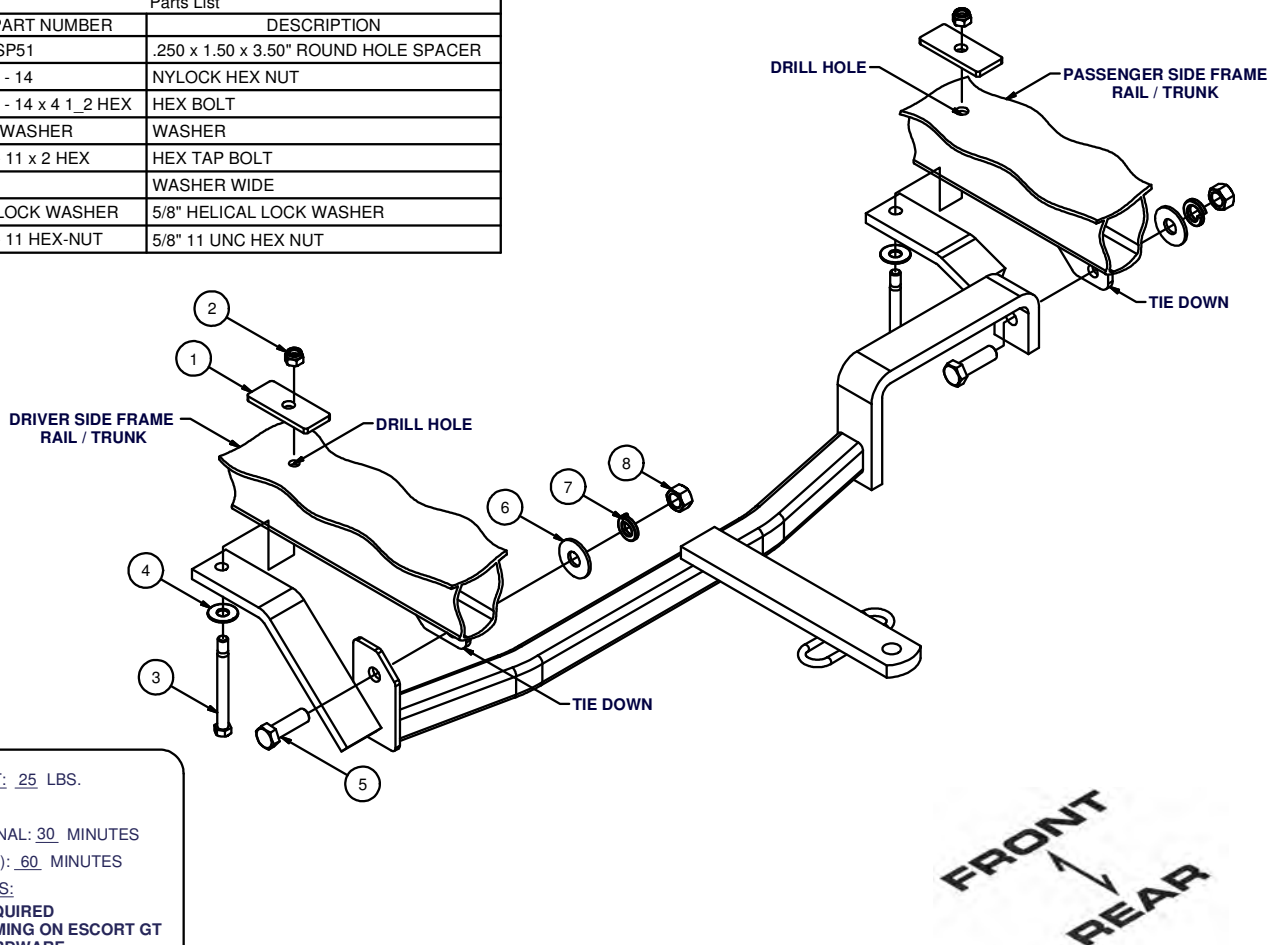

HITCH WEIGHT: .25 LBS.

INSTALL TIME

PROFESSIONAL: .30 MINUTES

NOVICE (DIY): .60 MINUTES

INSTALL NOTES:

- DRILLING REQUIRED
- FASCIA TRIMMING ON ESCORT GT
- SILICONE HARDWARE
- CLEAR TRUNK OF CONTENTS

INSTALLATION STEPS

1. Raise hitch into position under vehicle locating the driver side tie down inside the the hitch and the passenger side tie down on the outside of the hitch. Loosely install the 5/8" fasteners into the tow loops as shown.

Note: Ford Escort GT model may require some fascia trimming at bottom edge of bumper.

2. Clear trunk of contents in preparation to drill through the frame rails. Adjust hitch for best fit against the bottom of the frame rails. Using the hitch as a template, drill (2) holes through frame rails and into trunk for 7/16" fasteners.
3. Install 7/16" fasteners and spacers. Install the CM-SP51 backing plates inside the trunk of the vehicle. Tighten 7/16" fasteners only until the sheet metal begins to compress.
4. Torque all 5/8" fasteners to 210 ft-lbs.
5. Use silicone sealant around the hardware in the trunk to seal out water and exhaust fumes.
6. Reinstall trunk contents removed in step 2.

PERIODICALLY CHECK THIS RECEIVER HITCH TO ENSURE THAT ALL FASTENERS ARE TIGHT AND THAT ALL STRUCTURAL COMPONENTS ARE SOUND.

Curt Manufacturing Inc., warrants this product to be free of defects in material and/or workmanship at the time of retail purchase by the original purchaser. If the product is found to be defective, Curt Manufacturing Inc., may repair or replace the product, at their option, when the product is returned, prepaid, with proof of purchase. Alteration to, misuse of, or improper installation of this product voids the warranty. Curt Manufacturing Inc.'s liability is limited to repair or replacement of products found to be defective, and specifically excludes liability for incidental or consequential loss or damage.