

11624

87-91 STERLING SEDAN AND HATCHBACK

3/25/2013

GROSS LOAD CAPACITY WHEN USED AS A WEIGHT CARRYING HITCH: 1,500 LBS. TRAILER WEIGHT & 150 LBS. TONGUE WEIGHT.

*****DO NOT EXCEED VEHICLE MANUFACTURER'S RECOMMENDED TOWING CAPACITY.*****

WARNING: ALL NON-TRAILER LOADS APPLIED TO THIS PRODUCT MUST BE SUPPORTED BY 18050 STABILIZING STRAPS.

**** FAILURE TO PROPERLY SUPPORT NON-TRAILER LOADS WILL VOID PRODUCT WARRANTY****

HAVING INSTALLATION QUESTIONS? CALL TECHNICAL SUPPORT AT 1-800-798-0813

Parts List			
ITEM	QTY	PART NUMBER	DESCRIPTION
1	2	3_8 - 16 x 5 1_2 HEX	HEX BOLT
2	6	HFN3816	HEX FLANGE NUT
3	4	3/8 - 16 x 1 1/4	HEX BOLT
4	4	3/8"	FENDER WASHER
5	2	3/8"	WASHER

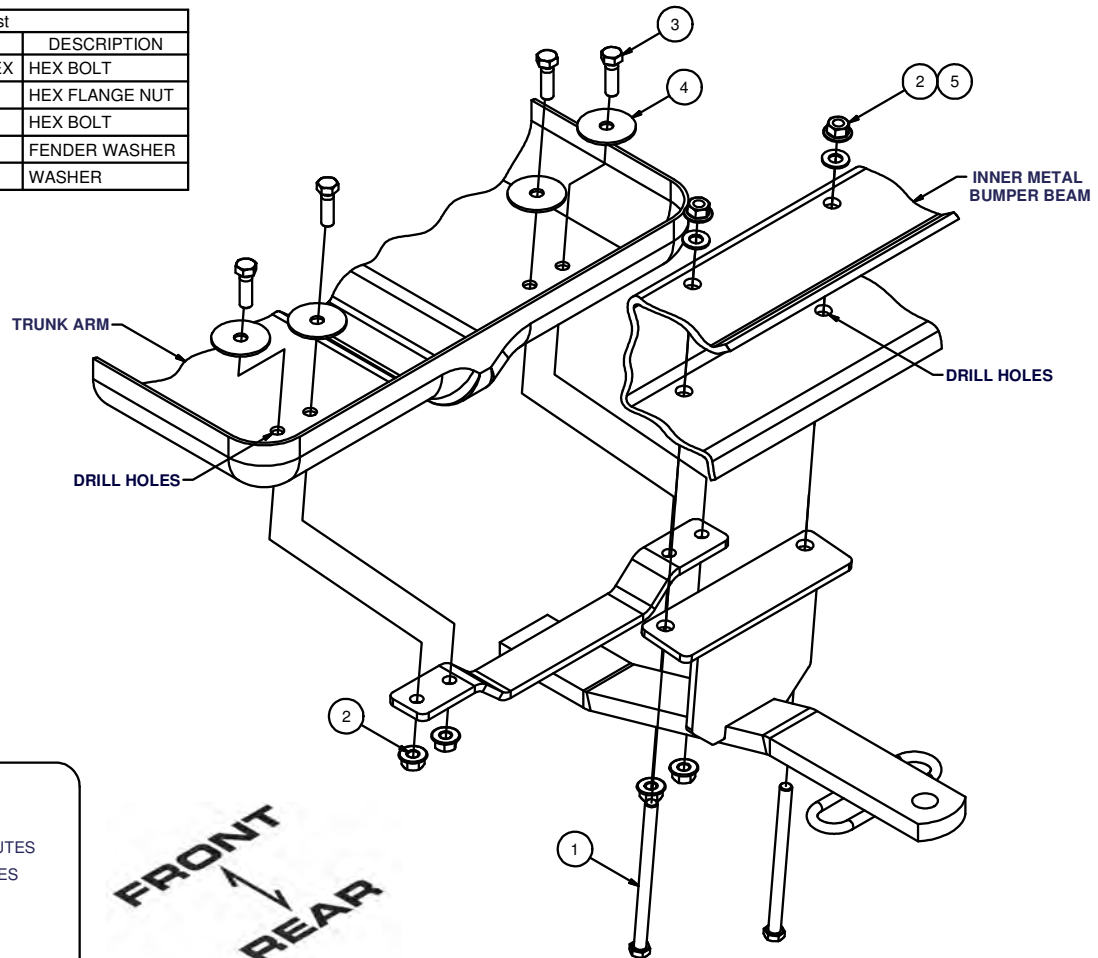

HITCH WEIGHT: 12 LBS.

INSTALL TIME

PROFESSIONAL: 45 MINUTES

NOVICE (DIY): 90 MINUTES

INSTALL NOTES:

- REMOVE PANEL
- CLEAR TRUNK
- DRILLING REQUIRED
- SILICONE HARDWARE

INSTALLATION STEPS

1. Remove the panel from the vehicle's rear bumper fascia to provide clearance for the hitch to fit up to inner metal bumper. Measure and mark the vehicle's centerline for positioning the hitch.
2. Position the hitch on the vehicle as shown, centered and square with the vehicle. Clear the trunk area before drilling. Mark, centerpunch and drill the bumper (2) places and trunk floor (4) places for 3/8" diameter bolts. NOTE: Holes through the metal bumper and drilled up through (2) surfaces being careful to drill straight up, not at an angle. An long drill bit will be necessary.
3. Install hitch using fasteners as shown. For access to washers and hex flange nuts at the top of the inner bumper it will be necessary to carefully bend fascia away from the body temporarily and hold with blocks that won't mar the finish. Tighten fasteners but do not overtighten or the bumper may become deformed.
4. Torque all 3/8" fasteners to 45 lb-ft.
5. Apply silicone sealant around fasteners installed in the trunk to seal out water and exhaust fumes.
6. Reinstall panel removed in step 1 and trunk contents removed in step 2.

PERIODICALLY CHECK THIS RECEIVER HITCH TO ENSURE THAT ALL FASTENERS ARE TIGHT AND THAT ALL STRUCTURAL COMPONENTS ARE SOUND.

Curt Manufacturing Inc., warrants this product to be free of defects in material and/or workmanship at the time of retail purchase by the original purchaser. If the product is found to be defective, Curt Manufacturing Inc., may repair or replace the product, at their option, when the product is returned, prepaid, with proof of purchase. Alteration to, misuse of, or improper installation of this product voids the warranty. Curt Manufacturing Inc.'s liability is limited to repair or replacement of products found to be defective, and specifically excludes liability for incidental or consequential loss or damage.

217352