

11645

89-92 CHEVY PRISM / 87-92 TOYOTA COROLLA SEDAN & WAGON

7/26/2013

GROSS LOAD CAPACITY WHEN USED AS A WEIGHT CARRYING HITCH: 2,000 LBS. TRAILER WEIGHT & 200 LBS. TONGUE WEIGHT.

**\*\*\*DO NOT EXCEED VEHICLE MANUFACTURER'S RECOMMENDED TOWING CAPACITY.\*\*\***

WARNING: ALL NON-TRAILER LOADS APPLIED TO THIS PRODUCT MUST BE SUPPORTED BY 18050 STABILIZING STRAPS.

**\*\* FAILURE TO PROPERLY SUPPORT NON-TRAILER LOADS WILL VOID PRODUCT WARRANTY\*\***

HAVING INSTALLATION QUESTIONS? CALL TECHNICAL SUPPORT AT 1-800-798-0813

Parts List			
ITEM	QTY	PART NUMBER	DESCRIPTION
1	2	M12-1.25 x 30mm	HEX BOLT
2	6	1/2"	LOCK WASHER
3	4	M12 - 1.25 x 40 HEX	HEX BOLT
4	4	7/16 WASHER	WASHER
5	2	M12 - 1.25	HANDLE NUT

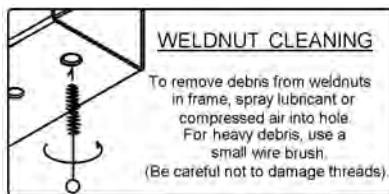
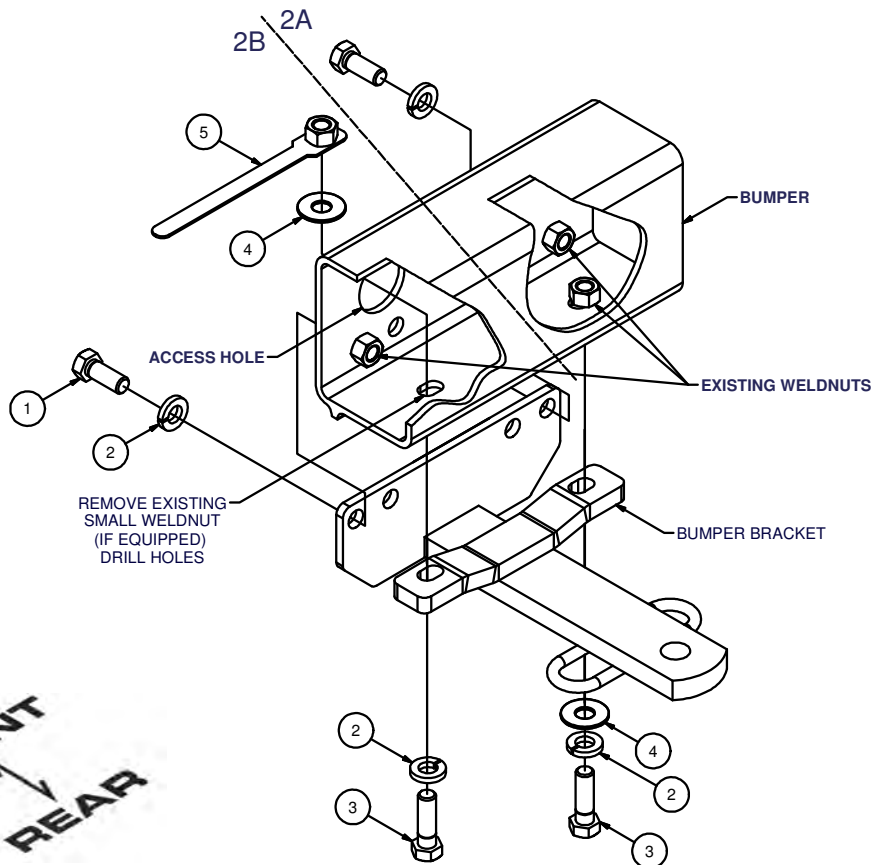

HITCH WEIGHT: 7 LBS.  
 INSTALL TIME  
 PROFESSIONAL: 45 MINUTES  
 NOVICE (DIY): 90 MINUTES  
 INSTALL NOTES:  
 -DRILLING MAY BE REQUIRED  
 -FASCIA TRIMMING REQUIRED

**INSTALLATION STEPS**

1. Position the hitch on the bumper so the hitch plate holes align with the threaded holes in front face of the bumper. At the bottom of the bumper, mark metal retainer strip and plastic fascia around the hitch bumper bracket. This area (approximately 1 1/2 x 8") must be clear for hitch bumper bracket to fit directly against metal bumper. Retainer is removed from bumper for cutting and fascia trimmed with a sharp knife. Use 10mm wrench to remove the retainer.
- 2A. Note the holes in the bottom of the metal bumper that match holes in hitch bumper bracket. For those bumpers with existing 12mm weldnuts in the bottom, the hitch can be bolted directly in place using supplied M12 bolts, 7/16" flat washers, and 7/16" lock washers as shown. If vehicle bumper does not have 12mm weldnuts at the bottom surface, go to 2B.
- 2B. Some bumpers will have smaller weld nuts for the retainer, or no holes in bottom of bumper. If equipped, remove the (2) small weldnuts with a drift pin. Using the hitch as a template drill 1/2" diameter holes in metal bumper. Fasten hitch to the vehicle bumper using M12 hex bolts, 7/16" flat washers, 7/16" lock washers and M12 handle nuts as shown. M12 handle nuts and flat washers must be placed as shown in diagram INSIDE of bumper through access holes in the front face of bumper.
3. Install M12 and 7/16" lock washers into existing weldnuts as shown.
4. Torque all 12mm fasteners to 86 lb-ft.

**PERIODICALLY CHECK THIS RECEIVER HITCH TO ENSURE THAT ALL FASTENERS ARE TIGHT AND THAT ALL STRUCTURAL COMPONENTS ARE SOUND.**

Curt Manufacturing Inc., warrants this product to be free of defects in material and/or workmanship at the time of retail purchase by the original purchaser. If the product is found to be defective, Curt Manufacturing Inc., may repair or replace the product, at their option, when the product is returned, prepaid, with proof of purchase. Alteration to, misuse of, or improper installation of this product voids the warranty. Curt Manufacturing Inc.'s liability is limited to repair or replacement of products found to be defective, and specifically excludes liability for incidental or consequential loss or damage.