

11702

87-90 BMW 3 SERIES CONVERTIBLE,
84-88 BMW 3 SERIES SEDAN AND COUPE (EXCEPT M3)

11/30/2012

GROSS LOAD CAPACITY WHEN USED AS A WEIGHT CARRYING HITCH: 2,000 LBS. TRAILER WEIGHT & 200 LBS. TONGUE WEIGHT.

*****DO NOT EXCEED VEHICLE MANUFACTURER'S RECOMMENDED TOWING CAPACITY.*****

WARNING: ALL NON-TRAILER LOADS APPLIED TO THIS PRODUCT MUST BE SUPPORTED BY 18050 STABILIZING STRAPS.

**** FAILURE TO PROPERLY SUPPORT NON-TRAILER LOADS WILL VOID PRODUCT WARRANTY****

HAVING INSTALLATION QUESTIONS? CALL TECHNICAL SUPPORT AT 1-800-798-0813

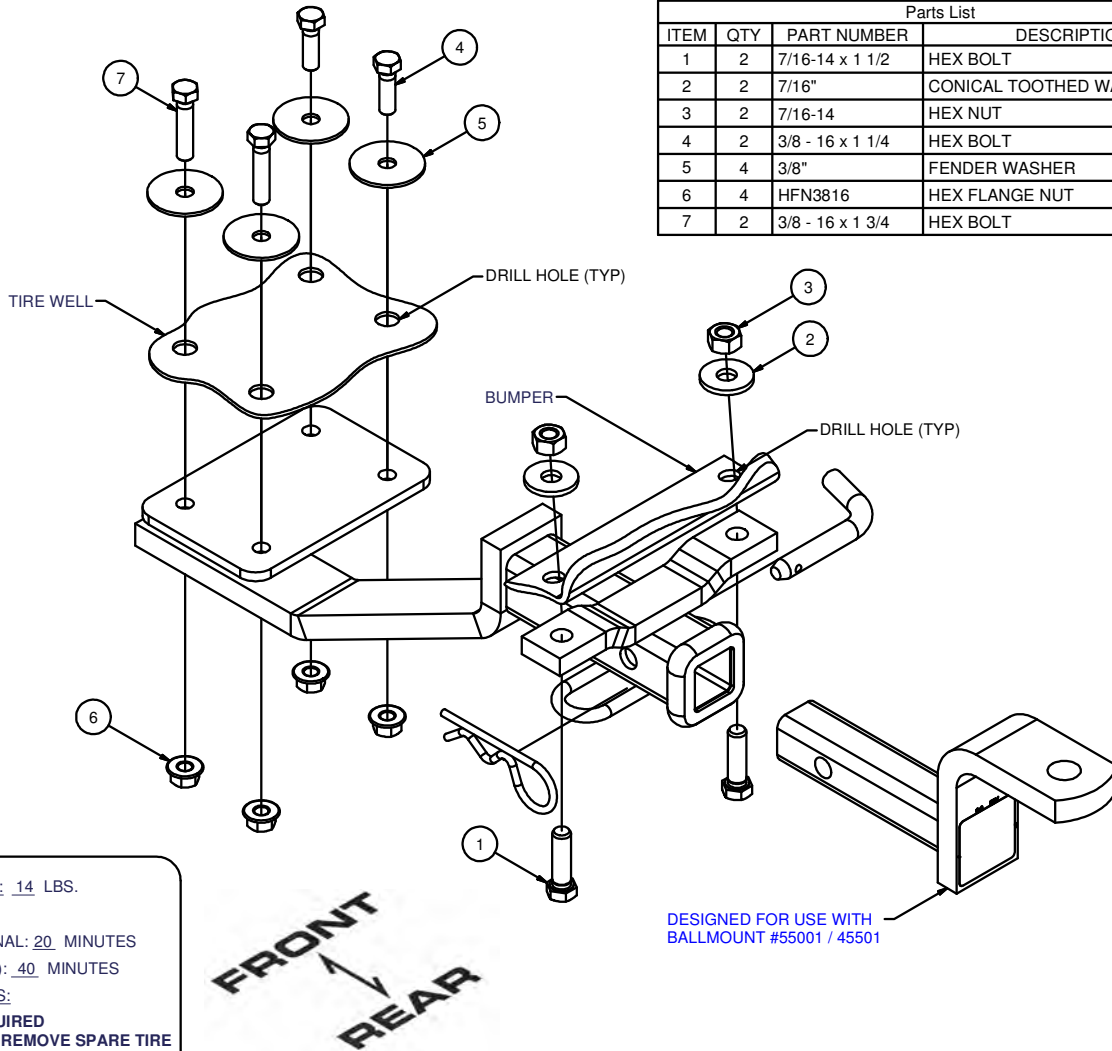

Parts List			
ITEM	QTY	PART NUMBER	DESCRIPTION
1	2	7/16-14 x 1 1/2	HEX BOLT
2	2	7/16"	CONICAL TOOTHED WASHER
3	2	7/16-14	HEX NUT
4	2	3/8 - 16 x 1 1/4	HEX BOLT
5	4	3/8"	FENDER WASHER
6	4	HFN3816	HEX FLANGE NUT
7	2	3/8 - 16 x 1 3/4	HEX BOLT

HITCH WEIGHT: 14 LBS.

INSTALL TIME

PROFESSIONAL: 20 MINUTES

NOVICE (DIY): 40 MINUTES

INSTALL NOTES:

- DRILLING REQUIRED
- TEMPORARILY REMOVE SPARE TIRE
- SILICONE SEAL HARDWARE

INSTALLATION STEPS

1. Temporarily remove spare tire. Position hitch against the spare tire well and bumper. Support hitch in place making sure it is square and centered on vehicle. Also check for enough bumper/hitch ball clearance with ball mount connected.
2. Using hitch as a template, mark and drill four places in tire well for 3/8" diameter bolts. Mark and drill the bottom of the bumper two places for 7/16" bolts.
3. Install hardware as shown.
4. Torque all 3/8" fasteners to 45 lb.-ft. and all 7/16" fasteners to 70 lb.-ft.
5. Silicone seal hardware installed through tire well.
6. Reinstall spare tire.

PERIODICALLY CHECK THIS RECEIVER HITCH TO ENSURE THAT ALL FASTENERS ARE TIGHT AND THAT ALL STRUCTURAL COMPONENTS ARE SOUND.

Curt Manufacturing Inc., warrants this product to be free of defects in material and/or workmanship at the time of retail purchase by the original purchaser. If the product is found to be defective, Curt Manufacturing Inc., may repair or replace the product, at their option, when the product is returned, prepaid, with proof of purchase. Alteration to, misuse of, or improper installation of this product voids the warranty. Curt Manufacturing Inc.'s liability is limited to repair or replacement of products found to be defective, and specifically excludes liability for incidental or consequential loss or damage.