



12079 INSTALLATION INSTRUCTIONS



Safety glasses should be worn at all times while installing this product.

YEARS: 2012-Present

MAKE: TOYOTA

MODEL: CAMRY

STYLE: SEDAN

WARNING: NEVER EXCEED YOUR VEHICLE MANUFACTURER'S RECOMMENDED TOWING CAPACITY

WEIGHT CARRYING:

TRAILER WEIGHT: 3500 LBS.

TONGUE WEIGHT: 350 LBS.

WARNING:

WE RECOMMEND THE USE OF 18050 STABILIZING STRAPS FOR ALL NON-TRAILER (WHEEL-LESS) LOADS. PLEASE SEE THE CURT CATALOG OR VISIT US ONLINE AT WWW.CURTMFG.COM FOR FURTHER INFORMATION.

INSTALLATION TIME: 50 MIN.

THE INSTALL TIME LISTED IS FOR PROFESSIONAL INSTALLERS. IF YOU ARE HESITANT TO UNDERTAKE THIS TASK ON YOUR OWN, CONTACT AN AUTHORIZED CURT INSTALLER FOR ADDITIONAL ASSISTANCE.





INSTALLATION TIPS:

1. BEFORE YOU BEGIN INSTALLATION, READ ALL INSTRUCTIONS THOROUGHLY.
2. TO EASE INSTALLATION, 2 PEOPLE MAY BE REQUIRED.
3. USING PROPER TOOLS WILL GREATLY IMPROVE THE QUALITY OF THE INSTALL AND REDUCE THE TIME REQUIRED.
4. NEED HELP OR HAVE SOME QUESTIONS? CALL TECHNICAL SUPPORT AT 800.798.0813

INSTALLATION REQUIRES:

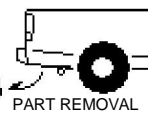
 DIE GRINDER	 POWER DRILL	 DRILL BIT 1/2"
 MARKER	 RATCHET	 AVIATION SHEARS
 SAFETY GLASSES	 SOCKET 10mm 12mm 14mm 17mm	 SOCKET 3/4"
 TORQUE WRENCH	 TAPE MEASURE	

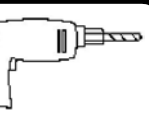
LEVEL OF DIFFICULTY: MODERATE

EASY	MODERATE	CHALLENGING
	Temporary lowering of exhaust required	
	Underbody panel removal required	
	Heat shield trimming required	
	Drilling required	
	Hole enlargement required	

VEHICLE PHOTO:



REPRESENTATIVE PHOTO

HITCH ILLUSTRATION:

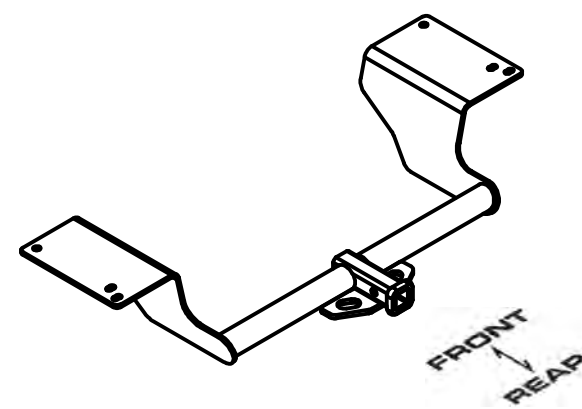

MAKE SURE YOUR HITCH MATCHES

PERIODICALLY CHECK THIS RECEIVER HITCH TO ENSURE ALL FASTENERS ARE TIGHT AND ALL STRUCTURAL COMPONENTS ARE SOUND

CURT Manufacturing LLC. warrants this product to be free of defects in material and/or workmanship at the time of retail purchase by the original purchaser. If the product is found to be defective, Curt Manufacturing LLC. may repair or replace the product at their option, when the product is returned, prepaid, with proof of purchase. Alteration to, misuse of, or improper installation of this product voids the warranty. Curt Manufacturing LLC.'s liability is limited to repair or replacement of products found to be defective, and specifically excludes liability for incidental or consequential loss or damage.

For more information log onto www.curtmfg.com, & for helpful towing tips log onto www.hitchinfo.com

INSTALLATION WALKTHROUGH:

Parts List			
ITEM	QTY	PART NUMBER	DESCRIPTION
1	2	1/2-13 x 1 3/4	HEX BOLT
2	2	1/2"	LOCK WASHER
3	2	1/2-13	HANDLE NUT
4	4	M10-1.25 x 35	HEX BOLT
5	4	3/8"	CONICAL TOOTHED WASHER

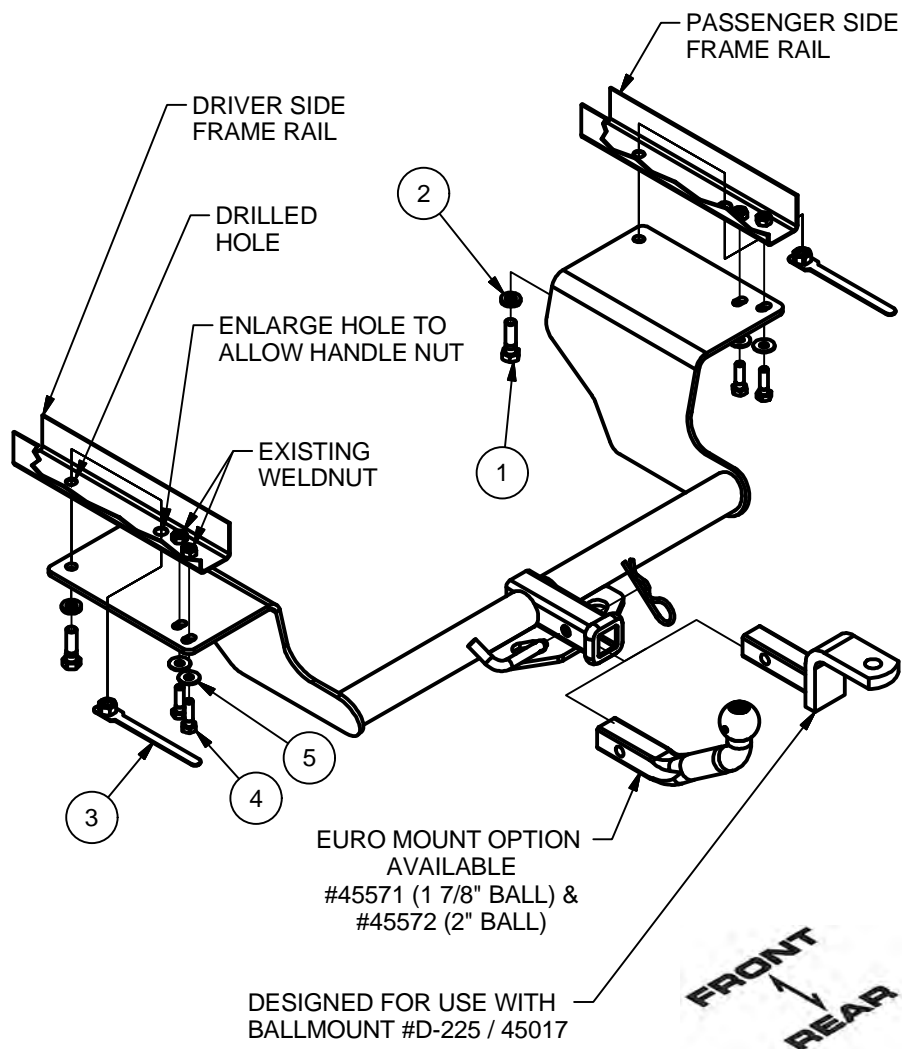

1. If present, remove plastic underbody panel and return panel and fasteners to vehicle owner.



REMOVE PLASTIC UNDERBODY PANEL AND RETURN TO VEHICLE OWNER

2. Lower exhaust by removing two bolts which attach exhaust hanger brackets to passenger side frame rail and removing rubber isolator located forward of muffler.

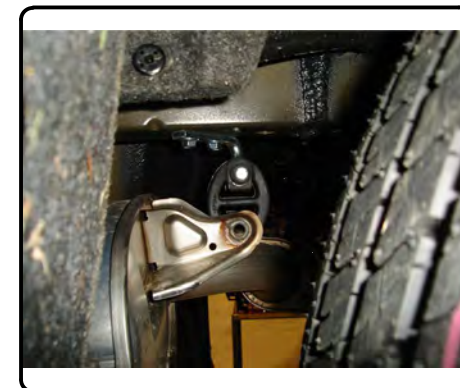

INSTALLATION WALKTHROUGH:

3. Remove heat shield by removing two screws which secure heat shield to passenger side frame rail. Trim heat shield as shown in Heat Shield Trim Diagram.

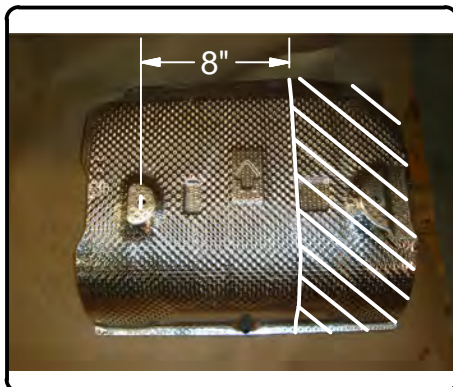
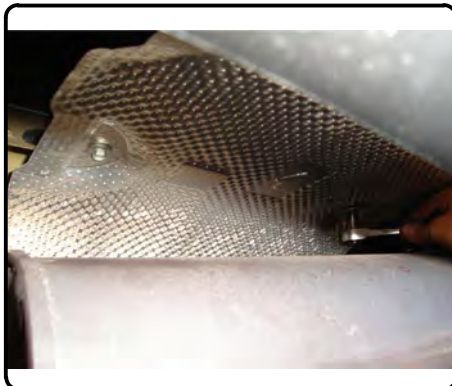

4. If vehicle is equipped with dual exhaust, repeat Steps 2 and 3 on driver side.

5. If present, remove tape from over holes and weldnuts in vehicle frame rails.



6. Raise hitch into position and temporarily attach with M10 bolts in existing weldnuts in frame rails. Mark location of forwardmost hole in each frame rail.

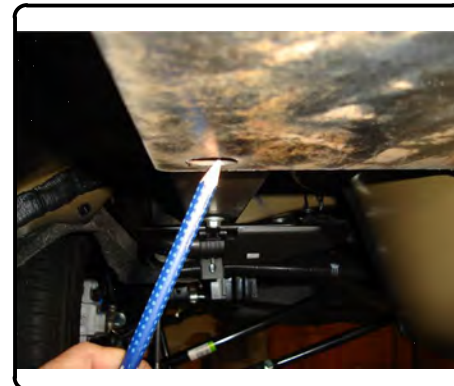
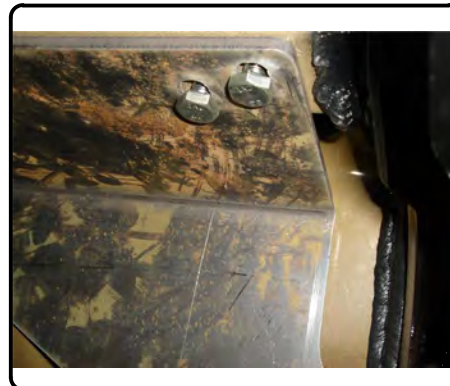

7. Lower hitch and drill 1/2" hole in each frame rail as marked in step 6.

8. Enlarge access hole in each frame rail enough to accept handle nuts, being careful not to damage weldnuts.

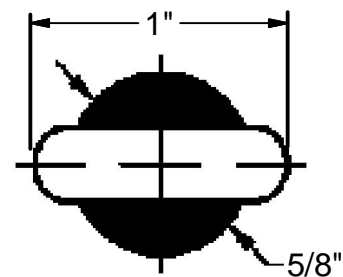

INSTALLATION WALKTHROUGH:

9. Insert handle nuts up through enlarged access hole and line up with holes drilled in step 7.

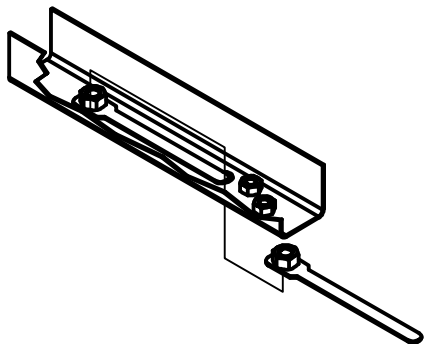

10. Remove exhaust hanger bracket from rubber isolators and rotate so that tab is on the outside of the frame rail and reinstall on rubber isolators. Repeat on driver side if equipped with dual exhaust.

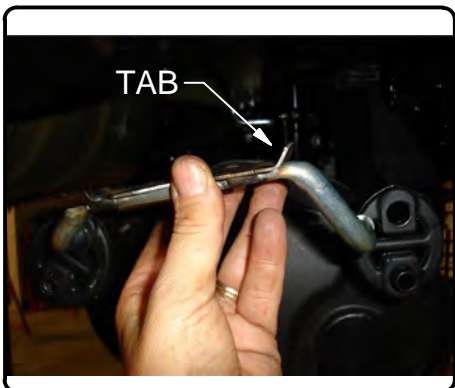
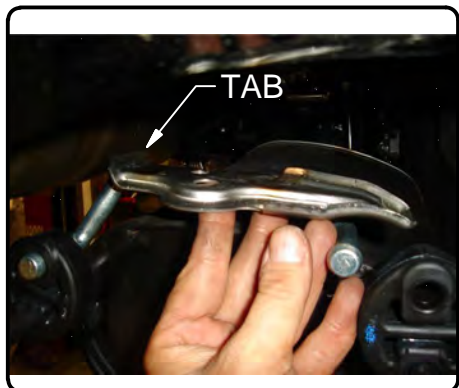

11. Reinstall trimmed heat shield using only forwardmost screw. Rearward edge of heat shield should be sandwiched between frame rail and edge of hitch bracket.

12. Raise hitch back into position, sandwiching hitch brackets between frame rails and exhaust hanger brackets. Install fasteners as shown.



13. Torque all M10 hardware to 37 lb.-ft. Torque all 1/2 hardware to 75 lb.-ft.

14. Reattach forwardmost exhaust rubber isolator.

Installation is complete.



GROSS LOAD CAPACITY WHEN USED AS A WEIGHT CARRYING HITCH: 3500 LBS. TRAILER WEIGHT & 350 LBS. TONGUE WEIGHT.

DO NOT EXCEED VEHICLE MANUFACTURER'S RECOMMENDED TOWING CAPACITY.

WARNING: ALL NON-TRAILER LOADS APPLIED TO THIS PRODUCT MUST BE SUPPORTED BY 18050 STABILIZING STRAPS.

** FAILURE TO PROPERLY SUPPORT NON-TRAILER LOADS WILL VOID PRODUCT WARRANTY**

HAVING INSTALLATION QUESTIONS? CALL TECHNICAL SUPPORT AT 1-800-798-0813

Parts List			
ITEM	QTY	PART NUMBER	DESCRIPTION
1	2	1/2-13 x 1 3/4	HEX BOLT
2	2	1/2"	LOCK WASHER
3	2	1/2-13	HANDLE NUT
4	4	M10-1.25 x 35	HEX BOLT
5	4	3/8"	CONICAL TOOTHED WASHER

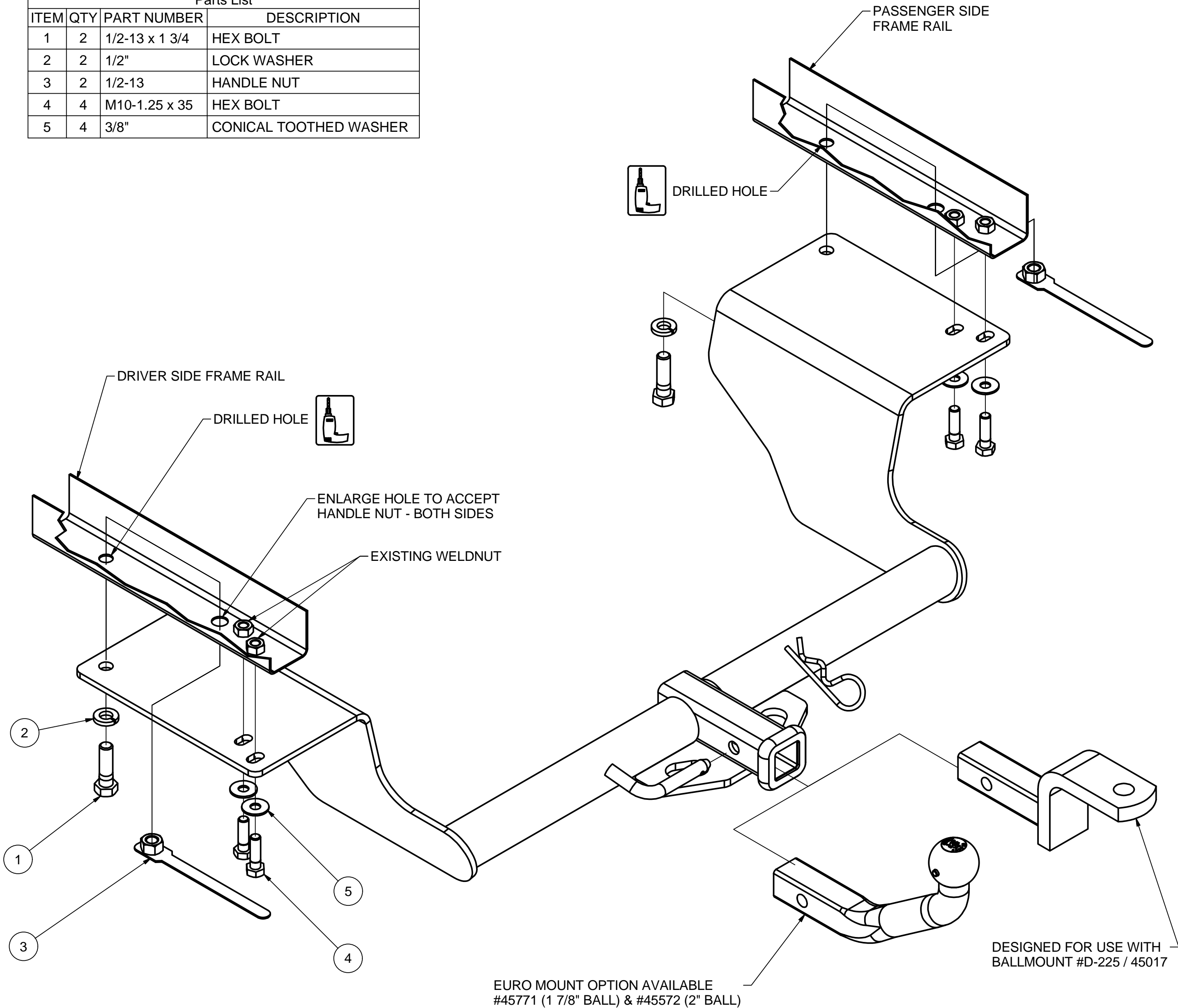

HITCH WEIGHT: 25 LBS.

INSTALL TIME

PROFESSIONAL: 50 MINUTES

NOVICE (DIY): 100 MINUTES

INSTALL NOTES:

- Drilling Required
- Heat shield trimming required
- Hole enlargement required
- Temporary lowering of exhaust required
- Underbody panel removal required

TOOLS REQUIRED
RATCHET
TORQUE WRENCH
10mm, 12mm, 14mm SOCKETS
17mm, 3/4" SOCKETS
DRILL & 1/2" BIT
DIE GRINDER
AVIATION SHEARS
TAPE MEASURE

PERIODICALLY CHECK THIS RECEIVER HITCH TO ENSURE THAT ALL FASTENERS ARE TIGHT AND THAT ALL STRUCTURAL COMPONENTS ARE SOUND.

Curt Manufacturing LLC., warrants this product to be free of defects in material and/or workmanship at the time of retail purchase by the original purchaser. If the product is found to be defective, Curt Manufacturing LLC., may repair or replace the product, at their option, when the product is returned, prepaid, with proof of purchase. Alteration to, misuse of, or improper installation of this product voids the warranty. Curt Manufacturing LLC.'s liability is limited to repair or replacement of products found to be defective, and specifically excludes liability for incidental or consequential loss or damage.

HAVING INSTALLATION QUESTIONS? CALL TECHNICAL SUPPORT AT 1-800-798-0813

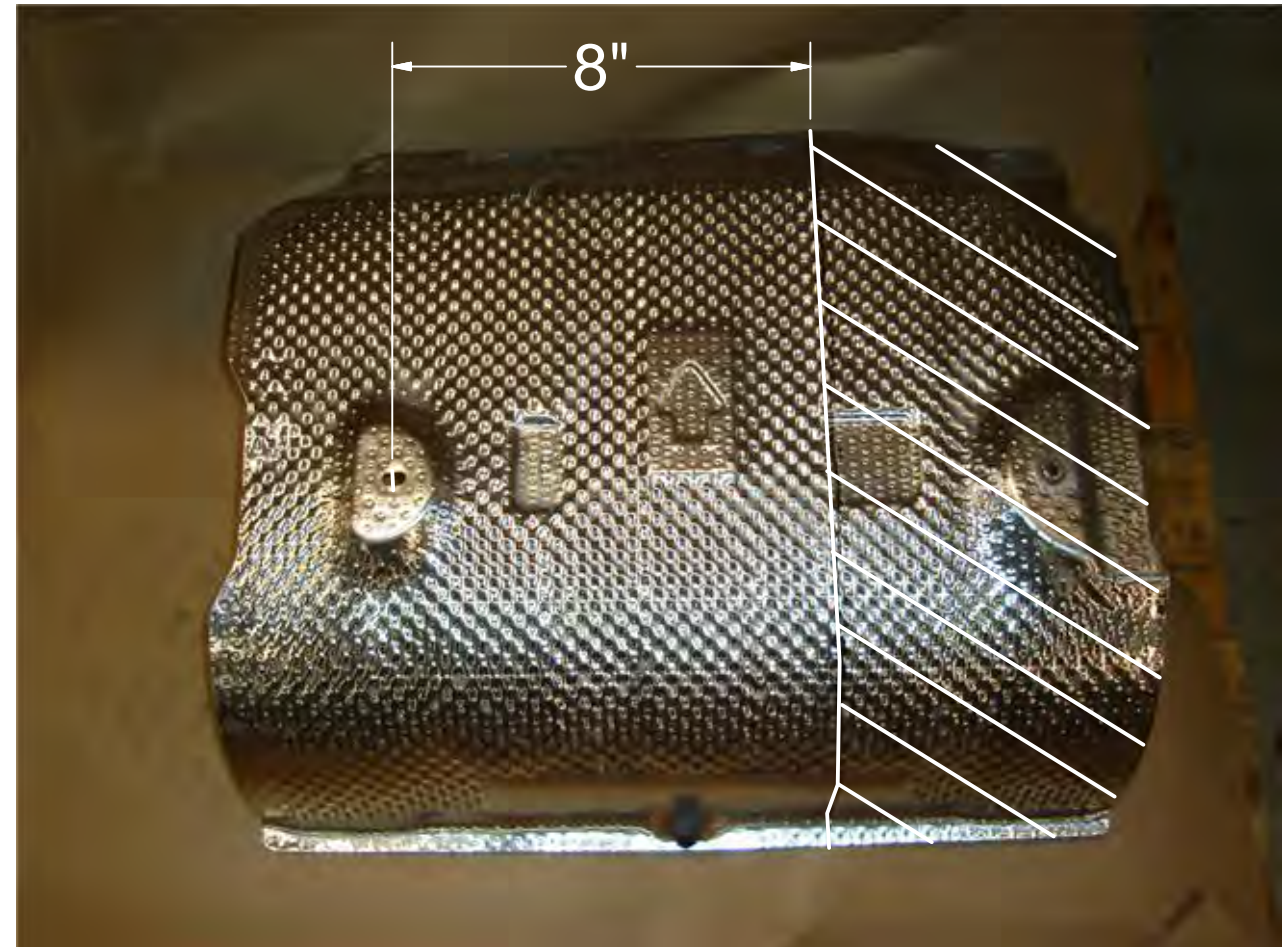
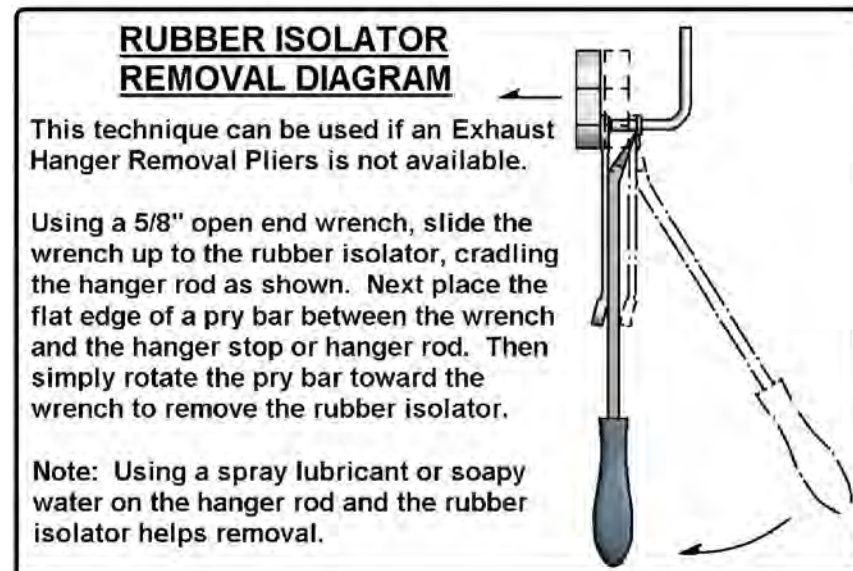
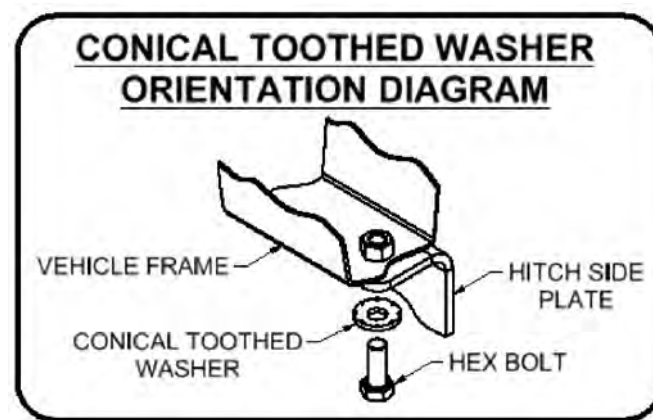
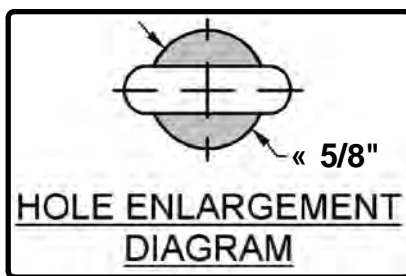
HEAT SHIELD TRIM DIAGRAM**INSTALLATION STEPS**

1. If present, remove plastic underbody panel and return panel and fasteners to vehicle owner.
2. Lower exhaust by removing two bolts which attach exhaust hanger brackets to passenger side frame rail and removing rubber isolator located forward of muffler.
3. Remove heat shield by removing two screws which secure heat shield to passenger side frame rail. Trim heat shield as shown in Heat Shield Trim Diagram.
4. If vehicle is equipped with dual exhaust, repeat Steps 2 and 3 on driver side.
5. If present, remove tape from over holes and weldnuts in vehicle frame rails.
6. Raise hitch into position and temporarily attach with M10 bolts in existing weldnuts in frame rails. Mark location of forwardmost hole in each frame rail.
7. Lower hitch and drill 1/2" hole in each frame rail as marked in step 6.
8. Enlarge access hole in each frame rail enough to accept handle nuts, being careful not to damage weldnuts.
9. Insert handle nuts up through enlarged access hole and line up with holes drilled in step 7.
10. Remove exhaust hanger bracket from rubber isolators and rotate so that tab is on the outside of the frame rail and reinstall on rubber isolators. Repeat on driver side if equipped with dual exhaust.
11. Reinstall trimmed heat shield using only forwardmost screw. Rearward edge of heat shield should be sandwiched between frame rail and edge of hitch bracket.
12. Raise hitch back into position, sandwiching hitch brackets between frame rails and exhaust hanger brackets. Install fasteners as shown.
13. Torque all M10 fasteners to 37 lb.-ft. Torque all 1/2 fasteners to 75 lb.-ft.
14. Reattach forwardmost exhaust rubber isolator.

PERIODICALLY CHECK THIS RECEIVER HITCH TO ENSURE THAT ALL FASTENERS ARE TIGHT AND THAT ALL STRUCTURAL COMPONENTS ARE SOUND.