

DO NOT EXCEED VEHICLE MANUFACTURER'S RECOMMENDED TOWING CAPACITY.

Parts List			
ITEM	QTY	PART NUMBER	DESCRIPTION
1	1	CM-16443-DS	.250" DRIVER SIDE PLATE
2	1	CM-16443-PS	.250" PASSENGER SIDE PLATE
3	2	1/2"	FISHWIRE TOOL
4	8	CM-SP33	.250 x 1.50 x 2.00" SQUARE HOLE SPACER
5	8	CM-SP136	.313" x 1.00 x 2.00" U-SHAPE SPACER
6	2	1/2 - 13 x 1 1/2	HEX BOLT
7	10	1/2-13 x 1 3/4	CARRIAGE BOLT
8	10	HFN 1213	HEX FLANGE NUT
9	2	CM-SP6	.250 x 1.00 x 3.00" SQUARE HOLE SPACER
10	2	CM-SP28	.250 x 3.00 x 4.00" SQUARE HOLE SPACER
11	2	1/2-13	HEX NUT
12	2	1/2"	LOCK WASHER
13	2	1/2" WASHER	1/2" FLAT WASHER

DRILL APPLICATION : YES
 APPROX. INSTALL TIME: 60 MIN.

OTHER NOTES:
 TEMPORARILY REMOVE BRAKE CABLE HANGERS
 FROM DRIVER SIDE FRAME RAIL

**FORD SUPER DUTY FULL
 SIZE PICK UP TRUCK**

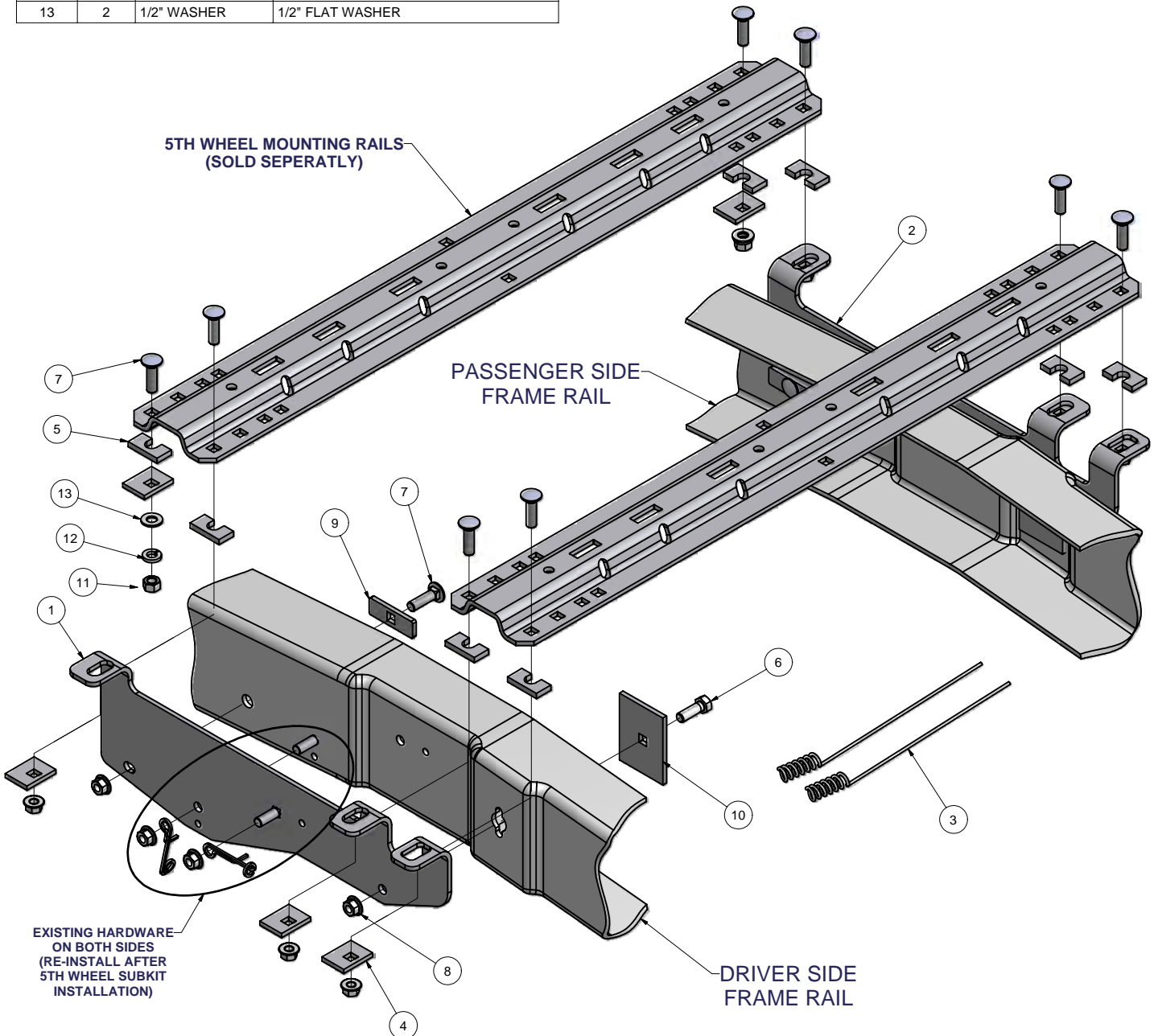

Curt Manufacturing Inc., warrants this product to be free of defects in material and/or workmanship at the time of retail purchase by the original purchaser. If the product is found to be defective, Curt Manufacturing Inc., may repair or replace the product, at their option, when the product is returned, prepaid, with proof of purchase. Alteration to, misuse of, or improper installation of this product voids the warranty. Curt Manufacturing Inc.'s liability is limited to repair or replacement of products found to be defective, and specifically excludes liability for incidental or consequential loss or damage.

RAIL LOCATION DIAGRAM

!IMPORTANT!
 SYSTEM MAY NOT WORK WITH
 2003 AND EARLIER COMPEDITOR
 PRODUCTS

USE HITCH TO LOCATE RAIL

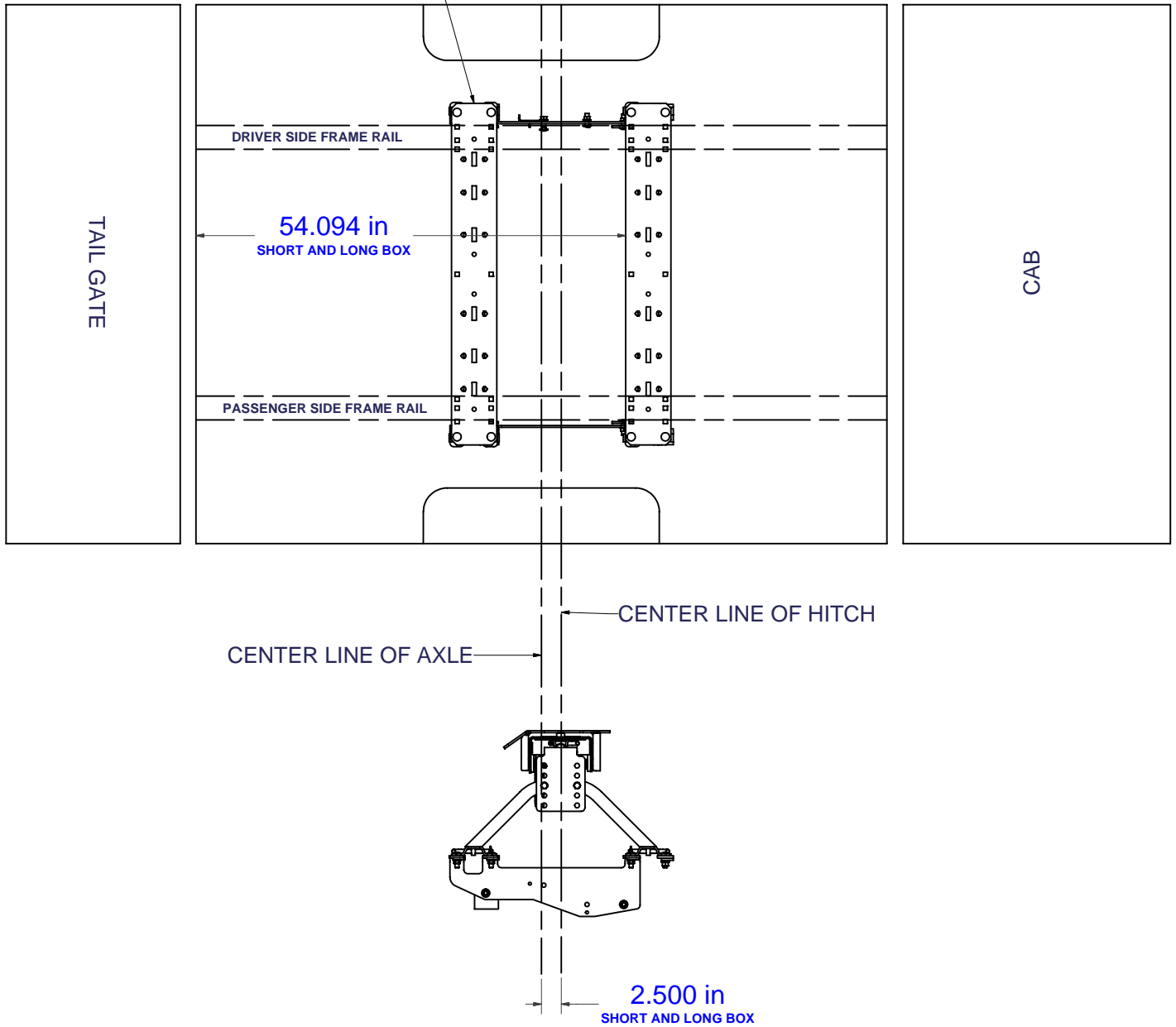

Curt Manufacturing Inc., warrants this product to be free of defects in material and/or workmanship at the time of retail purchase by the original purchaser. If the product is found to be defective, Curt Manufacturing Inc., may repair or replace the product, at their option, when the product is returned, prepaid, with proof of purchase. Alteration to, misuse of, or improper installation of this product voids the warranty. Curt Manufacturing Inc.'s liability is limited to repair or replacement of products found to be defective, and specifically excludes liability for incidental or consequential loss or damage.



16443

FORD SUPER DUTY SHORT AND LONG BOX

DO NOT EXCEED VEHICLE MANUFACTURER'S RECOMMENDED TOWING CAPACITY.

!WARNING!

- Do not install mounting rails over plastic bed liners. Plastic bed liners must be cut out of the way to provide metal to metal contact. Base rails may be installed on spray in liners.
- Use only bolts, nuts, and washers supplied to install this kit. All bolts are grade 5 and nuts are grade 5 unless specified otherwise.
- These instructions are guidelines only, actual installation is the responsibility of the installer and the owner. Always measure truck and trailer before installing hitch to be sure that there is clearance at the cab and at the bumper to allow for turns.
- During installation, when drilling, protect the fuel tank and filler tubes, brake lines, and wire harness by placing a piece of metal between the box floor and potential components at risk on the driver side. This will prevent drilling into these items.

- 1) On driver side, temporarily remove brake cable hangers from side of frame.

Note: There are no hangers on the passenger side of the frame.

- 2) Drill out the frame hanger hole using a 1/2" drill bit.
- 3) Re-install brake cable hangers on driver side plate using factory hardware as shown.
- 4) Place one rail in the box of the truck, using your tape measure, center the mounting rail on the truck box floor and the proper distance from the rear edge of the truck box as shown in the "Rail Location Diagram".
- 5) Using a center punch, mark the holes as per the illustration. Move the mounting rail out of the way and drill each position with a 1/8" drill bit.
- 6) Temporarily position the side plates on the frame and check that the 1/8" drilled holes align with the slots of the frame bracket. Remove the side plates from the vehicle.
- 7) Enlarge the 1/8" drilled holes to 9/16".
- 8) Attach the side plates to frame using specified hardware. (hand tighten only)
- 9) Reposition the mounting rail over the holes and fasten the mounting rail to the side plates using the supplied carriage bolts. Use the supplied spacers between the frame bracket or mounting rails and the box so as to ensure a metal to metal contact. (tighten hand tight)
- 10) Place the unassembled 5th wheel / roller / gooseneck hitch into the already installed mounting rail. Position the second mounting rail with the 5th wheel / roller / gooseneck hitch by inserting the tabs into the mounting rail and pushing the second mounting rail tight towards the other mounting rail. Ensure that the mounting rail is centered on the truck box floor. This will position the rail in the correct location and ensure that the 5th wheel will have a snug fit to the truck.

Note: If more than one hitch product will be used with the mounting rails then both should be used at the same time to align the second mount rail. This will ensure that one product does not compromise the fit of the other.

- 11) Repeat steps 5, 7, and 9 for the second mounting rail.
- 12) Torque all 1/2" fasteners to 110 lb-ft, starting with the bolts fastening the mounting rails to the side plates.