



INSTALLATION INSTRUCTIONS

Congratulations – your new Work-Rite load assists are quality products capable of improving the handling and comfort of your vehicle while under load. As with all products, proper installation is the key to obtaining all of the benefits your kit is capable of delivering. Please take a few minutes to read through the instructions to identify the components and learn where and how they are used. It is a good idea to start by comparing the parts in your kit with the parts list below.

***NOTE: IF ANY PARTS ARE MISSING FROM THE KIT,
PLEASE CALL 1-800-888-0650.
PLEASE DO NOT CALL OR RETURN THE KIT TO THE DEALER.***

Be sure to take all applicable safety precautions during the installation of the kit. The instructions listed in this brochure and the illustrations all show the left, or driver's side of the vehicle. To install the right side assembly simply follow the same procedures.

STEP 1 – PREPARE THE VEHICLE

With the vehicle on a solid, level surface chock the front wheels. Remove the negative battery cable. Remove the jounce bumpers located under the frame rail by pulling them down at an angle until it pulls off the jounce bumper stud. The jounce bumpers will not be re-used with this kit.

STEP 2 – PREASSEMBLE

Select one Work-Rite bumper and one upper bracket from the kit. Insert a 3/8"-16 x 1-1/5" bolt and flat washer through the bottom of the Work-Rite and through the small center hole in the upper bracket. Fasten the Work-Rite to the upper bracket using a 3/8"-16 flange lock nut. ***See Figure "A"***.

NOTE: An optional spacer may be installed to engage the Work-Rite sooner when a load is applied. To install, place between the Work-Rite and the upper bracket. There should be 3/8" to 1/2" between the Work-Rite and the axle pad. See Figure "B".

STEP 3 – INSTALLING THE WORK-RITE ONTO THE VEHICLE

Place two of the "L" brackets onto the frame, around the jounce bumper stud. ***See Figure "A" & "B"***. Place the Work-Rite assembly over the "L" brackets and onto the frame. Attach the upper bracket to the "L" brackets using four 5/16"-24 X 3/4" bolts and 5/16" flange lock nuts. ***See Figure "A"***.

STEP 4 – FINISH UP

Remove the wheel chocks and reconnect the battery cable. Now you're finished and ready to put your Work-Rite to use!

PARTS LIST

BOLT PACK (A21-760-8634)

WORK-RITE LOAD ASSISTS	1264	2	3/8"-16 X 1-1/2" HEX BOLT	2
UPPER BRACKET	5714	2	3/8"-16 FLANGE LOCK NUT	2
"L" BRACKETS	5715	4	5/16"-24 X 3/4" HEX BOLT	8
OPTIONAL SPACERS	0013	2	5/16"-24 FLANGE LOCK NUT	8
			3/8" FLAT WASHERS	2

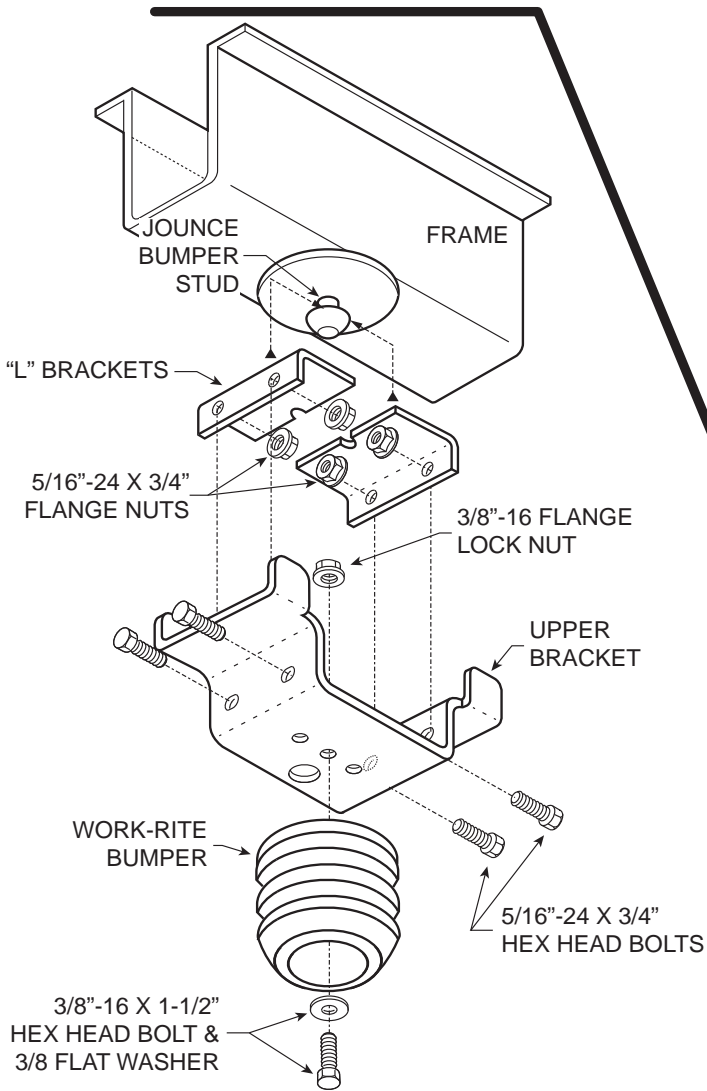

Figure "A"

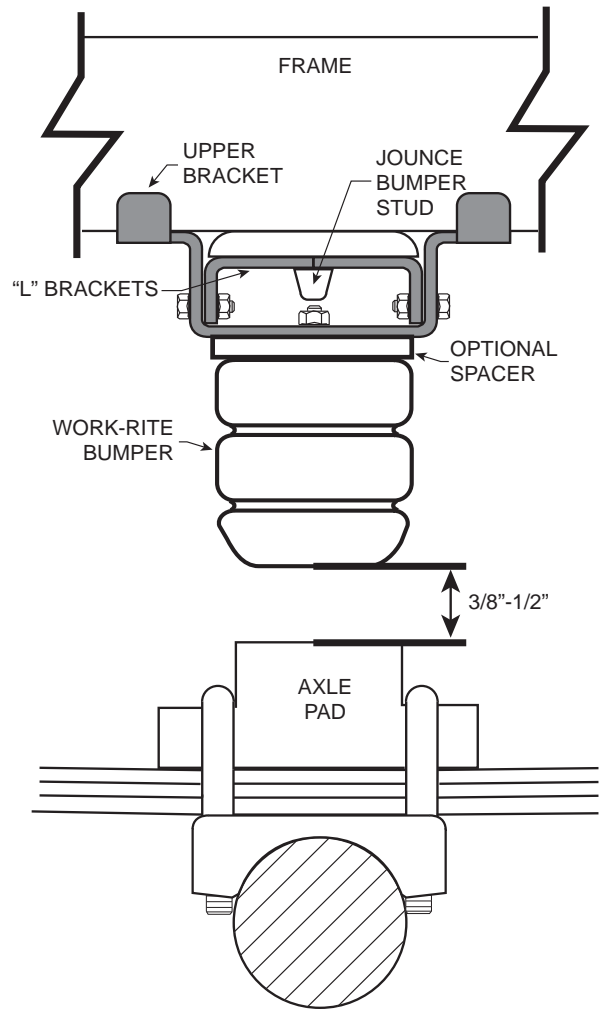

Figure "B"