



07902 - Door Edge Guard Installation Instructions

INTRODUCTION

This HuskyShield product is a Clear Overlay Paint Protection (**COPP**) system. Each HuskyShield "Kit" is comprised of a clear protective film with a self adhesive back. This kit is designed to help protect your door edges against paint chips, scrapes and other damage. It will provide this protection unobtrusively without obscuring your vehicle's appearance.

KIT SHADOW SHEET

The graphic below is a "Shadow Sheet" showing the position and shape of your HuskyShield kit. Use this to assist you in identifying the various pieces during installation.

Door Edge Guards



TOOLS & SUPPLIES

Supplied with your kit:

- A. Application Card
- B. Spray Bottle
- C. Surface Prep Putty
- D. Huskyshield Door Edge Guard kit

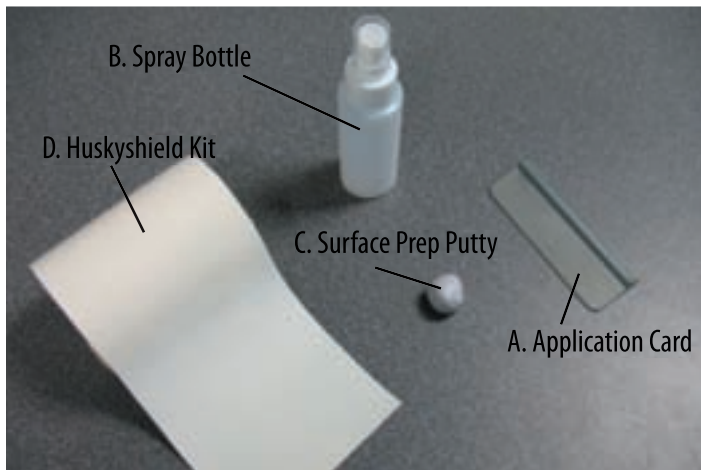

Supplied by you:

- Bathroom Scale (optional - to assist in applying proper pressure)
- Blow Dryer
- Quality Paper Towels, Lint Free Cloth or Chamois
- Sharp Scissors

PRE-INSTALLATION PREPARATIONS

- 1) Read all instructions in their entirety before beginning installation.
- 2) Verify that you have the necessary tools and supplies.
- 3) Your installation environment should be free of air born dust & debris and offer good lighting. A well lit garage with the doors closed would be a good choice.
- 4) Vehicle should be completely washed prior to installation.
- 5) You may wish to have a scale on hand to "get a feel" of how much pressure to apply when directed in the instructions.

ADVISORY NOTES

- 1) The COPP photographs included herein have had the edges enhanced for visibility in the instructions. Your COPP edges will be clear.
- 2) Allow up to 30 minutes for installation of this kit.
- 3) Always keep your hands wet when handling the Door Edge Guard.

DEFINITIONS

Adhesive Side - the side of the Door Edge Guard that is applied to the vehicle surface.

Bubbles - Either excess water, solution or air that becomes trapped between the COPP and vehicle surface.

Tack - When you squeegee a small area of the Door Edge Guard so that the adhesive side of the Door Edge Guard is adhered to the vehicle surface thus preventing it from moving.

DOOR EDGE GUARD INSTALLATION

- 1) Prep vehicle:
 - a. The 32 oz. Spray Bottle should be filled to the base of the neck with clear water. The Door Edge Guards are easier to install with clear water. Do not use installation solution when installing Door Edge Guards.
 - b. Using clear water, liberally spray both the outside & inside edge of the door.
 - c. Scrub the wet surface with the SURFACE PREP PUTTY provided as if you were cleaning the edge with a cleaning towel. (PIC #1) When using the surface prep putty ALWAYS keep the surface of the vehicle wet.

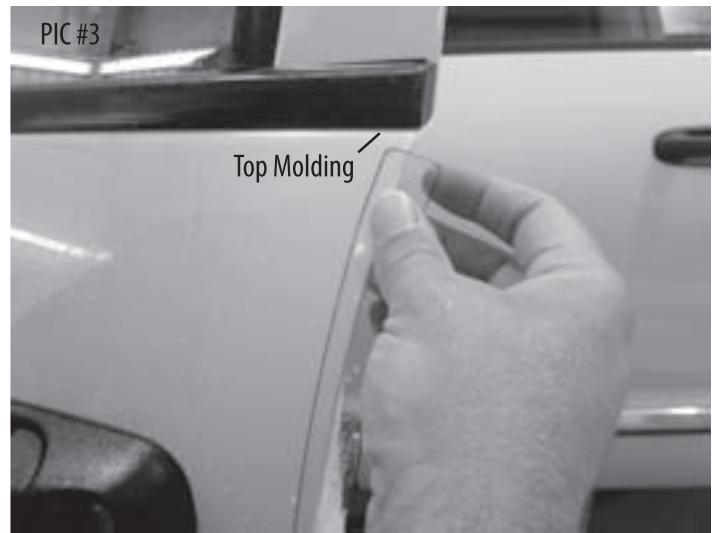
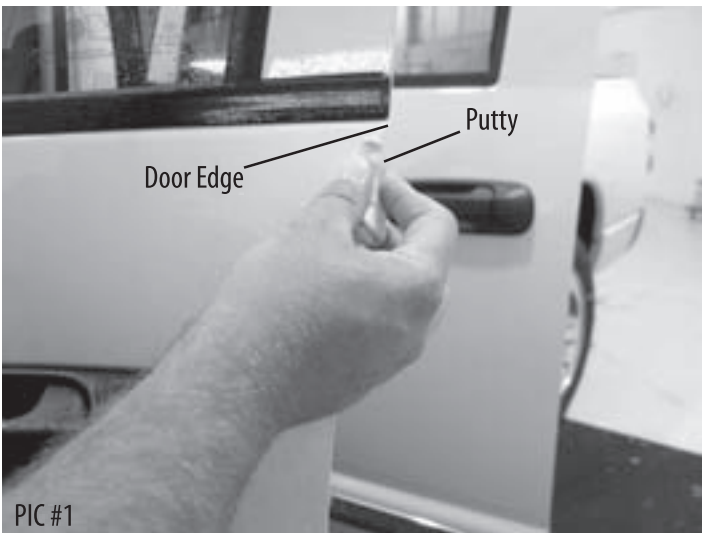

If used dry the putty will be sticky and not perform as intended. (Note: Recommended cleaning time is approx. 1 minute.)

- d. Cleaning should be concentrated approximately 1" above the lower outside belt molding of the door and continue down the door edge until the entire door edge has been cleaned.
- e. Wipe away ALL residue left from the Surface Prep Putty with a clean, lint-free towel. (PIC #2)

- d. Starting at the middle, using thumb and forefinger, wrap excess Door Edge Guard around the door edge. (PIC #4)

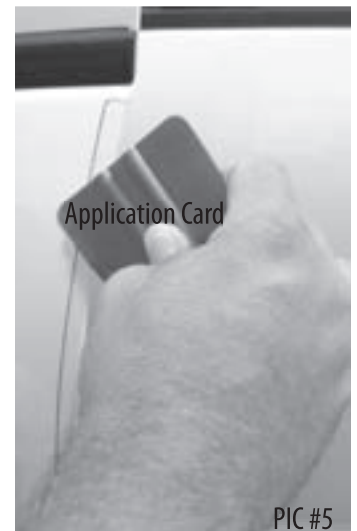

- e. Working from the center down wrap excess Door Edge Guard to bottom of door. Repeat this process, working from the center up to the top of the Door Edge Guard.
- f. Use the Application Card with 5 - 7 lbs of pressure to work out ALL air bubbles and excess water that may be trapped between the Door Edge Guard and the door surface. (PIC #5) Starting at the top, work from the outside door edge inward towards the outside of the Door Edge Guard. Continue using overlapping strokes as you move downward towards the bottom of the Door Edge Guard. When properly applied, the Door Edge Guard will seal around the door edge.

2) Door Edge Guard Installation:

- a. Spray the edge of the door liberally with clear water prior to applying the Door Edge Guard. (IMPORTANT: THE DOOR AND FILM MUST REMAIN WET FOR EASE OF MOVEMENT WHILE PLACING THE DOOR EDGE GUARD.)
- b. Using wet fingers, peel the Door Edge Guard from the liner while spraying the adhesive side of the film with clear water.
- c. Position the top of the Door Edge Guard just under the top molding as shown. (PIC #3) Apply one-half of the width of the Door Edge Guard (approximately 7/16") on the outside door surface. Using your thumb, make a quick swipe from the top to the bottom with 5 - 7 lbs of pressure to remove excess water.

3) Alternative Door Edge Guard Installation: when installing on a vehicle with body molding or surface indentations

- a. Repeat steps "2a" and "2b".
- b. Position the top of the Door Edge Guard just under the top molding as shown. (PIC #3) Apply one-half of the width of the

Door Edge Guard (approximately 7/16") on the outside door surface. Stop just above the molding or indentation. Using your thumb, make a quick swipe from the top to the bottom with 5 - 7 lbs of pressure to remove excess water.



DRYING THE DOOR EDGE GUARD

- 1) (IMPORTANT: MAKE SURE THE EXCESS SOLUTION HAS BEEN REMOVED PRIOR TO DRYING.) Use a blow dryer on a "LOW" setting to assist in the Door Edge Guard drying process. (PICs #11 & #12) This will seal the edges of the Door Edge Guard to the painted surface. Heat the the edge of the film while simultaneously pressing down on the edge with your thumb. Work your way around all edges both inside and outside of the door, making certain that it is securely sealed and dry.

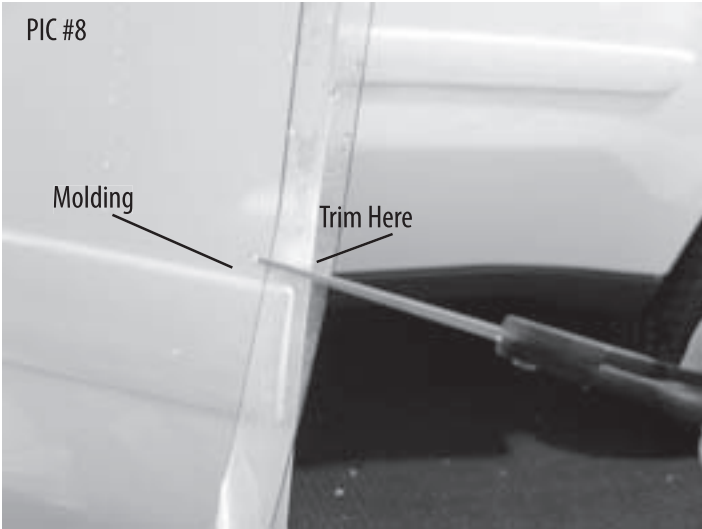

- c. Using sharp scissos, snip the Door Edge Guard approxiamently 1/4" above the molding or indentation. Save the remainder of the Door Edge Guard for installation below the molding or indentation. (PIC #6, #7, #8)
- d. Position the remainder of the Door Edge Guard approximately 1/4" below the molding. (PIC#9) Apply the Door Edge Guard to the outside of the door and snip with scissors 1/4" above the bottom of the door and discard the left-over film. (PIC#10)
- e. Using your thumb, make a quick swipe from the top to the bottom with 5 - 7 lbs of pressure to remove excess water for both upper and lower Door Edge Guards.
- f. Repeat Steps "2d, 2e & 2f" for both upper and lower door edge guards.

- 2) Allow the Door Edge Guard to dry for approximately 24 hours before using a power wash. It is recommended that liquid spray wax be applied on the vehicle and Door Edge Guards after it has dried for this 24 hour period.

Husky Shield® Limited Warranty

Winfield Consumer Products warrants your Husky Shield paint protection product against yellowing or cracking due to discernible defects in the manufactured material for a period of five years following installation. If your finished product is found defective, Husky Shield will authorize the replacement of your product at no charge to the original purchaser. This warranty covers product replacement only. Husky Shield will not provide a monetary refund for the price of the product or charges incurred during installation. This warranty is not transferable. Husky Shield assumes no liability for product failure due to accident, collision, negligence, vandalism or abuse.

THERE IS NO WARRANTY OF MERCHANTABILITY AND NO WARRANTY THAT THE PRODUCT SHALL BE FIT FOR ANY PARTICULAR PURPOSE OR USE. THIS WARRANTY GIVES YOU SPECIFIC LEGAL RIGHTS AND YOU MAY HAVE OTHER RIGHTS WHICH VARY FROM JURISDICTION.

THIS PRODUCT IS TO BE USED IN COMPLIANCE WITH ALL APPLICABLE STATE OR PROVINCIAL LAWS. INSTALLATION OF THIS PRODUCT IN A MANNER THAT VIOLATES STATE OR PROVINCIAL LAW IS A MISUSE OF THE PRODUCT AND VOIDS ALL WARRANTIES, EXPRESS OR IMPLIED, INCLUDING BUT NOT LIMITED TO THE WARRANTY OF MERCHANTABILITY. HUSKY SHIELD SHALL NOT BE LIABLE IN ANY MANNER WHATSOEVER FOR DAMAGES RELATED TO THE USE OF THIS PRODUCT IN AN ILLEGAL MANNER.

For warranty service contact your Husky Shield dealer or call Winfield Consumer Products at (800) 344-8759.

If you have any questions or concerns please contact us prior to beginning installation at 800-344-8759. You can also find us on the internet at www.huskyshield.com.