

# INSTALLATION INSTRUCTIONS

## 57-3025-1 Chevrolet/GMC S-10/Sonoma 1998-2003 2.2L L4

NOTE: This kit was not designed to fit vehicles with a body lift.

### TOOLS NEEDED:

Flat Blade Screwdriver  
Socket Extension  
4mm Allen Wrench  
Ratchet  
10mm Socket  
Pair of Dykes  
Pair of Pliers

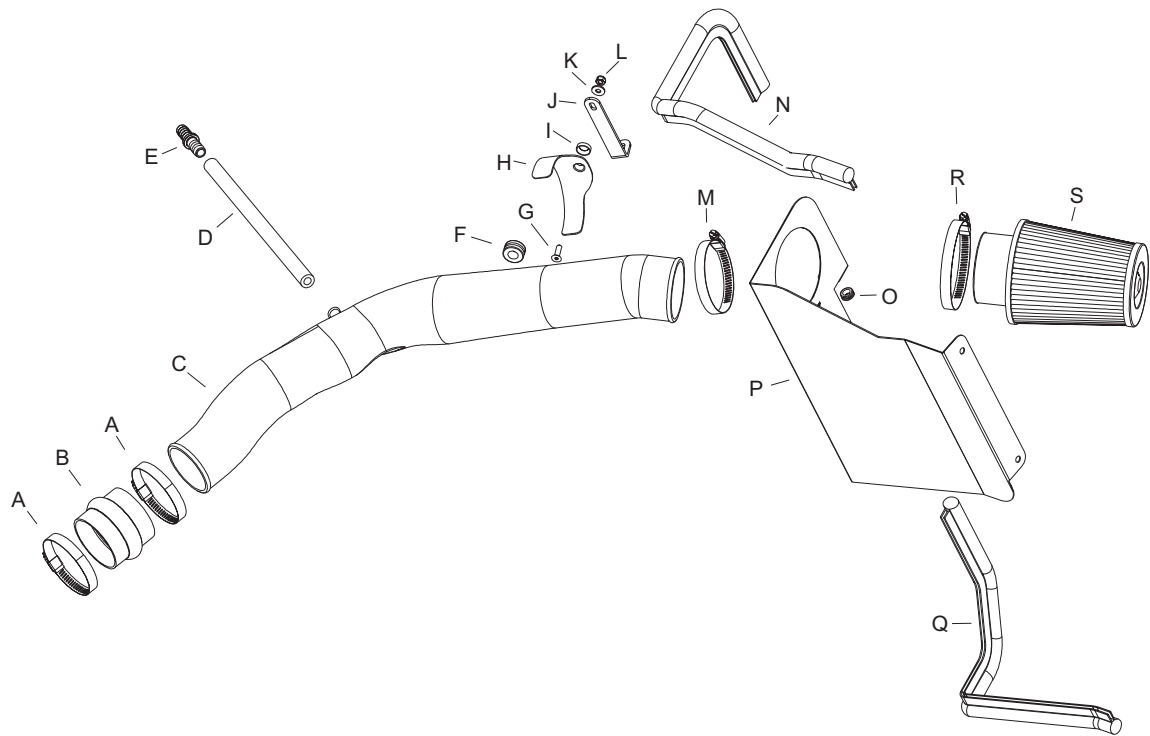

### PARTS LIST:

| Desc.            | Qty. | Part# | Desc.             | Qty. | Part#  | Desc.                    | Qty. | Part#   |
|------------------|------|-------|-------------------|------|--------|--------------------------|------|---------|
| A Hose Clamp #44 | 2    | 08577 | F Grommet 1" O.D. | 1    | 08064  | K Washer                 | 1    | 08275   |
| B Hump Hose      | 1    | 08185 | G Bolt 6mm        | 1    | 08376  | L Nut 6mm                | 1    | 07553   |
| C Intake Tube    | 1    | 26091 | H Saddle Bracket  | 1    | 078855 | M Hose Clamp #48         | 1    | 08601   |
| D Vent Hose      | 1    | 08402 | I Conical Washer  | 1    | 08180  | N Edge Trim 23" L        | 1    | 102495  |
| E Hose Mender    | 1    | 08686 | J Bracket         | 1    | 070952 | O Grommet                | 1    | 08090   |
|                  |      |       |                   |      |        | P Heat Shield            | 1    | 07431   |
|                  |      |       |                   |      |        | Q Edge Trim 20" L        | 1    | 102494  |
|                  |      |       |                   |      |        | R Hose Clamp #48         | 1    | 08601   |
|                  |      |       |                   |      |        | S Filtercharger® Element | 1    | RC-4650 |

### TO START:

1. Turn the ignition OFF and disconnect the vehicle's negative battery cable.



2. Disconnect the air temperature sensor electrical connection.



3. Detach the clip that retains the a/c lines to the radiator shroud.



4. Loosen the hose clamp on the intake hose at the airbox.



5. Loosen the hose clamp on the intake hose at the resonator.



6. Pry up on the two push clips that retain the intake tube to the radiator shroud.



7. Detach the intake hose from the resonator.



8. Detach the intake hose from the airbox.



9. Remove the entire intake tube assembly.



10. Loosen and remove the nut that retains the airbox to its mounting stud and remove airbox.



11. Press on the tab and lift and remove the airbox mounting bracket from the radiator core support.



12. Loosen and remove the bolt that retains the resonator to its mounting bracket.



13. Loosen the hose clamp on the resonator at the throttle body.



14. Detach the crankcase vent hose from the valve cover.



15. Detach the resonator from the throttle body and remove it.



16. Install the trim seal onto the heat shield as shown.



17. Install the 3/8"ID grommet onto the airbox mounting stud.



18. Pry up on and remove the two push clips from the radiator core support.



19. Install the heat shield.



20. Secure the heat shield to the radiator core support using the clips removed in step 18.



21. Assemble the saddle and "L" bracket using the hardware provided.



22. Install the saddle bracket assembly onto the airbox mounting stud and secure using the hardware provided.

**Note:** Do not tighten completely at this time.

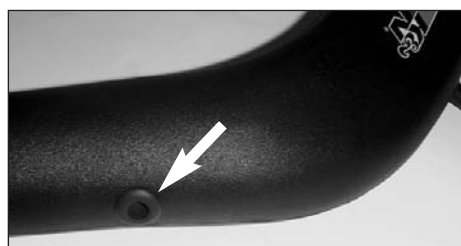

23. Install the 1/2"ID grommet into the K&N intake tube.



24. Remove the air temperature sensor from the stock intake hose.



25. Install the air temperature sensor into the grommet in the K&N intake tube.



26. Attach the hump hose onto the K&N intake tube and tighten hose clamp.



27. Detach the O.E. crankcase vent hose from the resonator.



28. Connect the O.E. crankcase vent hose and vent hose provided using the hose mender.



29. Attach the vent hose assembly to the vent fitting on the valve cover.

30. Install the intake tube feeding it thru the hole in the heat shield.

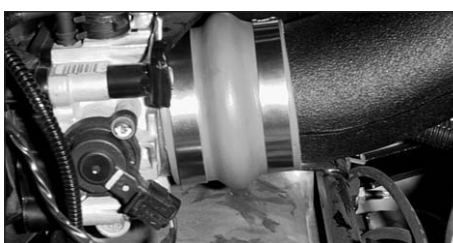

31. Attach the hump hose to the throttle body and tighten hose clamp.



32. Secure the saddle bracket to the intake tube using the hose clamp provided.



33. Attach the vent hose to the vent fitting on the intake tube.

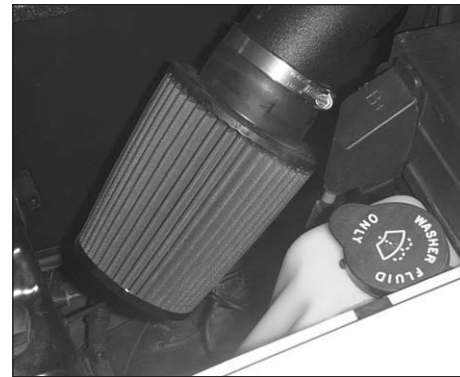

34. Install the filtercharger element and tighten hose clamp.

35. Align the intake tube for best clearance and tighten the nut that retains the "L" bracket to the stud.

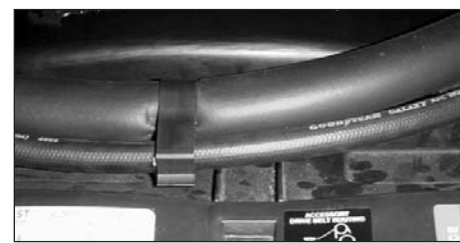

36. Secure the a/c lines to the radiator shroud with the retaining clip.



37. Reconnect the air temperature sensor electrical connection.

38. Reconnect the vehicle's negative battery cable. Double check to make sure everything is tight and properly positioned before starting the vehicle.

39. The C.A.R.B. exemption sticker, (attached), must be visible under the hood so that an emissions inspector can see it when the vehicle is required to be tested for emissions. California requires testing every two years, other states may vary.

40. It will be necessary for all FIPK's to be checked periodically for realignment, clearance and tightening of all connections. Failure to follow the above instructions or proper maintenance may void warranty.

#### ROAD TESTING:

1. Start the engine with the transmission in neutral or park, and the parking brake engaged. Listen for air leaks or odd noises. For air leaks secure hoses and connections. For odd noises, find cause and repair before proceeding. This kit will function identically to the factory system except for being louder and much more responsive.

2. Test drive the vehicle. Listen for odd noises or rattles and fix as necessary.

3. If road test is fine, you can now enjoy the added power and performance from your kit.

4. K&N suggests checking the Filtercharger element periodically for excessive dirt build-up. When the element becomes covered in dirt (or once a year), service it according to the instructions on the Recharger service kit, part number 99-5050 or 99-5000.