



AIRCHARGER™

HIGH-FLOW INTAKE KITS

NOT LEGAL FOR SALE OR USE ON ANY POLLUTION CONTROLLED MOTOR VEHICLE IN CALIFORNIA OR STATES ADOPTING CALIFORNIA EMISSION PROCEDURES.
See knfilters.com for CARB status on each part for a specific vehicle

INSTALLATION INSTRUCTIONS

63-3056
CHEVROLET
2008-11 HHR
L4-2.4L
2010-11 HHR
L4-2.2L

NOTE: This kit was not designed to fit vehicles with a body lift.

TOOLS NEEDED:

- Flat Blade Screwdriver
- 20 Torx Socket
- 27 Torx Socket
- 2.5mm Allen Wrench
- 3mm Allen Wrench
- 4mm Allen Wrench
- 7/16" Wrench
- Ratchet
- Extension

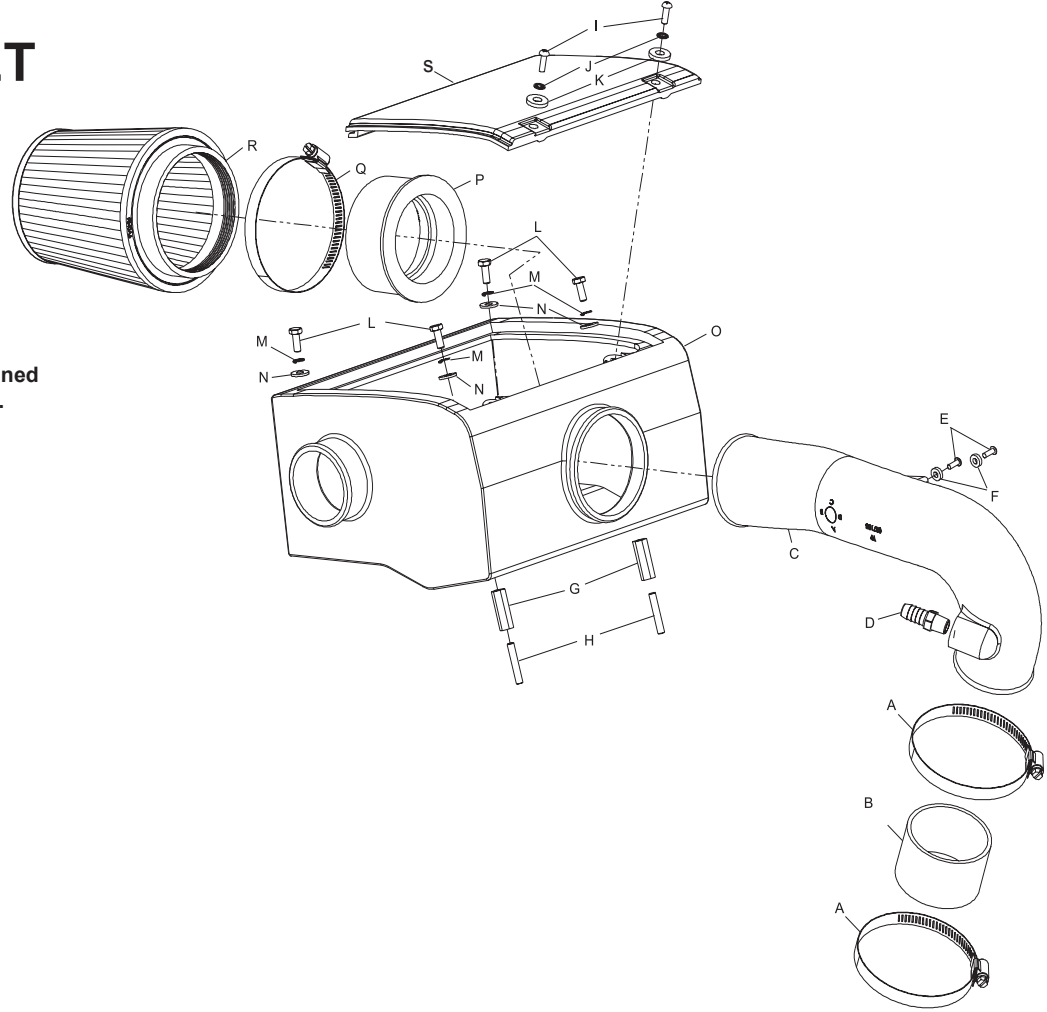

PARTS LIST:

Description	Qty.	Part #
A hose clamp; #44	2	08560
B Hose; 2.75" id X 2" L, silicone	1	08756
C intake tube (FP)	1	087188
D vent; str 1/2" hose, 1/4" npt	1	080022
E bolt; m4-.7x12mm, b/h/a	2	07726
F spacer; .437" o.d. x .200" i.d. x .115" thk	2	06503
G nut; 6mm x 1.33" l, coupling	2	08254
H stud; 6mm-1.00 x 35mm l, ss	2	08220
I bolt; m5	2	22208
J washer; 5mm internal star, lock	2	07724
K washer; flat #10	2	08257
L bolt; m6 x 1.00 x 16mm	4	07703
M washer; 1/4" split lock	4	08198
N washer; 1/4" id x 5/8" od, flat	4	08275
O airbox (FQ)	1	087189-1
P filter adapter	1	21561
Q Hose clamp #64	1	08648
R air filter	1	RC-5149
S Lid	1	087286

NOTE: FAILURE TO FOLLOW INSTALLATION INSTRUCTIONS AND NOT USING THE PROVIDED HARDWARE MAY DAMAGE THE INTAKE TUBE, THROTTLE BODY AND ENGINE.

TO START:

1. Turn off the ignition and disconnect the negative battery cable.
NOTE: Disconnecting the negative battery cable erases pre-programmed electronic memories. Write down all memory settings before disconnecting the negative battery cable. Some radios will require an anti-theft code to be entered after the battery is reconnected. The anti-theft code is typically supplied with your owner's manual. In the event your vehicles' anti-theft code cannot be recovered, contact an authorized dealership to obtain your vehicles anti-theft code.

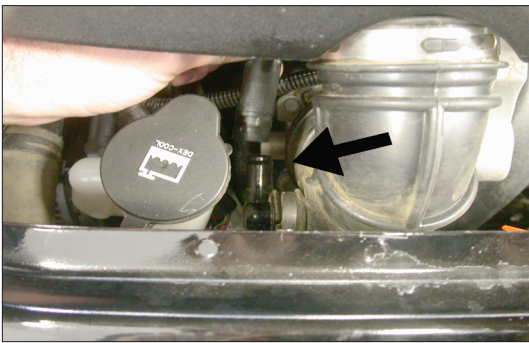

2. Loosen the hose clamp, which secures the crank case vent hose to the stock intake tube, and then disconnect the crank case vent hose from the stock intake tube as shown.



3. Loosen the hose clamp, which secures the intake tube to the throttle body, and then pull up on the intake tube/airbox assembly to dislodge it from the mounting grommets and disconnect the intake tube from the throttle body.

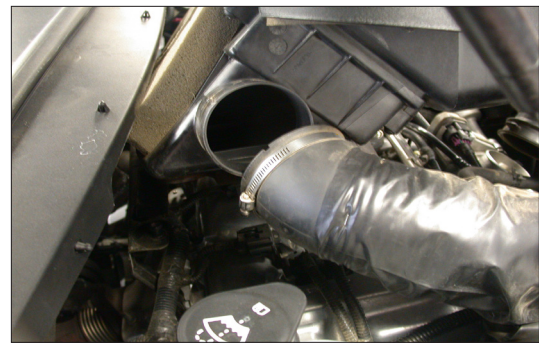

4. Lift the air box assembly up enough to gain access to the fresh air supply hose clamp, then loosen the clamp and disconnect the fresh air supply hose from the air box assembly.

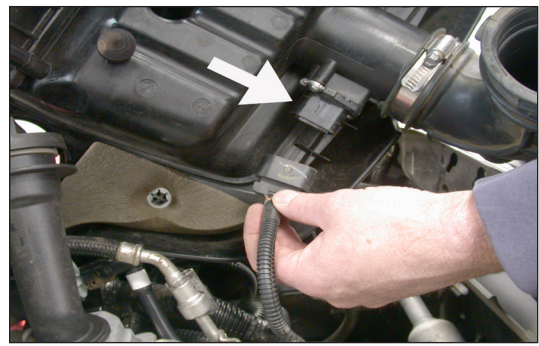

5. Flip the air box assembly up towards the driver's side of the vehicle to gain access to the mass air sensor electrical connection, and then disconnect the mass air sensor electrical connection as shown.



6. Remove the air box assembly from the vehicle. **NOTE: K&N Engineering, Inc., recommends that customers do not discard factory air intake.**

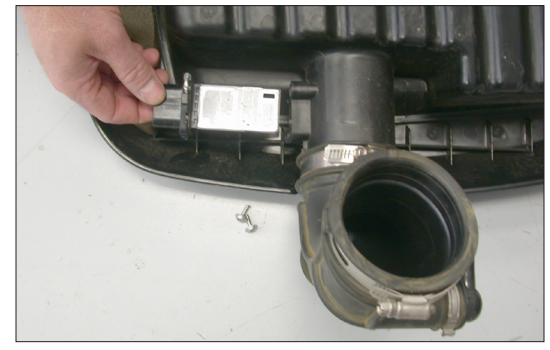

7. Remove the two screws securing the mass air sensor to the stock intake tube and then remove the sensor as shown.

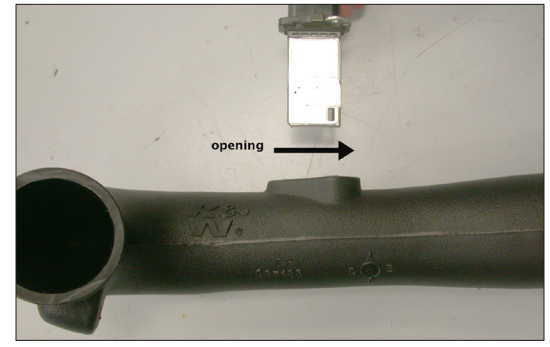

8. Install the mass air sensor into the intake tube as shown. **NOTE: The small opening in the sensor will be pointed towards the filter end of the tube.**



9. Secure the mass air sensor to the intake tube with the screws and spacers provided.



10. Install the supplied crank case vent fitting into the intake tube as shown.

NOTE: Plastic NPT fittings are easy to cross thread. Install the vent fitting "hand" tight, then turn it two complete turns with a wrench.

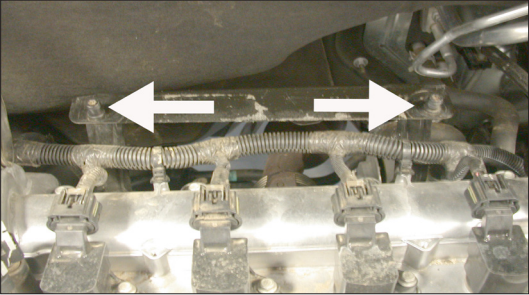

11. Remove the two stock air box mounting anchors shown from the mounting bracket.

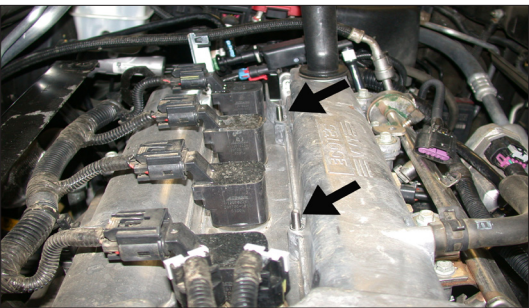

12. Install the two supplied 6mm studs into the valve cover as shown.

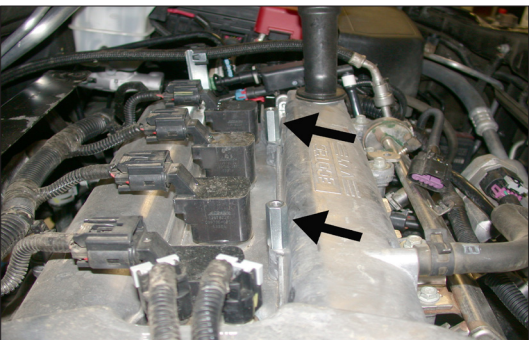

13. Thread and tighten the two coupling nuts onto the studs installed in step #12.



14. Install the K&N® air box onto the engine. Using the supplied hardware, secure the air box to the rear mounting bracket first and then to the coupling nuts installed in step #13.



15. Install the fresh air supply hose onto the K&N® air box and secure with the factory hose clamp.



16. Install the silicone hose (08756) onto the throttle body and secure with the provided hose clamp.

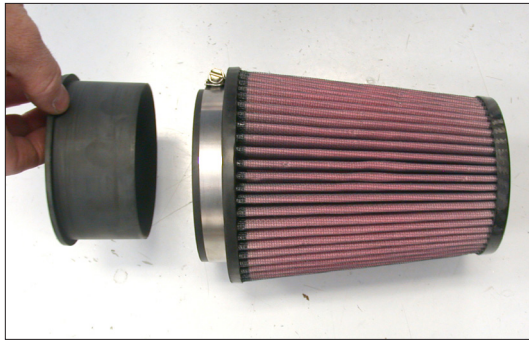

17. Install the filter adapter into the K&N® filter as shown.

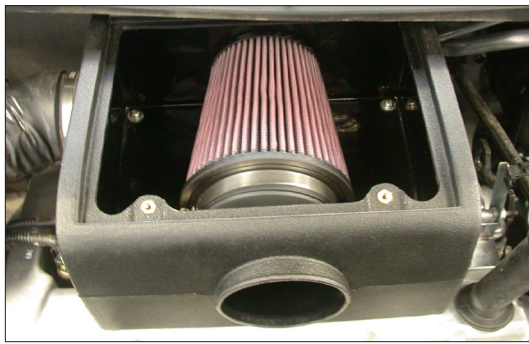

18. Place the filter assembly into the K&N® air box as shown.

NOTE: Drycharger® air filter wrap; part # RC-5149DK is available to purchase separately. To learn more about Drycharger® filter wraps or look up color availability please visit <http://www.knfilters.com>.

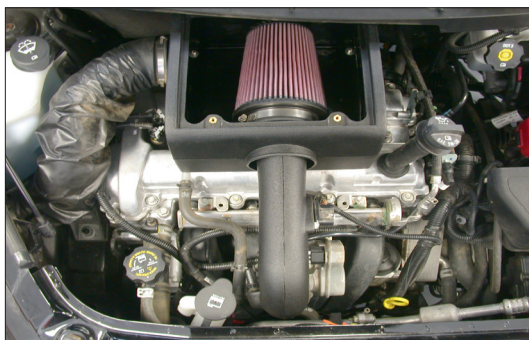

19. Install the K&N® intake tube through the opening in the air box and into the filter assembly. Then install the intake tube into the silicone hose at the throttle body and secure the filter and tube with the provided hose clamps.

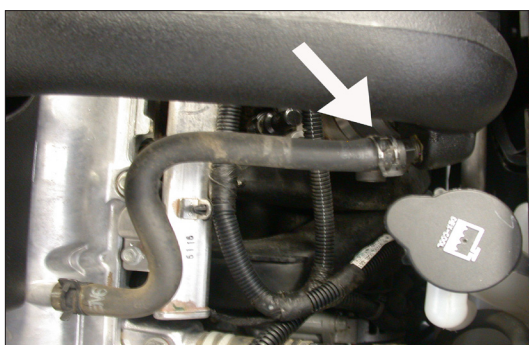

20. Install the stock crank case vent hose onto the fitting on the K&N® intake tube and secure with the stock hose clamp.



21. Install the K&N® air box lid and secure with the provided hardware as shown.

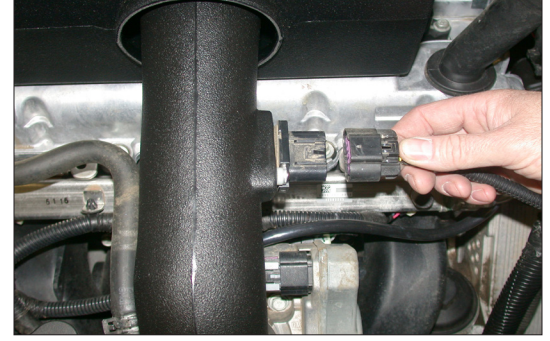

22. Reconnect the vehicle's mass air sensor electrical connection.

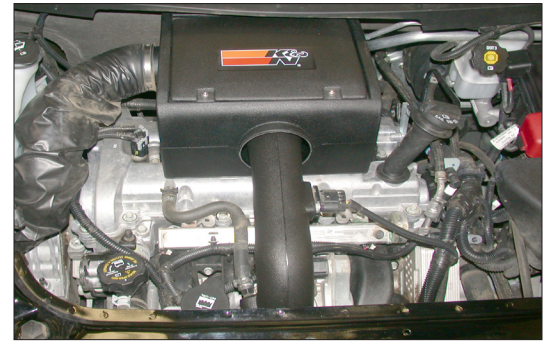

23. Reconnect the vehicle's negative battery cable. Double check to make sure everything is tight and properly positioned before starting the vehicle.

24. It will be necessary for all K&N® high flow intake systems to be checked periodically for realignment, clearance and tightening of all connections. Failure to follow the above instructions or proper maintenance may void warranty.

ROAD TESTING:

1. Start the engine with the transmission in neutral or park, and the parking brake engaged. Listen for air leaks or odd noises. For air leaks secure hoses and connections. For odd noises, find cause and repair before proceeding. This kit will function identically to the factory system except for being louder and much more responsive.

2. Test drive the vehicle. Listen for odd noises or rattles and fix as necessary.

3. If road test is fine, you can now enjoy the added power and performance from your kit.

4. K&N Engineering, Inc., requires cleaning the intake system's air filter element every 100,000 miles. When used in dusty or off-road environments, our filters will require cleaning more often. We recommend that you visually inspect your filter once every 25,000 miles to determine if the screen is still visible. When the screen is no longer visible some place on the filter element, it is time to clean it. To clean and re-oil, purchase our filter Recharger® service kit, part number 99-5050 or 99-5000 and follow the easy instructions.

NOT LEGAL FOR SALE OR USE ON ANY POLLUTION CONTROLLED MOTOR VEHICLE IN CALIFORNIA OR STATES ADOPTING CALIFORNIA EMISSION PROCEDURES.

See knfilters.com for CARB status on each part for a specific vehicle