



INTAKE SYSTEMS FOR VEHICLES LISTED ARE 50 STATE LEGAL. SEE KNFILTERS.COM FOR CARB STATUS ON EACH PART FOR A SPECIFIC VEHICLE.

## INSTALLATION INSTRUCTIONS

### 77-2580KP FORD 2009-10 F150 V8-4.6L

Excludes 2 Valve Vin W Vehicles

NOTE: This kit was not designed to fit vehicles with a body lift.

#### TOOLS NEEDED:

Flat Blade Screwdriver  
4mm Allen Wrench  
3mm Allen Wrench  
5/8" Wrench  
T20 TORX

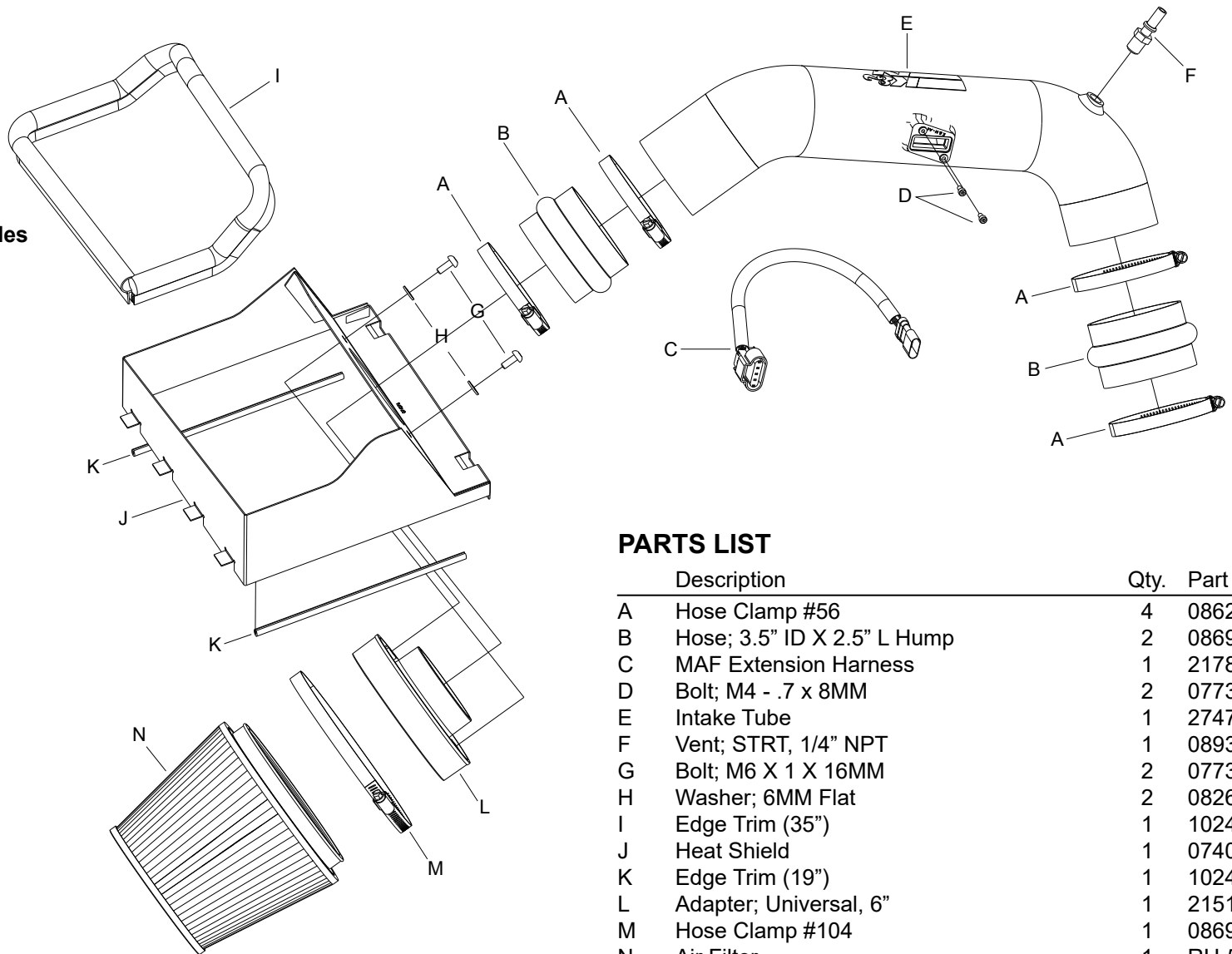

#### PARTS LIST

	Description	Qty.	Part #
A	Hose Clamp #56	4	08620
B	Hose; 3.5" ID X 2.5" L Hump	2	08699
C	MAF Extension Harness	1	21780
D	Bolt; M4 - .7 x 8MM	2	07733
E	Intake Tube	1	27479KP
F	Vent; STRT, 1/4" NPT	1	08938
G	Bolt; M6 X 1 X 16MM	2	07730
H	Washer; 6MM Flat	2	08269
I	Edge Trim (35")	1	102471A
J	Heat Shield	1	074076A
K	Edge Trim (19")	1	102451
L	Adapter; Universal, 6"	1	21512-1
M	Hose Clamp #104	1	08697
N	Air Filter	1	RU-5173

If you need any assistance please call 1-800-858-3333 to speak with a representative in our Customer Service Center before returning the product.

**NOTE: FAILURE TO FOLLOW INSTALLATION INSTRUCTIONS AND NOT USING THE PROVIDED HARDWARE MAY DAMAGE THE INTAKE TUBE, THROTTLE BODY AND ENGINE.**

#### TO START:

1. Turn off the ignition and disconnect the negative battery cable.

**NOTE: Disconnecting the negative battery cable erases pre-programmed electronic memories. Write down all memory settings before disconnecting the negative battery cable. Some radios will require an anti-theft code to be entered after the battery is reconnected. The anti-theft code is typically supplied with your owner's manual. In the event your vehicles' anti-theft code cannot be recovered, contact an authorized dealership to obtain your vehicles anti-theft code.**



2. Release the red locking tab and then disconnect the mass air sensor electrical connection.



3. Release the green locking tab and then disconnect the crankcase vent line from the intake tube as shown.



4. Loosen the hose clamp that secures the intake tube to the throttle body.



5. Release the three retaining clips that secure the upper airbox to the lower airbox.



6. Remove the upper airbox housing and intake tube assembly from the vehicle.  
**NOTE: K&N Engineering, Inc., recommends that customers do not discard factory air intake.**



7. Remove the air filter from the lower airbox.



8. Remove the center upper airbox retaining clip from the lower airbox.



9. Install the K&N® filter adapter into the heat shield as shown. Secure with the provided hardware.



10. Install the provided edge trim onto the heat shield as shown.

**NOTE: Some trimming of the edge trim will be necessary.**



11. Cut the 19" section of small edge trim into two 9-1/2" lengths.



12. Install the two 9-1/2" lengths of small edge trim onto the heat shield as shown.



13. Install the K&N® air filter onto the filter adapter and secure with the provided hose clamp.



14. Install the provided silicone hose (08699) onto the filter adapter as shown. Secure with the provided hose clamp.



15. Install the completed heat shield/filter assembly onto the lower airbox. Secure with the two factory airbox retaining clips.

**NOTE: A gap is normal between the lower airbox and the heat shield on the clip side of the heat shield.**



16. Install the provided silicone hose (08699) onto the throttle body and secure with the provided hose clamp.



17. Remove the two screws securing the mass air sensor to the factory airbox, and then remove the mass air sensor.



18. Install the mass air sensor into the K&N® intake tube as shown, secure with the provided hardware.



19. Install the provided crankcase vent fitting into the K&N® intake tube as shown.

**NOTE: Plastic NPT fittings are easy to cross thread. Install the vent fitting "hand" tight, then turn it two complete turns with a wrench.**



20. Install the K&N® intake tube; insert the lower end into the silicone hose attached to the heat shield /air filter assembly. Attach the upper end of the intake tube to the silicone hose secured to the throttle body. Secure the intake tube with the provided hose clamps.



21. Rotate the crankcase vent coupler so it lines up with the fitting installed into the K&N® intake tube; connect the coupler to the fitting.



22. Connect the provided mass air sensor extension harness into the factory connector and then connect the open end to the mass air sensor electrical connection.

**NOTE: Be sure to lock the mass air sensor connections with the red tabs.**



23. Reconnect the vehicle's negative battery cable. Double check to make sure everything is tight and properly positioned before starting the vehicle.

24. The C.A.R.B. exemption sticker, (attached), must be visible under the hood so that an emissions inspector can see it when the vehicle is required to be tested for emissions. California requires testing every two years, other states may vary.

25. It will be necessary for all K&N® high flow intake systems to be checked periodically for realignment, clearance and tightening of all connections. Failure to follow the above instructions or proper maintenance may void warranty.

#### ROAD TESTING:

1. Start the engine with the transmission in neutral or park, and the parking brake engaged. Listen for air leaks or odd noises. For air leaks secure hoses and connections. For odd noises, find cause and repair before proceeding. This kit will function identically to the factory system except for being louder and much more responsive.

2. Test drive the vehicle. Listen for odd noises or rattles and fix as necessary.

3. If road test is fine, you can now enjoy the added power and performance from your kit.

4. K&N Engineering, Inc., suggests checking the air filter element periodically for excessive dirt build-up. When the element becomes covered in dirt (or once a year), service it according to the instructions on the Recharger® service kit, part number 99-5050 or 99-5000.

**INTAKE SYSTEMS FOR VEHICLES LISTED ARE 50 STATE LEGAL. SEE KNFILTERS.COM FOR CARB STATUS ON EACH PART FOR A SPECIFIC VEHICLE.**