

182739

07-15 JK DUAL WINDSHIELD PILLAR LIGHT
KIT

**OFF CAMBER
FABRICATIONS**

by: **MBRP** INC.

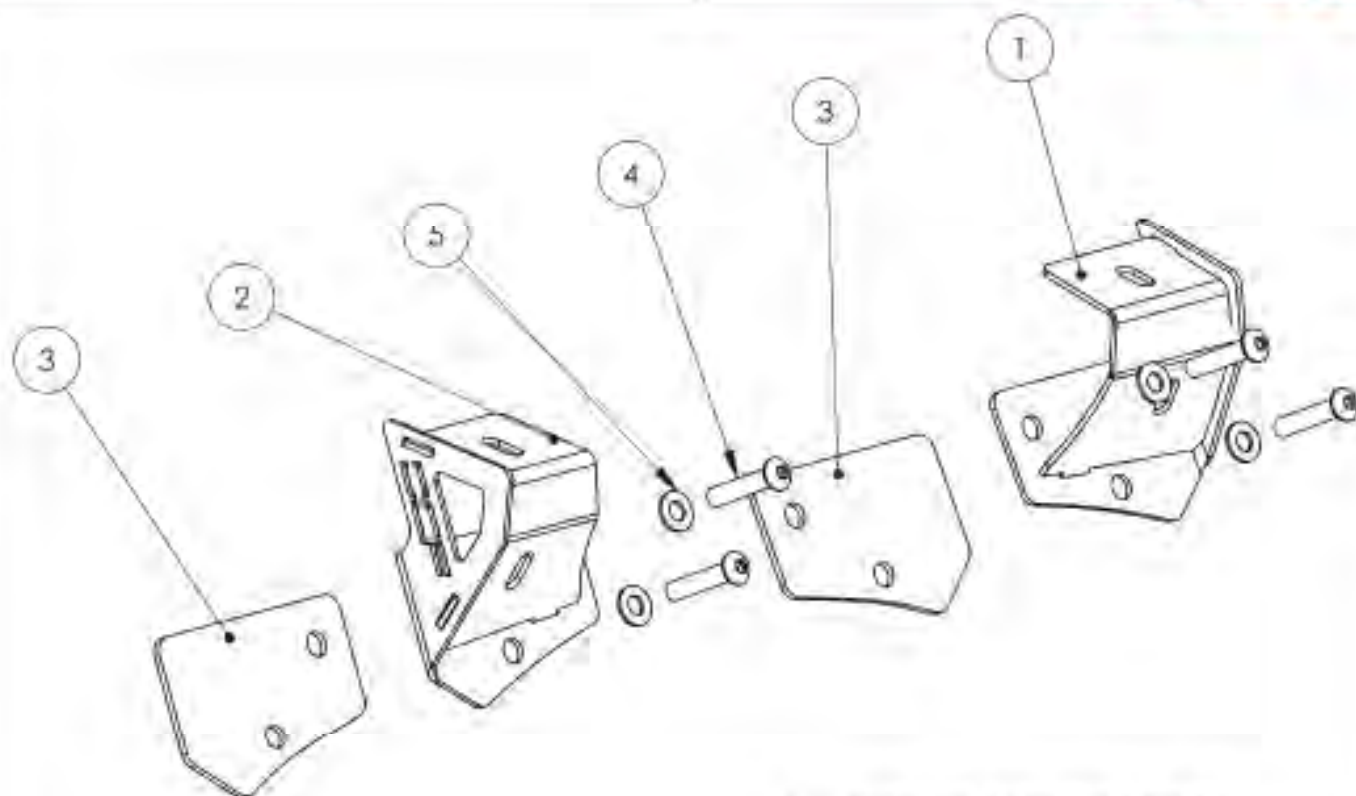

1. DRIVER SIDE BRACKET
2. PASSENGER SIDE BRACKET
3. GASKET [2 PCS]
4. M8x40 BOLT [4 PCS]
5. WASHER [4 PCS]

PLEASE READ BEFORE STARTING INSTALLATION

While MBRP Inc. has made every effort to ensure that all components of this kit are of superior quality and properly packaged, it is the installer's responsibility to ensure the following before starting:

- that ALL components shown above are present.
- that ALL mating components fit together.
- that there are no damaged components.
- that the kit you have purchased is appropriate for your year and model of vehicle.
- that the kit will not interfere with any modifications previously installed or planned.
- that you have read and understand these instructions.

If you have any questions or are uncertain about any aspect of the installation of this kit on your vehicle please contact your dealer before commencing installation.

This kit can be installed on its own, or along with OCF 182746/182760 Windshield Light Bar kit. Pictures show installation with the windshield light bar kit installed.



Figure 1



Figure 2



Figure 3



Figure 4.

1. Remove both forward facing driver side windshield frame bolts using a T40 torx bit. **Refer to Figure 1.**

NOTE: Installation with the windshield light bar kit requires the use of the supplied M8x40 Bolts and Washers. If the Dual Windshield Pillar Brackets are being installed directly to the body, reuse the original hardware.

2. Install the protective **Gasket** against the backside of the **Driver Side Bracket** and insert the appropriate hardware as described above, through the mounting holes. **Refer to Figure 2.**
3. Install the **Bracket/Gasket** assembly to the vehicle and loosely install the bolts. **Refer to Figure 3.**
4. With both bolts loose, adjust the position of the **Driver Side Bracket** and **Gasket** ensuring the bracket is level and centered over the **Gasket**. Once the position has been set, tighten the bolts.
5. Repeat steps 1-4 to install the **Passenger Side Bracket**.
6. Install your choice of Lights. Wiring can be routed into the engine compartment through the rear gap of the cowl panel. **Refer to Figure 4.**

Congratulations! You're finished! We are sure that you will enjoy this **Off Camber Fabrications** product by **MBRP Inc.**