

S5126

06-08 DODGE RAM 1500, 5.7L HEMI
SC/CC-SB CAT BACK, DUALS REAR
EXIT

MBRP
INC.
PERFORMANCE EXHAUST

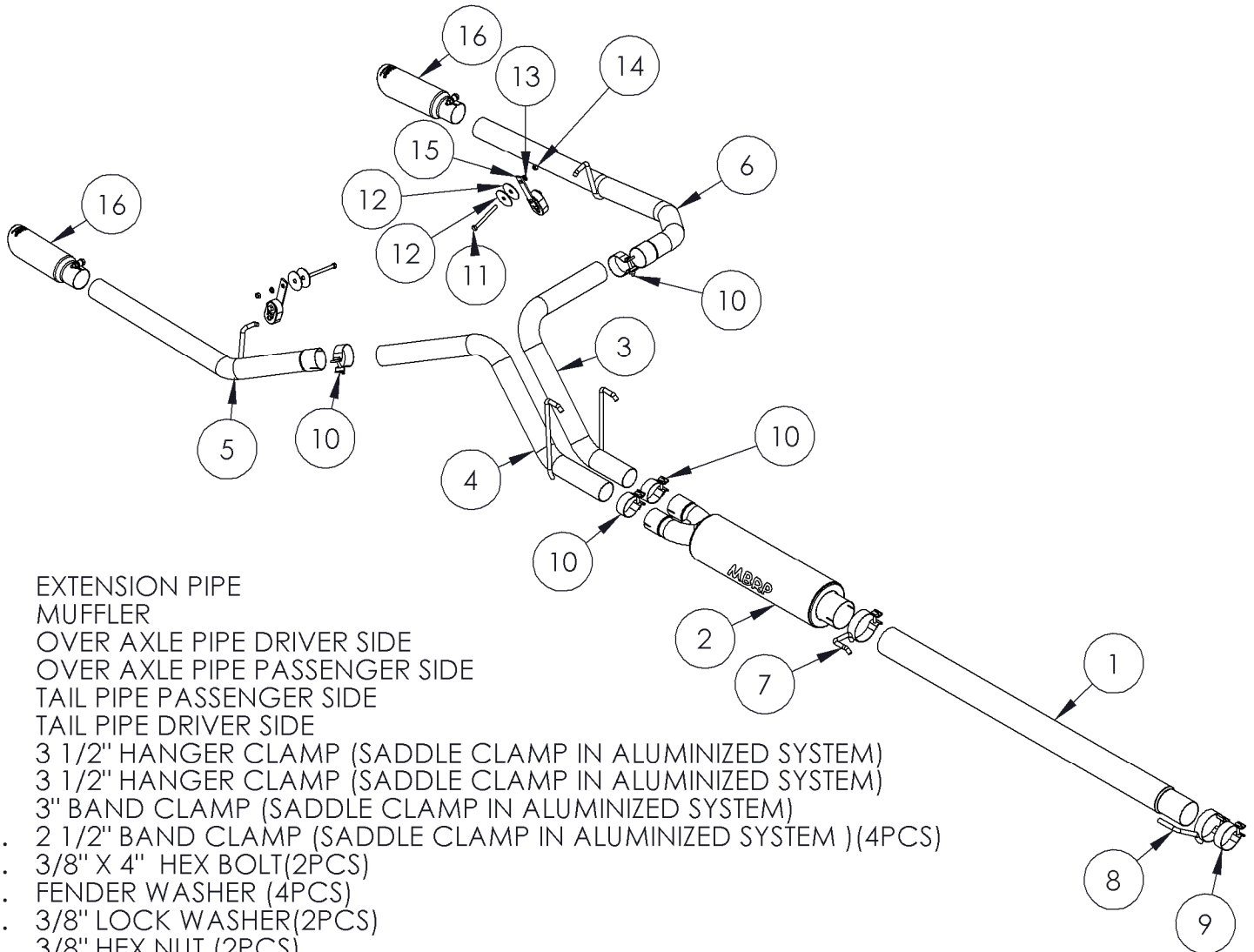

1. EXTENSION PIPE
2. MUFFLER
3. OVER AXLE PIPE DRIVER SIDE
4. OVER AXLE PIPE PASSENGER SIDE
5. TAIL PIPE PASSENGER SIDE
6. TAIL PIPE DRIVER SIDE
7. 3 1/2" HANGER CLAMP (SADDLE CLAMP IN ALUMINIZED SYSTEM)
8. 3 1/2" HANGER CLAMP (SADDLE CLAMP IN ALUMINIZED SYSTEM)
9. 3" BAND CLAMP (SADDLE CLAMP IN ALUMINIZED SYSTEM)
10. 2 1/2" BAND CLAMP (SADDLE CLAMP IN ALUMINIZED SYSTEM)(4PCS)
11. 3/8" X 4" HEX BOLT(2PCS)
12. FENDER WASHER (4PCS)
13. 3/8" LOCK WASHER(2PCS)
14. 3/8" HEX NUT (2PCS)
15. HANGER ASSEMBLY (2PCS)
16. EXHAUST TIP(2PCS)

PLEASE READ BEFORE STARTING INSTALATION

While MBRP Inc. has made every effort to ensure that all components of this system are of superior quality and properly packaged, it is the installer's responsibility to ensure the following before removal of the factory exhaust:

- that ALL components shown above are present.
- that ALL mating components fit together.
- that there are no damaged components.
- that the system you have purchased is appropriate for your vehicle year, model and configuration.
- that the system will not interfere with any modifications previously installed or planned.
- that you have read and understand these instructions.

If you have any questions or are uncertain about any aspect of the installation of this system to your vehicle please contact your dealer before commencing installation.



2006 Dodge Ram 5.7L Hemi

"COOL DUALS"™

Removal of stock system:

1. Apply a penetrating lubricant liberally to all exhaust fasteners, hangers and rubber insulators.
2. Remove the clamp located behind the muffler. Remove the tail pipe hanger from the rubber insulator and separate the tail pipe from the muffler at the slip joint. Remove the tail pipe from the vehicle.
3. Remove the clamp in front of the muffler and separate the muffler at the slip joint.
4. Remove the hangers from the rubber insulators and remove the muffler assembly from the vehicle.

Installation of MBRP Inc. Performance Exhaust:

NOTE: This system does not require the removal of the spare tire.

Quad Cab Models

1. Install the expanded end of the **Extension Pipe** over the factory exhaust system behind the "Y" pipe. Now install the first **Hanger Clamp** onto the **Extension Pipe** to help support it.
2. Place the **Muffler** onto extension pipe.
3. Loosely connect the **Driver Side Over Axle Pipe** to the muffler outlet closest to the drive shaft and place the hanger into the rubber insulator.
4. Feed the **Passenger Side Over Axle Pipe** over the axle and connect it to the remaining muffler outlet. Now place the hanger into the rubber insulator.
5. Feed the expanded end of the **Driver Side Tail Pipe** from the rear of the vehicle over the axle and connect it to the **Driver Side Over Axle Pipe**.
6. Move the **Driver Side Tail Pipe** into approximate position. Using the factory hole provided in the frame located directly above the tail pipe hanger, attach the **Hanger Assembly** provided using the supplied hardware.
7. Remove the factory rubber insulator for the factory tail pipe. Now feed the expanded end of the **Passenger Side Tail Pipe** from the rear of the vehicle over the axle and loosely connect it to the **Passenger Side Over Axle Pipe**.
8. Move the **Passenger Side Tail Pipe** into approximate position. Using the factory hole provided in the frame located directly above the tail pipe hanger, attach the **Hanger Assembly** provided using the supplied hardware.
9. Install the **Mirror Polished Tips**. It is recommended to install them at this point to assist with the final system alignment.
10. Install the **Hanger Clamp** around the front muffler joint and into the factory rubber insulator located on the frame near the front of the **Muffler**.
11. Install the provided **Clamps** to the pipe connections where required. Align the exhaust as required before tightening **Clamps**.
12. Starting at the front of the exhaust, tighten all clamps and connections.
13. Check along the whole length of the exhaust system to ensure that there is adequate clearance around the spare tire, fuel and brake lines or any wiring. If any interference is detected relocate or adjust.



PERFORMANCE EXHAUST

Regular Cab Models

1. Temporarily install the **Passenger Side** and **Driver Side Over Axle Pipes** by placing hangers into the factory rubber insulators. Loosely install the **Muffler** onto the **Over Axle Pipes** with the **Driver Side Over Axle Pipe** connected to the muffler outlet closest to the drive shaft. Support the **Muffler** so that it is level with the vehicle. Now measure from the front of the **Muffler** to the "Y" pipe. This will give you the required length for the **Extension Pipe**. Remove the **Muffler** and **Over Axle Pipes**.
2. Cut the **Extension Pipe** to the required length. Install the expanded end of the **Extension Pipe** over the factory exhaust system behind the "Y" pipe. Now install the first **Hanger Clamp** onto the **Extension Pipe** to help support it.
3. Place the **Muffler** onto **Extension Pipe**.
4. Loosely connect the **Driver Side Over Axle Pipe** to the outlet closest to the drive shaft and place the hanger into the rubber insulator.
5. Feed the **Passenger Side Over Axle Pipe** over the axle and connect it to the remaining muffler outlet. Now place the hanger into the rubber insulator.
6. Feed the expanded end of the **Driver Side Tail Pipe** from the rear of the vehicle over the axle and connect it to the **Driver Side Over Axle Pipe**.
7. Move the **Driver Side Tail Pipe** into approximate position. Using the factory hole provided in the frame located directly above the tail pipe hanger, attach the **Hanger Assembly** provided using the supplied hardware.
8. Remove the factory rubber insulator for the factory tail pipe. Now feed the expanded end of the **Passenger Side Tail Pipe** from the rear of the vehicle over the axle and loosely connect it to the **Passenger Side Over Axle Pipe**.
9. Move the **Passenger Side Tail Pipe** into approximate position. Using the factory hole provided in the frame located directly above the tail pipe hanger, attach the **Hanger Assembly** provided using the supplied hardware.
10. Install the **Mirror Polished Tips**. It is recommended to install them at this point to assist with the final system alignment.
11. Install the **Hanger Clamp** around the front muffler joint and into the factory rubber insulator located on the frame near the front of the **Muffler**.
12. Install the provided **Clamps** to the pipe connections where required. Align the exhaust as required before tightening **Clamps**.
13. Starting at the front of the exhaust, tighten all clamps and connections.
14. Check along the whole length of the exhaust system to ensure that there is adequate clearance around the spare tire, fuel and brake lines or any wiring. If any interference is detected relocate or adjust.

Congratulations! You are ready to begin enjoying the improved performance and driving experience of your MBRP Inc. Cool Duals system. We hope you enjoy your purchase.