

S5148

2003-2012 DODGE RAM 2500/3500 5.7L HEMI,
2006-2008 DODGE 1500, MEGA CAB 5.7L HEMI,
CAT BACK SINGLE

MBRP
INC.
PERFORMANCE EXHAUST

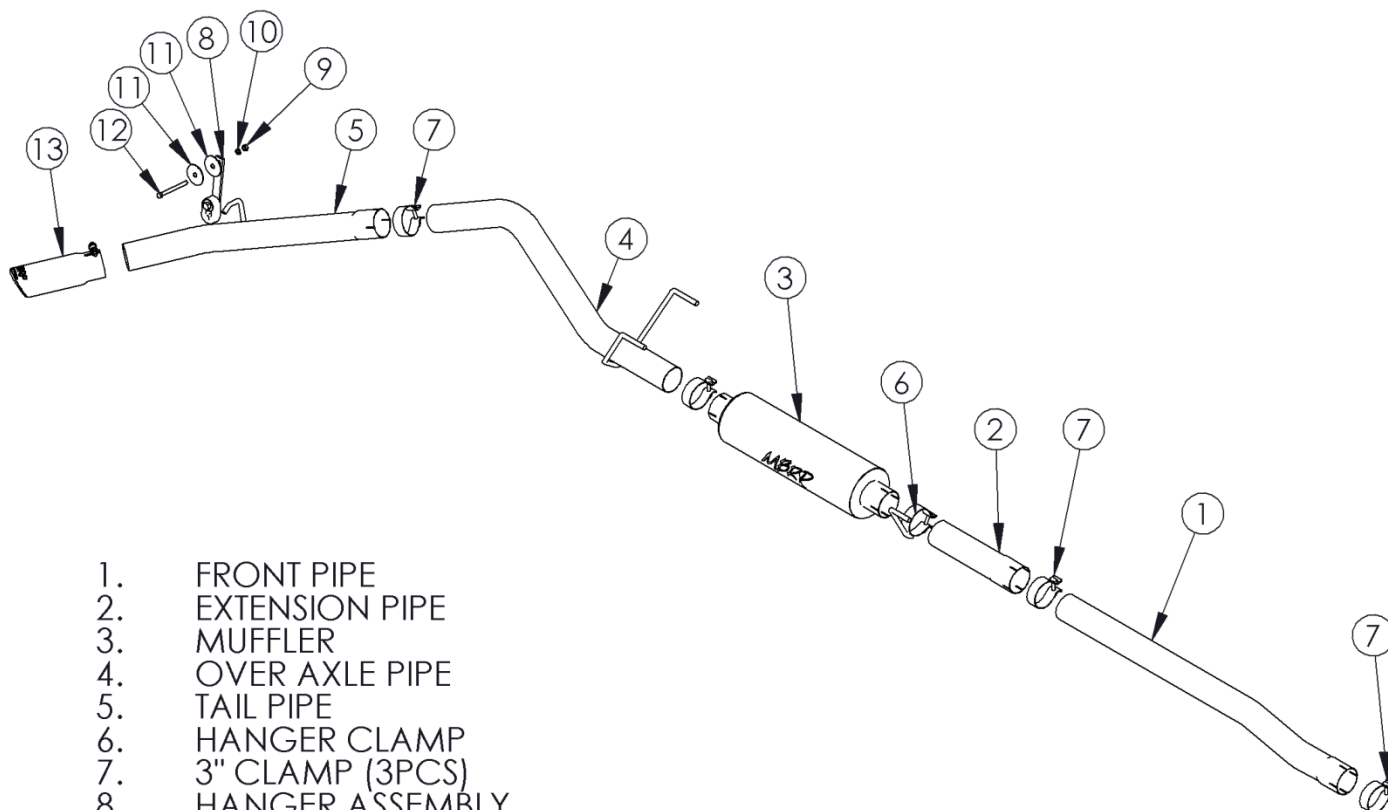

1. FRONT PIPE
2. EXTENSION PIPE
3. MUFFLER
4. OVER AXLE PIPE
5. TAIL PIPE
6. HANGER CLAMP
7. 3" CLAMP (3PCS)
8. HANGER ASSEMBLY
9. HEX NUT
10. LOCK WASHER
11. FENDER WASHER (2 PCS)
12. HEX BOLT
13. EXHAUST TIP

NOTE: SADDLE CLAMPS ARE USED IN ALUMINIZED SYSTEMS

PLEASE READ BEFORE STARTING INSTALLATION

While MBRP Inc. has made every effort to ensure that all components of this system are of superior quality and properly packaged, it is the installer's responsibility to ensure the following before removal of the factory exhaust:

- that ALL components shown above are present.
- that ALL mating components fit together.
- that there are no damaged components.
- that the system you have purchased is appropriate for your vehicle year, model and configuration.
- that the system will not interfere with any modifications previously installed or planned.
- that you have read and understand these instructions.

If you have any questions or are uncertain about any aspect of the installation of this system to your vehicle please contact your dealer before commencing installation.

Removal of Stock System

1. Apply a penetrating lubricant liberally to all exhaust fasteners, hangers and rubber insulators. **Refer to Figure 1 & 2.**
2. Remove the clamp just after the Y-pipe.
3. Remove the clamp from the rear of the muffler.
4. Remove the stock exhaust from the existing rubber isolators and remove the system from the vehicle.
5. Temporarily remove the spare tire and the heat shield around the spare tire. **Refer to Figure 2.**



Figure 1



Figure 2

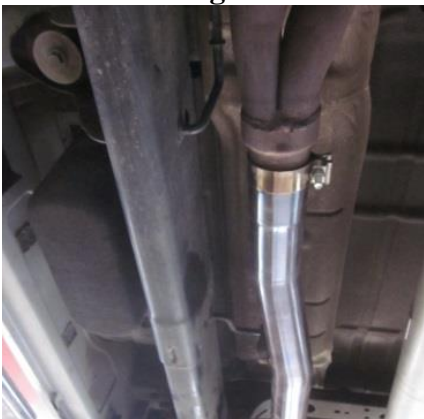

Figure 3



Figure 4

Installation of MBRP Inc. Performance Exhaust

1. Install the **Front Pipe** over the existing Y using the **3" Clamp**. Leave all clamps loose enough for adjustment. **Refer to Figure 3.**
2. Slide the **3" Hanger Clamp** over the **Extension Pipe** or **Front Pipe** and install the **Muffler** onto the **Extension Pipe** or **Front Pipe**. Insert the **3" Hanger Clamp** into the existing rubber insulator. **Refer to Figure 4.**
Note the extension Pipe is required on 2010 –Up Crew Cab 8' box only.

The front pipe will have to be trimmed for the:
2003-Up Regular Cab models (shortened by 20")
2003-2009 Quad Cab 6' 4" box (shortened by 20")
2010- Up Crew Cab 6' 4" box (shortened by 11")



Figure 5

3. Install the **Over Axle Pipe** into the **Muffler**. Install the **Over Axle Pipe** hangers into the existing rubber insulators. **Refer to Figure 5.**



Figure 6

4. Slide a **3" Clamp** onto the **Tail Pipe** and slide onto the **Over Axle Pipe**. Slide **Tail Pipe** hanger into the **Hanger Assembly** rubber insulator and attach to the frame using the fasteners provided. **Refer to Figure 6.**

5. Install and adjust the **Exhaust Tip** to suit. Reinstall the heat shield, a minor modification will be required. Trim Shield to fit with the **Hanger Assembly**. **Refer to Figures 7 & 8.**



Figure 7

6. Align the exhaust as required. Starting at the front of the exhaust, tighten all clamps and connections.

7. Check along the whole length of the exhaust system to ensure that there is adequate clearance around the spare tire, fuel and brake lines or any wiring. If any interference is detected relocate or adjust.



Figure 8

Congratulations! You are ready to begin experiencing the improved performance and driving pleasure of your MBRP Inc. performance exhaust system. We know *you will enjoy your purchase.*