

S5300

2005-2008 TOYOTA TACOMA
2.4L/4.0L EC/CC-SB

MBRP
INC.
PERFORMANCE EXHAUST

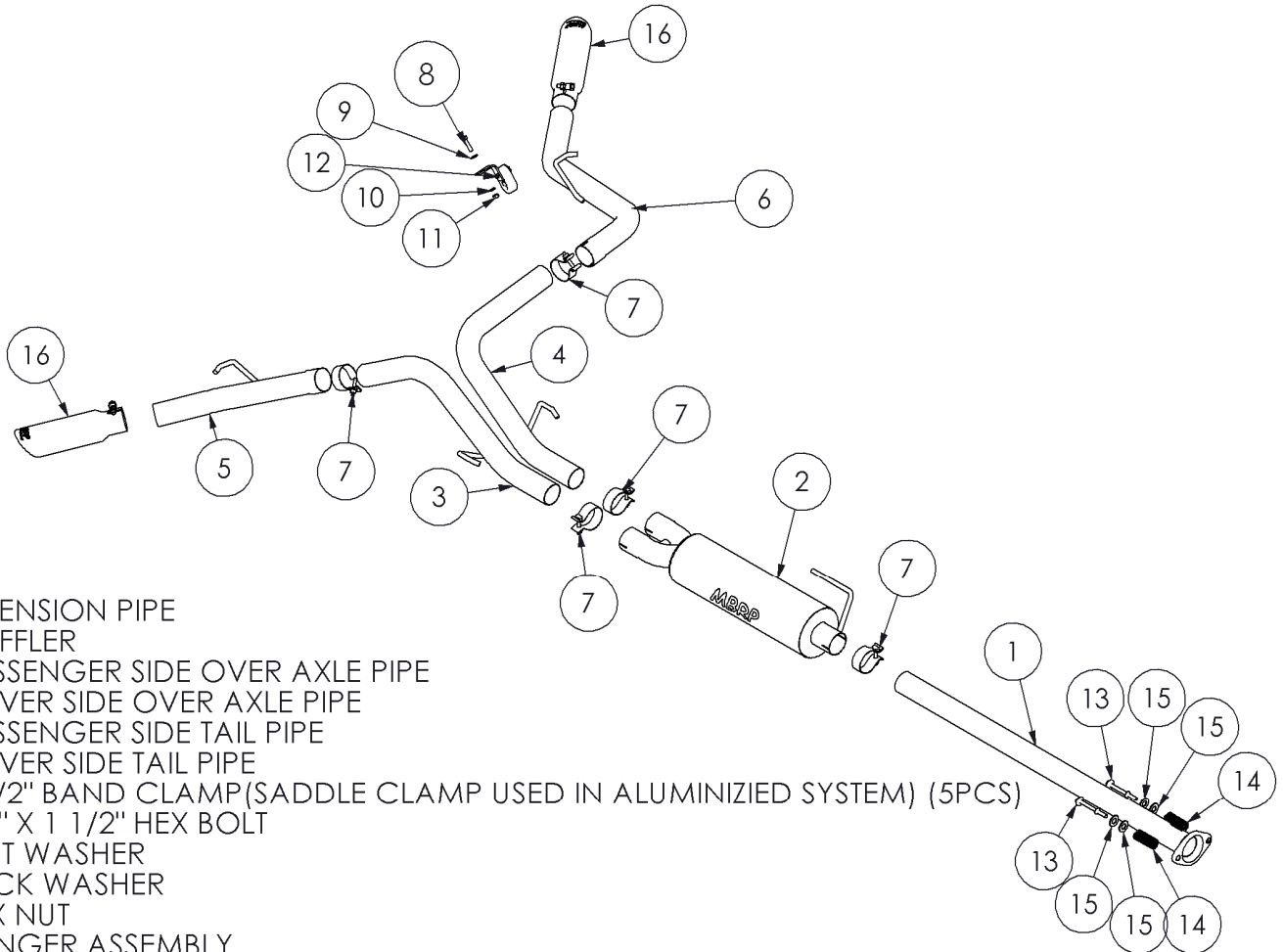

1. EXTENSION PIPE
2. MUFFLER
3. PASSENGER SIDE OVER AXLE PIPE
4. DRIVER SIDE OVER AXLE PIPE
5. PASSENGER SIDE TAIL PIPE
6. DRIVER SIDE TAIL PIPE
7. 2 1/2" BAND CLAMP(SADDLE CLAMP USED IN ALUMINIZED SYSTEM) (5PCS)
8. 3/8" X 1 1/2" HEX BOLT
9. FLAT WASHER
10. LOCK WASHER
11. HEX NUT
12. HANGER ASSEMBLY
13. EXISTING BOLT (2PCS)
14. EXISTING SPRING(2PCS)
15. 5/8" FLATWASHER (4PCS)
16. EXHAUST TIP (2PCS)

PLEASE READ BEFORE STARTING INSTALATION

While MBRP Inc. has made every effort to ensure that all components of this system are of superior quality and properly packaged, it is the installer's responsibility to ensure the following before removal of the factory exhaust:

- that ALL components shown above are present.
- that ALL mating components fit together.
- that there are no damaged components.
- that the system you have purchased is appropriate for your vehicle year, model and configuration.
- that the system will not interfere with any modifications previously installed or planned.
- that you have read and understand these instructions.

If you have any questions or are uncertain about any aspect of the installation of this system to your vehicle please contact your dealer before commencing installation.



2005 Toyota Tacoma DC-LB, 2.7L/4.0L

"COOL DUALS"™

Removal of stock system:

1. Apply a penetrating lubricant liberally to all exhaust fasteners, hangers and rubber insulators.
2. Remove the bolts and springs holding the front flange together and disconnect exhaust system. Do not discard this hardware as it is used for the installation
3. Remove the hangers from the rubber insulators and remove the exhaust from the vehicle. If a hoist or hydraulic lift is not being used the tail pipe may need to be cut to clear the rear axle.

Installation of MBRP Inc. Performance Exhaust:

1. Slide two of the 5/8" washers over the bolts previously removed at the flange and then slide the spring over the bolt. Now loosely attach the extension pipe at the flange.
2. Install the muffler onto extension pipe with the outlets horizontal and install the hanger into the factory rubber insulator.
3. Loosely install the driver side over axle pipe connecting it to the outlet closest to the drive shaft. Install the hanger into the rubber insulator located above the muffler outlets.
4. Feed the passenger side over axle pipe over the axle and install it loosely. Install the hanger into the rubber insulator located above the muffler outlets.
5. Connect the expanded end of the driver side tail pipe to the driver side over axle pipe.
6. Move the driver side tail pipe into approximate position. Using the factory hole provided in the frame located directly above the tail pipe hanger, attach the hanger provided using the supplied hardware.
7. Connect the expanded end of the passenger side tail pipe to the passenger side over axle pipe and install the hanger into the factory rubber insulator.
9. Install the mirror polished tips. It is recommended to install them at this point to assist with the final system alignment.
10. Install provided clamps to the pipe connections where required. Align the exhaust as required before tightening clamps.
11. Starting at the front of the exhaust tighten all clamps and connections.
12. Check along the whole length of the exhaust system to ensure that there is adequate clearance around the spare tire, fuel and brake lines or any wiring. If any interference is detected relocate or adjust.

Congratulations! You are ready to begin enjoying the improved performance and driving experience of your MBRP Inc. Cool Duals system. We hope you enjoy your purchase.