

S6027

2007-10 CHEV/GMC 2500/3500
DURAMAX LMM DPF BACK 4"
SINGLE SIDE DUAL OUTLET

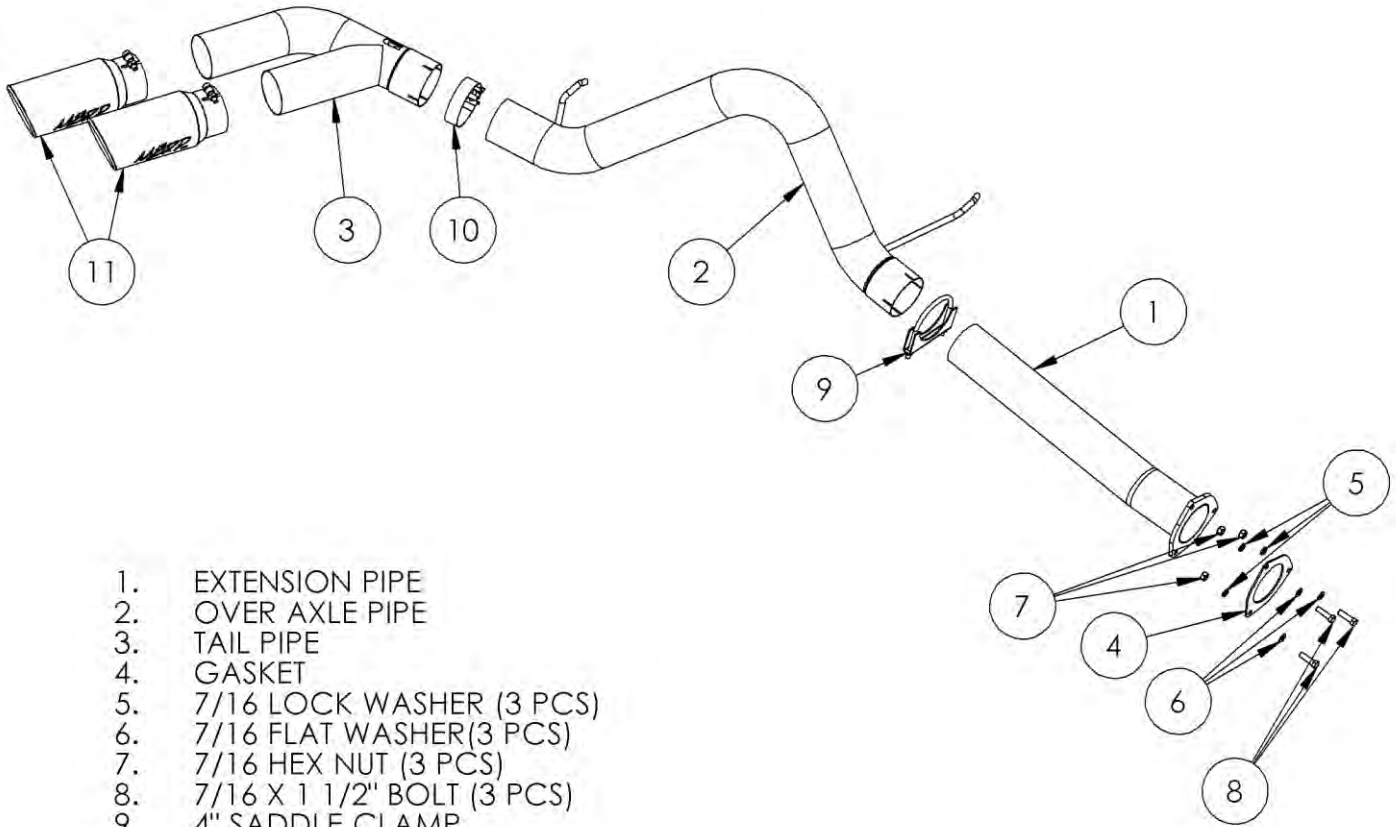

1. EXTENSION PIPE
2. OVER AXLE PIPE
3. TAIL PIPE
4. GASKET
5. 7/16 LOCK WASHER (3 PCS)
6. 7/16 FLAT WASHER (3 PCS)
7. 7/16 HEX NUT (3 PCS)
8. 7/16 X 1 1/2" BOLT (3 PCS)
9. 4" SADDLE CLAMP
10. 4" BAND CLAMP
11. EXHAUST TIP (2 PCS)

PLEASE READ BEFORE STARTING INSTALLATION

While MBRP Inc. has made every effort to ensure that all components of this system are of superior quality and properly packaged, it is the installer's responsibility to ensure the following before removal of the factory exhaust:

- that ALL components shown above are present.
- that ALL mating components fit together.
- that there are no damaged components.
- that the system you have purchased is appropriate for your vehicle year, model and configuration.
- that the system will not interfere with any modifications previously installed or planned.
- that you have read and understand these instructions.

If you have any questions or are uncertain about any aspect of the installation of this system to your vehicle please contact your dealer before commencing installation.

Removal of Stock System:



Figure 1



Figure 2



Figure 3



Figure 4



Figure 5

1. Apply a penetrating lubricant liberally to all hangers and rubber insulators.
2. Remove the factory tail pipe assembly from the factory rubber insulators.
Refer to Figures 1 and 2.

3. Cut the factory tail pipe as shown and remove the rear section.
Refer to Figure 3.

4. Remove the three nuts at the muffler inlet flange and remove the muffler.
Refer to Figure 4.

Installation of MBRP Inc. Performance Exhaust:

1. Install the three supplied 7/16" Bolts in the existing flange and place the supplied Gasket over the bolts.
Refer to Figure 5.



Figure 6

2. Install the **Extension Pipe** onto the flange. There is a slight bend in the **Extension Pipe**. The inside of this bend must face the driveshaft. If the outlet of the **Extension Pipe** angles slightly towards the driveshaft you have installed it correctly. Failure to install this pipe correctly will result in the **Over Axle Pipe** not fitting properly. Secure with the three supplied 7/16" **Flat Washers**, three 7/16" **Lock Washers** and three 7/16" **Nuts**. Refer to **Figure 6**.



Figure 7

3. Slide the 4" **Saddle Clamp** over the outlet of the **Extension Pipe**. Install the **Over Axle Pipe** from the rear of the truck over the axle and slide onto the **Extension Pipe**. Install the **Over Axle Pipe** hangers into the factory rubber isolators. Place the 4" **Band Clamp** over the **Over Axle Pipe**. Refer to **Figures 7 and 8**.



Figure 8

4. Install the **Tail Pipe** onto the **Over Axle Pipe**. Snug, but do not completely tighten the **Clamp**. Refer to **Figure 9**.



Figure 9

5. Install the **Exhaust Tips** and adjust to your liking. The **Exhaust Tips** can only be installed on the straight sections of the **Tail Pipe**. Attempting to force them back farther may not allow them to tighten and align properly. Refer to **Figure 10**.



Figure 10

6. Once everything is aligned, completely tighten all **Clamps**.

7. Check along the whole length of the exhaust system to ensure that there is adequate clearance around the spare tire, fuel and brake lines or any wiring. If any interference is detected relocate or adjust.

8. It is recommended to tack weld each joint, including the **Exhaust Tips** to ensure vibrations do not allow any pieces to become detached.



Congratulations! You are ready to begin experiencing the improved power, sound and driving experience of your **MBRP Inc.** performance exhaust system. We know you will enjoy your purchase.