

# S6158

2013 DODGE CUMMINS 6.7L, 4" DUAL  
DPF BACK - ALL EXCEPT CC/SB

**MBRP**  
INC.  
PERFORMANCE EXHAUST

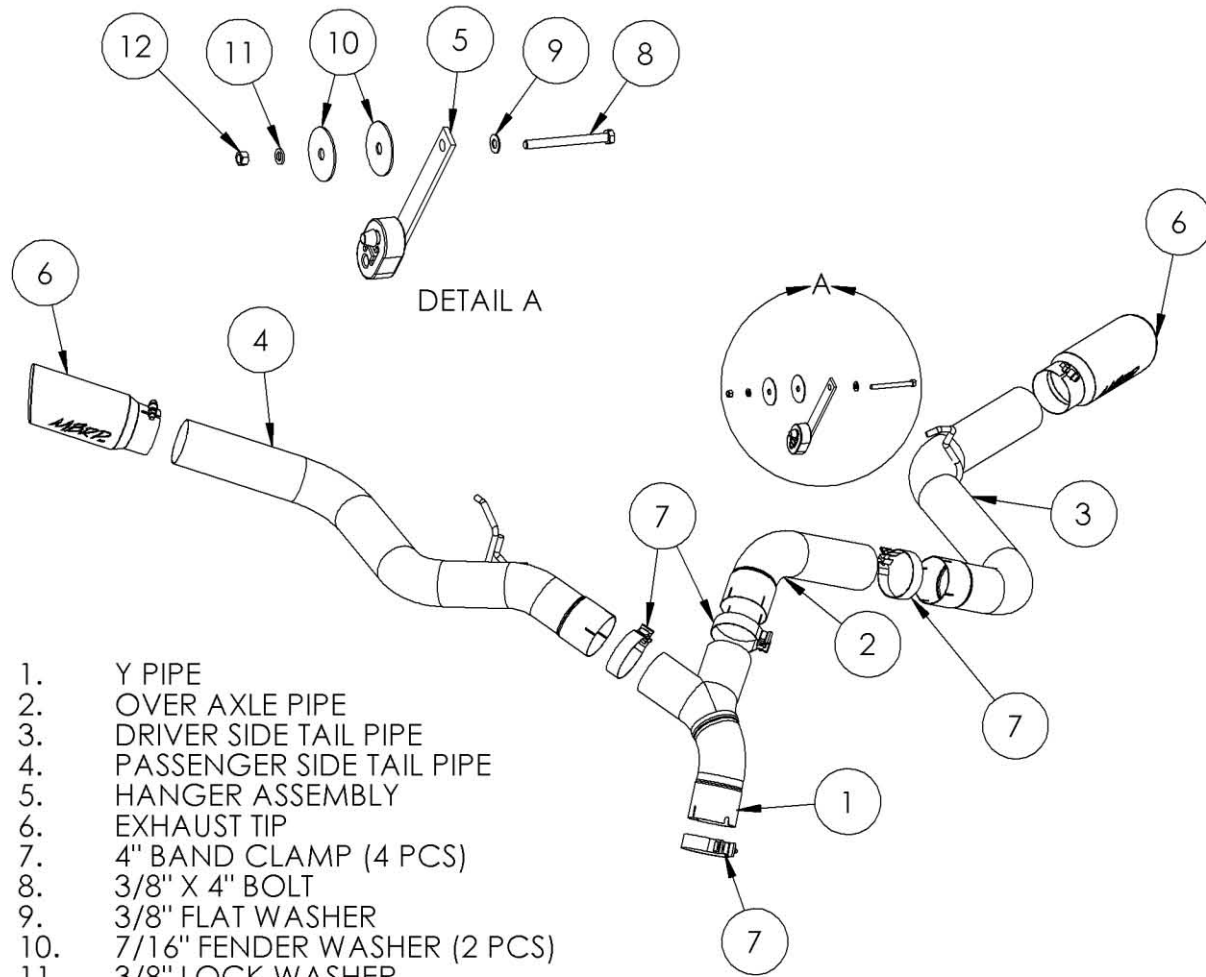

1. Y PIPE
2. OVER AXLE PIPE
3. DRIVER SIDE TAIL PIPE
4. PASSENGER SIDE TAIL PIPE
5. HANGER ASSEMBLY
6. EXHAUST TIP
7. 4" BAND CLAMP (4 PCS)
8. 3/8" X 4" BOLT
9. 3/8" FLAT WASHER
10. 7/16" FENDER WASHER (2 PCS)
11. 3/8" LOCK WASHER
12. 3/8" HEX NUT

**NOTE: ALUMINIZED SYSTEMS USE SADDLE CLAMPS**

## PLEASE READ BEFORE STARTING INSTALLATION

While MBRP Inc. has made every effort to ensure that all components of this system are of superior quality and properly packaged, it is the installer's responsibility to ensure the following before removal of the factory exhaust:

- that ALL components shown above are present.
- that ALL mating components fit together.
- that there are no damaged components.
- that the system you have purchased is appropriate for your vehicle year, model and configuration.
- that the system will not interfere with any modifications previously installed or planned.
- that you have read and understand these instructions.

If you have any questions or are uncertain about any aspect of the installation of this system to your vehicle please contact your dealer before commencing installation.

## 2013 DODGE 6.7L Cummins, 2500/3500

### Removal of Stock System:

1. Apply a penetrating lubricant liberally to all exhaust fasteners, hangers and rubber insulators.

2. Loosen the nut on the clamp on the factory tailpipe.

**Refer to Figure 1.**

3. Remove the tail pipe from the particulate filter (or extension pipe on crew cab long box and Mega Cab models) then from the OEM rubber hanger. Remove the stock exhaust from the vehicle. Completely remove the factory rubber tail pipe hanger but keep for the new system.

4. Temporarily lower the spare tire.

### Installation of MBRP Inc. Performance Exhaust:

1. Slide a 4" **Clamp** onto the outlet end of the particulate filter (or extension pipe on crew cab long box and Mega Cab models). Install the **Y Pipe** as shown, taking care to align the tab on the filter with the slot in the **Y Pipe**.

**Refer to Figure 2.**

2. Install the **Over Axle Pipe** onto the left hand outlet of the **Y Pipe**. Slide two 4" **Clamps** onto the outlet end of the **Over Axle Pipe**.

**Refer to Figure 3.**

3. Install the **Driver Side Tail Pipe** onto the **Over Axle Pipe**, keeping the brake flex hoses and ABS wiring in front of the pipe.

**Refer to Figure 4.**



**Figure 1**



**Figure 2**



**Figure 3**



**Figure 4**



**Figure 5**

4. Using the **Driver Side Tail Pipe** as a guide, locate the large hole in the frame just above the hanger location. Install the **Hanger Assembly**, centered in the hole, using the provided hardware, keeping the **7/16" Fender Washers** next to the frame. Do not completely tighten until all of the pipes are in place. **Refer to Figure 5.**



**Figure 6**

5. Install the **Driver Side Tail Pipe** hanger into the **Hanger Assembly**. **Refer to Figure 6.**



**Figure 7**

6. Install the **Passenger Side Tail Pipe** using a **4" Clamp** onto the **Y Pipe**. **Refer to Figure 7.**



**Figure 8**

7. Reinstall the factory rubber hanger onto the frame mounts and the **Passenger Side Tail Pipe** hanger. **Refer to Figure 8.**



**Figure 9**

8. Install the **Exhaust Tips**. Single rear wheel owners may wish to trim the length of the tail pipes to suit. The Tail Pipes are purposely left long for dual rear wheel applications.

**Refer to Figure 9.**

9. Align the exhaust as required. Starting at the front of the exhaust, tighten all clamps, hangers and connections. Raise the spare tire keeping it as far to the right rear of the vehicle as possible.

10. Check along the whole length of the exhaust system to ensure that there is adequate clearance around the spare tire, fuel and brake lines or any wiring. If any interference is detected relocate or adjust. Pay particular attention to the brake flex lines and ABS wiring on the driver's side. Most often these can be kept clear of the exhaust by loosely tying them back to the emergency brake cable. Different configurations may require different methods. It is the installer's responsibility to ensure there is enough clearance to prevent damage.



**Congratulations!** You are ready to begin experiencing the improved power, sound and driving experience of your **MBRP Inc.** performance exhaust system. We hope you enjoy your purchase.