

## A

1. Place plastic collar then brass fitting on the antenna cable. (Fig A)

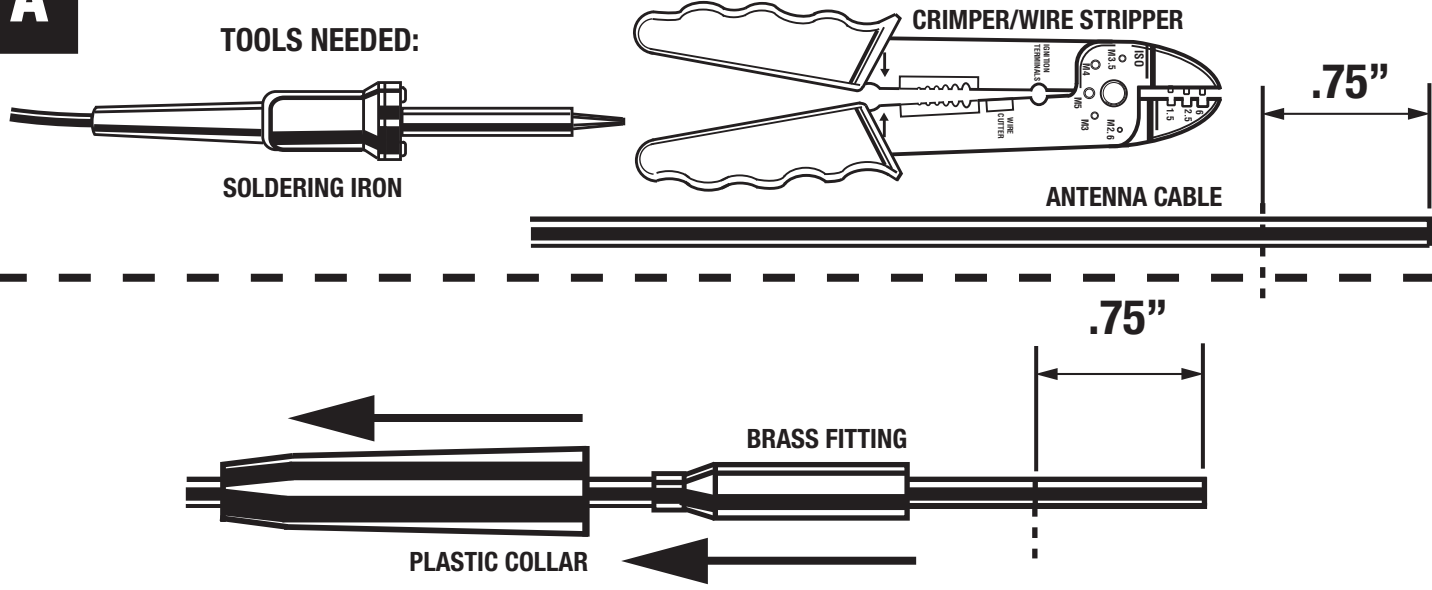

## B1

2a. Strip back outer insulation 3/4" and peel ground shield over outer insulation. (Fig B1)

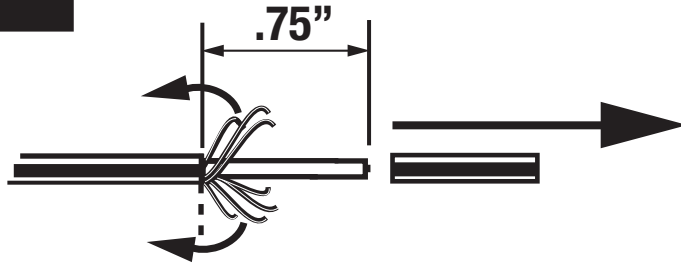

## B2

2b. Cut inner insulation exposing the center conductor. (Fig B2)

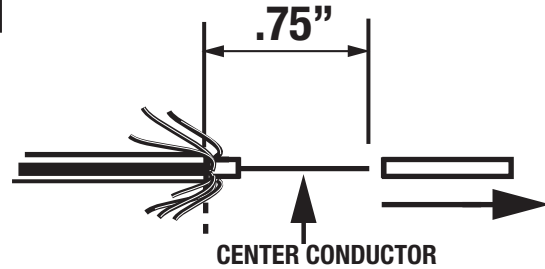

## C

3. Solder the center conductor to the brass connector. (Fig C)

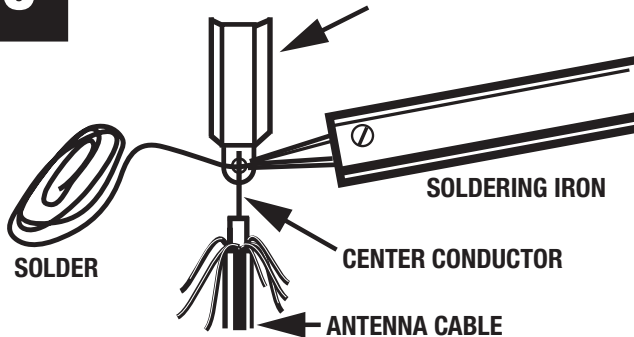

## D

4. Insert brass connector into the plastic housing and slide brass fitting over housing and outer ground shield. (Fig D)

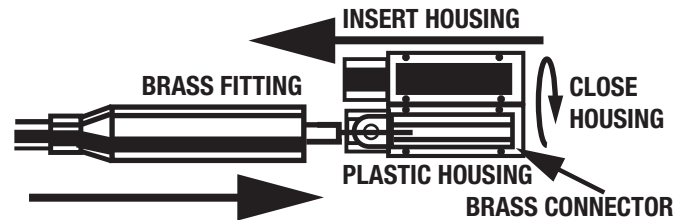

## E

5. Crimp brass housing at outer insulation securing it in place. (Fig E)

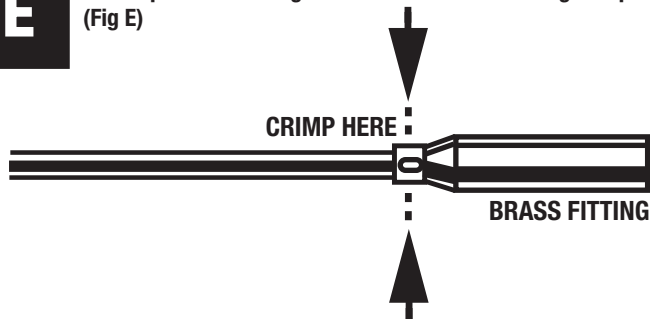

## F

6. Slide plastic collar over brass fitting. (Fig F)

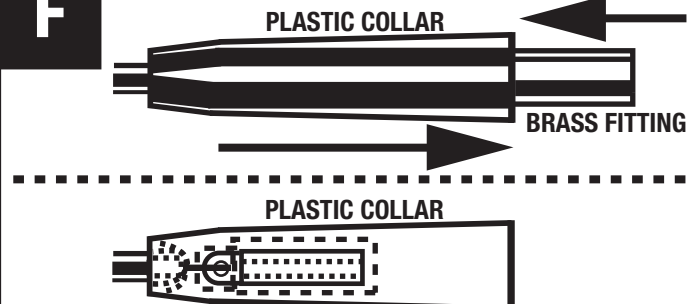

[www.metraonline.com](http://www.metraonline.com)

1-800-221-0932



### KNOWLEDGE IS POWER

Enhance your installation and fabrication skills by enrolling in the most recognized and respected mobile electronics school in our industry. Log onto [www.installerinstitute.com](http://www.installerinstitute.com) or call 800-354-6782 for more information and take steps toward a better tomorrow.