



## INSTALLATION INSTRUCTIONS FOR PART 95-7416G

### APPLICATIONS

# Nissan Maxima (w/ Bose and/or comfort and convenience packages) 2000-2003

# 95-7416G

#### KIT FEATURES

- DDIN Head Unit Provision
- Painted scratch resistant gray to match factory dash



#### KIT COMPONENTS

- A) Double DIN Trim Plate

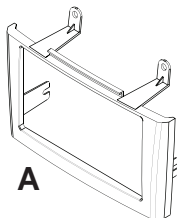

#### WIRING AND ANTENNA CONNECTIONS (Sold Separately) Harness:

- 70-7550 - Nissan harness 95-up
- 70-7551 - Nissan amp interface harness 95-up

#### Antenna Adapter:

- 40-NI10 - Nissan antenna adapter 1987-2008

#### TOOLS REQUIRED:

- Socket Wrench
- Panel Removal Tool
- Phillips Screwdriver



METRA. THE WORLD'S BEST KITS.™



1-800-221-0932



www.metraonline.com

© COPYRIGHT 2007-2009

METRA ELECTRONICS CORPORATION

**TABLE OF CONTENTS**

**Dash Disassembly**

**- Nissan Maxima 2000-2003.....1**

**Kit Assembly**

**- DDIN Head Unit Provision .....2**

**\*Note:**

**Refer also to the instructions included with the aftermarket radio.**



**KNOWLEDGE IS POWER**

Enhance your installation and fabrication skills by enrolling in the most recognized and respected mobile electronics school in our industry. Log onto [www.installerinstitute.com](http://www.installerinstitute.com) or call 800-354-6782 for more information and take steps toward a better tomorrow.



Metra recommends MECP certified technicians.

## NISSAN MAXIMA 2000-2003

- 1** Disconnect the negative battery terminal to prevent an accidental short circuit.
- 2** Unclip and remove the climate control vent panel. (Figure A)
- 3** Remove (2) Phillips screws expose behind a/c vents. (Figure A)
- 4** Remove the ashtray and (1) Phillips screw exposed in the ashtray cavity. (Figure B)
- 5** Unclip and remove the gear shift trim panel. (Figure B)
- 6** Remove (2) Phillips screws exposed behind gear shift trim panel. (Figure B)
- 7** Unclip and remove the radio/climate control bracket assembly.
- 8** Remove (8) Phillips screws securing the factory radio to the bracket assembly.

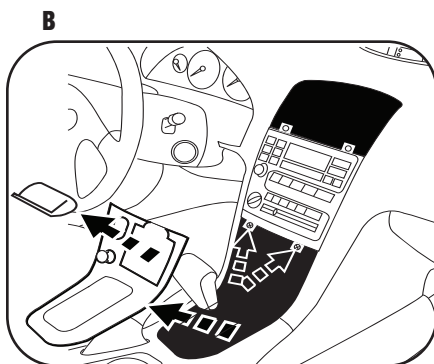
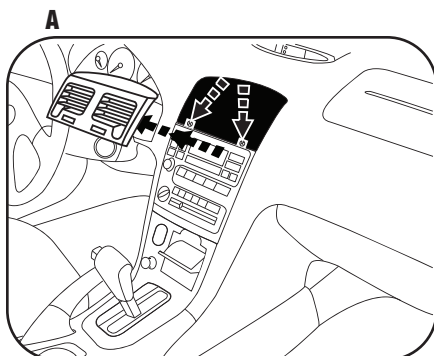

*Continue to kit assembly.*

**DOUBLE DIN HEAD UNIT PROVISION**

**\*Note: Refer also to the instructions included with the aftermarket radio.**

- 1** Locate the factory wiring harness in the dash. Metra recommends using the proper mating adapter from Metra or AXXESS. Re-connect the negative battery terminal and test the unit for proper operation.
- 2** Place the 7416 DDIN trim plate over the aftermarket radio and screw the factory climate/ bracket assembly together using the ISO screws supplied with the aftermarket radio. (Figure A)
- 3** Mount the radio/climate/ bracket assembly into the dash using the four factory screws removed in disassembly. (Figure B)
- 4** Reassemble dash in reverse order of disassembly.

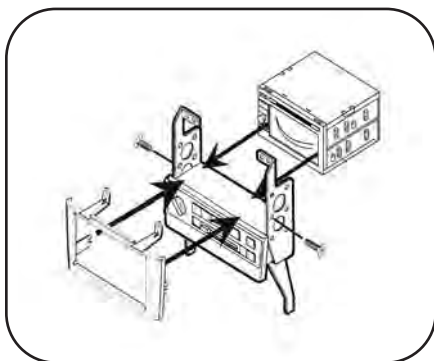
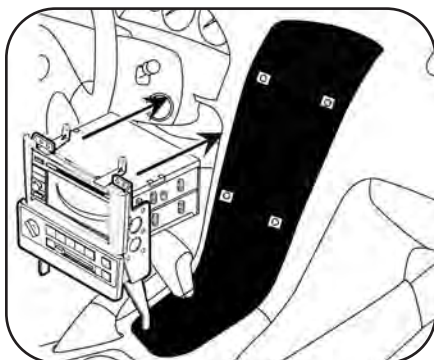
**A****B**







# 95-7416G INSTRUCTIONS

METRA. THE WORLD'S BEST KITS.™



1-800-221-0932



[www.metraonline.com](http://www.metraonline.com)

REV. 12/07/09 © COPYRIGHT 2003-2009 METRA ELECTRONICS CORPORATION INST95-7416G