



INSTALLATION INSTRUCTIONS FOR PART 95-8204

APPLICATIONS

Toyota Corolla 2003-2008

95-8204

KIT FEATURES

- Double DIN Radio Provision
- Stacked ISO Units Provision



KIT COMPONENTS

A) Double DIN Trim Plate B) Double DIN Brackets

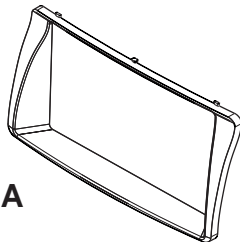

A

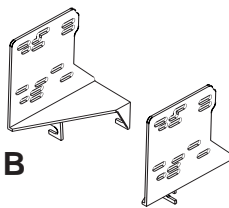

B

TOOLS REQUIRED:

- Small Flat Blade Screwdriver
- Panel Removal Tool
- Phillips Screwdriver
- Socket Set



1-800-221-0932



www.metraonline.com

© COPYRIGHT 2004-2007 METRA ELECTRONICS CORPORATION

TABLE OF CONTENTS

Dash Disassembly

- Totota Corolla 2003-2008 1

Kit Assembly

- Double DIN Radio Provision 2

- Stacked ISO Units Provision..... 3

Final Assembly 4

***Note:**

Refer also to the instructions included with the aftermarket radio.

TOYOTA COROLLA 2003-2008

- 1** Disconnect the negative battery terminal to prevent an accidental short circuit.
- 2** Unclip and remove the gear shifter trim panel. (Figure A)
- 3** Remove the center a/c knob and (1) Phillips screw exposed behind it. (Figure B)
- 4** Unclip and remove the a/c-pocket assembly. (Figure C)
- 5** Remove (4) 10 MM bolts from the bottom of the radio then unclip and remove the factory radio and trim panel together. Unplug radio from factory harness. (Figure D)
- 6** Unclip and remove the radio trim panel including the a/c vents from the factory radio.

Continue to kit assembly.

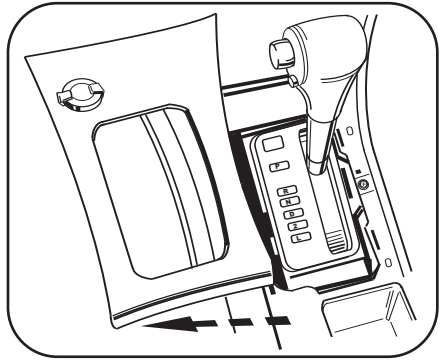
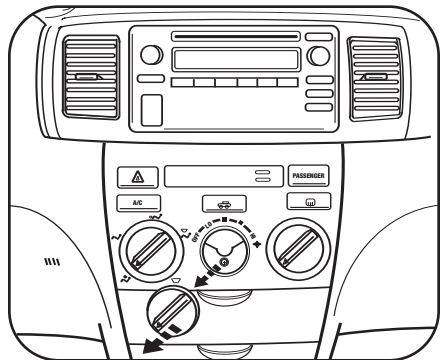
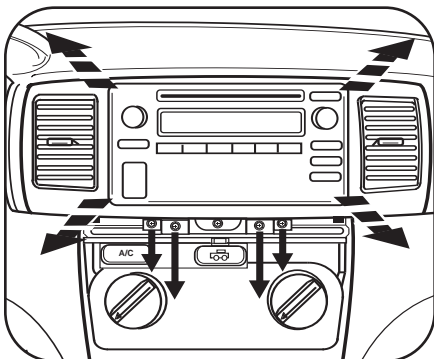
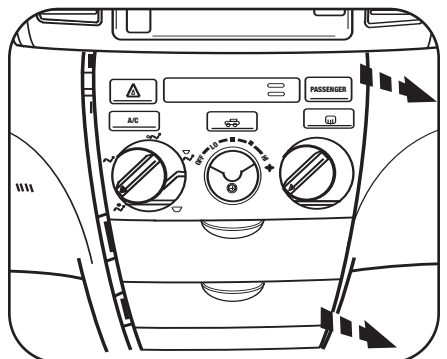
A

B

D

C

DOUBLE DIN RADIO PROVISION

**Note: Refer also to the instructions included with the aftermarket radio.*

- 1 Snap the Double DIN trim plate into the factory trim panel. (Figure A)
- 2 Slide the Double DIN radio into the Double DIN brackets and secure the radio to the brackets using the screws supplied with the radio. (Figure B)

Continue to final assembly.

A

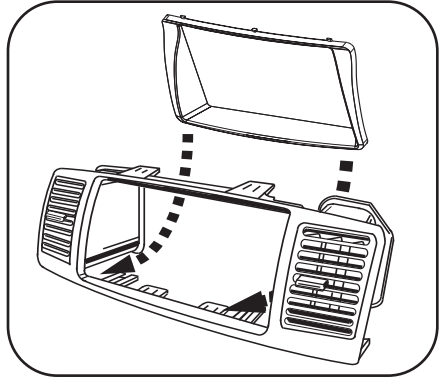

B

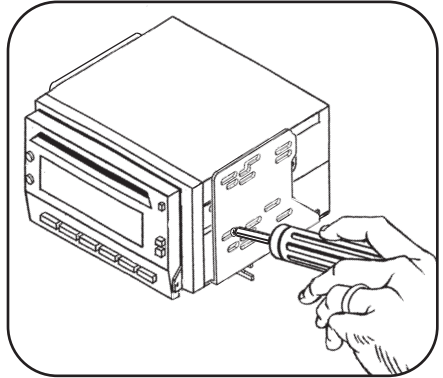

STACKED ISO UNITS PROVISION

**Note: Refer also to the instructions included with the aftermarket radio.*

- 1 Snap the Double DIN trim plate into the factory trim panel. (Figure A)
- 2 Slide the stacked ISO units into the Double DIN brackets and secure the units to the brackets using the screws supplied with the units. (Figure B)

Continue to final assembly.

A

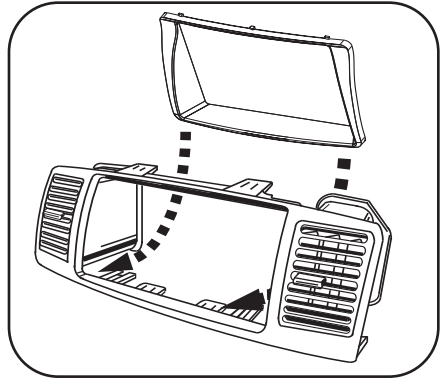

B

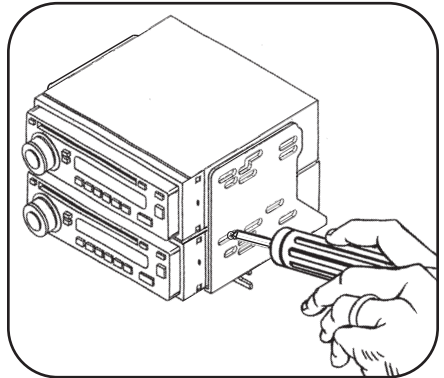

FINAL ASSEMBLY

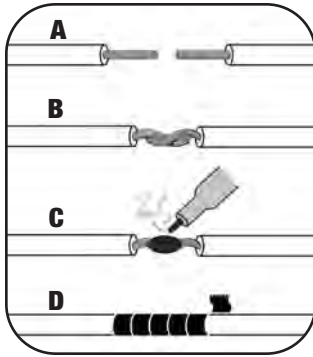

(A) Strip wire ends back 1/2"

B) Twist ends together

C) Solder

D) Tape

- 1 Locate the factory wiring harness in the dash. Metra recommends using the proper mating adapter and making connections as shown. (Isolate and individually tape off the ends of any unused wires to prevent electrical short circuit.)
- 2 Re-connect the negative battery terminal and test the unit for proper operation.
- 3 Reassemble radio and dash assemblies in reverse order of disassembly.

FINAL WIRING CONNECTIONS

Make wiring connections using the EIA color code chart shown below and the instructions included with the head unit. Metra recommends making connections as shown below; Strip, Splice, Solder, Tape. Isolate and individually tape off ends of any unused wires to prevent electrical short circuit.

METRA / EIA WIRING CODE

12V Ignition / Acc. Red	Right Front (+) Gray
12V Batt / Memory Yellow	Right Front (-) Gray / Black
Ground Black*	Left Front (+) White
Power Antenna Blue	Left Front (-) White / Black
Amp Turn-On Blue / White	Right Rear (+) Violet
Amp Ground Black / White	Right Rear (-) Violet / Black
Illumination Orange	Left Rear (+) Green
Dimmer Orange / White	Left Rear (-) Green / Black

***NOTE:** When a Black wire is not present, ground radio to vehicle chassis.
All colors may not be present on all leads due to manufacturer's specifications.

95-8204 INSTRUCTIONS



1-800-221-0932



www.metraonline.com

REV. 10/02/07 © COPYRIGHT 2004 METRA ELECTRONICS CORPORATION

INST95-8204