



INSTALLATION INSTRUCTIONS FOR PART 95-8225G

APPLICATIONS

Toyota Venza 2009

95-8225G

KIT FEATURES

- Double DIN Head Unit Provision
- Stacked ISO DIN Head Unit Provision
- *Painted to match factory dash - G=Gray*

KIT COMPONENTS

- A) DDIN Trim Plate

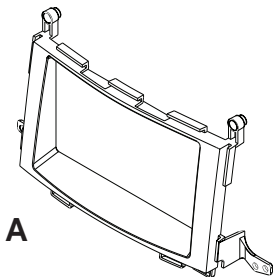

WIRING AND ANTENNA CONNECTIONS (Sold Separately)

- 70-1761 - 1987-up Toyota harness
- TYTO-01 - 2003-up Toyota JBL amp interface

TOOLS REQUIRED:

- Small Flat Blade Screwdriver/ Panel Removal Tool
- Phillips Screwdriver • Socket Set
- Magnetized Universal Swivel Head Socket Adapter

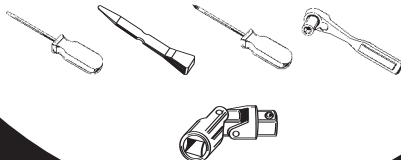

1-800-221-0932



www.metraonline.com

© COPYRIGHT 2009 METRA ELECTRONICS CORPORATION

TABLE OF CONTENTS

Dash Disassembly

- **Toyota Venza 2009** 1

Kit Assembly

- **Double DIN Head Unit/Stacked ISO Din Head Unit Provision** 2

**Note:*

Refer also to the instructions included with the aftermarket radio.



KNOWLEDGE IS POWER

Enhance your installation and fabrication skills by enrolling in the most recognized and respected mobile electronics school in our industry. Log onto www.installerinstitute.com or call 800-354-6782 for more information and take steps toward a better tomorrow.

Toyota Venza 2009

- 1 Disconnect the negative battery terminal to prevent an accidental short circuit.
- 2 Unclip and remove the trim panel to the right of the shifter. (Figure A)
- 3 Remove (1) Phillips screw from the bottom of the climate control then unclip and remove the climate control. (Figure B)
- 4 Remove (4) 10 MM bolts securing the radio. **Note: You will need a universal swivel head socket adapter to get to the bottom left bolt.** (Figure C)
- 5 Remove (4) Phillips screws securing the factory radio to the a/c vent panel. (Figure D)

Continue to kit assembly.

A

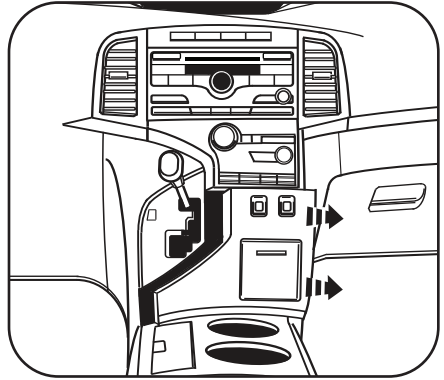

B

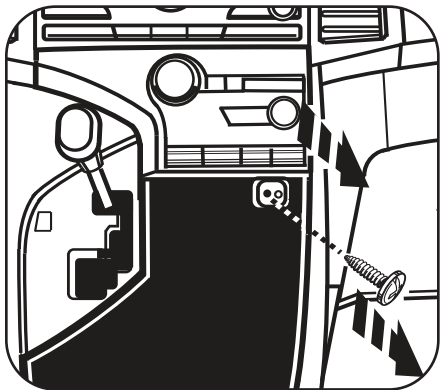

C

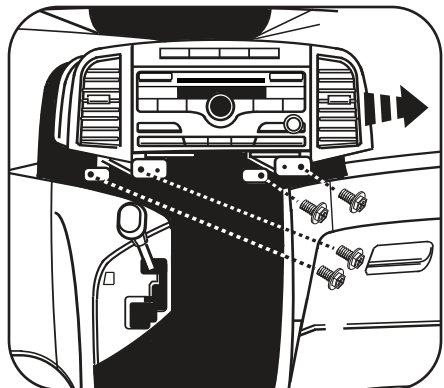

D

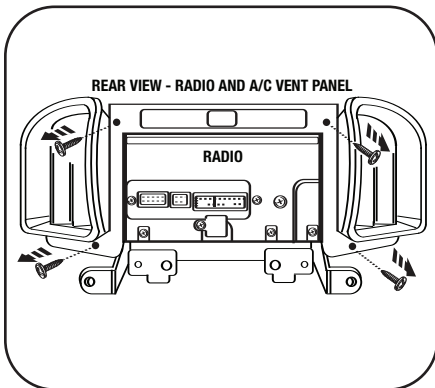

DOUBLE DIN HEAD UNIT PROVISION/ STACKED ISO DIN HEAD UNIT PROVISION

**Note: Refer also to the instructions included with the aftermarket radio.*

- 1** Secure the DDIN Trim plate into the factory a/c vent panel using the factory hardware. (Figure A)
- 2** Attach the factory radio brackets to the DDIN head unit or the stacked ISO DIN head units with the screws supplied with the unit. (Figure B)
- 3** Locate the factory wiring harness in the dash. Metra recommends using the proper mating adapter from Metra or AXCESS. Re-connect the negative battery terminal and test the unit for proper operation.
- 4** Secure the aftermarket radio into the dash using (4)10 MM bolts. (Figure C)
- 5** Snap the factory vent panel/DDIN trim plate over radio. (Figure D)
- 6** Reassemble the remaining radio and dash assemblies in reverse order of disassembly.

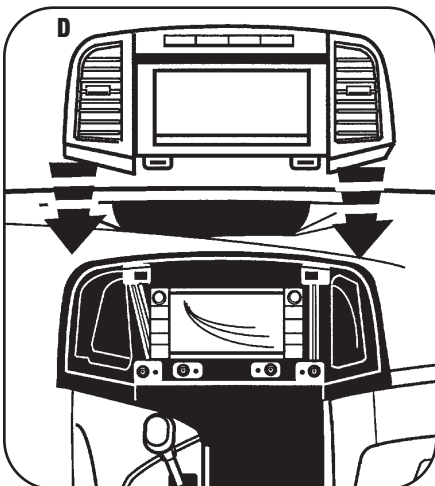
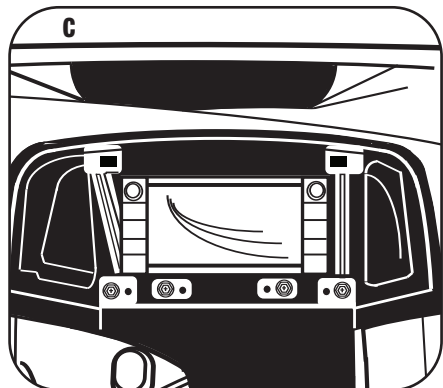
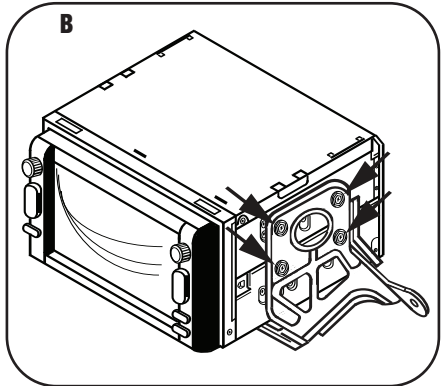
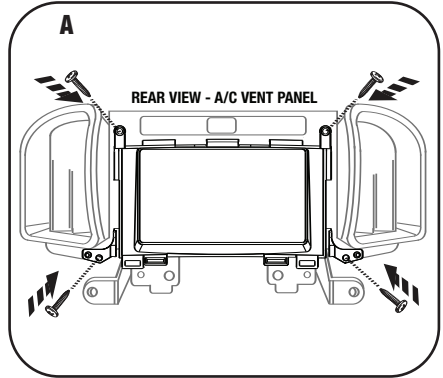

2



1-800-221-0932



www.metraonline.com