



INSTALLATION INSTRUCTIONS FOR PART 95-9012

APPLICATIONS

- **GOLF 1999-2006**
- **GTI 1999-2005**
- **JETTA 1999-2005**
(Excluding NEW JETTA 2005)
- **PASSAT 2000-2005**

95-9012

KIT FEATURES

- Double DIN Head Unit Provision
- Stacked ISO DIN Head Unit Provision

KIT COMPONENTS

A) Radio Housing • B) (8) Phillips screws

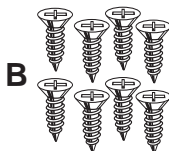
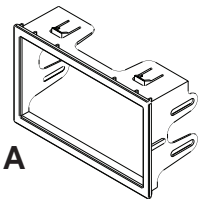

WIRING AND ANTENNA CONNECTIONS (Sold Separately)

- 70-1784 VW harness 1998-2001
- XSVI-9003-NAV VW Interface 2003-up

Antenna adapter:

- 40-EU55-adapter for amplified antenna 2002-up
- 40-VW53 adapter for amplified antenna 1998-01

TOOLS REQUIRED:

- Small Flat Blade Screwdriver • Panel Removal Tool
- 86-9001 Radio Removal Tools (2 sets)

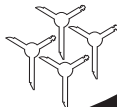
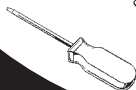

1-800-221-0932



www.metraonline.com

© COPYRIGHT 2009 METRA ELECTRONICS CORPORATION

TABLE OF CONTENTS

Dash Disassembly

- Golf 1999-2006	1
- GTI 1999-2005	1
- JETTA 1999-2005 (Excluding NEW JETTA 2005)	1
- PASSAT 2000-2005	1

Kit Assembly

- Double DIN Head Unit Provision	2
- ISO Stacked Head Unit Provision	2

<u>Final Assembly</u>	2
------------------------------------	---

***Note:**

Refer also to the instructions included with the aftermarket radio.



KNOWLEDGE IS POWER

Enhance your installation and fabrication skills by enrolling in the most recognized and respected mobile electronics school in our industry. Log onto www.installerinstitute.com or call 800-354-6782 for more information and take steps toward a better tomorrow.

Note: This installation kit is an extremely tight fit and requires force to be “snapped” into the dash opening. Removal of aftermarket radio is even more difficult than installation, so please be sure to fully test the aftermarket radio prior to completing the kit’s installation.

•GOLF 1999-2006 •GTI 1999-2005
•JETTA 1999-2005
(Excluding NEW JETTA 2005)
•PASSAT 2000-2005

- 1 Disconnect the negative battery terminal to prevent an accidental short circuit.
- 2 Insert the long ends of the 86-9001 into the slots on the factory radio and pull out to remove. **Note: Flat edge of key should point outward.** (Figure A)
- 3 For single DIN radios with the pocket, remove the radio and pocket, then pull out on the plastic tray separating the dash cavity. (Figure B)

A

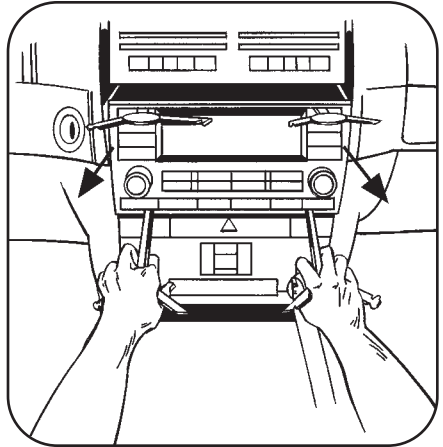

B

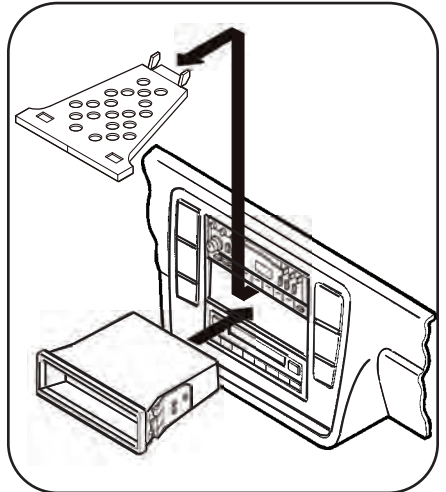

Note: This installation kit is an extremely tight fit and requires force to be "snapped" into the dash opening. Removal of aftermarket radio is even more difficult than installation, so please be sure to fully test the aftermarket radio prior to completing the kit's installation.

**DOUBLE DIN HEAD UNIT PROVISION/
ISO STACKED HEAD UNIT PROVISION**

- 1 Slide the DDIN radio unit into the DDIN bracket/radio housing assembly and secure the unit to the kit using the (8) Phillips screws supplied with the kit. (Figure A)
- 2 Locate the factory wiring harness in the dash. Metra recommends using the proper mating adapter from Metra or AXCESS. Re-connect the negative battery terminal and test the unit for proper operation.
- 3 Snap kit/ radio assembly into the dash opening.

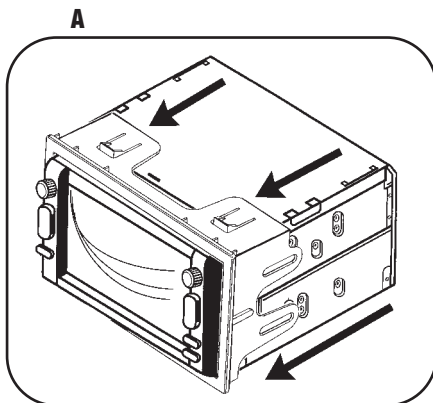

Note: This installation kit is an extremely tight fit and requires force to be “snapped” into the dash opening. Removal of aftermarket radio is even more difficult than installation, so please be sure to fully test the aftermarket radio prior to completing the kit’s installation.



1-800-221-0932

www.metraonline.com