

## KIT FEATURES

- ▶ Shaft and DIN unit provisions
- ▶ Equalizer provisions



# 99-3103 INSTALLATION INSTRUCTIONS

## KIT COMPONENTS

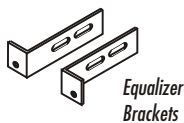
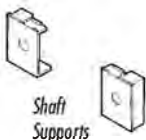

## APPLICATIONS

<u>CAR</u>	<u>PAGE</u>
SATURN (All models) 1995-99.....	1-2



## TOOLS REQUIRED



Phillips screwdriver



Cutting tool



File

## ALL VEHICLES

1

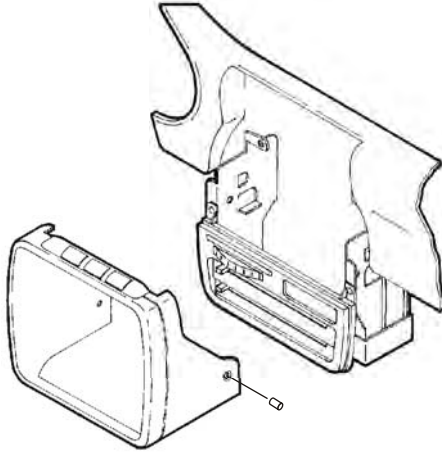

Disconnect the negative battery terminal to prevent an accidental short circuit. Remove (2) pop-clips from the sides of the radio trim bezel. Unclip the radio trim bezel, disconnect the switch wiring and remove the bezel. Remove (2) 7mm hex-head screws securing the top of the factory head unit and disconnect the wiring.

2

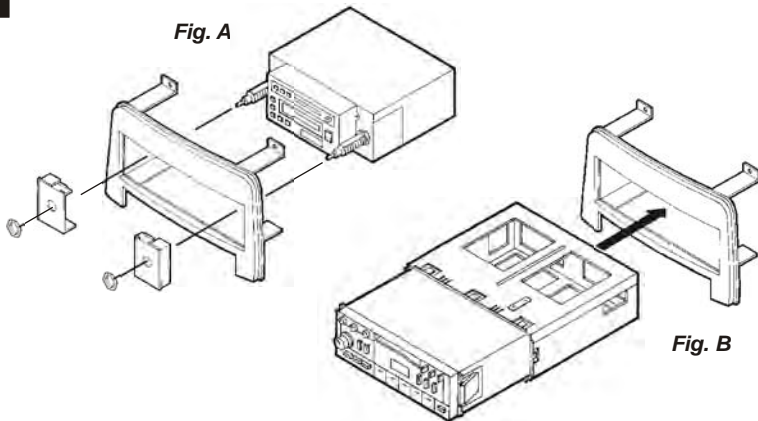

**2-SHAFT HEAD UNITS:** Snap the **Shaft Supports** into the **Radio Housing**. Slide the aftermarket head unit into the kit and secure with shaft nuts. (see Fig. A)

**DIN HEAD UNITS:** Slide the DIN cage into the kit and secure by bending the metal locking tabs down. Slide the aftermarket head unit into the cage until secure. (see Fig. B)

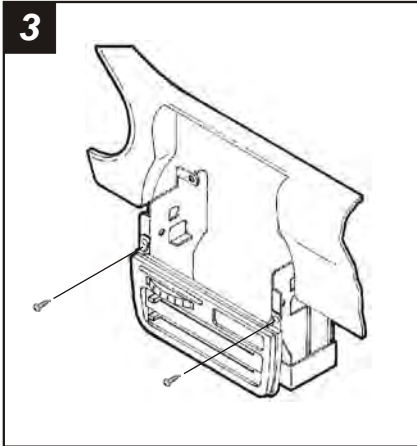

Remove (2) Phillips screws securing the climate control panel to the sub-dash and remove the panel.

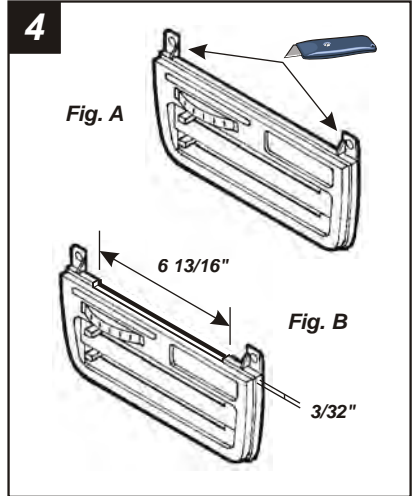

Using a small blade or saw, cut away the protruding tabs located between the screw holes and locating pins on the back of the panel. These tabs are brittle plastic and should NOT be cut with snips. (see Fig. A). Measuring in  $9/16$ " from each side of the climate control panel lip, file away a  $6\ 13/16$ " long by  $3/32$ " deep portion of the panel lip. (see Fig. B)

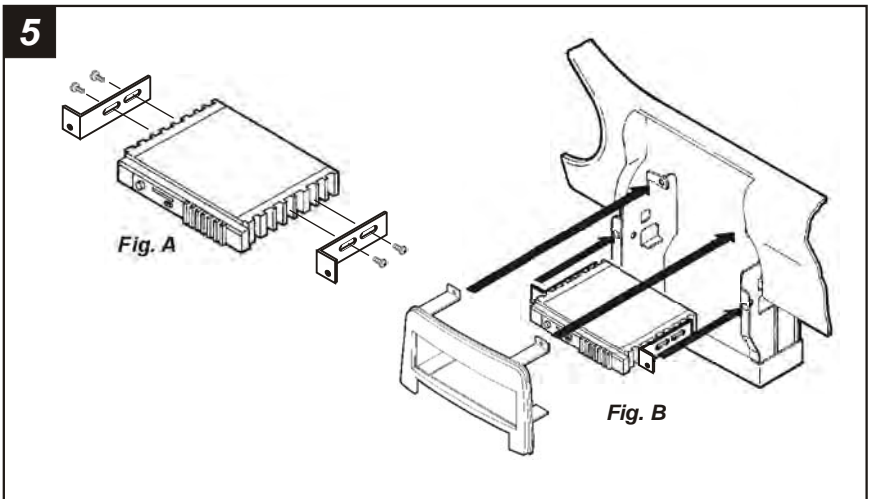

Loosely mount the **Equalizer Brackets** to the sides of the equalizer. (see Fig. A). Using the **Radio Housing** as a gauge, slide the equalizer and Housing into the sub-dash, adjust the Equalizer Brackets to locate the proper installation depth and tighten the screws. (see Fig. B)

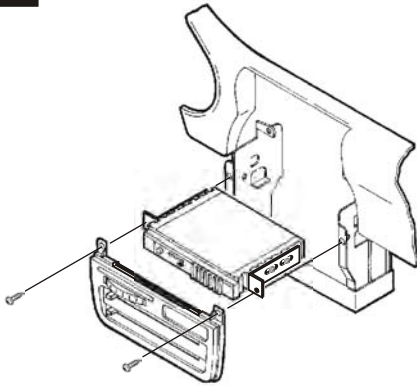
**6**

Mount the climate control panel and equalizer to the sub-dash with (2) screws previously removed in step #3.

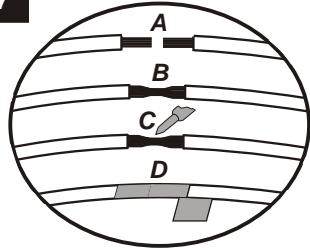
**7**

- A) Strip wire ends back 1/2"**
- B) Twist ends together**
- C) Solder**
- D) Tape**

Locate the factory wiring harness in the dash. Metra recommends using the proper mating adaptor and making connections as shown. (Isolate and individually tape off the ends of any unused wires to prevent electrical short circuit).

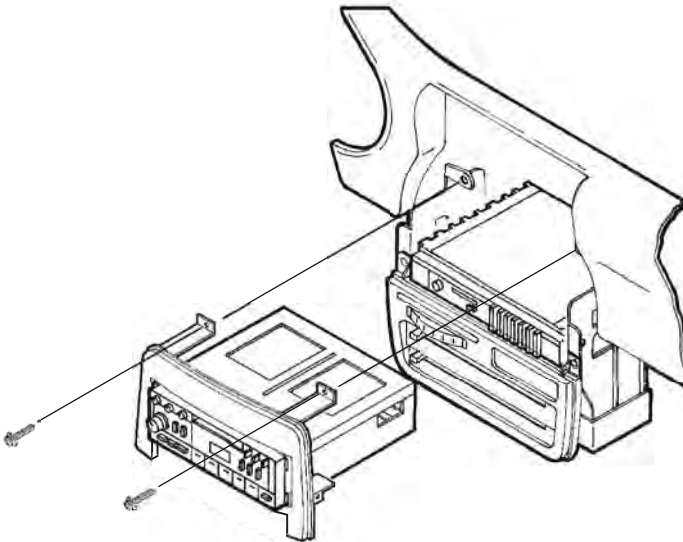
**8**

Re-connect the battery terminal and test the unit for proper operation. Mount the head unit/kit assembly to the sub-dash with (2) 7mm hex-head screws previously removed in step #1.