

KIT FEATURES

- ▶ Shaft and DIN unit provisions



99-3900

INSTALLATION INSTRUCTIONS

KIT COMPONENTS

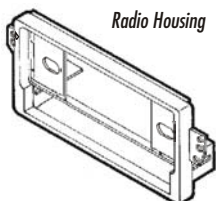

APPLICATIONS

CAR

PAGE

CHEVROLET

Blazer 1998-02.....	1
Camaro 1997-02.....	1
Caprice 1994-96.....	1
Cavalier 1995-99.....	1
Corvette 1997-02.....	2
Impala SS 1994-96.....	1
Lumina 1995-01.....	2
Malibu 1997-00.....	2
Monte Carlo 1995-99.....	2
S-10 Pickup 1998-02.....	1
Venture 1997-99.....	2

GMC

Jimmy 1998-02.....	1
Sonoma Pickup 1998-02.....	1

OLDSMOBILE

Silhouette 1997-00.....	2
-------------------------	---

PONTIAC

Montana 1999.....	2
TransSport 1997-99.....	2

TOOLS REQUIRED



Phillips screwdriver



Cutting tool



Socket wrench

☎ 1-800-221-0932 💻 www.metraonline.com

© COPYRIGHT 2001 METRA ELECTRONICS CORPORATION

rev. 261202

CHEVROLET Blazer/S-10 Pickup • GMC Jimmy/Sonoma 1998-02

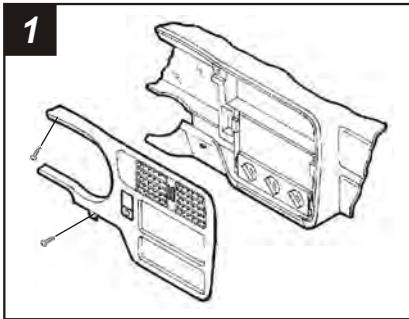

Disconnect the negative battery terminal to prevent an accidental short circuit. Remove (2) 9/32" hex-head screws from the knee bolster. Pull down on the bolster and remove 9/32" screws exposed on the base of the dash trim bezel. Remove (1) Phillips screw above the instrument cluster. Unclip the dash trim bezel and remove. Remove (2) 9/32" hex-head screws securing the factory head unit and disconnect the wiring.

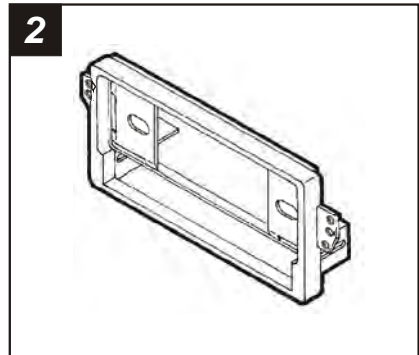

Locate the **Radio Housing**. Skip to the *Installation Instructions for ALL VEHICLES* on Page #5.

CHEVROLET Caprice 1994-96 Impala SS 1994-96

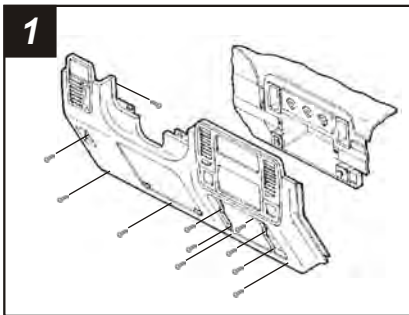

Disconnect the negative battery terminal to prevent an accidental short circuit. Remove (5) hex-head screws from the ashtray cavity. Remove (4) hex-head screws from the base of the dash trim bezel. Unsnap the fuse box cover and remove (1) hex-head screw exposed. Remove (2) hex-head screws above the instrument cluster. Place the gear selector in "D1". Pull out on the cluster trim and remove. Remove (1) hex-head screw exposed on the left edge of the dash trim bezel. Unclip the dash trim bezel (including the radio trim bezel) and remove.

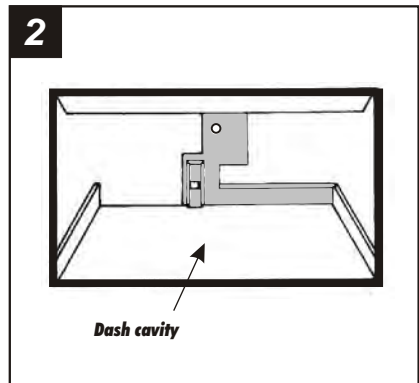

Locate the rear support system in the dash cavity. Cut and remove the shaded portion of the dash cavity plastic. Skip to the *Installation Instructions for ALL VEHICLES* on Page #5.

CHEVROLET Camaro 1997-02

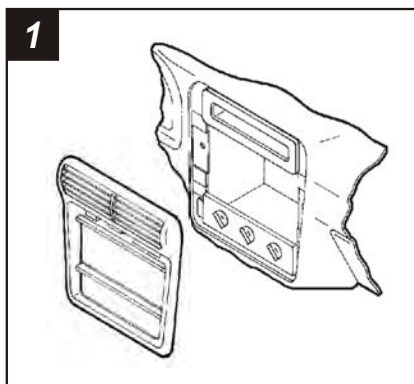

Disconnect the negative battery terminal to prevent an accidental short circuit. Unclip the radio trim bezel and remove. Remove (2) 7mm hex-head screws securing the factory head unit and disconnect the wiring.

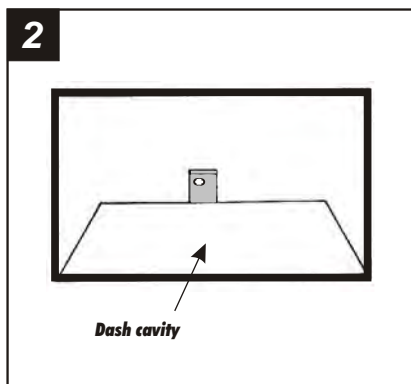

Locate the rear support system in the dash cavity. Cut and remove the shaded portion of the dash cavity plastic. *Skip to the Installation Instructions for ALL VEHICLES on Page #5.*

CHEVROLET Cavalier 1995-99

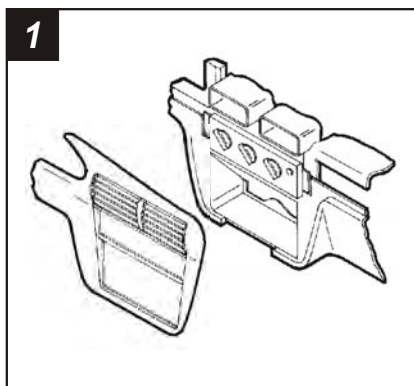

Disconnect the negative battery terminal to prevent an accidental short circuit. Remove (3) 7mm hex-head screws from the top of the glove box liner. Remove (2) 7mm hex-head screws from the top-left corner of the glove box cavity. Remove (1) Phillips screw from the defroster duct. Remove the duct work and (1) Phillips screw exposed. Unclip the dash trim piece and remove (2) Phillips screws exposed. Remove the dash pad and (3) Phillips screws exposed at the top of the radio trim bezel.

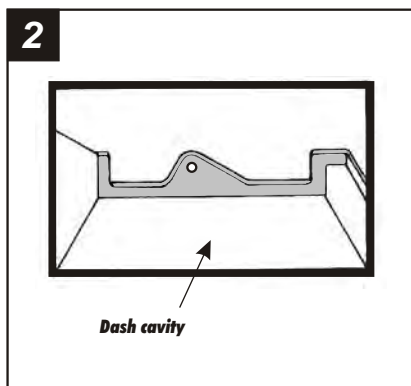

Locate the rear support system in the dash cavity. Cut and remove the shaded portion of the dash cavity plastic. (After removing the plastic, it will be necessary to modify the HVAC vent with a heat gun to provide additional depth). *Skip to the Installation Instructions for ALL VEHICLES on Page #5.*

CHEVROLET Corvette 1997-02

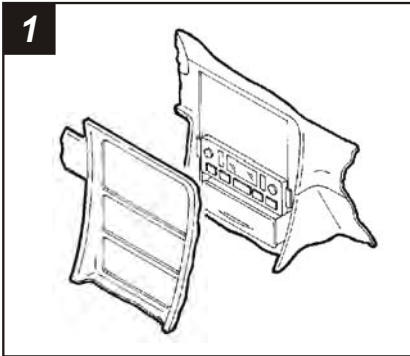

Disconnect the negative battery terminal to prevent an accidental short circuit. Pry out on the ride control switch and disconnect the wiring. Unsnap the switch trim and remove (2) 10mm hex-head bolts exposed. Open the center console door, remove (4) screws from the inner hinge and remove the door. Open the ashtray and remove (1) screw exposed. Remove the ashtray and (1) screw exposed. Unclip the small grille to the left of the ignition switch and remove (1) screw exposed. Unclip the base of the radio trim bezel and remove.

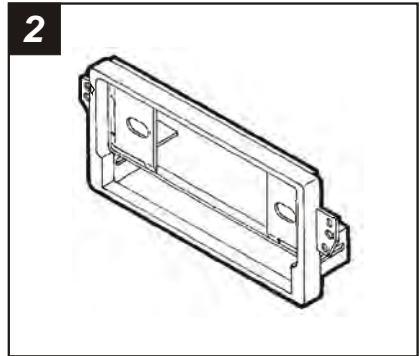

Locate the **Radio Housing**. Skip to the *Installation Instructions for ALL VEHICLES* on Page #5.

CHEVROLET Lumina / Monte Carlo 1995-01

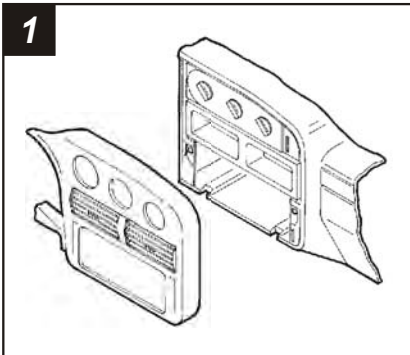

Disconnect the negative battery terminal to prevent an accidental short circuit. Unclip the dash trim bezel and remove. (It may be necessary to loosen the knee bolster). Remove (2) 7mm hex-head screws securing the factory head unit and disconnect the wiring.

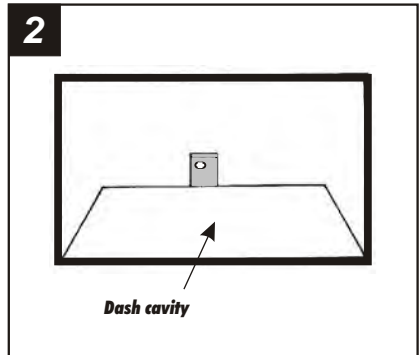

Locate the rear support system in the dash cavity. Cut and remove the shaded portion of the dash cavity plastic. Skip to the *Installation Instructions for ALL VEHICLES* on Page #5.

CHEVROLET Malibu 1997-00

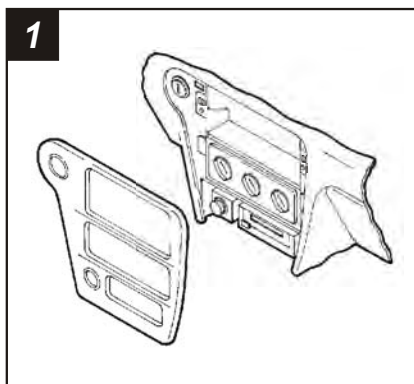

Disconnect the negative battery terminal to prevent an accidental short circuit. Unclip the radio trim bezel and remove. Remove (2) 9/32" hex-head screws securing the factory head unit and disconnect the wiring.

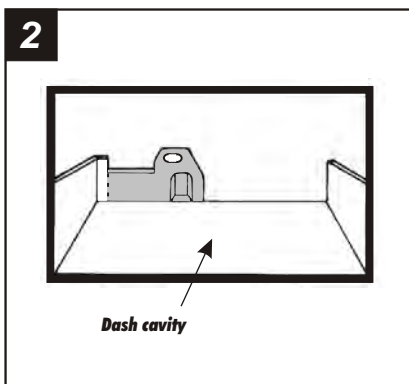

Locate the rear support system in the dash cavity. Cut and remove the shaded portion of the dash cavity plastic. *Skip to the Installation Instructions for ALL VEHICLES on Page #5.*

CHEVROLET Venture 1997-99 / OLDSMOBILE Silhouette 1997-00 PONTIAC Montana 1999 / TransSport 1997-99

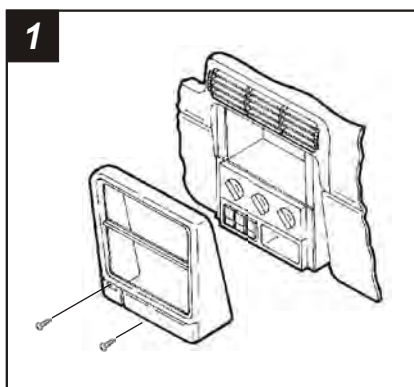

Disconnect the negative battery terminal to prevent an accidental short circuit. Remove the ashtray and (1) Phillips screw exposed in the ashtray cavity. Remove (1) Phillips screw from the cigarette lighter compartment. Remove (2) Phillips screws securing the factory head unit and disconnect the wiring.

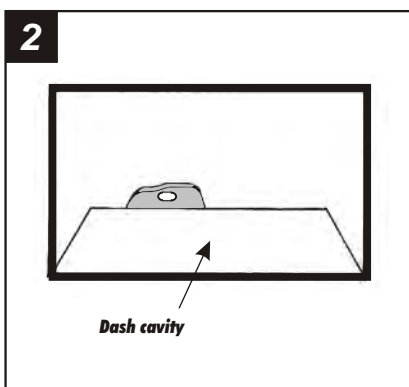

Locate the rear support system in the dash cavity. Cut and remove the shaded portion of the dash cavity plastic. *Skip to the Installation Instructions for ALL VEHICLES on Page #5.*

ALL VEHICLES

3

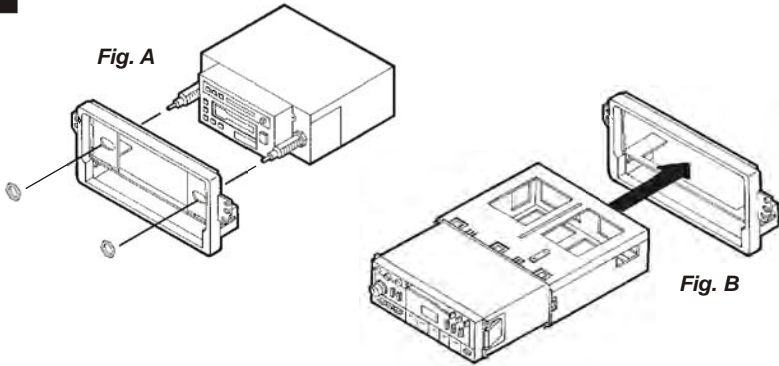

2-SHAFT HEAD UNITS: Slide the aftermarket head unit into the kit and secure with shaft nuts. (see Fig. A)

DIN HEAD UNITS: Cut and remove the shaft supports. Slide the DIN cage into the kit and secure by bending the metal locking tabs down. Slide the aftermarket head unit into the cage until secure. (see Fig. B)

4

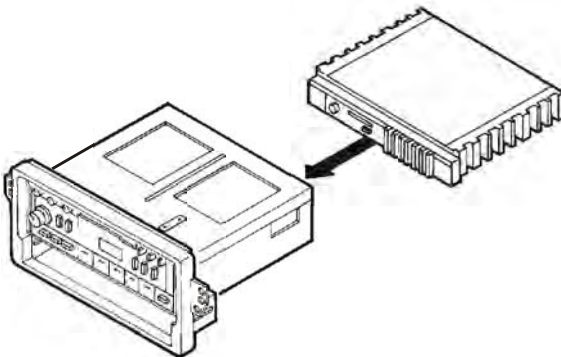

Slide the aftermarket equalizer into the back of the kit and secure using the hardware included with the equalizer.

5

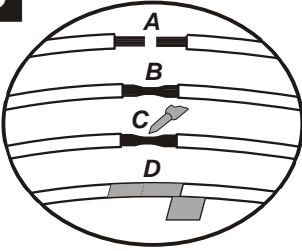
5

- A) Strip wire ends back ½"**
- B) Twist ends together**
- C) Solder**
- D) Tape**

Locate the factory wiring harness in the dash. Metra recommends using the proper mating adaptor and making connections as shown. (Isolate and individually tape off the ends of any unused wires to prevent electrical short circuit).

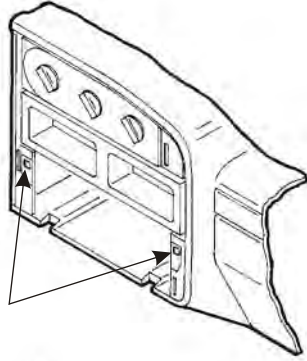
6

Locate the (2) mounting positions in the sub-dash.

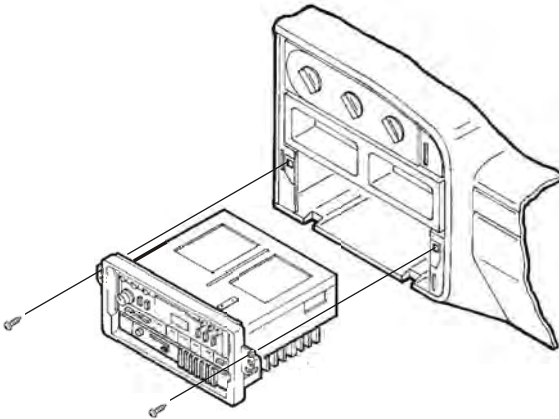
7

Re-connect the battery terminal and test the unit for proper operation. Mount the head unit/kit assembly to the sub-dash with those screws previously removed in step #1. (For the Malibu, use the center mounting positions).