



## INSTALLATION INSTRUCTIONS FOR PART 99-7862

### APPLICATIONS

# Honda Accord

## 2003-2007

# 99-7862

#### KIT FEATURES

- DIN Head Unit Provision with pocket
- ISO DIN Head Unit Provision with pocket



#### KIT COMPONENTS

- A) Radio Housing • B) ISO Brackets • C) ISO Trimplate • D) Radio Harness

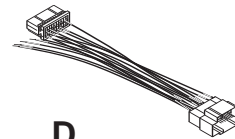
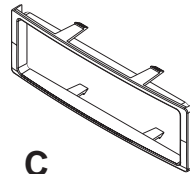
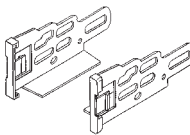
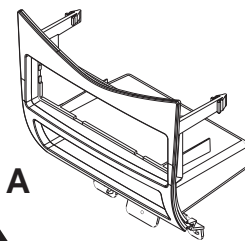

#### TOOLS REQUIRED:

- Phillips Screwdriver • Small Flat Blade Screwdriver Or Panel Removal Tool

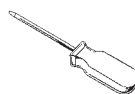
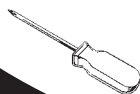

1-800-221-0932



[www.metraonline.com](http://www.metraonline.com)

© COPYRIGHT 2004-2007 METRA ELECTRONICS CORPORATION



# **TABLE OF CONTENTS**

## **Dash Disassembly**

**- Honda Accord 2003-2007 ..... 1, 2**

## **Kit Assembly**

**- DIN Head Unit Provision ..... 3**

**- ISO DIN Head Unit Provision ..... 4**

**Final Assembly ..... 5**

**HONDA ACCORD 2003-2007**

- 1 Disconnect the negative battery terminal to prevent an accidental short circuit.
- 2 Unsnap and remove shift lever trim ring. (Figure A)
- 3 Unsnap coin tray/ashtray from assembly and remove. Rubber cover may come out first but entire assembly must be removed to access screws below. (Figure B)
- 4 Remove (2) Phillips screws from under coin tray/ashtray and remove entire assembly. (Figure C)

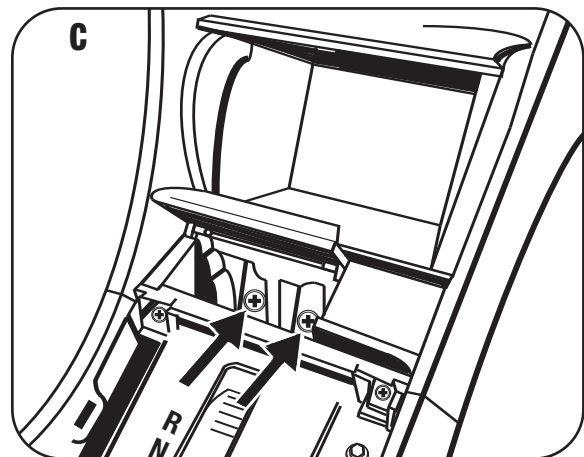
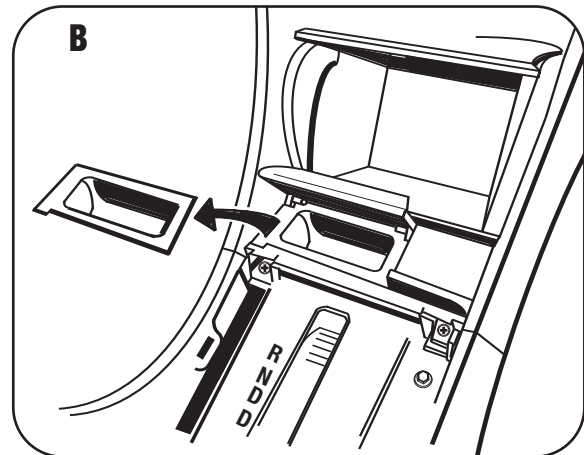
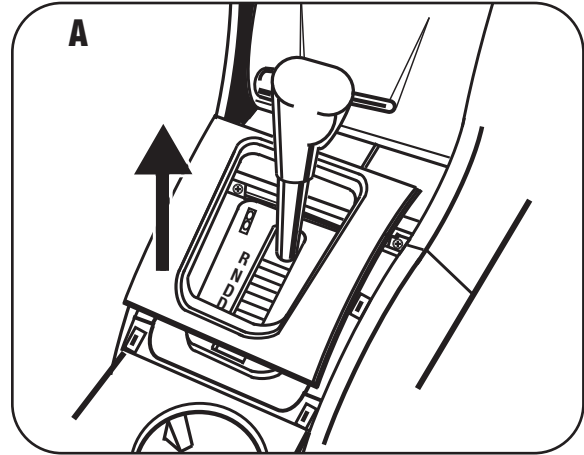

## HONDA ACCORD 2003-2007

- 5 Remove (2) Phillips screws from bottom of pocket assembly and unsnap and remove. (Figure D)
- 6 Remove (2) Phillips screws facing up under radio/climate control assembly. (Figure E)
- 7 Unsnap and remove upper panel (including a/c vents) and remove (3) Phillips screws behind the panel. (Figure F)

**Tip:** *You can use a hook tool to grasp the panel inside of the vent and pull toward the rear of the vehicle. Be careful not to scratch the panel.*

- 8 Unclip and remove radio/climate control assembly.

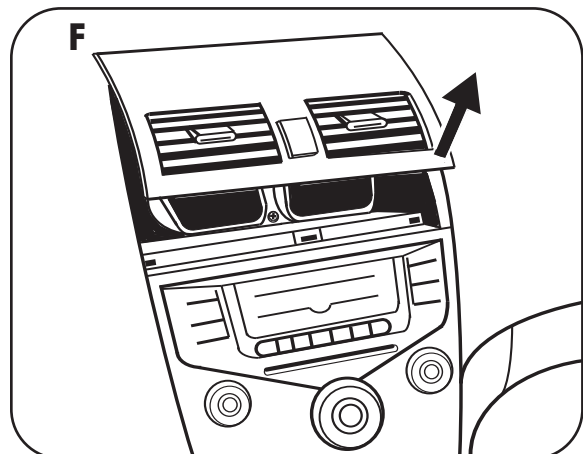
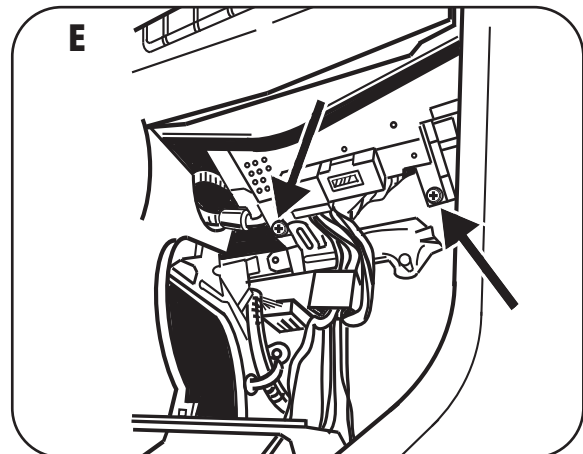
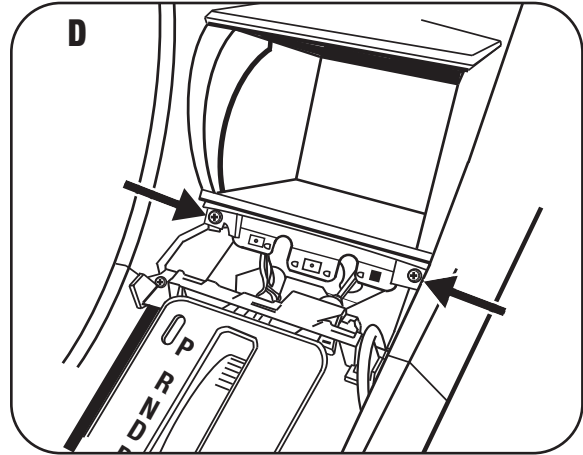

## DIN HEAD UNIT PROVISION

- 1** Snap the DIN cage into the Radio Housing and secure by bending the metal locking tabs down.. (Figure A)
- 2** Slide the aftermarket radio into the cage and secure. (Figure B)
- 3** Skip to step #1 in the Final Assembly.

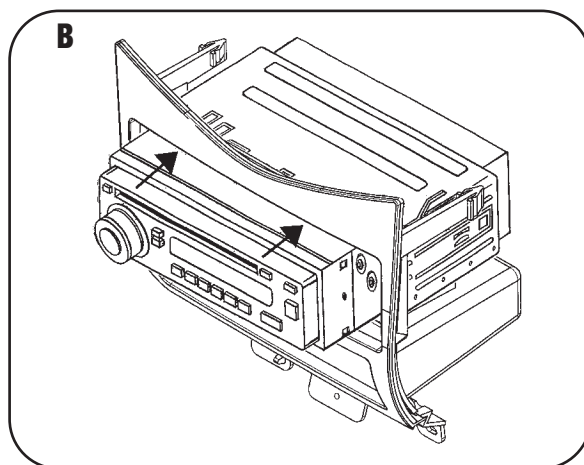
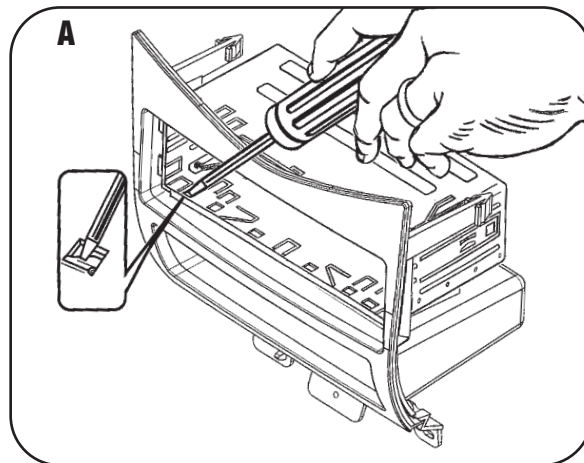

## ISO DIN HEAD UNIT PROVISION

- 1** Mount the ISO Brackets to the head unit with the screws supplied with the unit. (Figure A)
- 2** Slide the head unit into the radio opening until the side clips engage. Snap the Trim plate into the Radio Housing. (Figure B)
- 3** Skip to step #1 in the Final Assembly.

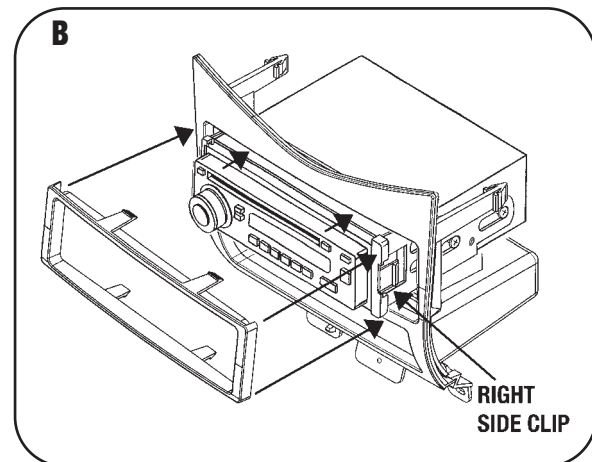
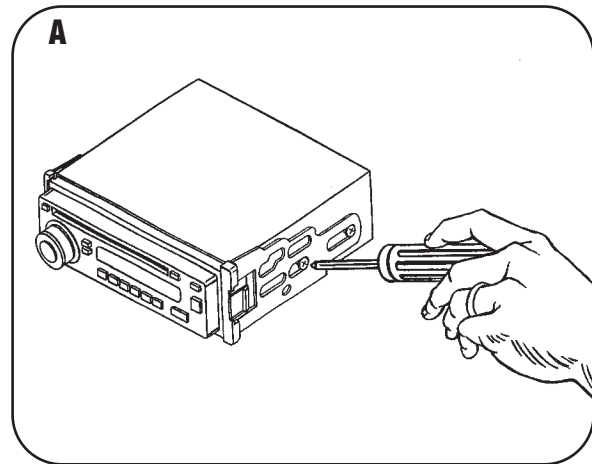

# FINAL ASSEMBLY

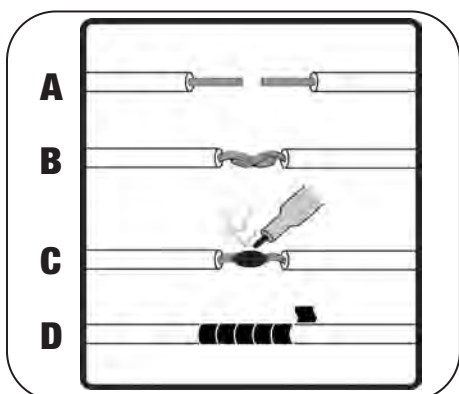

- A) Strip wire ends back 1/2"**
- B) Twist ends together**
- C) Solder**
- D) Tape**

- 1** Make the wiring connections from the radio harness included with this kit to the harness included with your radio using the EIA color code shown below. (Isolate and individually tape off the ends of any unused wires to prevent electrical short circuit.)
- 2** Unplug factory harness from factory radio and plug the new harness in between the factory harness and the factory radio.
- 3** Re-connect the negative battery terminal and test the unit for proper operation.
- 4** Reassemble radio and dash assemblies in reverse order of disassembly.

## FINAL WIRING CONNECTIONS

Make wiring connections using the EIA color code chart shown below and the instructions included with the head unit. Metra recommends making connections as shown below; Strip, Splice, Solder, Tape. Isolate and individually tape off ends of any unused wires to prevent electrical short circuit.

### METRA / EIA WIRING CODE

12V Ignition / Acc . . . Red	Right Front (+) . . . . Gray
12V Batt / Memory . . Yellow	Right Front (-) . . . . Gray/ Black
Ground . . . . . Black*	Left Front (+) . . . . . White
Power Antenna . . . . . Blue	Left Front (-) . . . . . White / Black
Amp Turn-On . . . . . Blue / White	Right Rear (+) . . . . . Violet
Amp Ground . . . . . Black / White	Right Rear (-) . . . . . Violet / Black
Illumination . . . . . Orange	Left Rear (+) . . . . . Green
Dimmer . . . . . Orange / White	Left Rear (-) . . . . . Green / Black

**\*NOTE:** When a Black wire is not present, ground radio to vehicle chassis.

All colors may not be present on all leads due to manufacturer's specifications.

# 99-7862 INSTRUCTIONS



1-800-221-0932



[www.metraonline.com](http://www.metraonline.com)

REV. 06/19/07

© COPYRIGHT 2004 METRA ELECTRONICS CORPORATION

INST99-7862