



# INSTALLATION INSTRUCTIONS FOR PART 99-7871

## APPLICATIONS

# Honda Civic 2006-2009

# 99-7871/ 99-7871T

### KIT FEATURES

- DIN Head Unit Provision with Pocket
- ISO DIN Head Unit Provision with Pocket
- Double DIN Head Unit Provision
- ISO Stacked Head Unit Provision
- Stacked DIN Head Unit Provision
- Painted To Match Factory Dash:  
99-7871= Gunmetal, 99-7871T= Taupe



### KIT COMPONENTS

- A) Radio Housing • B) DDIN Trim Plate • C) ISO Trim Plate • D) Double DIN Brackets • E) Pocket  
• F) (8) #8 Phillips Screws • G) ISO Brackets • H) (5) White Plastic Clips • I) (6) Metal Clips

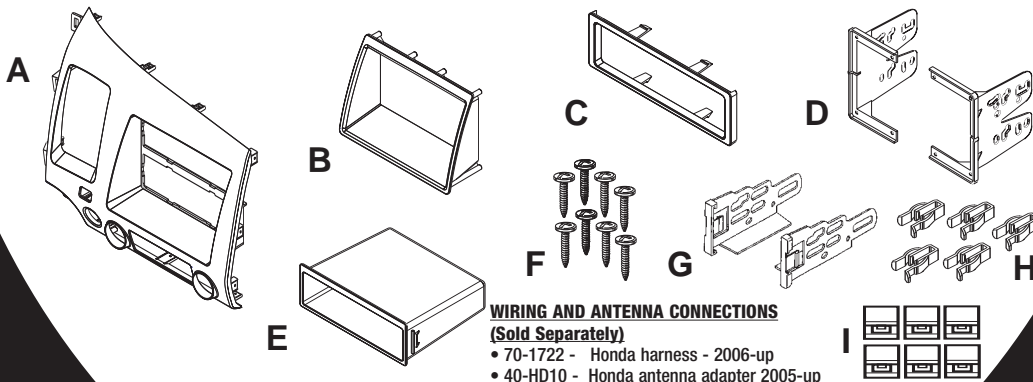

### TOOLS REQUIRED:

- Small Flat Screwdriver • Phillips Screwdriver • Socket Wrench

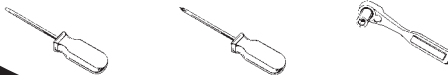

1-800-221-0932



www.metraonline.com



# TABLE OF CONTENTS

---

**Dash Disassembly**

***Honda Civic 2006-2009..... 1,2***

**Kit Assembly:**

***DIN Head Unit Provision..... 3***

***ISO DIN Head Unit Provision ..... 4***

***Double DIN Head Unit Provision ..... 5***

***Stacked ISO DIN Head Unit Provision..... 6***

***Stacked DIN Head Unit Provision. .... 7***

**Final Assembly ..... 8**



**KNOWLEDGE IS POWER**

Enhance your installation and fabrication skills by enrolling in the most recognized and respected mobile electronics school in our industry.

Log onto [www.installerinstitute.com](http://www.installerinstitute.com) or call 800-354-6782 for more information and take steps toward a better tomorrow.

## HONDA CIVIC 2006-2009

- 1 Disconnect the negative battery terminal to prevent an accidental short circuit.
- 2 Unclip and remove the panel below the steering wheel. (Figure A)
- 3 Remove the (1) Phillips screw exposed on the lower left side of the panel above the steering wheel and around the instrument cluster. (Figure B)
- 4 Unclip and remove the panel around top of steering wheel and instrument cluster. (Figure C)
- 5 Remove panel inside pocket below radio and climate controls then remove (2) 8 MM screws facing up behind panel. (Figure D)

A

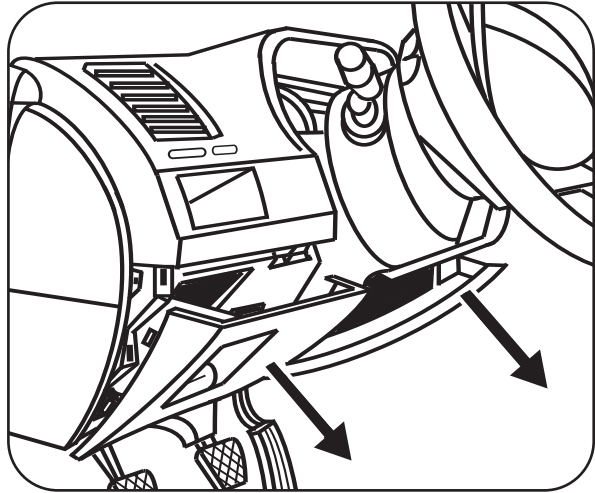

B

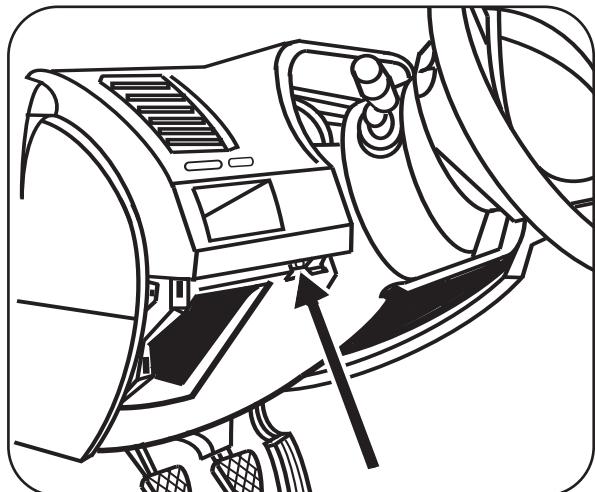

C

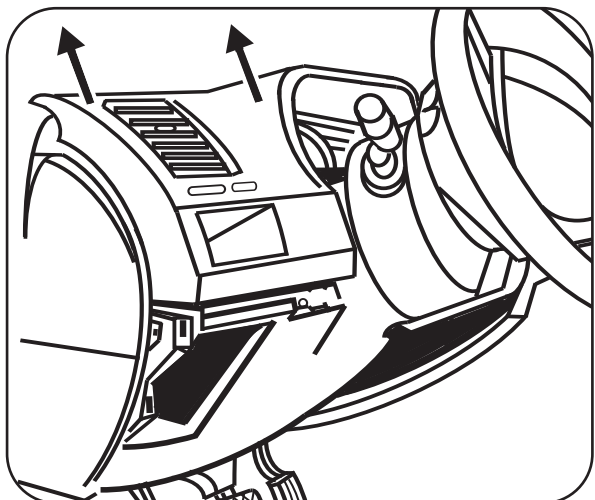

D

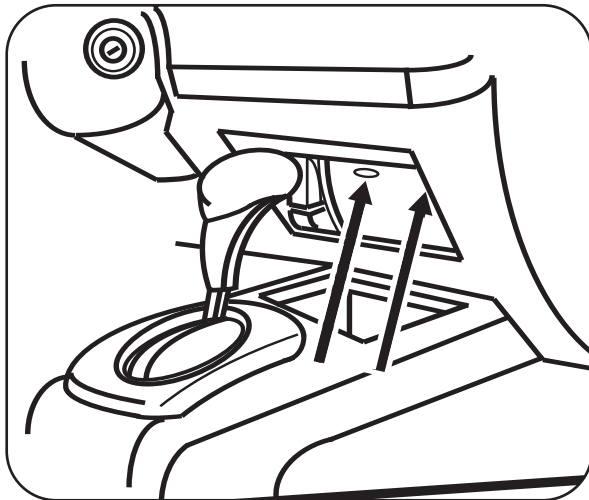

## HONDA CIVIC 2006-2009

- 6 Unclip and remove radio/climate control assembly. (Figure E)
- 7 Remove (3) Phillips screws securing the a/c vent to the radio/climate control panel. (Figure F)
- 8 Remove the (4) Phillips screws securing the climate control to the radio/climate control panel. (Figure F)
- 9 Remove the (2) Phillips screws securing the hazard switch to the radio/climate control panel. (Figure F)
- 10 Remove the (2) Phillips screws securing the passenger air bag on/off light to the radio/climate control panel. (Figure F)

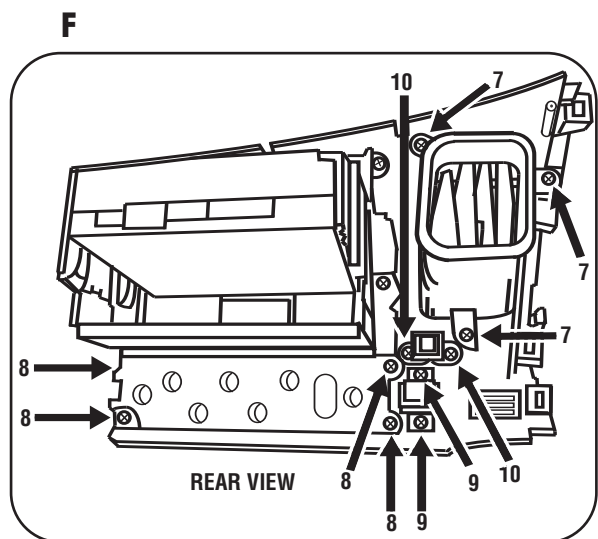
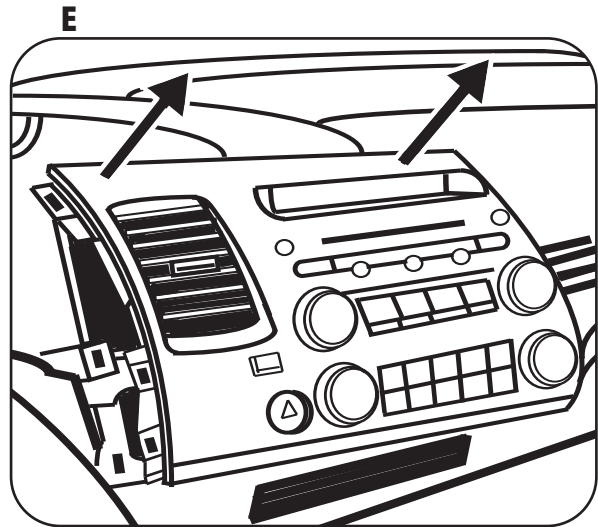

## DIN HEAD UNIT PROVISION

**NOTE:** Secure the a/c vent, climate control, hazard switch, and the passenger air bag on/off light into the 99-7871 radio housing panel using the factory hardware. **(Figure A1)** Position the (6) metal factory retaining clips and (5) plastic white clips onto the radio housing in the same location as the factory radio/climate control panel. **(Figure A2)**

- 1 Slide the pocket into the bottom section of the kit housing. **(Figure B)**
- 2 Slide the DIN cage into the Radio Housing and secure by bending the metal locking tabs down. **(Figure C)**
- 3 Slide the aftermarket head unit into the cage and secure. **(Figure D)**

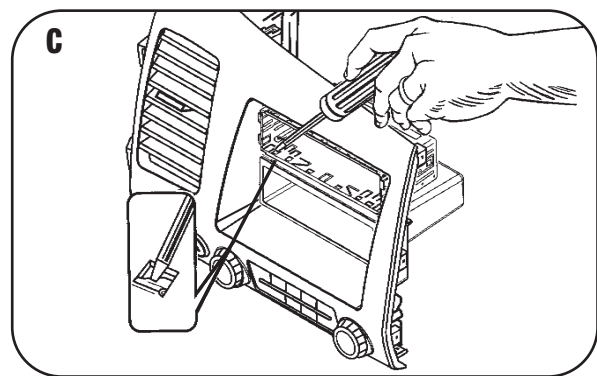
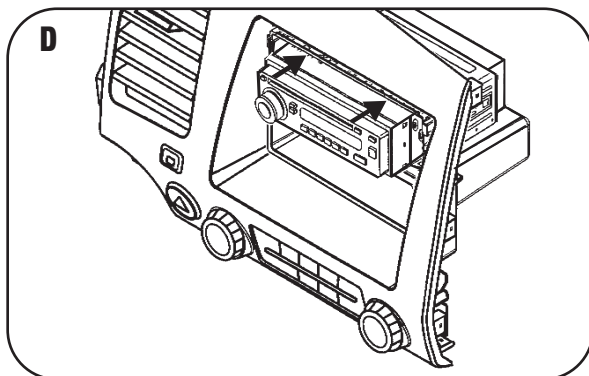
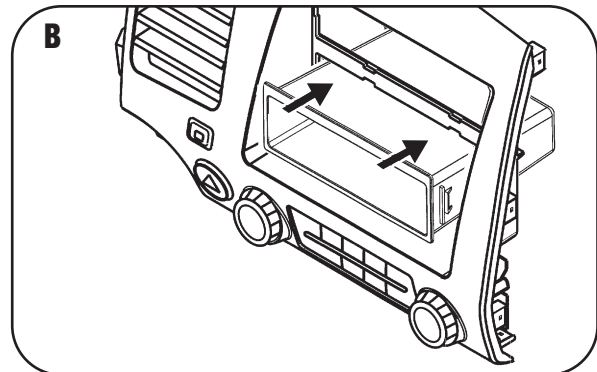
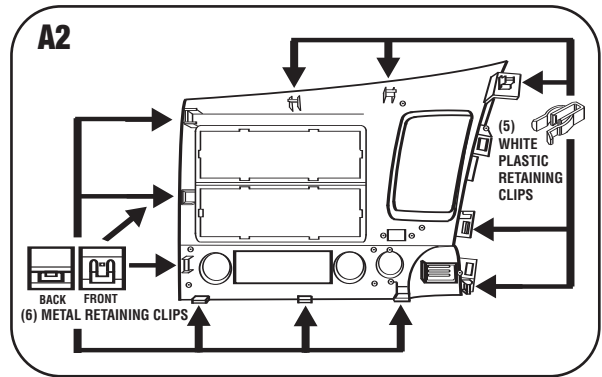
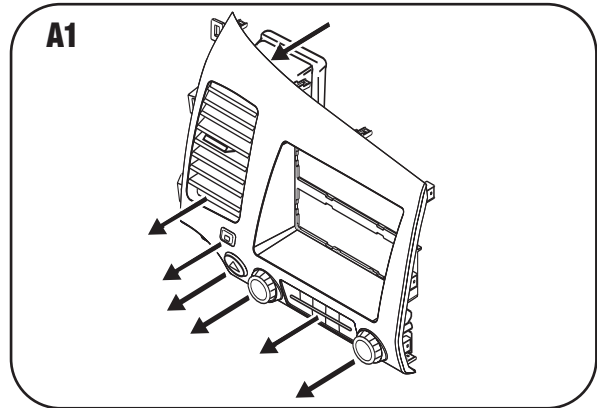

## ISO DIN HEAD UNIT PROVISION

**NOTE:** Secure the a/c vent, climate control, hazard switch, and the passenger air bag on/off light into the 99-7871 radio housing panel using the factory hardware. (Figure A1)  
Position the (6) metal factory retaining clips and (5) plastic white clips onto the radio housing in the same location as the factory radio/climate control panel. (Figure A2)

- 1 Slide the pocket into the bottom section of the kit housing. (Figure B)
- 2 Mount the ISO Brackets to the head unit with the screws supplied with the unit. (Figure C)
- 3 Slide the head unit into the radio opening until the side clips engage. (Figure D)
- 4 Snap the Trim plate into the Radio Housing. (Figure D)

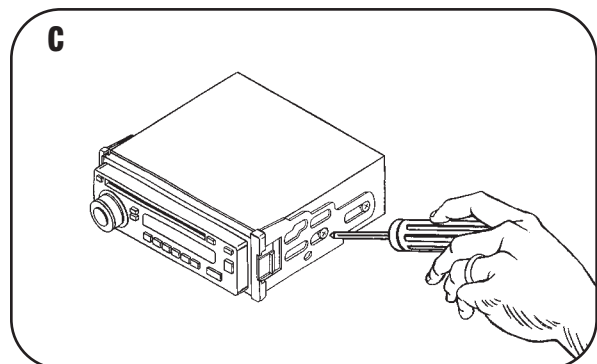
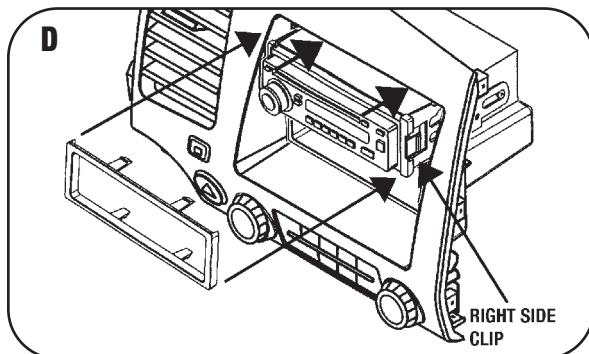
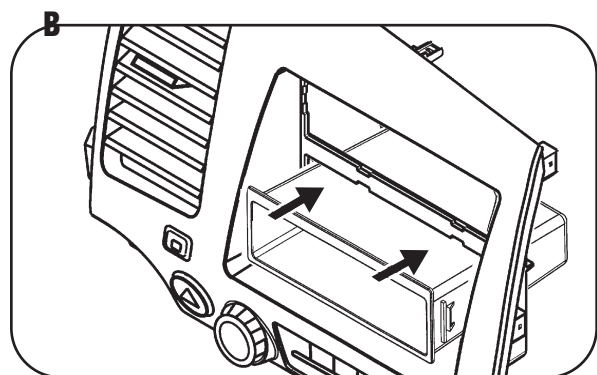
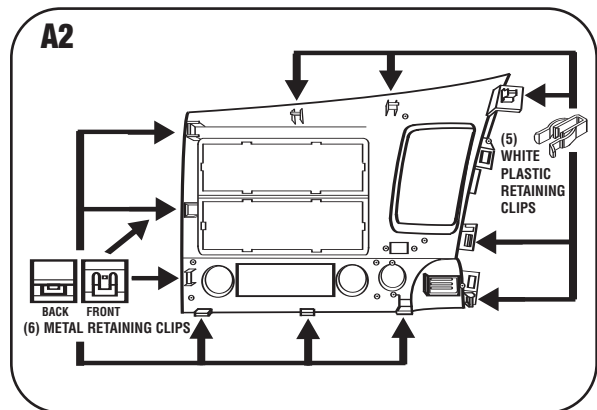
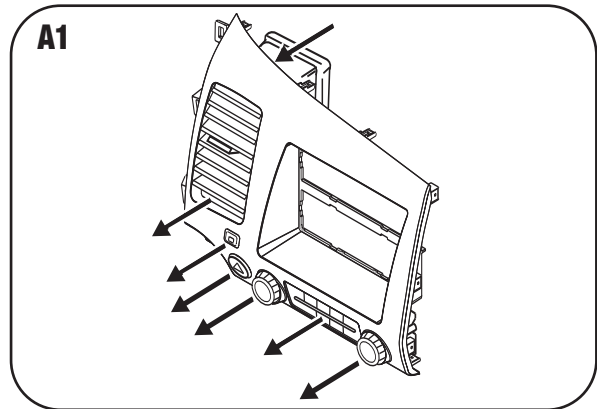

## DOUBLE DIN HEAD UNIT PROVISION

**NOTE:** Secure the a/c vent, climate control, hazard switch, and the passenger air bag on/off light into the 99-7871 radio housing panel using the factory hardware. (Figure A1)  
Position the (6) metal factory retaining clips and (5) plastic white clips onto the radio housing in the same location as the factory radio/climate control panel. (Figure A2)

- 1 Remove the center bar from the 99-7871 radio housing. (Figure B)
- 2 Attach the corresponding bracket to the DDIN head unit. (Figure C)
- 3 Insert the DDIN trim plate into the radio housing. (Figure D)
- 4 Position the bracket/radio assembly to the back of the radio housing and secure with the (8) Phillips screws provided. (Figure D)

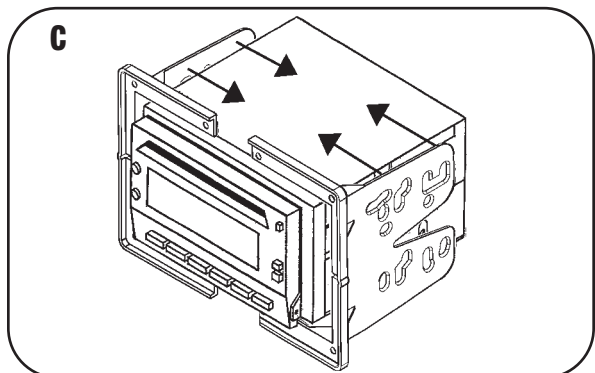
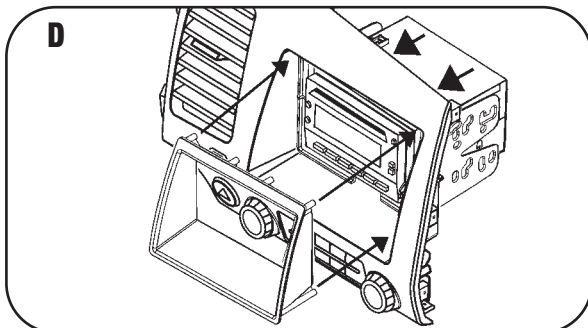
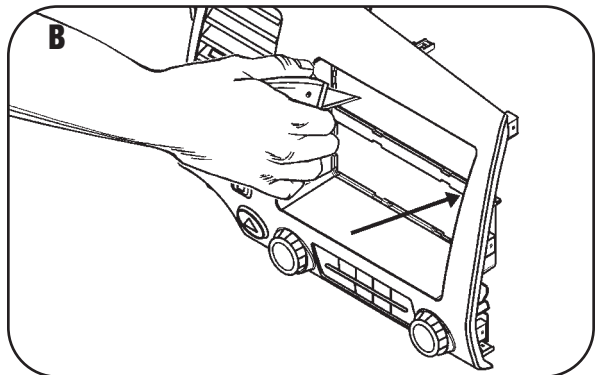
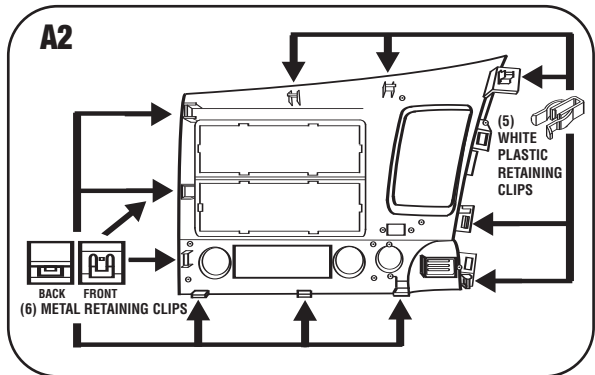
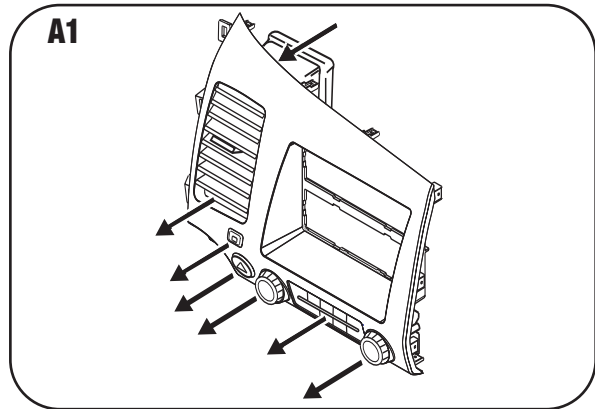

## STACKED ISO DIN HEAD UNIT PROVISION

**NOTE:** Secure the a/c vent, climate control, hazard switch, and the passenger air bag on/off light into the 99-7871 radio housing panel using the factory hardware. (Figure A1) Position the (6) metal factory retaining clips and (5) plastic white clips onto the radio housing in the same location as the factory radio/climate control panel. (Figure A2)

- 1 Remove the center bar from the 99-7871 radio housing. (Figure B)
- 2 Attach the corresponding bracket to the (2) ISO head units. (Figure C)
- 3 Insert the DDIN trim plate into the radio housing. (Figure D)
- 4 Position the bracket/radio assembly to the back of the radio housing and secure with the (8) Phillips screws provided. (Figure D)

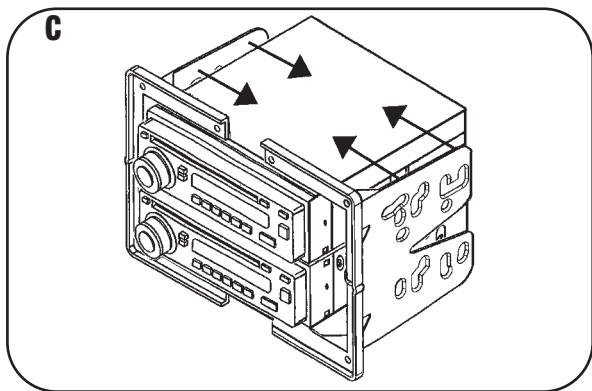
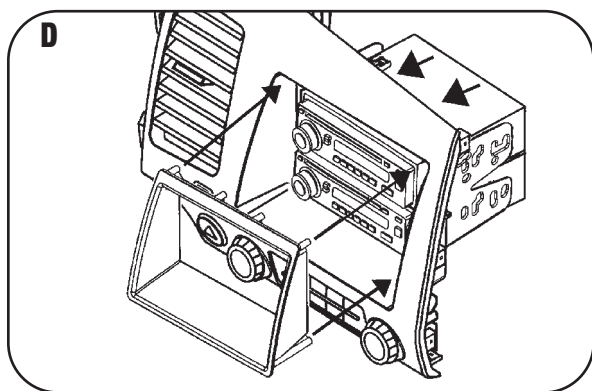
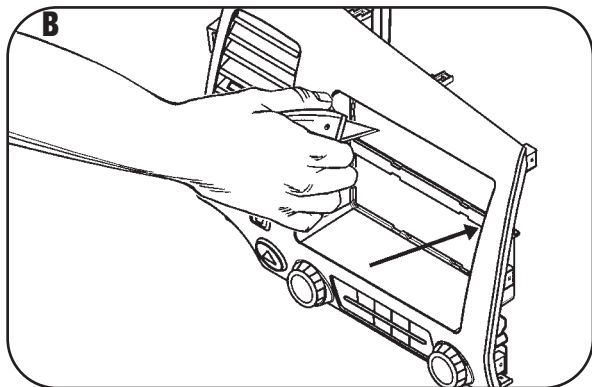
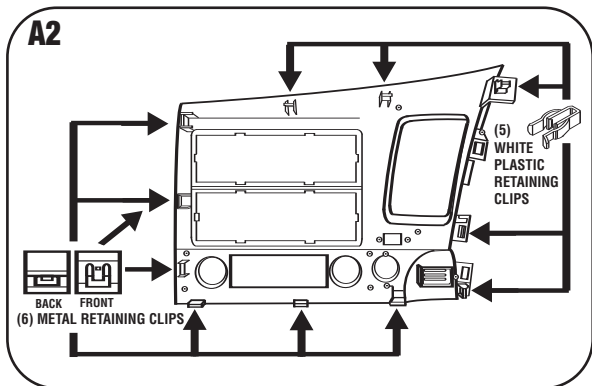
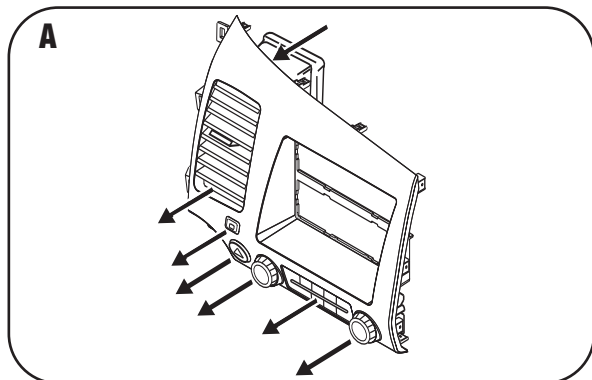



## STACKED DIN HEAD UNIT PROVISION

**NOTE:** Secure the a/c vent, climate control, hazard switch, and the passenger air bag on/off light into the 99-7871 radio housing panel using the factory hardware. (Figure A1) Position the (6) metal factory retaining clips and (5) plastic white clips onto the radio housing in the same location as the factory radio/climate control panel. (Figure A2)

- 1 Slide the DIN cages into the Radio Housing and secure by bending the metal locking tabs outward. (Figure B)
- 2 Slide the aftermarket head units into the cages and secure. (Figure C)

A1

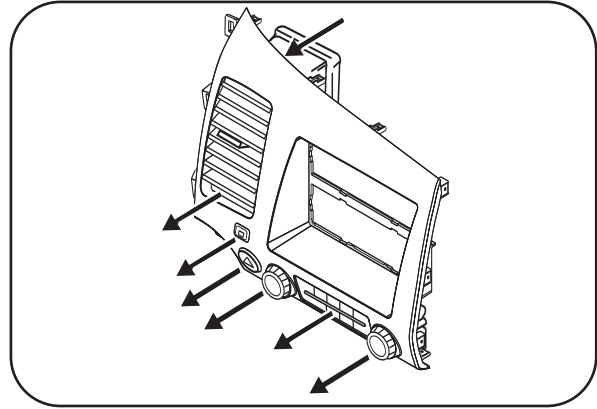

A2

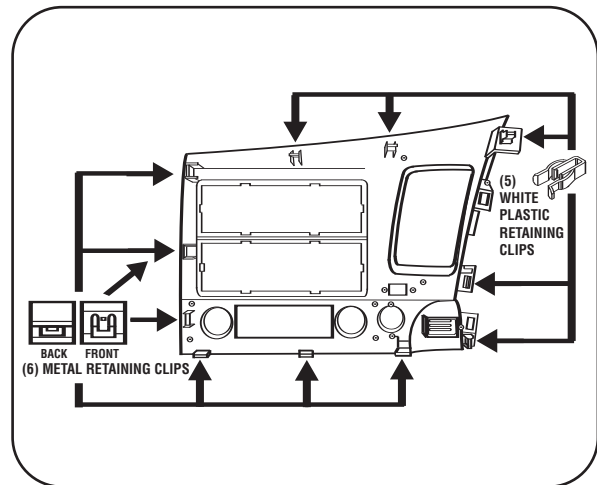

C

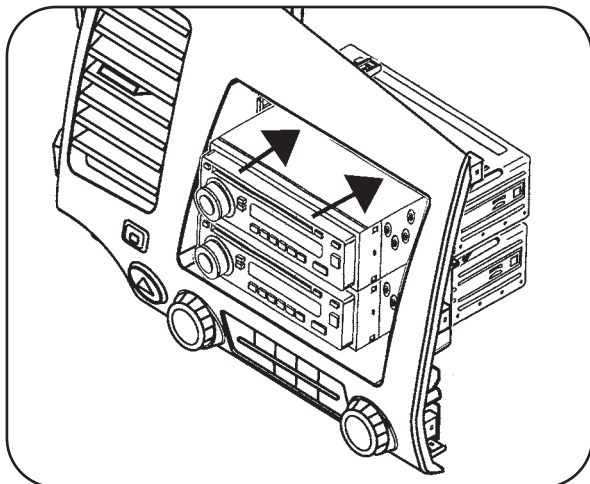

B

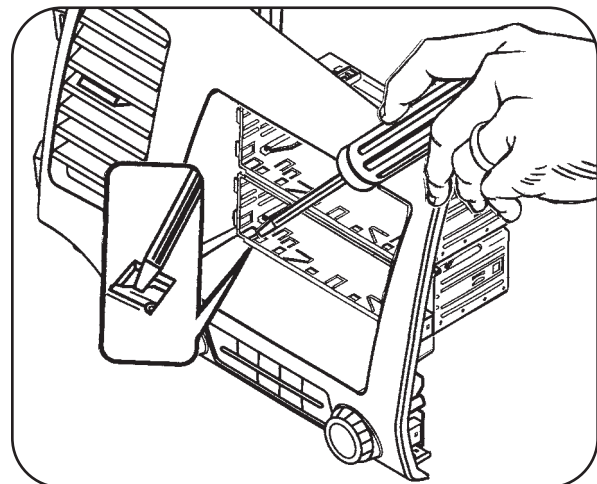

## FINAL ASSEMBLY

- 1 Locate the factory wiring harness in the dash and make the connection as shown. Metra recommends using the proper mating adapter and making the connections as shown. (Isolate and individually tape off the ends of any unused wires to prevent electrical short circuit.)
- 2 Re-connect the negative battery terminal and test the unit for proper operation.
- 3 Reassemble radio and dash assemblies in reverse order of disassembly.

### FINAL WIRING CONNECTIONS

Make wiring connections using the EIA color code chart shown below and the instructions included with the head unit. Metra recommends making connections as shown below; Strip, Splice, Solder, Tape. Isolate and individually tape off ends of any unused wires to prevent electrical short circuit.

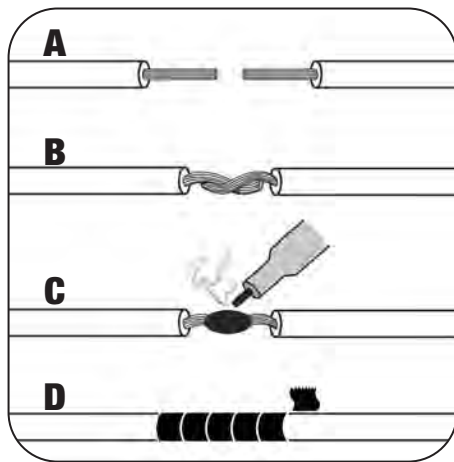

- A) Strip wire ends back 1/2"**
- B) Twist ends together**
- C) Solder**
- D) Tape**

### METRA / EIA WIRING CODE

12V Ignition / Acc . . . Red	Right Front (+) . . . . . Gray
12V Batt / Memory . . Yellow	Right Front (-). . . . . Gray / Black
Ground . . . . . Black*	Left Front (+) . . . . . White
Power Antenna . . . . . Blue	Left Front (-). . . . . White / Black
Amp Turn-On . . . . . Blue / White	Right Rear (+). . . . . Violet
Amp Ground . . . . . Black / White	Right Rear (-) . . . . . Violet / Black
Illumination. . . . . Orange	Left Rear (+). . . . . Green
Dimmer . . . . . Orange / White	Left Rear (-) . . . . . Green / Black

**\*NOTE:** When Black a wire is not present, ground radio to vehicle chassis.

All colors may not be present on all leads due to manufacturer's specifications.



# 99-7871 INSTRUCTIONS



1-800-221-0932



[www.metraonline.com](http://www.metraonline.com)

REV. 06/29/09 © COPYRIGHT 2004-2009

METRA ELECTRONICS CORPORATION INST99-7871