



INSTALLATION INSTRUCTIONS FOR PART 99-9303

APPLICATIONS **BMW Z4** **2003-2008**

99-9303

KIT FEATURES

- DIN Head Unit Provision

KIT COMPONENTS

A) Radio Housing

TOOLS REQUIRED:

Small Flat Blade Screwdriver • Phillips Screwdriver

A

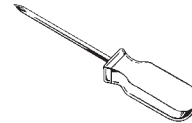
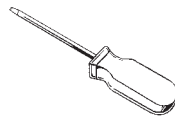

WIRING AND ANTENNA CONNECTIONS (Sold Separately)

- 40-EU10 - European antenna adapter
- 70-9003 - European harness

TABLE OF CONTENTS

Dash Disassembly: pg. 1

Kit Assembly: pg. 2

Final Assembly: pg. 3



1-800-221-0932



www.metraonline.com

REV. 04-17-09 © COPYRIGHT 2004-2009 METRA ELECTRONICS CORPORATION

BMW Z4 2003-2008

- 1 Disconnect the negative battery terminal to prevent an accidental short circuit.

NOTE: Make sure the vent on/off dials are in the middle position.

- 2 Using a small flat blade screwdriver, release the metal clip located inside the vents facing upward on the left and right side while pulling the vents outward from the dash. (Figure A)

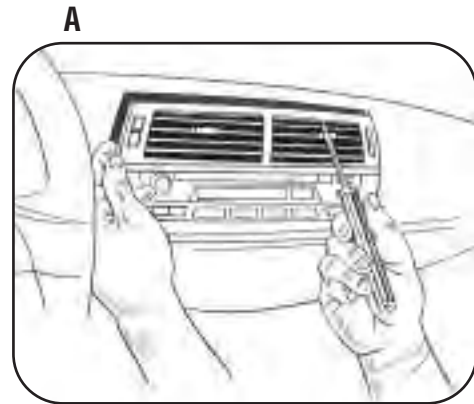

- 3 Remove (2) Phillips screws exposed at top of radio and remove. (Figure B)

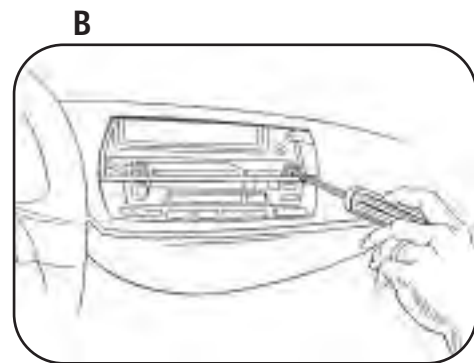

99-9303

DIN HEAD UNIT PROVISION

NOTE:

The bottom bar connecting the two sides of the 99-9303 will need to be cut and removed prior to Kit Assembly. (Figure A)

- 1 Screw the 99-9303 housing into the dash opening instead of the factory radio. (Figure B)
- 2 Slide the DIN cage into the space in the 99-9303 and secure by bending the metal locking tabs outward. (Figure C)
- 3 Slide the aftermarket head unit into the DIN cage until secure. (Figure D)

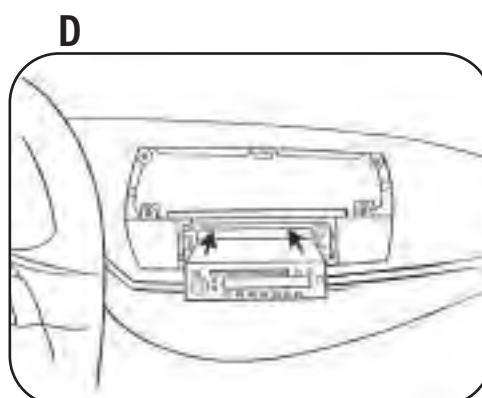
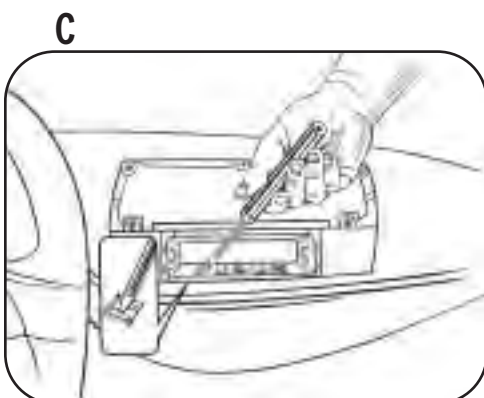
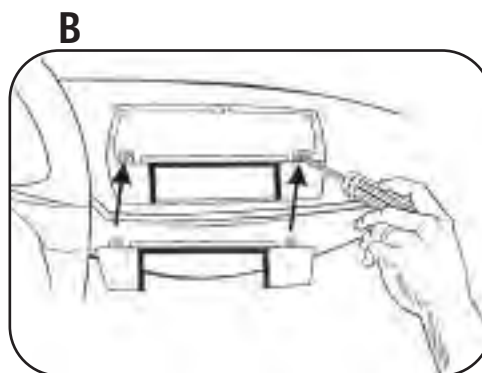
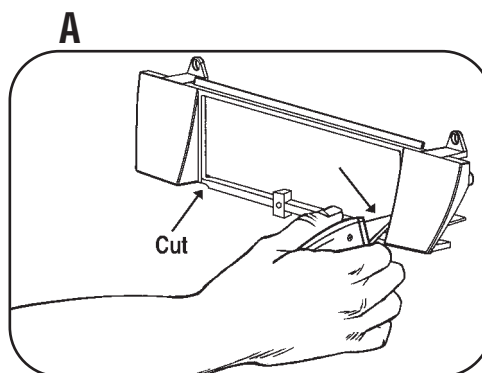

KIT ASSEMBLY



99-9303

FINAL ASSEMBLY

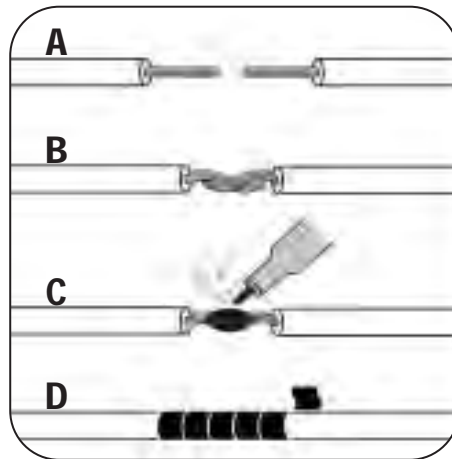

- A) Strip wire ends back 1/2"*
- B) Twist ends together*
- C) Solder*
- D) Tape*

- 1** Locate the factory wiring harness in the dash. Metra recommends using the proper mating adapter and making the connections as shown. (Isolate and individually tape off the ends of any unused wires to prevent electrical short circuit)
- 2** Re-connect the negative battery terminal and test the unit for proper operation.
- 3** Reassemble radio and dash assemblies in reverse order of disassembly.



KNOWLEDGE IS POWER

Enhance your installation and fabrication skills by enrolling in the most recognized and respected mobile electronics school in our industry. Log onto www.installerinstitute.com or call 800-354-6782 for more information and take steps toward a better tomorrow.