

### 2007-2010 BMW 335 Sedan Touring

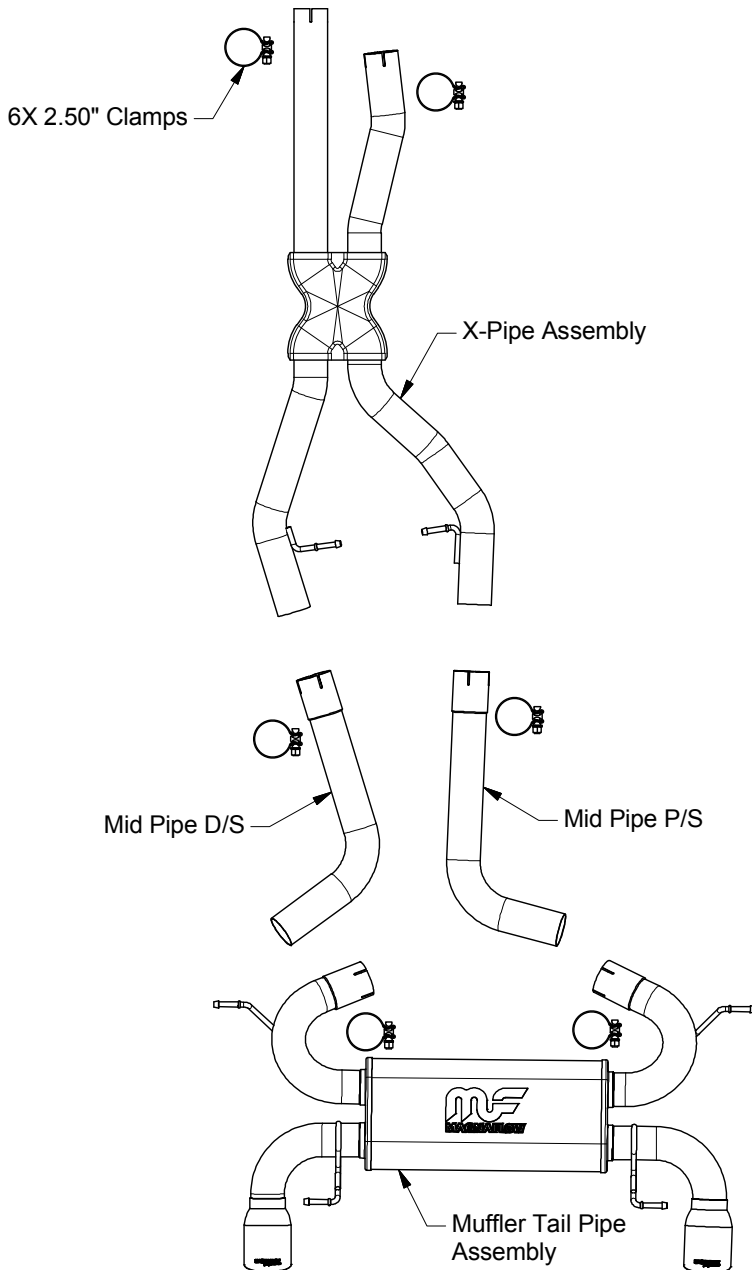

**Warning:** When working on, under, or around any vehicle exercise caution. Please allow the vehicle's exhaust system to cool before removal, as exhaust system temperatures may cause severe burns. If working without a lift, always consult vehicle manual for correct lifting specifications. Always wear safety glasses and ensure a safe work area. Serious injury or death could occur if safety measures are not followed.

**Step 1:** (Carefully read all instructions before installation). To remove the OEM exhaust system you will need to cut each pipe approximately 5" rearward of the driver side catalytic converter and 3" rearward of the passenger side catalytic converter. Remove the exhaust hangers from the rubber isolators. Be sure to retain all mounting hardware as it will be needed to mount your new MAGNAFLOW performance exhaust system.

**Step 2:** Begin installing your new exhaust system by slipping the inlet pipes of the X-Pipe assembly over the outlet pipes you have just cut. Loosely secure using the supplied clamps. Next slip both inlets of the Mid pipes over the outlets of the X-Pipe assembly and loosely secure using the supplied clamps. Mount the Tail Pipe Muffler assembly by slipping the inlet pipes over the outlet ends of the Mid pipes. Locate all hangers to the existing rubber isolators.

**Step 3:** With all components mounted loosely, adjust the system for overall aesthetics and clearance of frame & bodywork. (MAGNAFLOW recommends at least 1/2" of clearance between the exhaust system and any body panels to prevent heat-related body damage or fire.)

**Step 4:** Once a final position has been chosen for the new system, evenly tighten all fasteners from front to rear. The supplied band clamps must be VERY tight to properly align the pipes and prevent leaks (Approximately 40ft-lbs). U-bolt clamps should be tightened to approximately 30-35ft-lbs. Inspect all fasteners after 25-50 miles of operation and retighten if necessary.

**\*\* Magnaflow Performance Exhaust recommends professional installation on all their products**