

# **MSD** **IGNITION** **INSTALLATION INSTRUCTIONS**

## **MSD Distributor Reluctor with Advance for EFI PN 8627**

### **Parts Included:**

- 1 - Reluctor
- 1 - Roll Pin
- 1 - Snap Ring

**Note:** The installation of this Reluctor requires a press. Care must be taken when disassembling the distributor and upon the assembly.

The EFI Reluctor is designed to provide an advanced ignition trigger signal to an ECU. This enables the ECU to control the ignition timing, and positions the rotor so its tip is leading into the distributor cap terminal.

There are three positions that the reluctor can be installed in. Standard, or 10° advanced for clockwise or counterclockwise rotation engines. Figure 1 shows the roll pin locations.

1. Disassemble the distributor by removing the gear and the shaft and pull the shaft from the housing.
2. Slide the reluctor/advance assembly off the shaft.
3. Remove the snap ring from below the reluctor (Figure 2).
4. Using a piece of round stock or a punch (.625"), carefully press the advance assembly from the reluctor.
5. Position the new reluctor in the desired advanced location. Support the advance assembly in the center to prevent damaging the weight pins. Carefully press the new reluctor onto the advance assembly. Be sure to keep the pin slot aligned!
6. Press, or gently tap the new dowel pin into the pin slot.
7. Install the snap ring making sure it snaps into the groove on the housing.
8. Reinstall the assembly to the shaft and assemble the distributor.

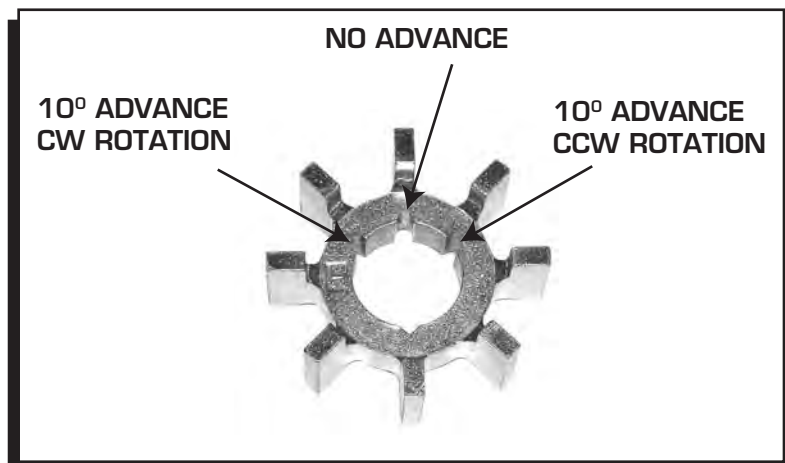

**Figure 1 Reluctor Assembly Locations.**

A PRESS MUST BE USED WHEN INSTALLING THE RELUCTOR. USING A HAMMER COULD RESULT IN DAMAGE TO THE RELUCTOR OR SHAFT BUSHING.

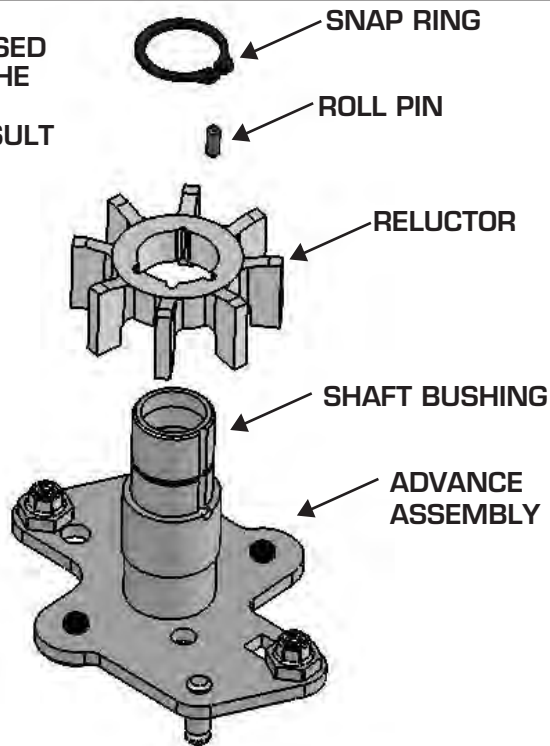

Figure 2 Reluctor Assembly.

### Service

In case of malfunction, this MSD component will be repaired free of charge according to the terms of the warranty. When returning MSD components for service, Proof of Purchase must be supplied for warranty verification. After the warranty period has expired, repair service is charged based on a minimum and maximum charge.

**All returns must have a Return Material Authorization (RMA) number** issued to them before being returned. To obtain an RMA number please contact MSD Customer Service at (915) 855-7123 or fax a request to (915) 857-3344. Send the unit prepaid with proof of purchase to the attention of: **MSD Ignition, Customer Service - RMA #, 12120 Esther Lama, Dock 5, El Paso, Texas 79936.**

When returning the unit for repair, leave all wires at the length in which you have them installed. Be sure to include a detailed account of any problems experienced, and what components and accessories are installed on the vehicle.

The repaired unit will be returned as soon as possible after receipt, COD for any charges. (Ground shipping is covered by warranty). All units are returned regular UPS unless otherwise noted. For more information, call the MSD Customer Service Line (915) 855-7123. MSD technicians are available from 7:00 a.m. to 6:00 p.m. Monday - Friday (mountain time).

### Limited Warranty

MSD IGNITION warrants MSD Ignition products to be free from defects in material and workmanship under normal use and if properly installed for a period of one year from date of purchase. If found to be defective as mentioned above, it will be replaced or repaired if returned prepaid along with proof of date of purchase. This shall constitute the sole remedy of the purchaser and the sole liability of MSD Ignition. To the extent permitted by law, the foregoing is exclusive and in lieu of all other warranties or representations whether expressed or implied, including any implied warranty of merchantability or fitness. In no event shall MSD Ignition be liable for special or consequential damages.