

# MSD IGNITION INSTALLATION INSTRUCTIONS

## MSD Launch Control PN 8735

**IMPORTANT:** Read these instructions completely before attempting the installation.

### Parts Included:

- 1 - Launch Control
- 4 - Mounting Screws

**WARNING:** During installation, disconnect the battery cables. When disconnecting the battery, always remove the Negative cable first and install it last.

The MSD Launch Control allows you to select three different rpm limits. Two limits, the race and burnout, are adjusted with plug-in modules. The launch (or holeshoot) limit is adjusted with the two rotary switches (Figure 1).

The launch and burnout limits are activated when 12 volts are supplied to their corresponding activation wires. When neither limit is activated, the overrev limit is active.

It is recommended to mount the Launch Control within easy reach of the driver so last minute adjustments can be made to the launch rpm setting. Also, make sure the wiring reaches the MSD Ignition. Mark the location of the mounting holes, then drill the holes using an 1/8" bit. Use the supplied mounting screws to secure the Control.

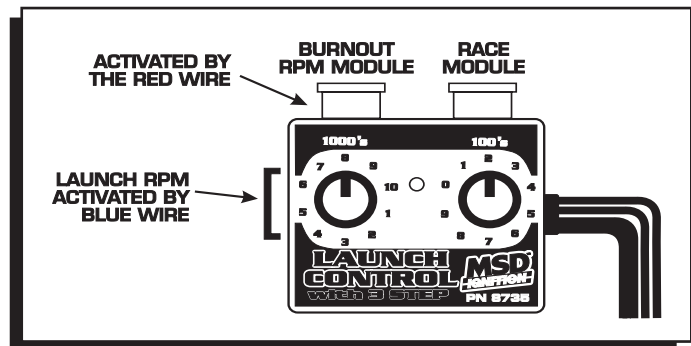
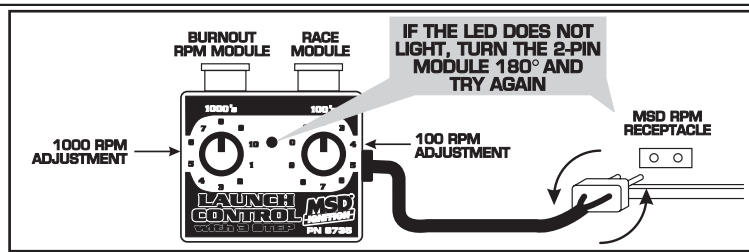
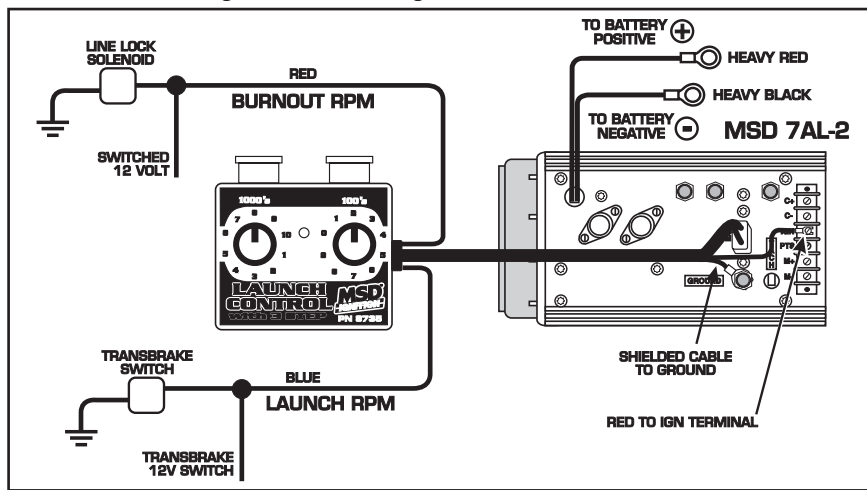

Figure 1 Module Controls and Adjustments.

## WIRE FUNCTIONS

ACTIVATION WIRES	
<b>BLUE</b>	Launch Module Activation Wire. When 12 volts are applied, the launch circuit is activated. <b>Note:</b> This circuit overrides the other modules.
<b>RED</b>	Burnout Activation Wire. When 12 volts are applied, this module (Burnout) is activated.
2-PIN MODULE HARNESS	
<b>BARE WIRE</b>	Connect to Ground on the MSD Ignition.
<b>RED</b>	Connects to Switched 12 volts, such as the IGN terminal on MSD 7 Series.
<b>2-PIN</b>	This connector plugs into the rpm module socket of an MSD Ignition or Rev Control. <b>Note:</b> The Control will only operate when this is installed one way. It is correct when the LED on the Control lights when the ignition is turned On. If the LED does not come on, turn the 2-Pin connector around and try again.

**Figure 2 Connecting the 2-Pin Connector.****Figure 3 Wiring with an MSD 7 Series Ignition.**

### Service

In case of malfunction, this MSD component will be repaired free of charge according to the terms of the warranty. When returning MSD components for warranty service, **Proof of Purchase** must be supplied for verification. After the warranty period has expired, repair service is based on a minimum and maximum fee.

**All returns must have a Return Material Authorization (RMA) number** issued to them before being returned. To obtain an RMA number please contact MSD Customer Service at 1 (888) MSD-7859 or visit our website at [www.msdition.com/rma](http://www.msdition.com/rma) to automatically obtain a number and shipping information.

When returning the unit for repair, leave all wires at the length in which you have them installed. Be sure to include a detailed account of any problems experienced, and what components and accessories are installed on the vehicle. The repaired unit will be returned as soon as possible using Ground shipping methods (ground shipping is covered by warranty). For more information, call MSD Ignition at (915) 855-7123. MSD technicians are available from 7:00 a.m. to 6:00 p.m. Monday - Friday (mountain time).

### Limited Warranty

MSD IGNITION warrants this product to be free from defects in material and workmanship under its intended normal use\*, when properly installed and purchased from an authorized MSD dealer, for a period of one year from the date of the original purchase. This warranty is void for any products purchased through auction websites. If found to be defective as mentioned above, it will be repaired or replaced at the option of MSD Ignition. Any item that is covered under this warranty will be returned free of charge using Ground shipping methods.

This shall constitute the sole remedy of the purchaser and the sole liability of MSD Ignition. To the extent permitted by law, the foregoing is exclusive and in lieu of all other warranties or representation whether expressed or implied, including any implied warranty of merchantability or fitness. In no event shall MSD Ignition or its suppliers be liable for special or consequential damages.

\*Intended normal use means that this item is being used as was originally intended and for the original application as sold by MSD Ignition. Any modifications to this item or if it is used on an application other than what MSD Ignition markets the product, the warranty will be void. It is the sole responsibility of the customer to determine that this item will work for the application they are intending. MSD Ignition will accept no liability for custom applications.