



# In Channel **SNAP/INZ**<sup>TM</sup> Sidewind Deflectors

## INSTALLATION INSTRUCTIONS

**WARNING:** Improper installation can result in damage to the sidewind and/or window/window mechanisms.

### BEFORE INSTALLATION:

- Trial fit the Sidewind Deflector to vehicle to ensure fit. Take note of where the adhesive will make contact.
- Clean window channels with glass cleaner. Allow cleaner to dry completely.
- Wipe the area where the adhesive strip will contact the window channel gasket with the alcohol pad provided. Allow the alcohol to dry completely.
- Apply the adhesive promoter to the areas where the adhesive will make contact, and allow to dry.

- 1** Insert the vertical leading edge of the sidewind into the channel behind the mirror assembly. (fig 1)  
Insert the tab at the bottom of the sidewind in between the flexible inner gasket and the solid outer gasket of the weather stripping.  
**NOT INTO THE WINDOW GLASS CHANNEL!** (fig 2)

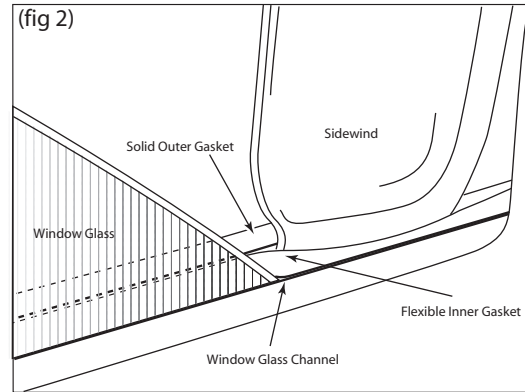
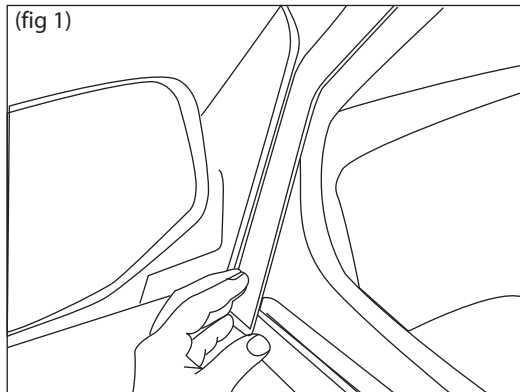

- 2** While holding the front end of the sidewind into the channel with one hand, grasp the back end with your free hand and bow the sidewind out towards you. (fig 3) Continue inserting the flange on the top of the sidewind into the channel ending up at the top rear corner of the window frame. Push upward on the sidewind until it is firmly seated into the channel. (fig 4)

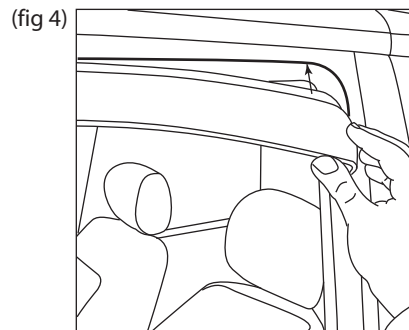
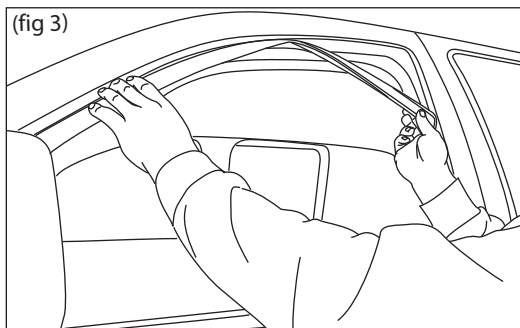

- 3** Carefully open and close the window several times to insure that the top flange on the sidewind is firmly and securely seated into the channel. With the window up push firmly on the outside of the gasket to insure the inside is securely fastened to the adhesive strip on the sidewind. Leave window closed for at least 24 hours for best results.

Repeat steps for passenger side window.



# In Channel **SNAP-IN** Sidewind Deflectors

## **INSTALLATION INSTRUCTIONS**

**WARNING:** Improper installation can result in damage to the sidewind and/or window/window mechanisms.

### **BEFORE INSTALLATION:**

- Trial fit the Sidewind Deflector to vehicle.
- Clean window channels with glass cleaner. Allow cleaner to dry completely.
- Wipe the area where the adhesive strip will contact the window channel gasket with the alcohol pad provided. Allow the alcohol to dry completely.
- Remove the backing from the adhesive strip before installing.

### **REAR SIDEWIND INSTALLATION**

**1** Remove backing from adhesive strip. Place the top rear corner of the sidewind into the top rear corner of the window opening, and insert the sidewind flange into the window channel. (fig 1)

**2** While holding the flange into place in the channel, pivot the the front end of sidewind into place making sure the top flange inserts into the channel as you pivot. Once the sidewind is in place push upwards on it to ensure that is securely seated "wedged" into the channel. (fig 2)

**3** When you close the window for the first time pull the sidewind slightly towards you to prevent the glass from dislodging the flange from the channel. (fig 3) Open and close the window a few times to insure the sidewind is securely seated. With the window closed push firmly along the outside of the outer gasket to ensure a good bond with the adhesive strip.

Leave the window closed for at least 24 hours to ensure it remains firmly seated into the channel.

Repeat the steps for passenger side window.

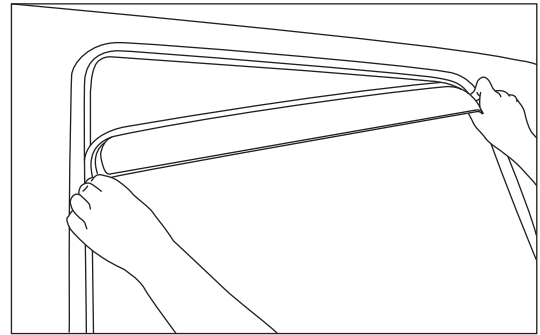

(fig 1)

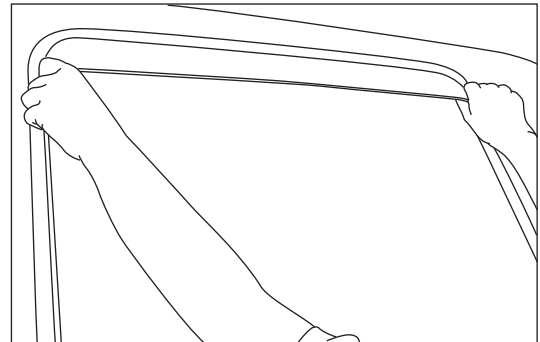

(fig 2)

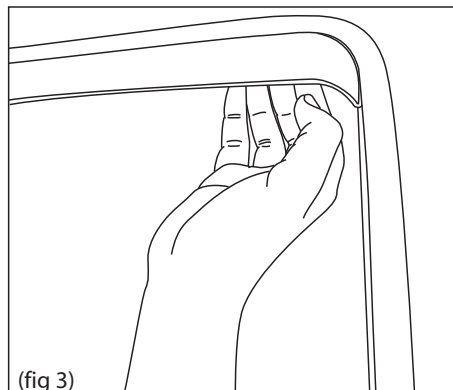

(fig 3)