

# FORD EXPLORER SPORT TRAC INSTRUCTIONS

Ford Sport Tracs, because of their unique nature, require additional assembly procedures to install the side rails. A set of support brackets and hardware have been included with your TruXedo® kit in place of the clamp assemblies used on standard pickup boxes. These have been especially designed to fit your Sport Trac composite box.

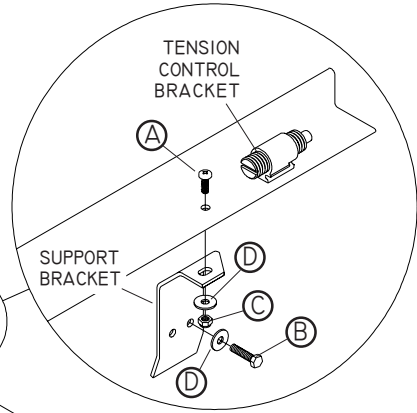
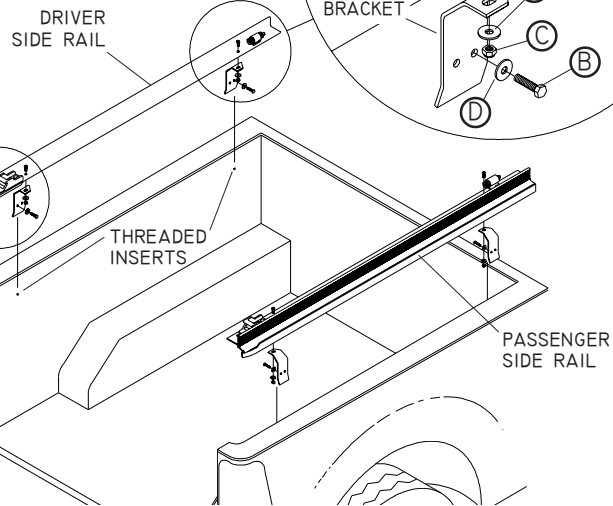
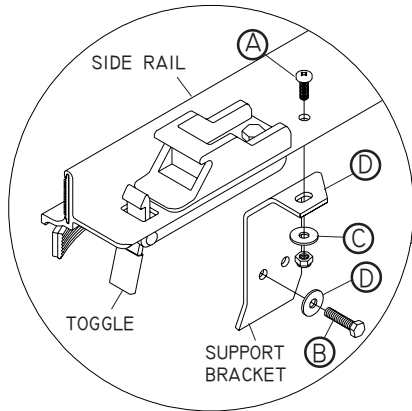

HARDWARE	
(A)	PAN HEAD CAP SCREW, 1/4" x 3/4"
(B)	HEX HEAD CAP SCREW WITH LOCKING PATCH, M6X1 x 25MM
(C)	NYLON LOCK NUT, 1/4"
(D)	FLAT WASHER, 1/4"

**Note:** Threaded inserts are built in to your Sport Trac composite box

**STEP 1:** Align rear hole in support bracket with threaded insert in composite box near tailgate. Insert screw (B) through washer (D) and hole in bracket. Finger tighten into composite box.

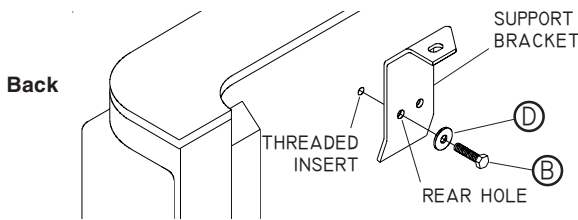

**STEP 2:** Align front hole on support bracket with threaded insert at front of composite box. Insert screw (B) through washer (D) and hole in bracket. Finger tighten into composite box.

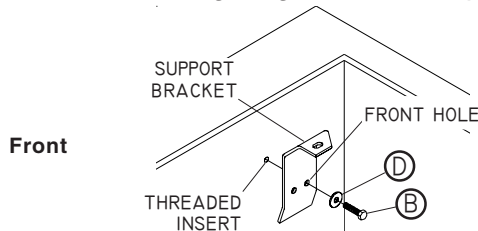

**STEP 3:** Fasten side rails to support brackets through pre-drilled holes in side rails with screws (A), washers (D) and nuts (C).

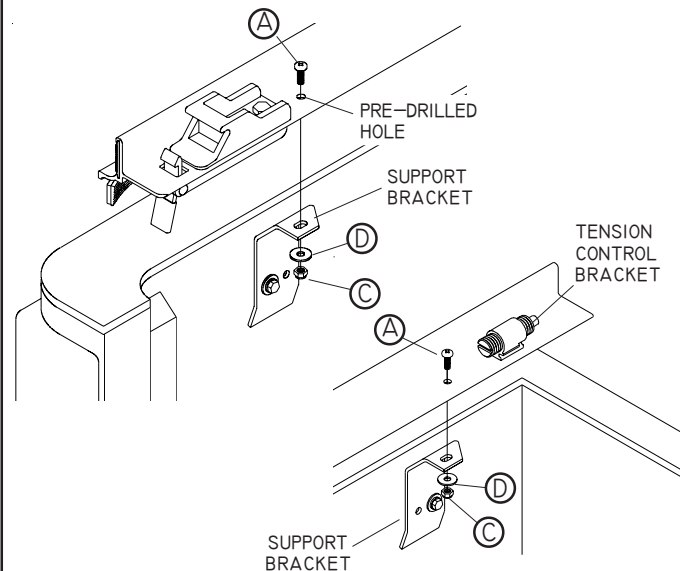

**STEP 4:** Tighten all screws and nuts securely.

**CAUTION** Tighten screws and nuts on side rails before driving vehicle

**Shur-Co.**

P.O. Box 713, 2309 Shur-Lok Street Yankton, South Dakota 57078

Call Toll Free: 877-TRUXEDO (1-877-878-9336) Fax: (605) 664-9304 Web Site: <http://www.truxedo.com>

**TRUXEDO**  
Yankton, SD 1-877-TRUXEDO

10/24/03, 50

P/N 1113672 Rev. B