



INSTALLATION INSTRUCTIONS

ATV Plow Mounting Kit

Part Number: 63936

Application: 2002 and newer Polaris Sportsman 700/600

Your safety, and the safety of others, is very important. To help you make informed decisions about safety, we have provided installation and operating instructions and other information on labels and in this guide. This information alerts you to potential hazards that could hurt you or others. It is not possible to warn you about all potential hazards associated with this product, you must use your own good judgment.

CARELESS INSTALLATION AND OPERATION CAN RESULT IN SERIOUS INJURY OR EQUIPMENT DAMAGE. READ AND UNDERSTAND ALL SAFETY PRECAUTIONS AND OPERATING INSTRUCTIONS BEFORE INSTALLING AND OPERATING THIS PRODUCT.

This guide identifies potential hazards and has important safety messages that help you and others avoid personal injury or death.

WARNING and **CAUTION** are signal words that identify the level of hazard. These signal words mean:

▲ WARNING signals a hazard that *could* cause serious injury or death, if you do not follow recommendations.

CAUTION signals a hazard that *may* cause minor to moderate injury, if you do not follow recommendations.

This guide uses **NOTICE** to call attention to important mechanical information, and **Note**: to emphasize general information worthy of special attention

▲ WARNING

SEVERE INJURY OR DEATH MAY RESULT IF YOU IGNORE ANY OF THE FOLLOWING.

- **Read the Plow Operator's Manual, the Winch Operator's Manual, and all warning labels before operating.**
- **Operate ATV at a walking speed with the blade installed. Do Not exceed 5mph (8 km/h) even with the blade up.**
- **Plow Cautiously, impact with a hidden or stationary object may cause the ATV to stop suddenly or go out of control.**
- **Do Not operate the ATV on slopes greater than 10° with the plow installed.**
- **Do Not stand or ride on the plow.**
- **Stay clear of moving parts and joints. Keep others away when operating or adjusting plow.**
- **Inspect the plow mechanism, fasteners, cable, and adjustments before operating. Replace all worn or damaged parts before operating.**
- **Lower the plow to the down position before leaving the ATV unattended.**

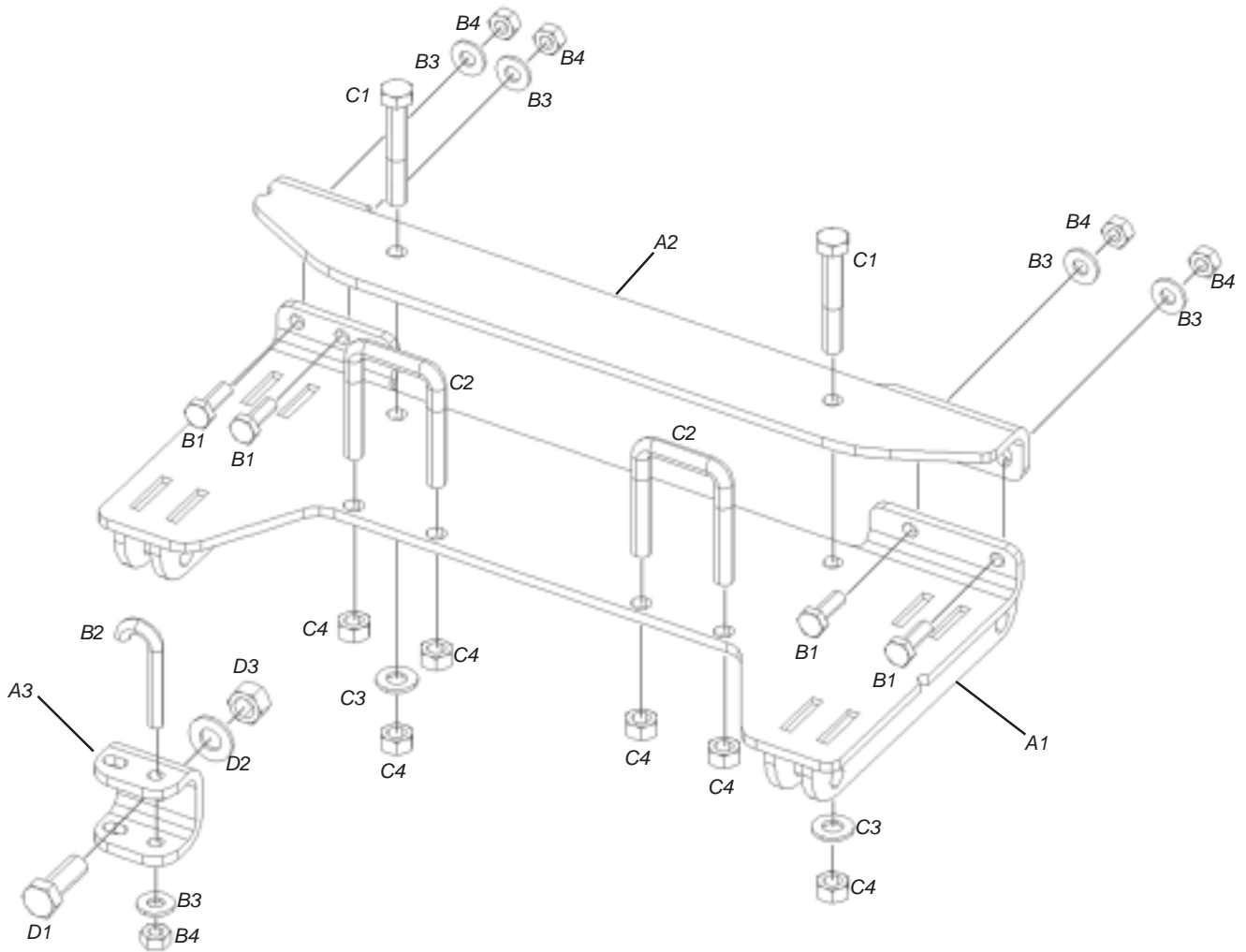

I. Parts List

<u>Ref</u>	<u>Part #</u>	<u>Description</u>	<u>Qty</u>
A1	64678	Plow Mount	1
A2	64319	Clamp Plate	1
A3	62845	J-bolt Bracket	1
B1	7146	1/4" dia x 3/4" long bolt	4
B2	35391	1/4" dia J-bolt	2
B3	1320	1/4" dia flat washer	6
B4	6725	1/4" dia nylock nut	6
C1	22501	5/16" dia x 2" long bolt	2
C2	61461	5/16" dia x 1-1/4" wide U-bolt	2
C3	1324	5/16" dia flat washer	2
C4	2002	5/16" dia nylock nut	6
D1	1827	3/8" dia x 1" long bolt	1
D2	11524	3/8" flat washer	1
D3	6779	3/8" nylock nut	1

II. Tools Required

- Ratchet
- Sockets: 7/16", 1/2", 9/16"
- Wrenches: 7/16", 1/2", 9/16"

III. Installation

1. Place the clamp plate (A2) over the top of the ATV frame just behind the front wheels.
2. Place the plow mount (A1) under the vehicle just below the clamp plate (A2) and behind the lip on the front skid plate as shown in figure 1.
3. Slide two 5/16" dia x 2" long bolts (C1) through the clamp plate (A2) and through the plow mount (A1). Terminate the bolts with a 5/16" dia flat washer (C3) and 5/16" dia nylock nut (C4).

NOTE: Do not tighten the bolt and nut completely. You will do this later in the installation.

4. Slide the four 1/4" dia x 3/4" long bolts (B1) through the plow mount (A1) and clamp plate (A2). Terminate the bolts with a 1/4" dia flat washer (B3) and 1/4" dia nylock nut (B4) as shown in figure 1.

NOTE: Do not tighten the bolt and nut completely. You will do this later in the installation.

5. Slide two 5/16" dia x 1-1/4" wide square U-bolts (C2) over the top of the square tubing of the ATV frame and through the plow mount. Terminate the ends of the U-bolts with a 5/16" dia nylock nut (C4) as shown in figure 2. Tighten the nuts to a recommended torque of 14 ft-lb.

NOTE: Do not install 5/16" flat washers on the ends of the U-bolts. Washers will interfere with the lip of the skid plate.

6. Next, tighten the two 5/16" dia x 2" long bolts (C1) and 5/16" dia nylock nuts (C4) to a recommended torque of 14 ft-lb.
7. Finally tighten the four 1/4" dia x 3/4" long bolts (B1) and 1/4" nylock nuts (B4) to a recommended torque of 7 ft-lb. The completed assembly should look like figure 3.

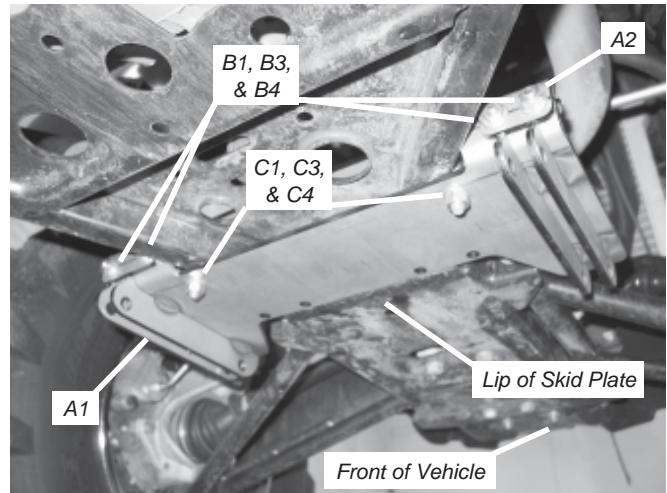

Figure 1 Install Bolts on Plow Mount

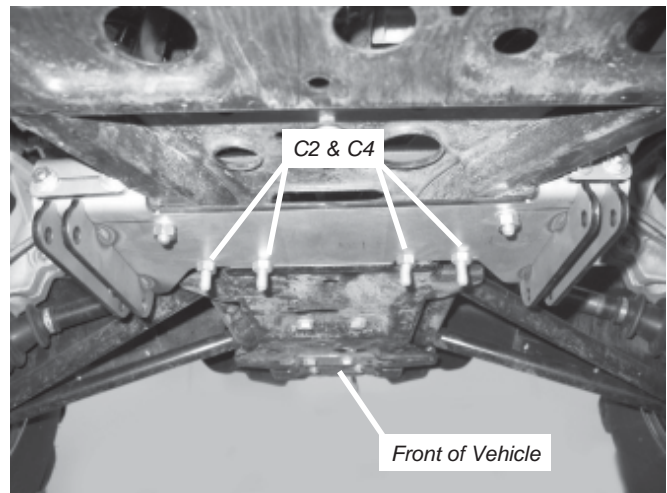

Figure 2 Install U-Bolts on Plow Mount

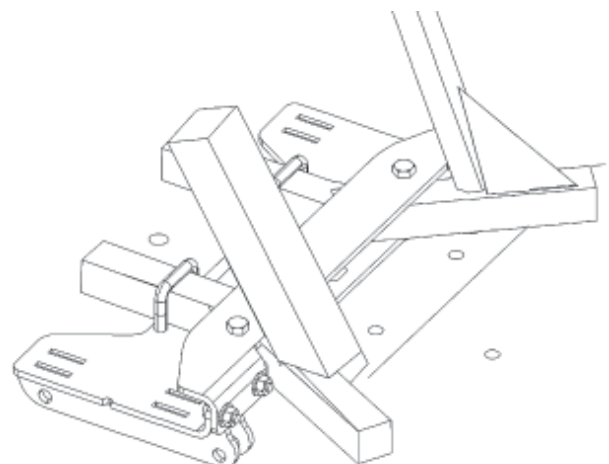

Figure 3 Assembled Plow Mount

⚠ WARNING

Tighten all nuts and bolts securely. Failure to check all nuts and bolts prior to use can result in product failure which can lead to vehicle damage and operator injury or death.

8. If not already done so, assemble the plow per the instructions that came with the plow blade kit. Attach the plow to the plow mount (A1) using the clip pins that came with the plow blade. Mount the plow to the forward holes in the plow mount if using a winch to lift the plow. Mount the plow to the rear holes in the plow mount if using either an electric actuator or manual lift to lift the plow. Use figure 4 as a reference.

If using an electric actuator or manual lift to raise your plow, stop here and proceed to section IV, Maintenance/Care. Winch users continue with step 9.

9. Attach the J-bolt bracket (A3) to the center hole in the plow crossmember using a 3/8" dia x 1" long bolt (D1) as shown in figure 5. The bracket should be mounted on the blade side of the crossmember with the side flanges parallel to the ground. Terminate the bolt with a 3/8" dia flat washer (D2) and 3/8" dia nylock nut (D3). Tighten the bolt and nut to a recommended torque of 25 ft-lb.
10. Run the winch cable over the roller fairlead and down to the J-bolt bracket (A3). Using a 1/4" dia J-bolt (A3), hook the loop on the end of the winch cable and slide the threaded end of the J-bolt through the round holes in the J-bolt bracket. The hook end of the J-bolt should slide into the slotted hole in the J-bolt bracket. Terminate the end of the J-bolt with a 1/4" dia flat washer (B3) and 1/4" dia nylock nut (B4). Tighten the nut until the winch cable is snug inside the J-bolt as shown in figure 6.

NOTE: If a winch hook is installed on the end of your winch cable, you may either remove it or simply slide it out of the way.

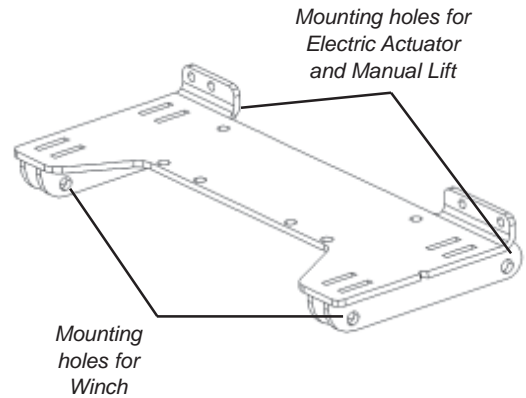

Figure 4 Mounting Locations

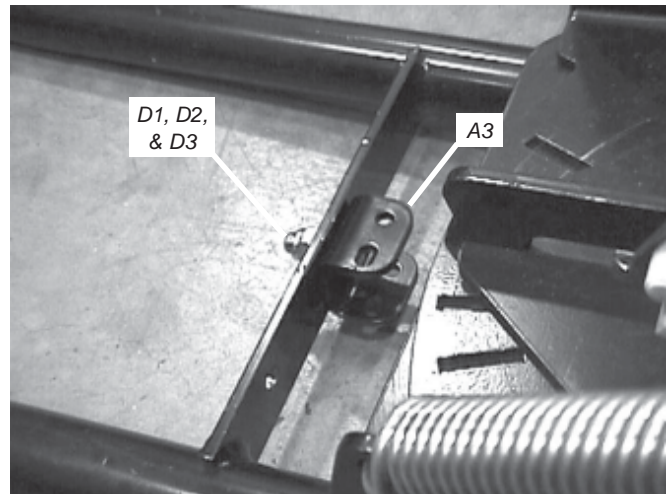

Figure 5 Installed J-bolt Bracket

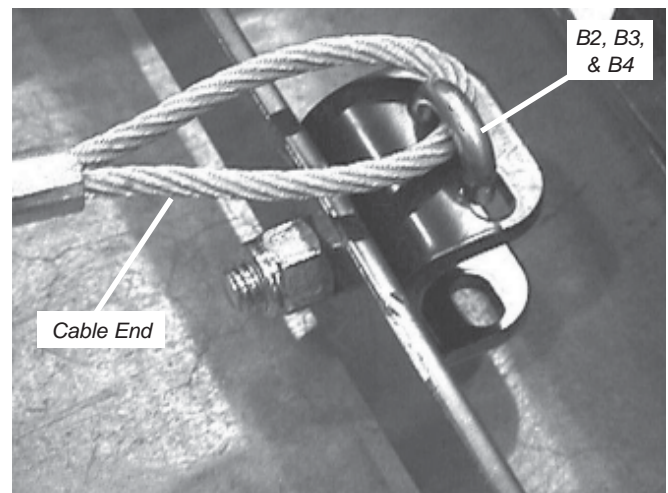

Figure 6 J-bolt and Winch Cable

⚠ CAUTION

The purpose of the J-bolt is to break the connection between the plow and ATV when the plow is subjected to high forces that could damage the plow or vehicle. The plow will drop instantly if the J-bolt breaks, so be sure there are no bystanders when operating the plow. Instances when the J-bolt might break are:

- If the plow is raised too high and stalls.
- If the operator is trying to lift too much material with the plow blade.

In general, do not raise the top of the plow blade above the headlights of the vehicle. If the plow stalls, stop the winch immediately and lower the plow. After pushing material with the plow, backup the ATV prior to raising it. If the J-bolt breaks, replace it with the spare hardware found in this kit. Read the Plow Operators Guide for more information.

Plow mount installation is now complete and should look like figure 7. Proceed to the next section entitled **Maintenance/Care**.



Figure 7 Completed Winch and Plow Assembly

IV. Maintenance/Care

- Inspect all metal parts on the plow, plow mount, and related hardware. Replace all that appears rusted or deformed prior to use.
- Inspect all nuts and bolts on the plow, plow mount, and related hardware prior to each use. Tighten all nuts and bolts that appear to be loose. Stripped, fractured, or bent bolts or nuts need to be replaced immediately.
- Check all cables prior to use. Replace cables that are worn or frayed.
- Check all moving and rotating parts. Remove debris that may inhibit the part from moving freely.

⚠ WARNING

Failure to perform regular inspections and maintenance on the plow, plow mount, and related hardware may result in vehicle damage and operator injury or death.

V. Troubleshooting

Problem

1. Difficulty getting the plow clip pins through the plow flanges and plow mount (A1).

Solution

1. Be sure to install the plow on level ground. Position the plow into place. Align one of the plow flanges with the mounting hole in the plow mount (A1). Slide a screwdriver (or similar) through the plow flange and plow mount. Align the plow flange on the other side with the plow mount. Slide one of the clip pins through the plow flange and plow mount. Go back to the first plow flange. Remove the screwdriver and replace it with the clip pin.