



INSTALLATION INSTRUCTIONS

Brush Guard Kit

For Chevrolet Trucks

Kit 65340/65535

Your safety, and the safety of others, is very important. To help you make informed decisions about safety, we have provided installation and operating instructions and other information on labels and in this guide. This information alerts you to potential hazards that could hurt you or others. It is not possible to warn you about all potential hazards associated with this product, you must use your own good judgment.

CARELESS INSTALLATION AND OPERATION CAN RESULT IN SERIOUS INJURY OR EQUIPMENT DAMAGE. READ AND UNDERSTAND ALL SAFETY PRECAUTIONS AND OPERATING INSTRUCTIONS BEFORE INSTALLING AND OPERATING THIS PRODUCT.

This guide identifies potential hazards and has important safety messages that help you and others avoid personal injury or death.

WARNING and **CAUTION** are signal words that identify the level of hazard. These signal words mean:

WARNING signals a hazard that *could* cause serious injury or death, if you do not follow recommendations.

CAUTION signals a hazard that *may* cause minor to moderate injury, if you do not follow recommendations.

This guide uses **NOTICE** to call attention to important mechanical information, and **Note**: to emphasize general information worthy of special attention



WARNING

Injury Hazard

Failure to observe these instructions could lead to severe injury or death.

- ❑ **ALWAYS USE EXTREME CAUTION WHEN DRILLING ON ANY VEHICLE. MAKE SURE THAT ALL FUEL LINES, BRAKE LINES, ELECTRICAL WIRES AND OTHER OBJECTS ARE NOT PUNCTURED OR DAMAGED WHEN/IF DRILLING ON THE VEHICLE. THOROUGHLY INSPECT THE AREA TO BE DRILLED (BOTH INBOARD AND OUTBOARD SIDE OF FRAME) PRIOR TO DRILLING, AND RELOCATE ANY OBJECTS THAT MAY BE DAMAGED. FAILURE TO INSPECT THE AREA TO BE DRILLED MAY RESULT IN VEHICLE DAMAGE, ELECTRICAL SHOCK, FIRE, OR PERSONAL INJURY.**
- ❑ **ALWAYS WEAR SAFETY GLASSES WHEN INSTALLING THIS KIT. THE DRILLING OPERATION WILL CAUSE FLYING METAL CHIPS. FLYING METAL CHIPS CAN CAUSE EYE INJURY.**

<u>PART NO.</u>	<u>QUANTITY</u>	<u>DESCRIPTION</u>
65336/65553	2	Center Tube, Black/Stainless
65338/65555	1	Brush Guard, RH, Black/Stainless
65337/65554	1	Brush Guard, LH, Black/Stainless
29146	6	Nylon Washer (Black only)
65533	2	Bracket (3/4 & 1 ton)
65668	2	Brace (1/2 ton)
39371	2	Adapter
39372	2	Plug
66548	1	Non Reflective Tape (Stainless only)

NOTE: These Brush Guards will fit both 1/2 ton and the 3/4 & 1 ton trucks, but different support brackets are required. See Figure 2 for the 1/2-ton application and Figures 3 and 4 for the heavier trucks.

NOTE: The self-tapping 1/4" screws should be threaded into the brush guards, then removed prior to installation of any parts. This will ease installation of the support brackets.

1. Install the Brush Guards onto the side plates of the Trans4mer Grille Guard as shown in **Figure 1**. Adjust outer ends for best alignment with lights and bumper. Tighten securely.

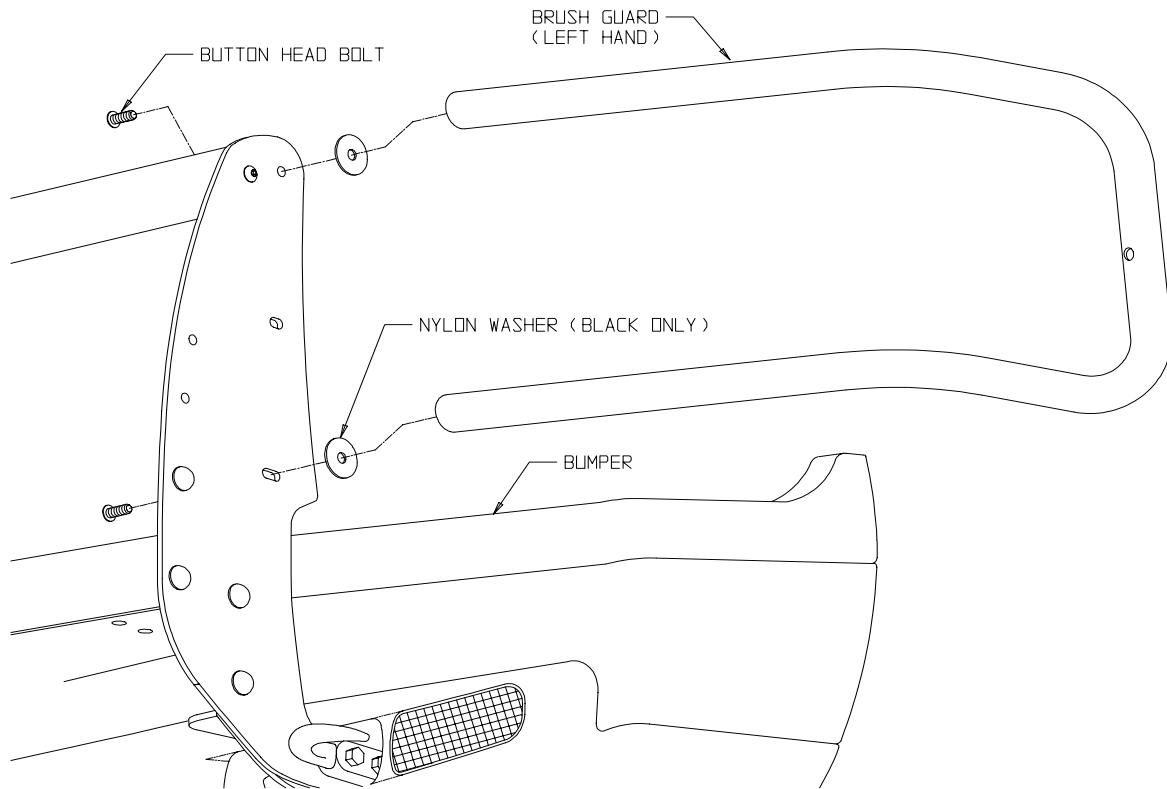

Figure 1: Install Brush Guard.

2. **On 1/2 ton trucks only**, refer to **Figure 2** and attach the brace to the Brush Guard tubes. Secure with the 1/4" self-tapping bolt. Using the square slotted hole as a guide, drill a 1/4" hole thru the bumper plastic and the metal below. Secure with the black 1/4" square neck bolts and a locknut on the bottom side of the bumper lip.



Figure 2: For 1/2 ton only.

3. **On 3/4 and 1 ton trucks only**, slide the Brush Guard Bracket along the bumper as shown in **Figure 3**. Approximately 4" in rotate the bracket in towards the truck. This will allow the Bracket to slide the rest of the way up to the Brush Guard. Line the holes up on the Bracket and Brush Guard. Attach the Bracket with a 1/4" self-tapping bolt.

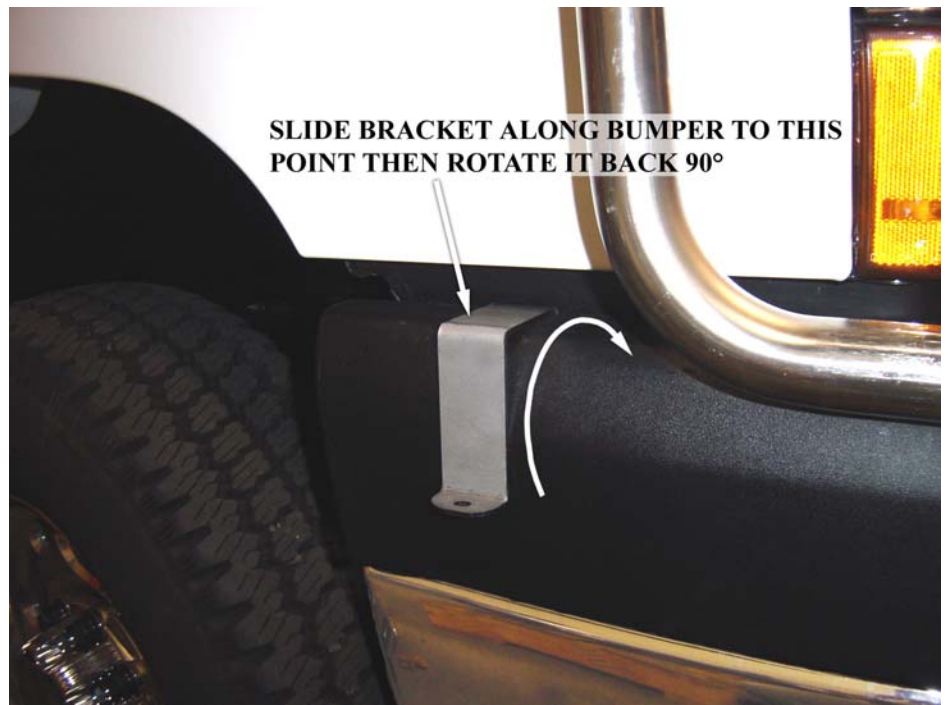

Figure 3: (3/4 & 1 ton only) Install Brush Guard Bracket

4. **On 3/4 and 1 ton trucks only**, use the Brush Guard Bracket as a guide to drill a 1/4" hole in the bumper as shown in **Figure 4**.
5. Attach the Bracket to the bumper with a 1/4" x 1" bolt and locking nut. Insert the bolt from the top side and the nut on the bottom side.

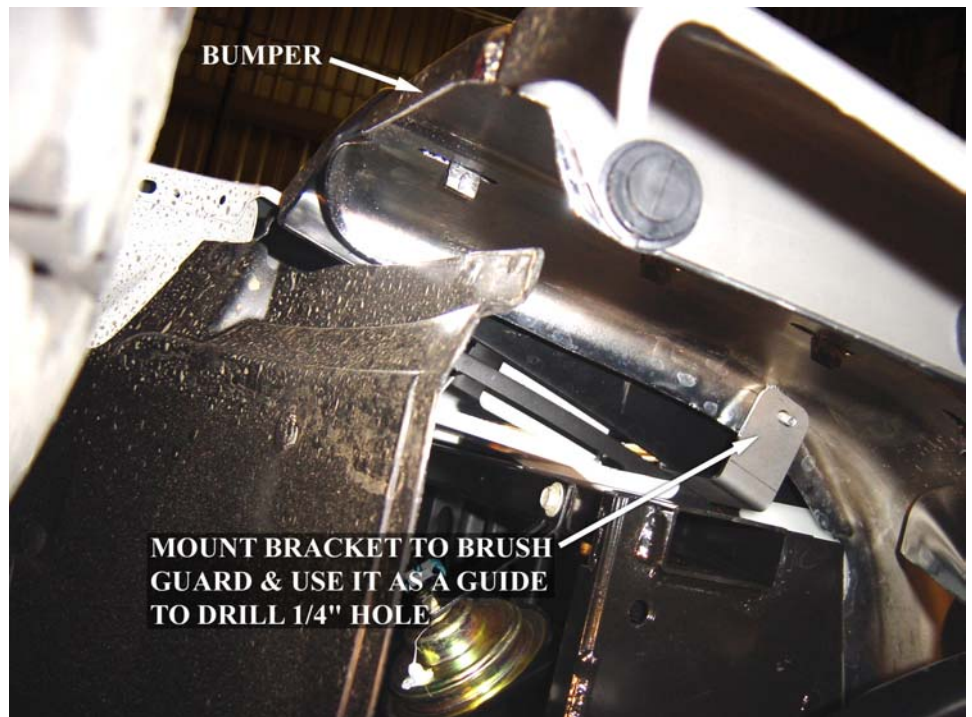

Figure 4: (3/4 & 1 ton only) Drill 1/4" hole, install 1/4" bolt and nut (passenger side).

6. Install the Center Tube as shown in **Figure 5**. Note the adjustment slot in side member and adjust tube to achieve best fit. Note that the rubber Adapter is cut out at an angle and must be installed to match the Brush

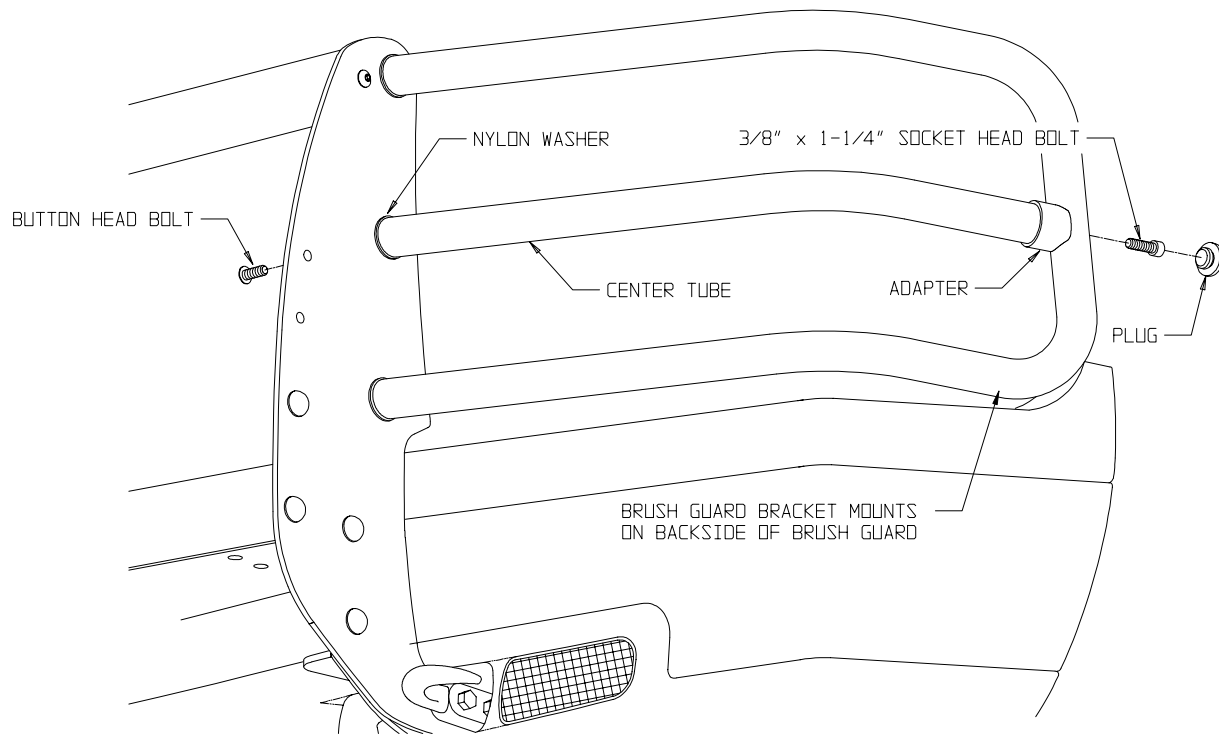

Figure 5: Install Center Tube.

Guard properly. **Do not over tighten the Socket Head Bolt at the outer end.**



CAUTION

Injury Hazard

Failure to observe these instructions may lead to moderate or minor injury.

- Always install non-reflective tape as instructed.

INSTALLATION OF NON-REFLECTIVE TAPE (stainless steel kit only)

7. The gray tape included with the Stainless Steel Brush Guard Kit is to reduce the light reflected from the headlights when they are in the high beam mode. The tape is to be installed as shown in Figures 6, 7, and 8. Cut two pieces of tape 8" long. Round the corners to reduce the chance of it peeling off. NOTE: When it is in place, the edge of it will be approximately 9.5" from the Side Member.

Prior to installation clean the area of the Brush Guards where the tape will be placed with Isopropyl Alcohol (Rubbing Alcohol). Draw a guide line with a Permanent Marker starting at the center of the outward shallow bend, centered on the tube vertically, running approximately 8" inboard as shown in Figure 6. Install the tape as shown in Figures 7 and 8.



Figure 6: Draw tape centerline.



Figure 8: Stick to centerline first to minimize air bubbles.



Figure 7: Gray tape installed.

Warn Industries

Stainless Steel Truck Accessories

What to expect:

Polished stainless steel combines the beauty of a chrome-like appearance with extreme durability and corrosion resistance. With a minimum amount of care, the appearance will last almost indefinitely. Unlike platings or coatings, there is nothing to peel off or wear away that would allow corrosion underneath.

The actual appearance may not be exactly like new chrome in either the degree of luster or color. There may be fine polishing lines visible up close and small differences between mating parts of an assembly. A grille guard, for instance, may have small differences between the round tubing and the flat plate. The backside of a part may not be as highly polished as the front. However, part of the beauty and appeal of stainless actually lies in the smooth “hand-worked” appearance.

There also is a possibility that small rust spots can appear on stainless products. They are usually due to minor iron contamination on the surface as a result of normal manufacturing and handling processes. This minor rust, if it occurs at all, is easy to remove and will not tend to spread.

Recommended care:

Regular washing with fresh water and mild car wash detergents followed by rinsing and drying with a soft towel is the best minimum care. Beyond that, any cleaner/wax recommended for automotive finishes will work well to remove minor stains and scuffs, enhance the shine and provide protection. Always use clean soft cotton cloths. In most cases, this will be all that is required for many years. For more serious blemishes or a rust spot, use a cream metal polish recommended for stainless, aluminum, etc. Try to rub in the direction of the original polishing lines.

Ultimately, any stainless part can be restored to a brilliant shine with power buffing processes.

Caution:

Do not use steel wool or any type of metal scraper. Do not use “Scotch Brite” pads or abrasive powdered cleaners. Do not try to clean with muriatic acid or any other acid.

Stainless Fasteners

Stainless steel fasteners are included in many of the stainless kits. These fasteners provide similar corrosion resistance and appearance as the rest of the kit. However, stainless fasteners are prone to galling when installed in similar stainless material. It is a good idea to apply a small amount of anti-seize compound to the threads when installing them. Care should also be taken when tightening the fasteners to prevent rounding or deforming the corners of the bolts. Make sure the wrenches are the correct size and fit properly. In the case of socket heads, the wrench should have sharp, un-worn edges. With a few precautions during assembly the products should provide years of service.