



# INSTALLATION INSTRUCTIONS SKID PLATE BODY ARMOR

Part Number: 74870

Application: Yamaha Grizzly 700 2007

Your safety, and the safety of others, is very important. To help you make informed decisions about safety, we have provided installation and operating instructions and other information on labels and in this guide. This information alerts you to potential hazards that could hurt you or others. It is not possible to warn you about all potential hazards associated with this product, you must use your own good judgment.

**CARELESS INSTALLATION AND OPERATION CAN RESULT IN SERIOUS INJURY OR EQUIPMENT DAMAGE. READ AND UNDERSTAND ALL SAFETY PRECAUTIONS AND OPERATING INSTRUCTIONS BEFORE INSTALLING AND OPERATING THIS PRODUCT.**

This guide identifies potential hazards and has important safety messages that help you and others avoid personal injury or death. **WARNING** and **CAUTION** are signal words that identify the level of hazard. These signal words mean:

**WARNING** signals a hazard that *could* cause serious injury or death, if you do not follow recommendations. **CAUTION** signals a hazard that *may* cause minor to moderate injury, if you do not follow recommendations.

This guide uses **NOTICE** to call attention to important mechanical information, and **Note** to emphasize general information worthy of special attention.

## **WARNING** INJURY HAZARD

Failure to observe these instructions could lead to severe injury or death.

- Always** Read all warning labels before operating.
- Always** use extreme caution when drilling on any vehicle. Make sure that all fuel lines, brake lines, electrical wires, and other objects are not punctured or damaged when/if drilling on the vehicle. Thoroughly inspect the area to be drilled (on both sides of material) prior to drilling, and relocate any objects that may be damaged. Failure to inspect the area to be drilled may result in vehicle damage, electrical shock, fire or personal injury.
- Always** wear safety glasses when installing this kit. A drilling operation will cause flying metal debris.
- Always** use extreme caution when cutting and trimming during fitting.
- Always** remove jewelry and wear eye protection.
- Never** lean over battery while making connections.
- Always** insure components will remain secure during installation and operation.
- Always** tighten all nuts and bolts securely, per the installation instructions.
- Always** inspect, tighten, and replace damaged hardware before use.
- Always** replace all worn or damaged parts before operating.
- Never** operate this WARN product with damaged or missing parts.
- Never** work under vehicle before properly securing vehicle.

## **NOTICE**

- Product may affect airflow to vehicle engine and drivetrain components.
- Installation of this accessory may affect vehicle warranty.
- This product will NOT protect vehicle from all impacts and terrain conditions.

<b>⚠ Caution</b>	
<b>Moving Parts Entanglement Hazard</b>	
<b>Failure to observe these instructions could lead to minor or moderate injury.</b>	
<input type="checkbox"/>	<b>Always</b> take time to fully read and understand the installation and Operations Guide included with this product.
<input type="checkbox"/>	<b>Never</b> operate this product if you are under 16 years of age.
<input type="checkbox"/>	<b>Never</b> operate this product when under the influence of drugs, alcohol or medications.
<b>Read installation and operating instructions thoroughly.</b>	

## I. TABLE OF CONTENTS

Before You Begin ..... page 3  
 Parts List ..... page 3  
 Tools Required ..... page 3  
 Torque Specifications ..... page 4  
 Installation ..... page 4-6  
   *Body Armor* ..... page 5  
 Maintenance/Care ..... page 7  
 Service Parts ..... page 7

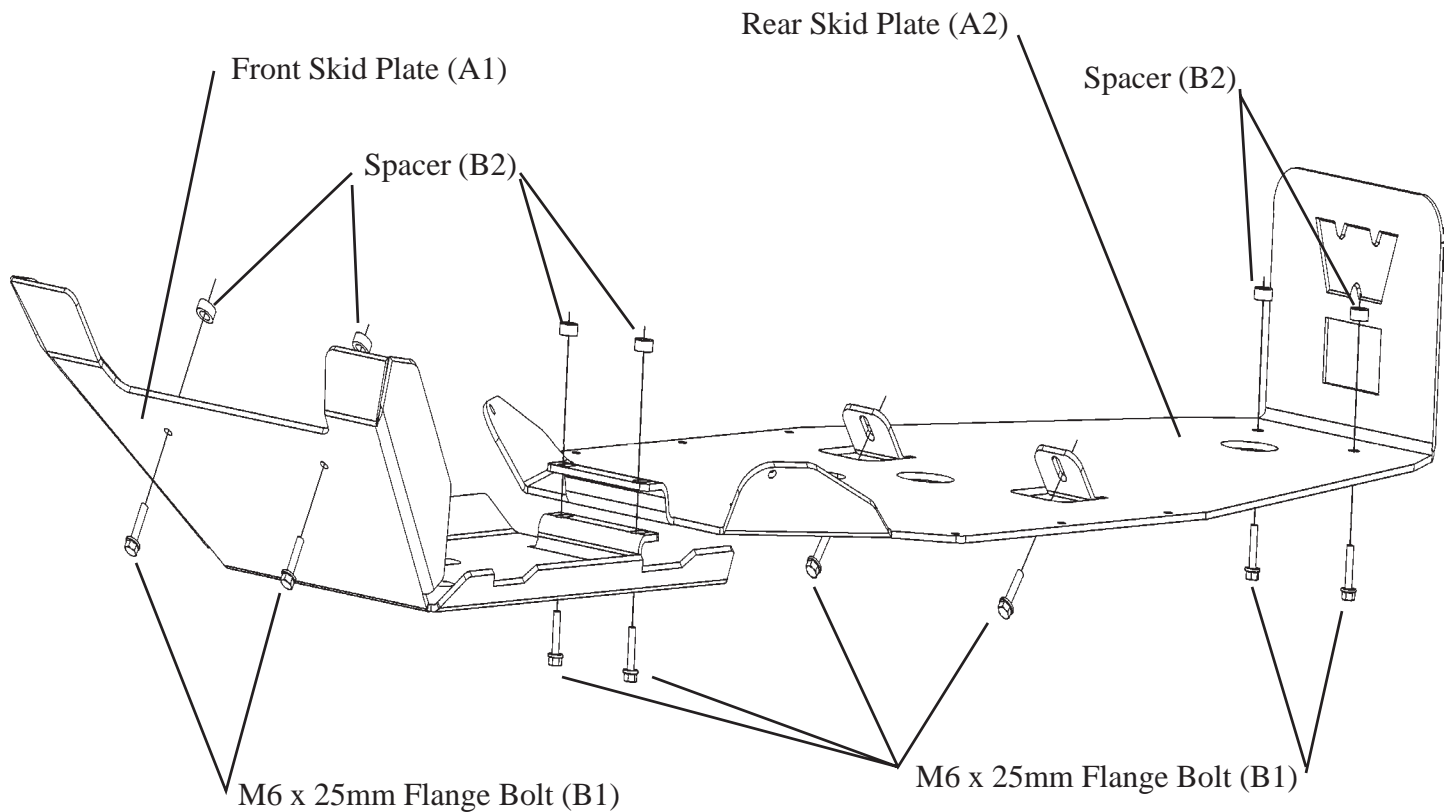

## II. BEFORE YOU BEGIN

<b>⚠ Caution</b>
<b>Injury Hazard</b>
<b>Failure to observe these instructions could lead to injury.</b>
<input type="checkbox"/> Part edges may be sharp!

### Installation tip:

- Apply electrical tape to clean dry vehicle components that will be in direct contact with aluminum skid plates. Tape will help protect painted finish against abrasion and can reduce tendency of squeaks.
- Raising the vehicle on a hoist or ramps may ease installation of this product.
- A second person may helpful in holding larger panels in place for hole drilling and fastening.

## III. PARTS LIST

### Kit 1 - Body Armor (75266)

<u>Reference</u>	<u>Part Number</u>	<u>Qty</u>	<u>Description</u>
A1	74498	1	Front Skid Plate
A2	74499	1	Rear Skid Plate
B1	64108	8	M6 x 25mm Flange Hd Bolt
B2	66039	6	Spacer

## IV. TOOLS REQUIRED

- 10mm end wrench and or socket

## V. TORQUE SPECIFICATIONS

<u>Fastener Size</u>	<u>Torque lb.ft. (n-m)</u>
M8	21lb.ft. (29 N-m)
M6	8.8 lb. ft. (12 N-m)

## VI. INSTALLATION:

1. Remove factory plastic skid plates, front and rear.
2. Tape spacers (B2) in place on the front and rear skid plates. The spacers will be taped to the back of the fastener embossings on both skid plates, two on the front skid plate and two on rear skid plate
3. Place the rear skid plate (A2) into position as indicated in figure 1. Attach to the bottom of the ATV frame at the mid point fastening position. Run two M6 flange bolts (B1) up through the angled tabs and into the weld nuts on the frame, finger tight at this time see figure 1.

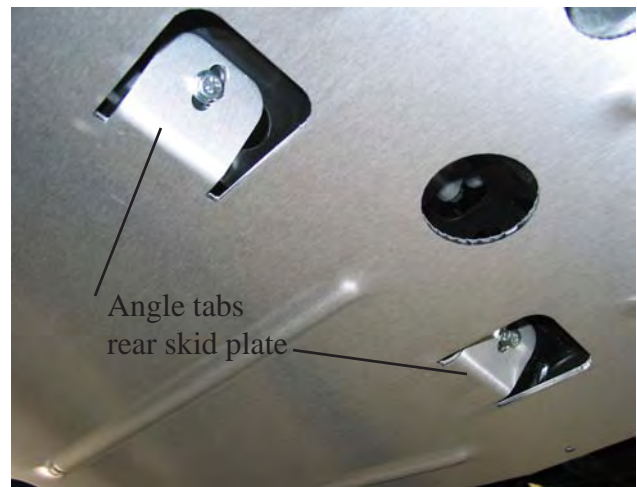

*Figure 1*

4. Run the M6 flange bolts (B1) up through the rear fastener embossings through the spacers (B2) taped on the back side and into the weld nuts on the frame, see figure 2. Note: In some cases the M6 bolts may be too long and bottom out on the frame in this instance use the factory bolts that were removed in step 1.



*Figure 2*

5. The front flange of the rear skid plate can be attached after the front skid plate (A1) is in position, see figure 3.
6. Position the front skid plate into position on the ATV and attach at the front with 2 M6 flange bolts (B1). Run the flange bolts through the fastener embossings and through the spacers taped on the backside and into the weld nuts on the ATV, see figure 4.



*Figure 3*

## VI. INSTALLATION:



Figure 4

5. To finish the attachment of the front and rear skid plates. first slip a spacer (B2) behind the flanges on the skid plates. Run an M6 flange bolt (B1) up through the flange on the front skid plate (A1) and through the flange on the rear skid plate (A2) and through the spacer (B2) and into the weld nut on the frame, see figure 5.

6. Tighten all fasteners at this time to recommended torques on page 3



Figure 5

## VII. MAINTENANCE/CARE

- Inspect all metal parts and related hardware. Replace all parts that appear corroded, cracked or deformed prior to use.
- Inspect all nuts and bolts and related hardware prior to each use. Tighten all nuts and bolts that appear to be loose. Stripped, fractured, or bent bolts or nuts need to be replaced immediately.
- Check skid plates protecting moving or rotating parts of the vehicle. Remove debris that may inhibit the part from moving freely. Removal of aluminum armor may be necessary to thoroughly clean and inspect both the vehicle and the aluminum underbody components. Frequency of removal will depend on the type of terrain conditions experienced. Regular cleaning will help keep product looking good and will help avoid damage to related components.

Contact Warn customer service with installation issues, comments, concerns, and questions.

## WARN INDUSTRIES, INC

Customer Service Department  
12900 SE Capps Road  
Clackamas, OR 97015  
1-800-543-WARN (1-800-543-9276)  
1-503-722-3005 International Fax  
www.warn.com