

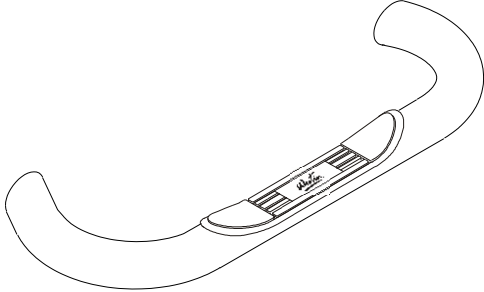

INSTALLATION INSTRUCTIONS

APPLICATION: 1989-94 TOYOTA COMPACT PICKUP REG. CAB

AUTOMOTIVE PRODUCTS, INC.

STEP BAR ASSEMBLY 25-0570 25-0575	
--	--

QTY	PARTS KIT CONTENTS DESCRIPTION	TOOLS REQUIRED
2	STEP BAR	3/4" SOCKET
2	FRONT BRACKET	3/4" WRENCH
2	REAR BRACKET	9/16" SOCKET
3	MOUNT BAR	9/16" WRENCH
1	MOUNT BAR, BENT	RATCHET
4	TOP CLAMP ASSEMBLY	TORQUE WRENCH
4	BOTTOM CLAMP ASSEMBLY	
1	SPACER PLATE	
4	1/2-13 X 2.00" HEX HEAD BOLT	
4	1/2" LOCK WASHER	
8	3/8-16 X 1.75" HEX HEAD BOLT	
8	3/8" FLAT WASHER	
8	3/8" LOCK WASHER	

- STEP 1. Remove the contents from the box and check for any damage. Verify all parts against the parts list.
- STEP 2. Read and understand instructions completely before beginning installation.
- STEP 3. Attach brackets to step bars using 1/2" fasteners. Torque to 65 FT.LBS.
- STEP 4. On inside of passenger side frame, remove bolt holding plastic clip that supports brake and gas lines.
NOTE: Remove only the clip nearest the front door. Place spacer plate between clip and frame and reinstall bolt.
- STEP 5. Position step bar up to frame. Slide top clamp assembly between top of frame and body. Hook top clamp assembly to mounting bar. Attach brackets to top clamps using 3/8" fasteners. Finger tight. With top clamps in position, hook bottom clamps to mounting bar and bolt to brackets using 3/8" fasteners. Make sure step bar is properly aligned with vehicle. Torque 3/8" fasteners to 30 FT.LBS.
NOTE: Some adjustment front to back might be necessary to clear obstructions that might be on frame.
- STEP 6. Repeat for opposite side.

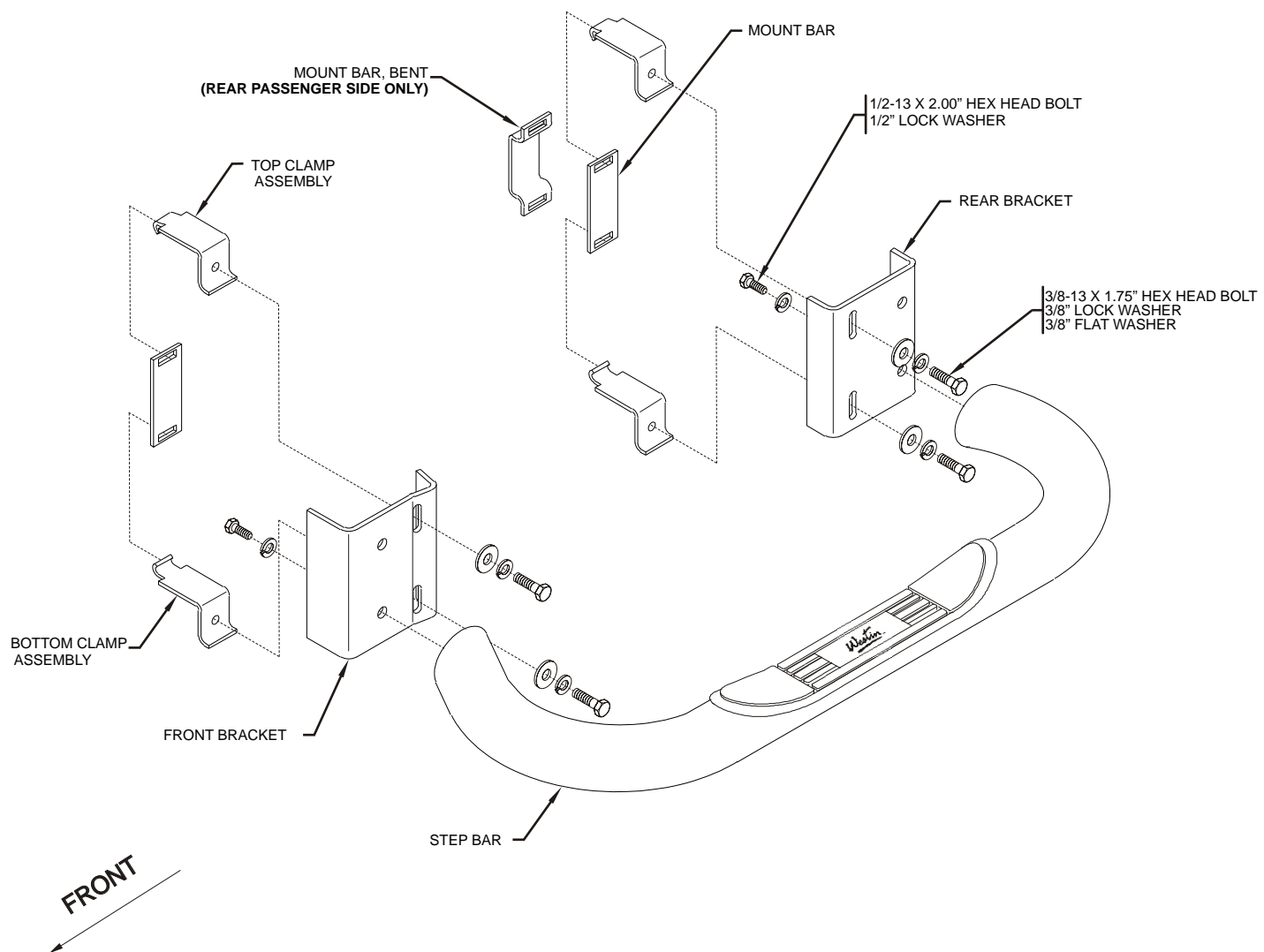

FIGURE 1
INSTALLATION VIEW OF DRIVER SIDE, PASSENGER SIDE OPPOSITE

Finish protection - Westin products have a high quality finish that must be cared for like any other exposed finish on the vehicle. Protect the finish with a non-abrasive automotive wax (pure carnauba, for example) on a regular basis. The use of cleaner wax or any compound which contains an abrasive is detrimental, as the compounds scratch the finish and open it to corrosion.



Westin Automotive Products, Inc.
 5200 N. Irwindale Ave. Suite 220
 Irwindale, Ca. 91706

Thank You for choosing Westin products
 For additional installation assistance please call
 Customer service (800) 793-7846 or (507)-375-3559